

MISSOURI HIGHWAYS AND TRANSPORTATION COMMISSION
2(6.0' x 3.0') CONCRETE BOX CULVERT

ROUTE 66	STATE MO	DISTRICT BR	SHEET NO. 1
JOB NO. J7S0741			
CONTRACT ID			
PROJECT NO.			
COUNTY JASPER			DATE
SEC/SUR 3 & 10 TWP 27N RGE 33W			

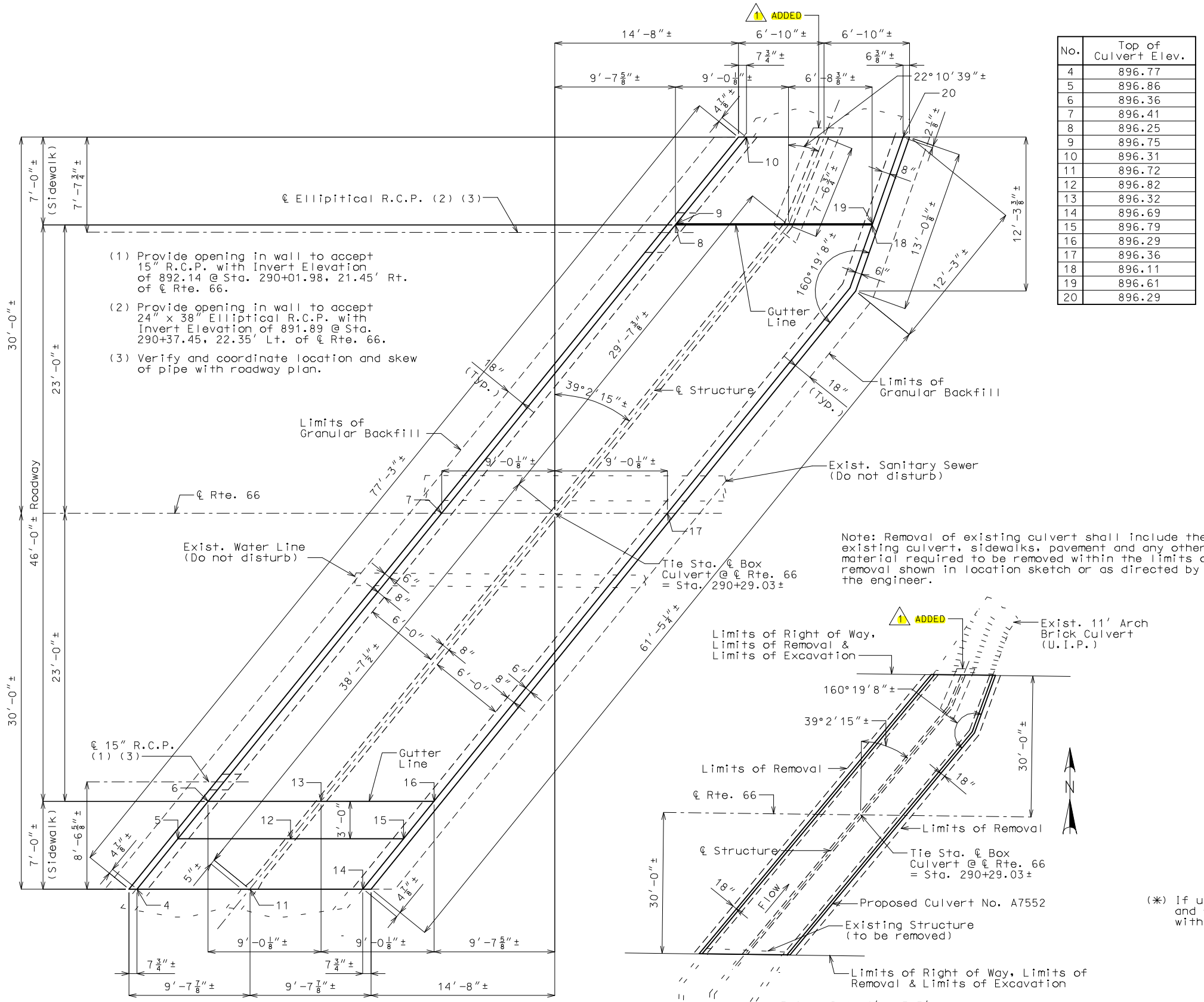

No.	Top of Culvert Elev.
4	896.77
5	896.86
6	896.36
7	896.41
8	896.25
9	896.75
10	896.31
11	896.72
12	896.82
13	896.32
14	896.69
15	896.79
16	896.29
17	896.36
18	896.11
19	896.61
20	896.29

Estimated Quantities			Final Quantities
Removal of Existing Culvert	lump sum	1	
Class B-1 Concrete (Culverts)	cu. yard	166.6	
Class B-2 Concrete	cu. yard	41.9	
Reinforcing Steel (Culverts)	pound	14,910	
Reinforcing Steel (Epoxy Coated)	pound	7,710	

Cost of any required excavation for concrete box culvert will be considered completely covered by the contract lump sum price for Removal of Existing Culvert. (See Sec 206 and Sec 216)

- GENERAL NOTES:**
- Design Specifications:** 2002 - AASHTO 17th Edition Load Factor Design
 - Design Loading:** HS20 Modified, Earth 120 #/ft.³, Equivalent fluid pressure 30 #/ft.³ (Min.) - 60 #/ft.³ (Max.)
 - Design Unit Stresses:** Class B-1 Concrete (Bottom Slab & Walls) f'c = 4,000 psi; Class B-2 Concrete (Top Slab) f'c = 4,000 psi; Reinforcing Steel (Grade 60) fy = 60,000 psi
 - Miscellaneous:** Minimum clearance to reinforcing steel shall be 1 1/2", unless otherwise shown. "Sec" refers to the sections in the standard and supplemental specifications unless specified otherwise. Top of bottom slab and inside faces of walls shall be built flush with the existing downstream structure. Outline of old work is indicated by light dashed lines. Heavy lines indicate new work. Contractor shall verify all dimensions in field before ordering new material. Use cast-in-place culvert only. Precast concrete box culvert option shall not be used.
 - Traffic Handling:** Rte. 66 (W. 7th St.) shall be closed during construction. (See Roadway Plans)

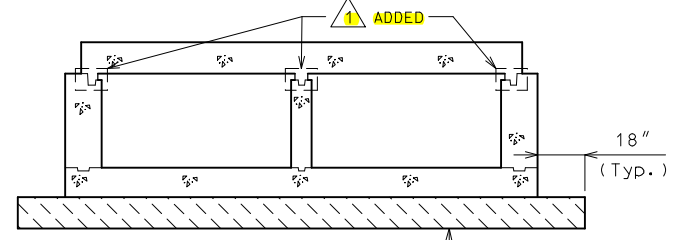

SECTION THRU BOX

(*) If unsuitable material is encountered, excavation of unsuitable material and furnishing and placing of granular backfill shall be in accordance with Sec 206.

B.M. #2, ELEV. 896.79, 80D NAIL
STA. 289+24.76, 28.85 RT.

CULVERT OVER STORM SEWER
STATE ROAD BETWEEN MOFFET AVE. AND BEYERS AVE.
IN JOPLIN
PROJECT NO. STA. 290+29.03±
JOB NO. J7S0741 RTE. 66