

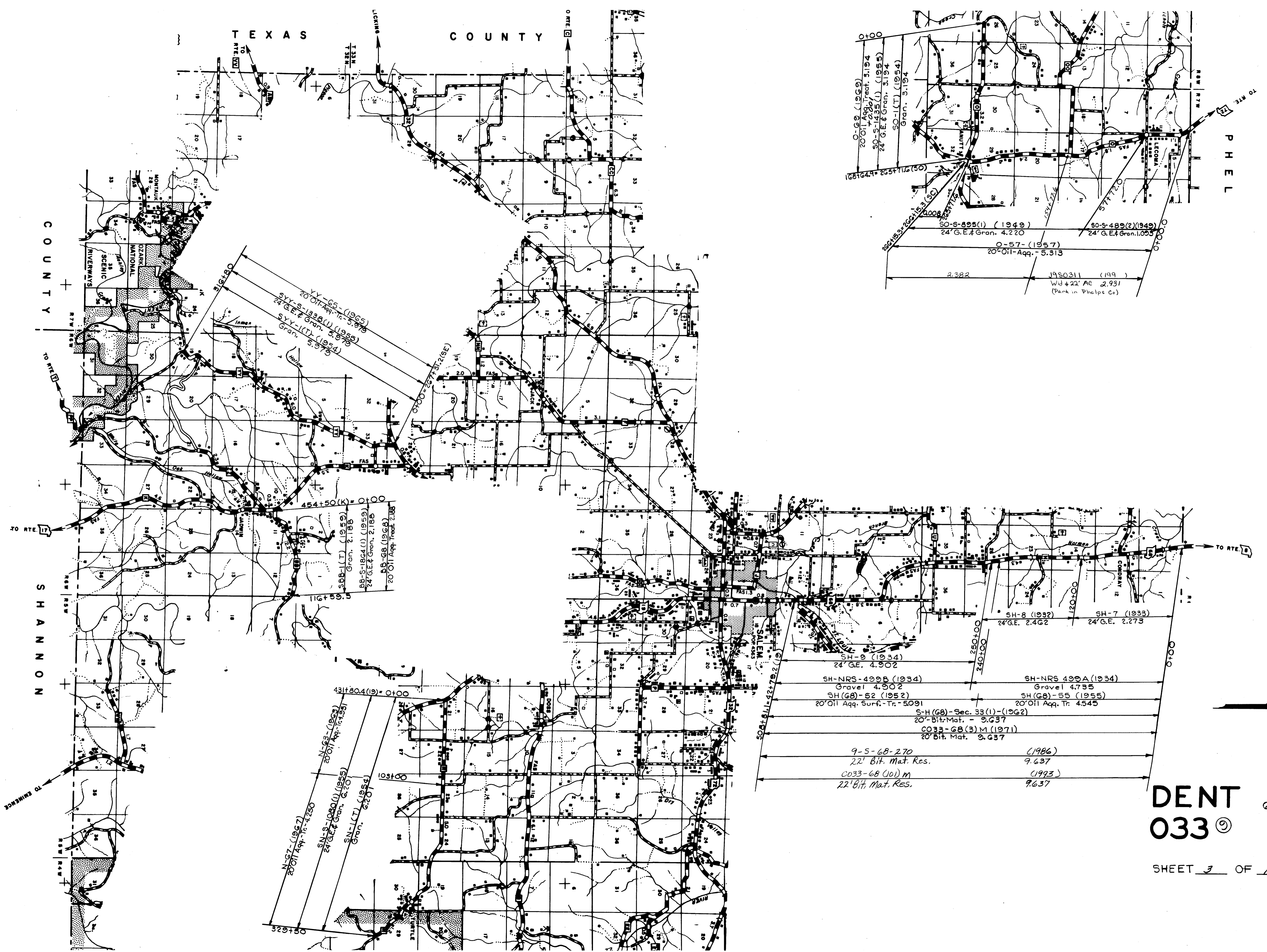

DENT ROUTE 32
033 ©

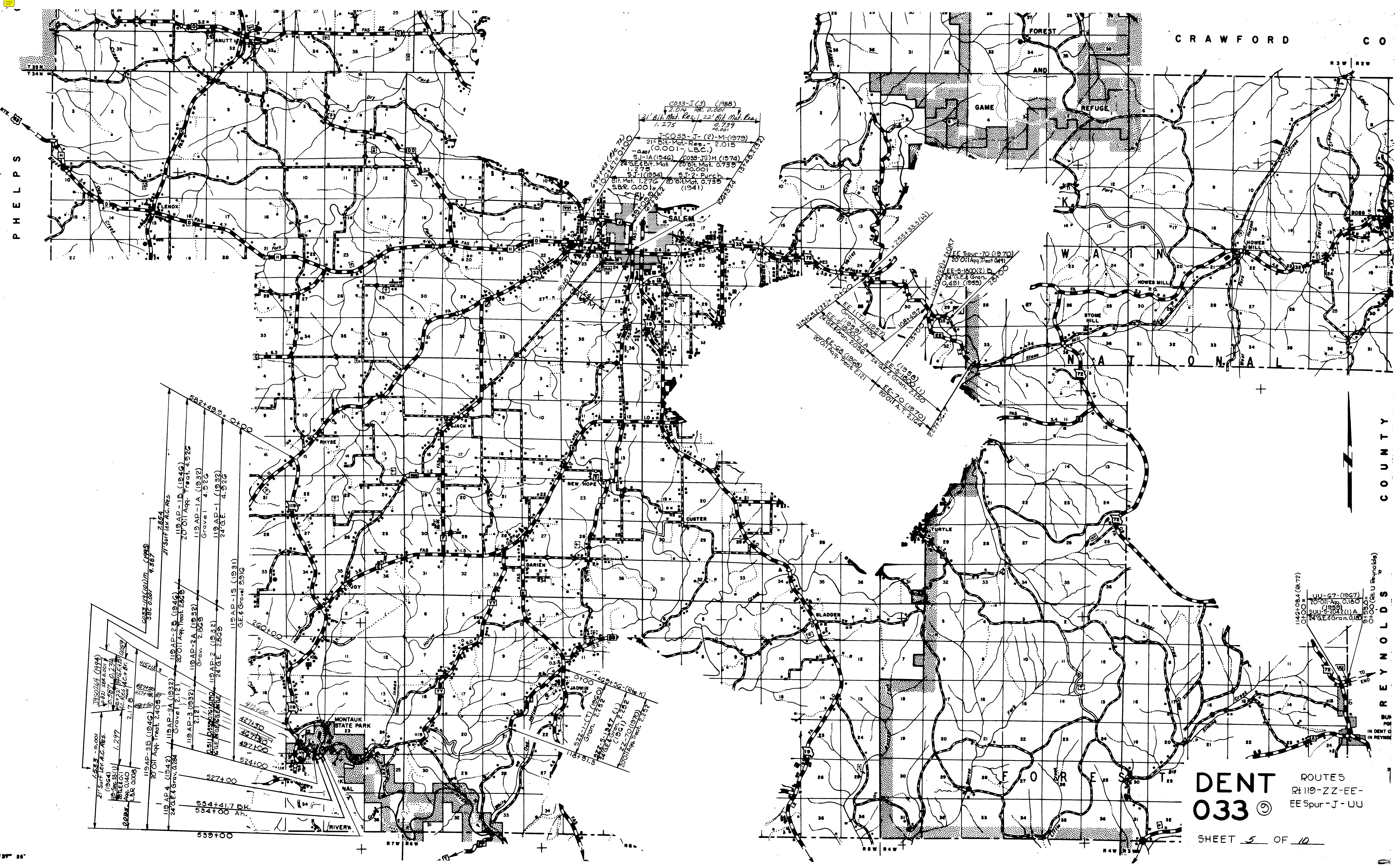

SHEET 3 OF 10



0033-J (3) (1988)
21' Bit. Mat. Res. 22' Bit. Mat. Res.
1.275 0.739
0.001
J-0033-J (2)-M (1979)
21' Bit. Mat. Res. - 2.015
(0.001 - L.B.C.)
S-J-1A (1946) (2035-J) M (1974)
24' G.E. Bit. Mat. 20' Bit. Mat. 0.739
-0.001
S-J-1 (1934) S-J-2 Purch.
Bit. Mat. 1.270 20' Bit. Mat. 0.739
S.B.R. 0.001 (1941)

EE Spur-70 (1970)
20' Oil Acq. Treat. 0491
EE-S-1000 (2) D
24' G.E. Gran. 0.421 (1955)

EE-68 (1968)
20' Oil Acq. Treat. 2121
EE-69 (1969)
20' Oil Acq. Treat. 2121
EE-70 (1970)
20' Oil Acq. Treat. 2121
EE-71 (1971)
20' Oil Acq. Treat. 2121
EE-72 (1972)
20' Oil Acq. Treat. 2121

3150164 (1994)
27' Surf. Lev. A.C. Res.
0.587 0.236
0.001
1.297
0.001
2.176
119 AP-3B (1946)
20' Oil Acq. Treat. 2405
119 AP-3A (1932)
Gravel 1.121
119 AP-2B (1946)
20' Oil Acq. Treat. 2405
119 AP-2A (1932)
Grav. 2.869
119 AP-1A (1932)
Gravel 4.926
119 AP-1 (1932)
24' G.E. 4.926
119 AP-1S (1931)
G.E. & Gravel 931G
5274.00
554+41.7 Bk.
534+00 Ah.
539+00

1146+08.4 (Rt. 72)
UU-67 (1967)
20' Oil Acq. 0.160
(1939)
SUU-S-2042 (1) A
24' G.E. Gran. 0.100
9159.02
0+00 (Rt. U. 1490.04)

DENT
033 ©
SHEET 5 OF 10
ROUTES
Rt 119-ZZ-EE-
EE Spur-J-UU

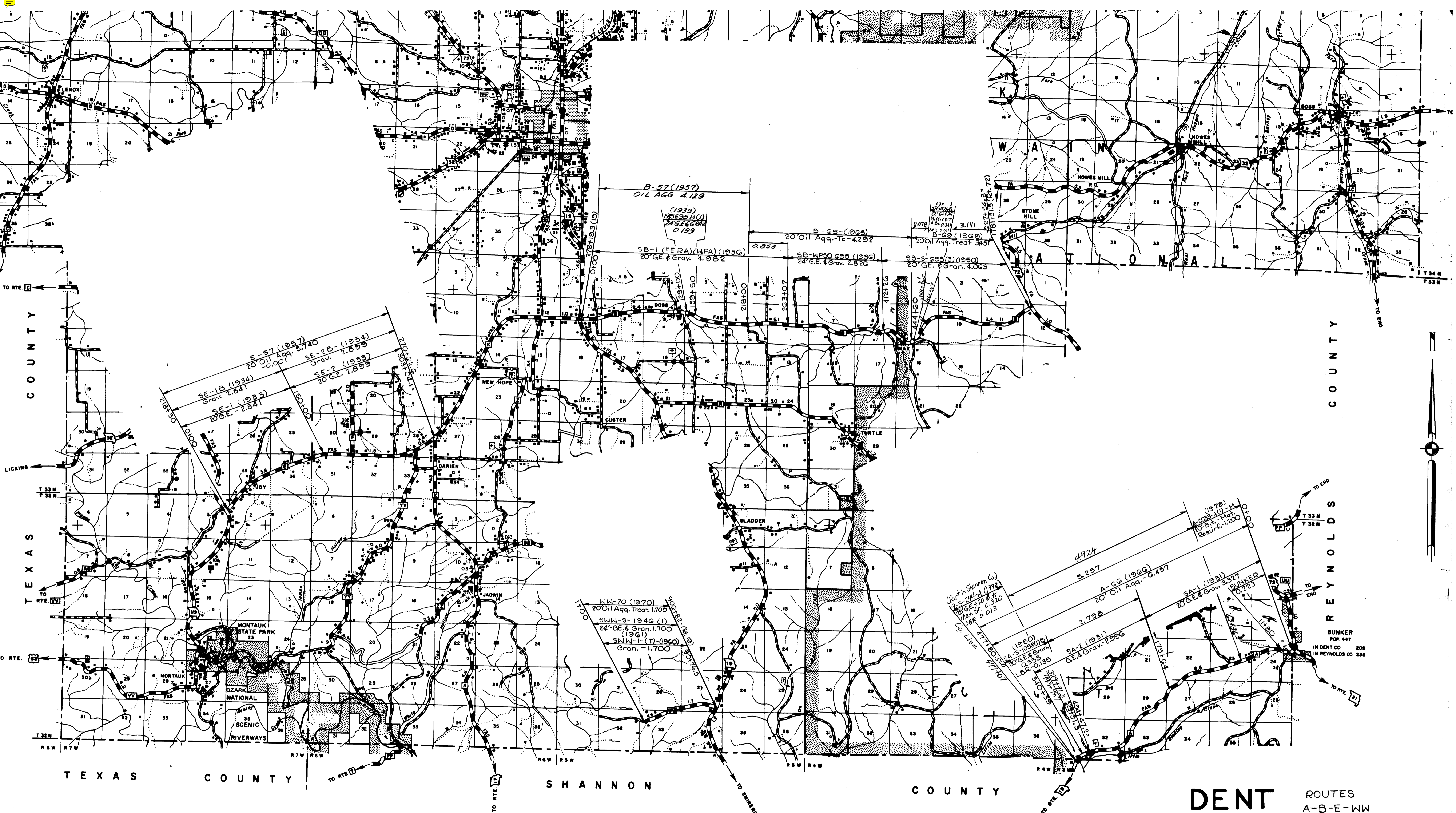

TEXAS COUNTY

TEXAS COUNTY

TEXAS COUNTY

TEXAS COUNTY

TEXAS COUNTY

SHANNON COUNTY

SHANNON COUNTY

REYNOLDS COUNTY

DENT
033 ©

ROUTES
A-B-E-WW

SHEET 6 OF 10

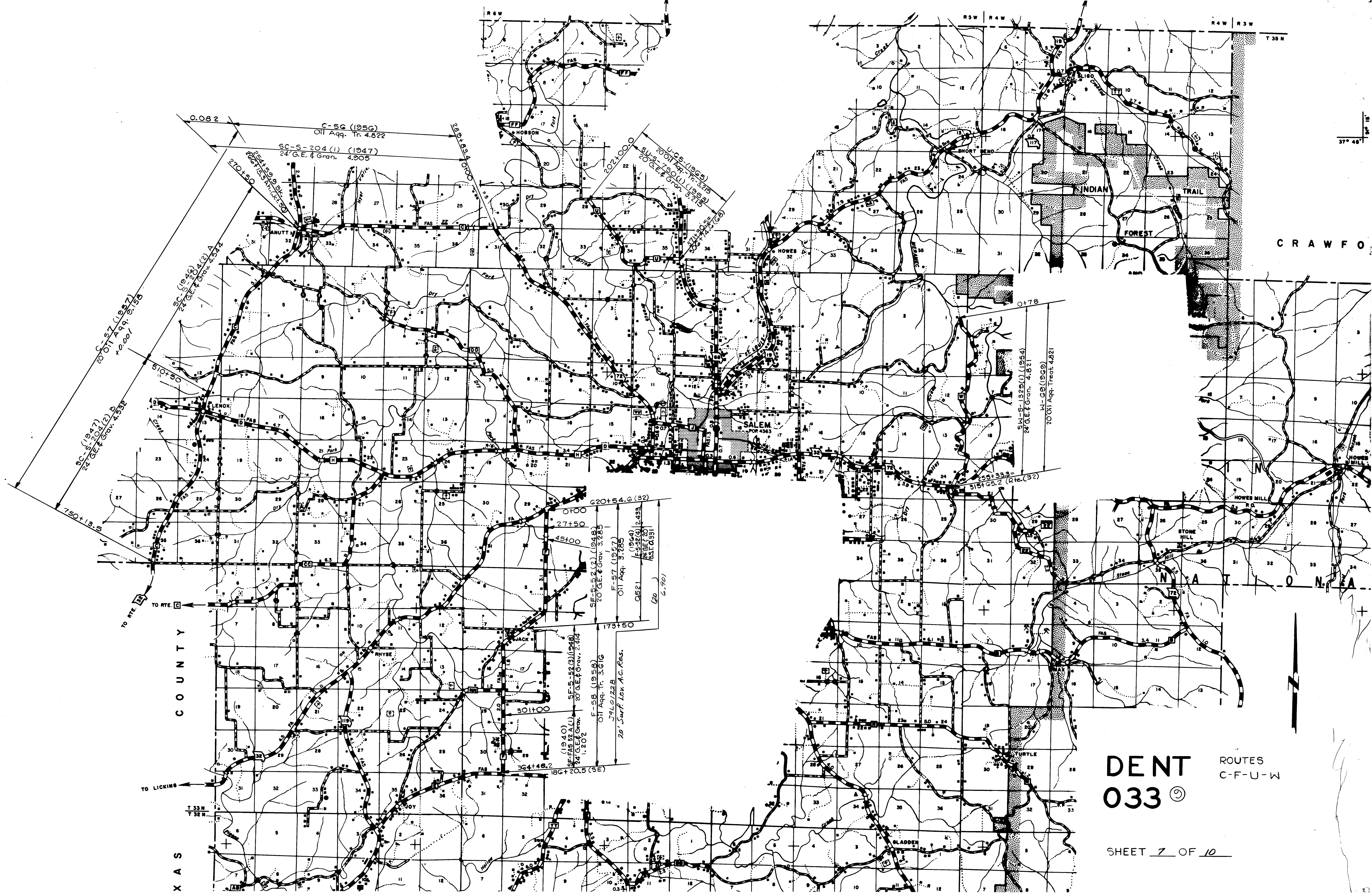

DENT
033 ©

SHEET 7 OF 10

ROUTES
 C-F-U-W

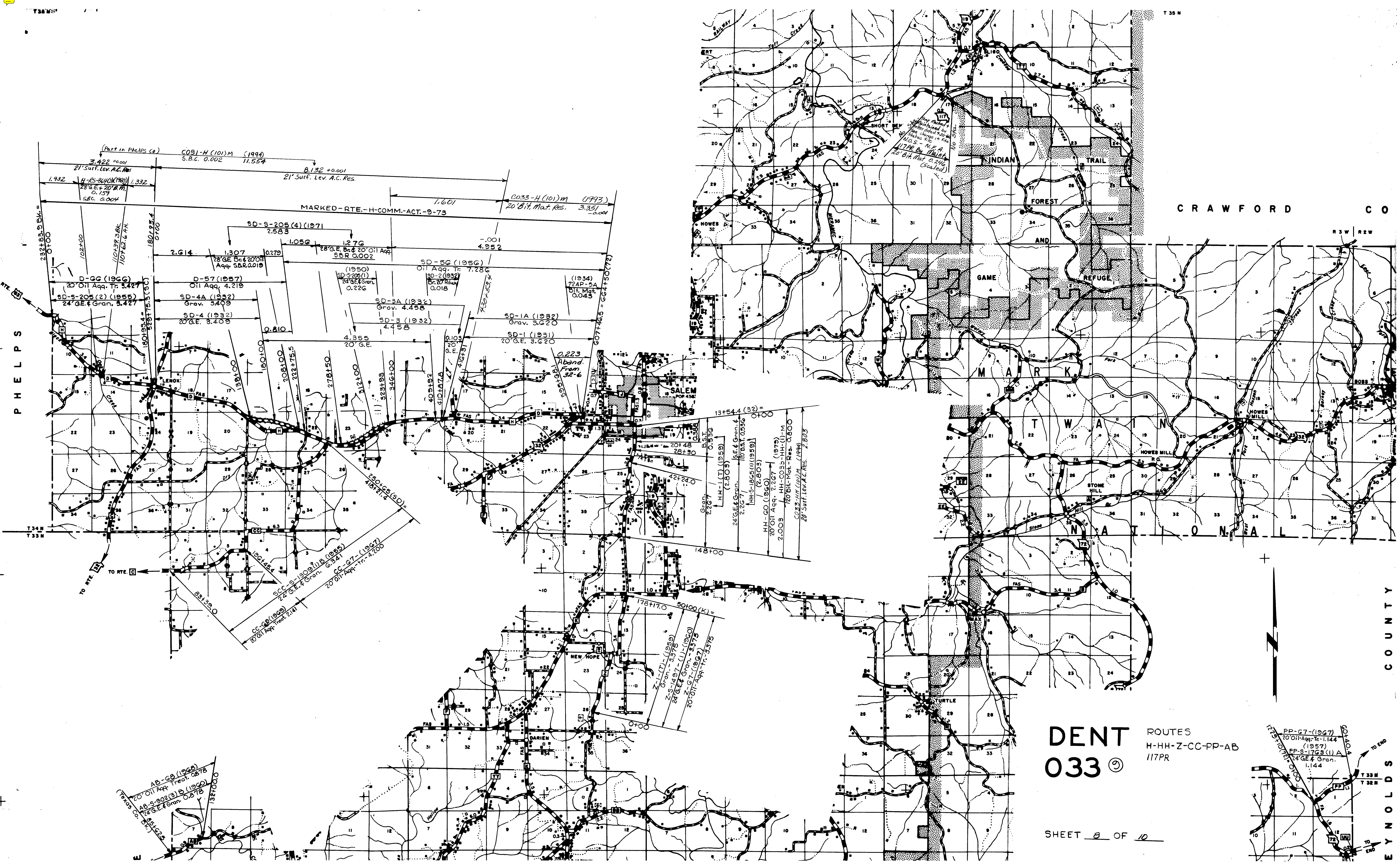

T 35 W

CRAWFORD CO

EYNOLDS COUNTY

DENT
033

ROUTES
H-HH-Z-CC-PP-AB
117PR

SHEET 8 OF 10

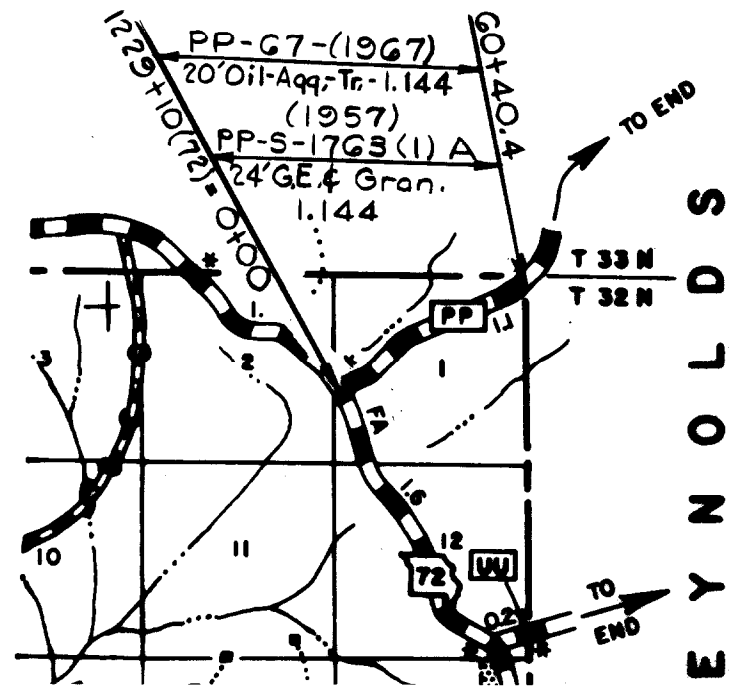

(Part in Phelps Co) COB1-H (101)M (1994)
5.B.C. 0.002 11.554

3.422 +0.001
21' Surf. Lev. A.C. Res.

1.932
H-RS-3640X(1983) 1.332
28' G.E. + 20' B.M.
O. 159
S.B.C. 0.004

8.132 +0.001
21' Surf. Lev. A.C. Res.

1.601
CO33-H (101)M (1993)
20' B.M. Mat. Res. 3.351
0.001

MARKED-RTE.-H-COMM.-ACT.-9-73

SD-S-205 (4) (1971)
2.683

2.614

1.307
28' G.E. Br. 4 20' Oil App.
Aqq. S.B.R. 0.019

0.279

1.056

1.276
28' G.E. Br. 4 20' Oil App.
S.B.R. 0.002

SD-56 (1956)
Oil App. Tr. 7.286

(1950)
SD-5-205 (1)
24' G.E. Gran. 0.226

SD-2 (1932)
Br. 20' Mat. 0.018

(1934)
70' AP-5A
Bit. Mat. 0.043

D-GG (1966)
20' Oil App. Tr. 5.427

D-57 (1957)
Oil App. 4.219

SD-5-205 (2) (1955)
24' G.E. Gran. 5.427

SD-4A (1932)
Grav. 3.409

SD-4 (1932)
20' G.E. 3.409

SD-3A (1932)
Grav. 4.458

SD-3 (1932)
4.458

SD-1A (1932)
Grav. 3.620

SD-1 (1931)
20' G.E. 3.620

0.810

4.355
20' G.E.

0.103
20' G.M.

0.223
Aband. From 326

6077.65 = 6647.50 (72)

13+54.4 (32) =
0+00

0.356
B.S.T.

HH-1 (T) (1959)
(2.803)

24' G.E. Gran. 1.64
20' B.M. 10' B.S.T. 0.056

HH-S-165 (1) (1959)
(2.803)

HH-GO (1960)
(2.803)

20' Oil App. 2.267 (1979)

2.003
HH-CO33-HH-11-M

120' B.M. Mat. Res. 0.600

CO33-HH (101)M (1994)
20' Surf. Lev. A.C. Res. 2.203

148+00

178+17.0
50+00 (K)

Z-1 (T) (1959)
Gran. 3.376

Z-S-1497 (L) (1960)
24' G.E. Gran. 3.376

Z-G-1 (L) (1967)
20' Oil App. Tr. 3.376

CC-68 (1968)
20' Oil App. Treat. 2.878

AB-S-902 (3) B (1960)
24' G.E. Gran. 0.878

CC-67 (1967)
20' Oil App. Tr. 4.200

CC-69 (1969)
20' Oil App. Treat. 2.111

250+65 (SD)
1087.74

1387.00

1387.00

102+00

110+39.3 BK
110+62.6 AH

180+33.4
0+00

232+83.9 BK =
0+00

TO RTE [B]

TO RTE [C]

TO ENO

TO END

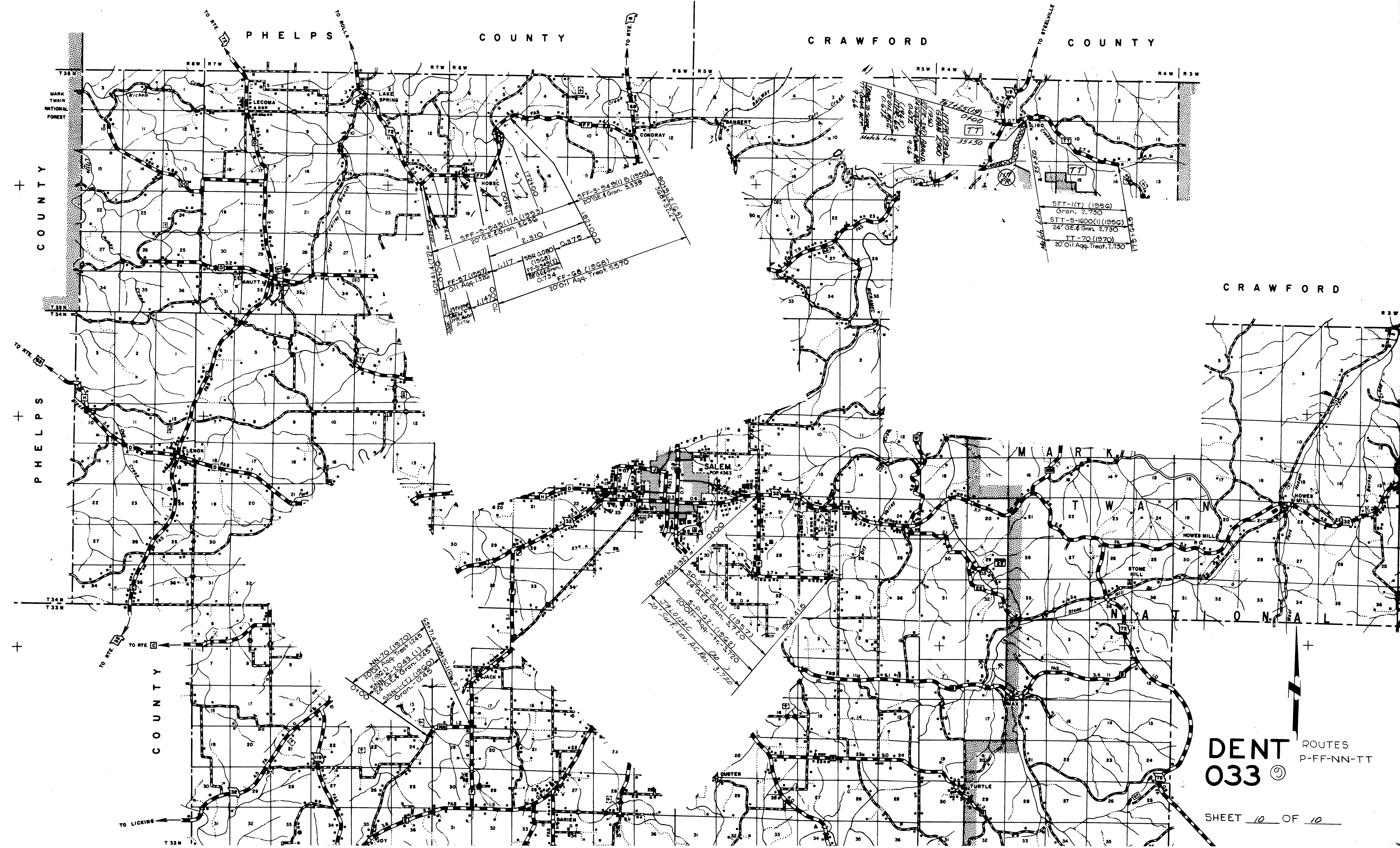

PHELPS COUNTY CRAWFORD COUNTY

CRAWFORD

DENT 033 ROUTES P-FF-NN-TT

SHEET 10 OF 10

SFF-5-949(1)A (1953)
20' G.E. & Gran. 3,636

FF-57 (1957)
Oil Acq. 1,322

FF-68 (1968)
Oil Acq. Treat. 5,570

Match Line
17125(19)
0100
35450

STT-1(T) (1956)
Gran. 2,730
STT-9-1600(1) (1956)
24' G.E. & Gran. 2,730
TT-70 (1970)
20' Oil Acq. Treat. 2,730

NN-70 (1970)
2001 Acq. Treat. 1,245
SNN-2-2042(1) (1967)
24' G.E. & Gran. 1,245
SNN-CT-1 (1967)
Gran. 1,245

SP-5-1623(U) (1957)
24' G.E. & Gran. 3,170
SP-6-2-1186(2)
20' Oil Acq. Treat. 3,170
SP-10-1226
20' Surf. Lev. AC. Res. 3,170

COUNTY

PHELPS

COUNTY

MARK TWAIN

W A I N

N A T I O N A L

R E C R E A T I O N A R E A

