

ROUTE :
6

② 040 SHEET 1 OF 8
GRUNDY

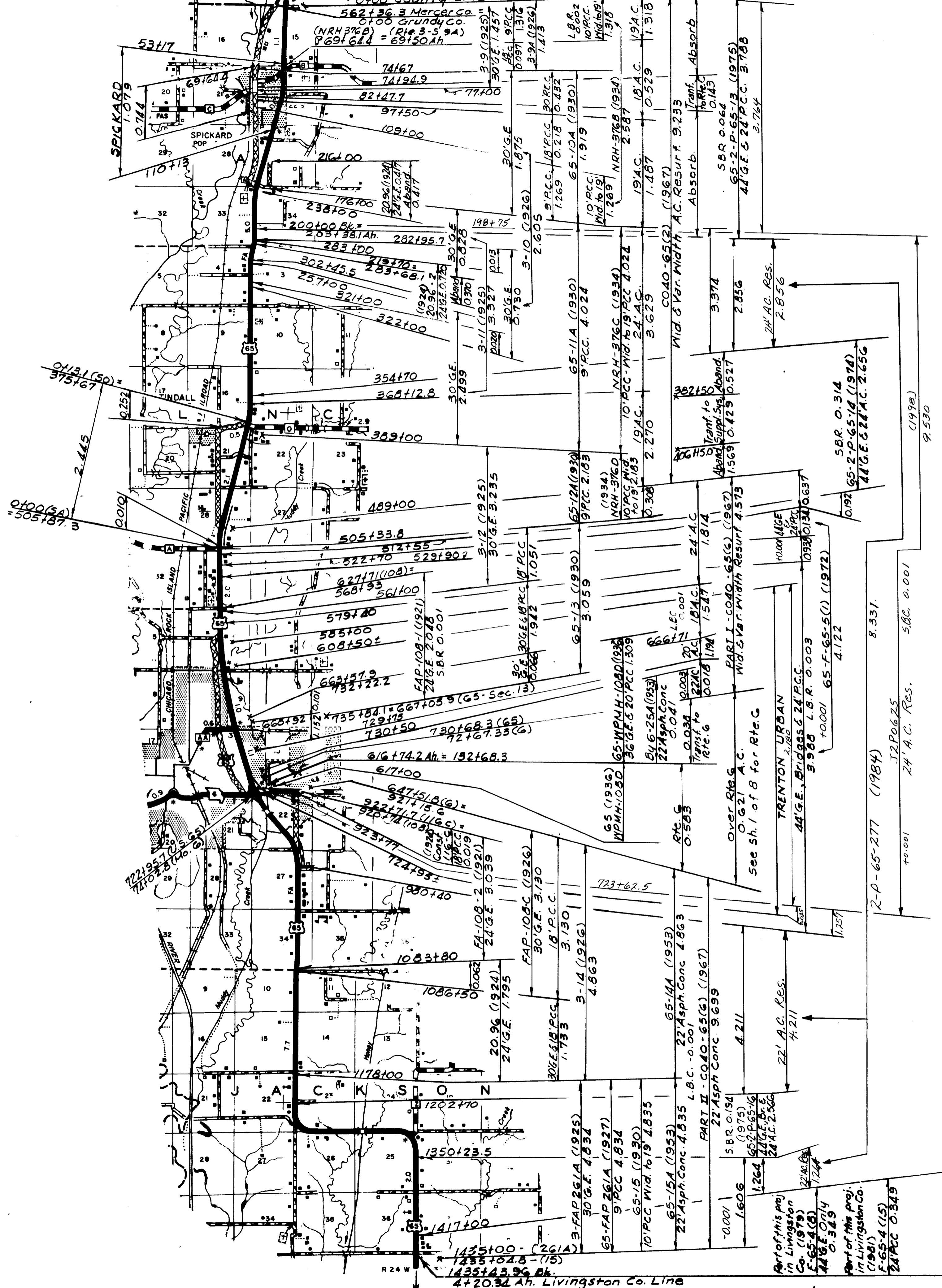

ROUTE
65

② 040 SHEET 2 OF 8
GRUNDY

ON COUNTY

COUNTY

DAVIESS

LINCOLN

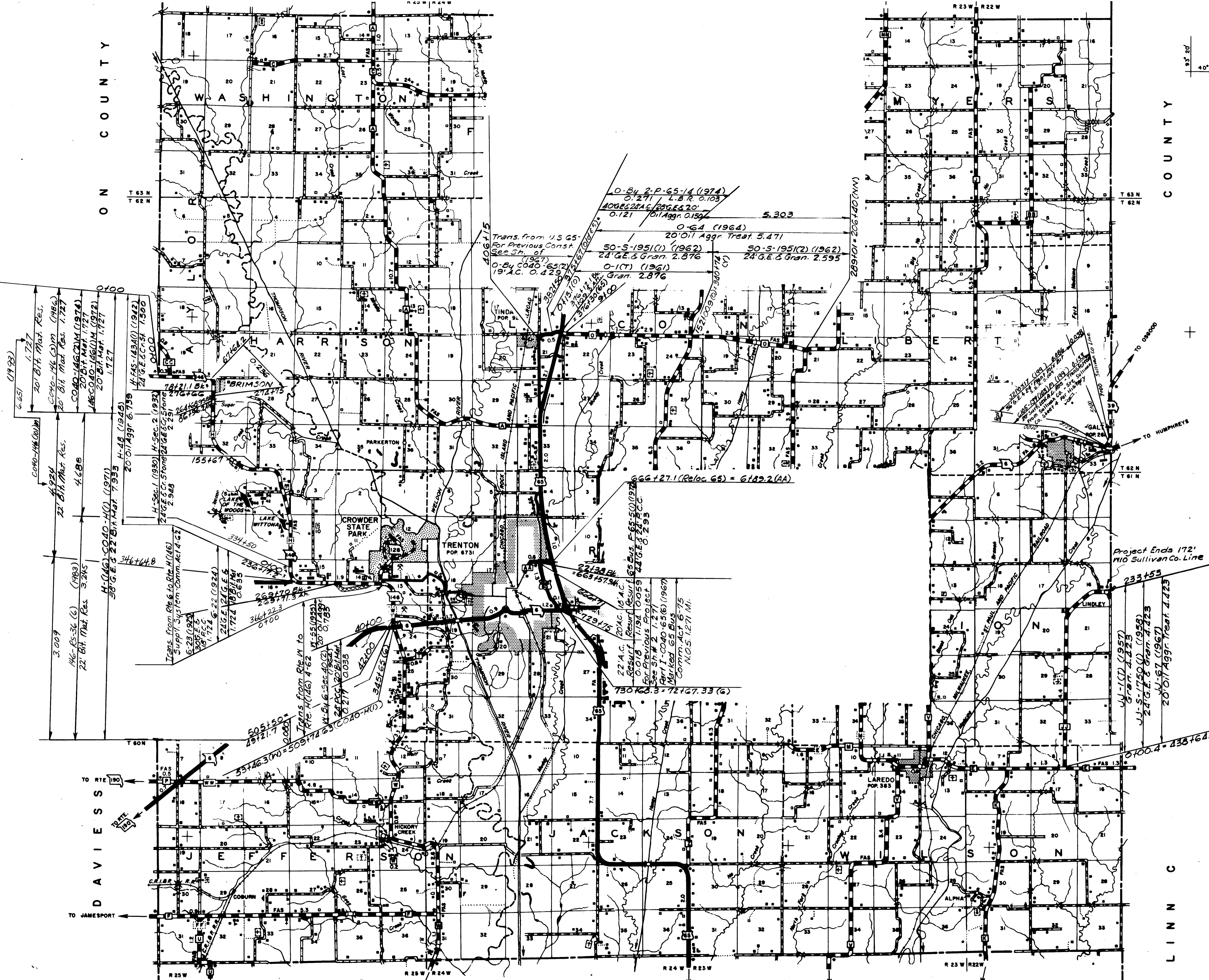

ROUTES
 BUS. 65
 146 (H)
 O
 J
 J
 139

② 040 SHEET 3 OF 8
 GRUNDY

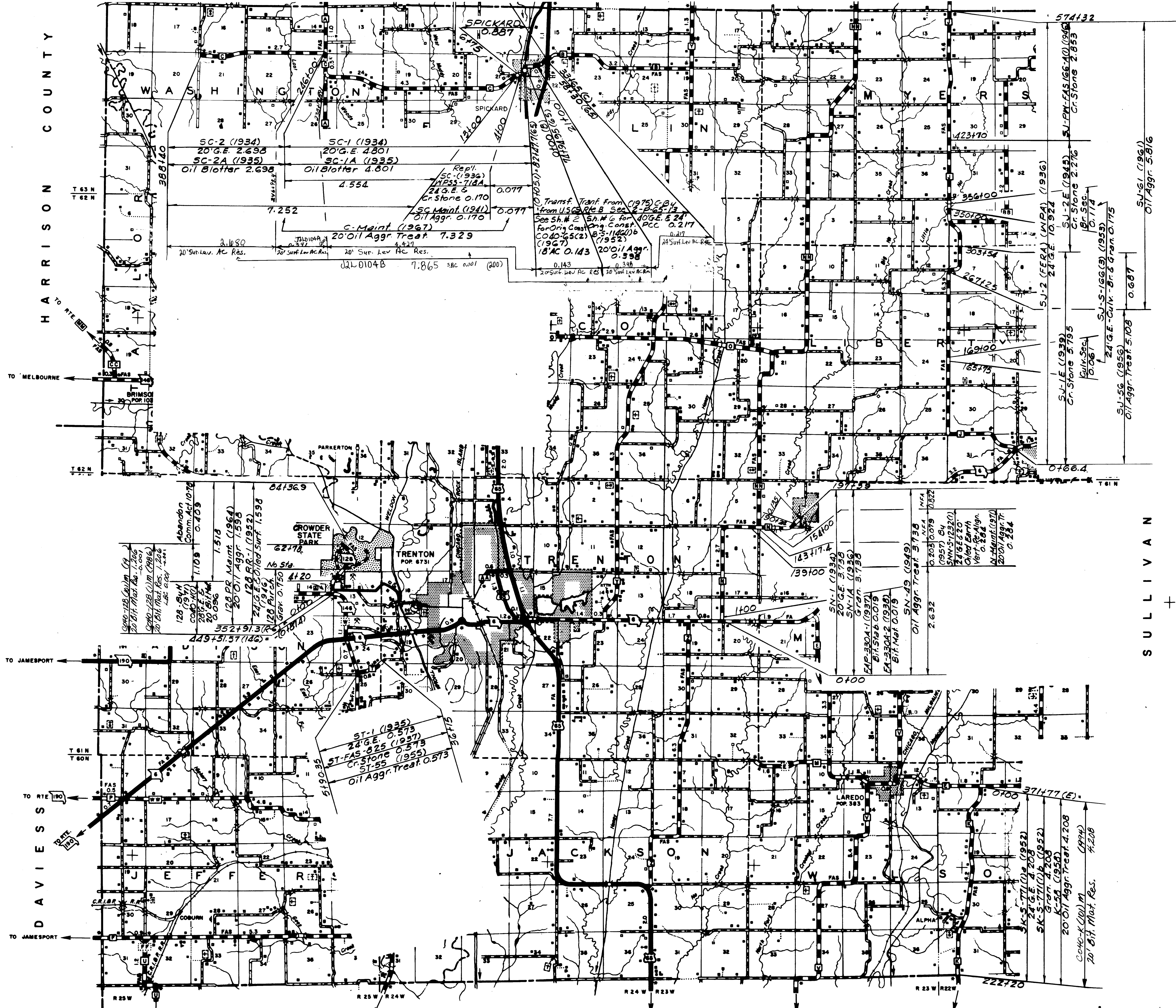

HARRISON COUNTY

DAVIESS

SULLIVAN



ROUTES
128
C
J
K
T

② 040 SHEET 4 OF 8
GRUNDY

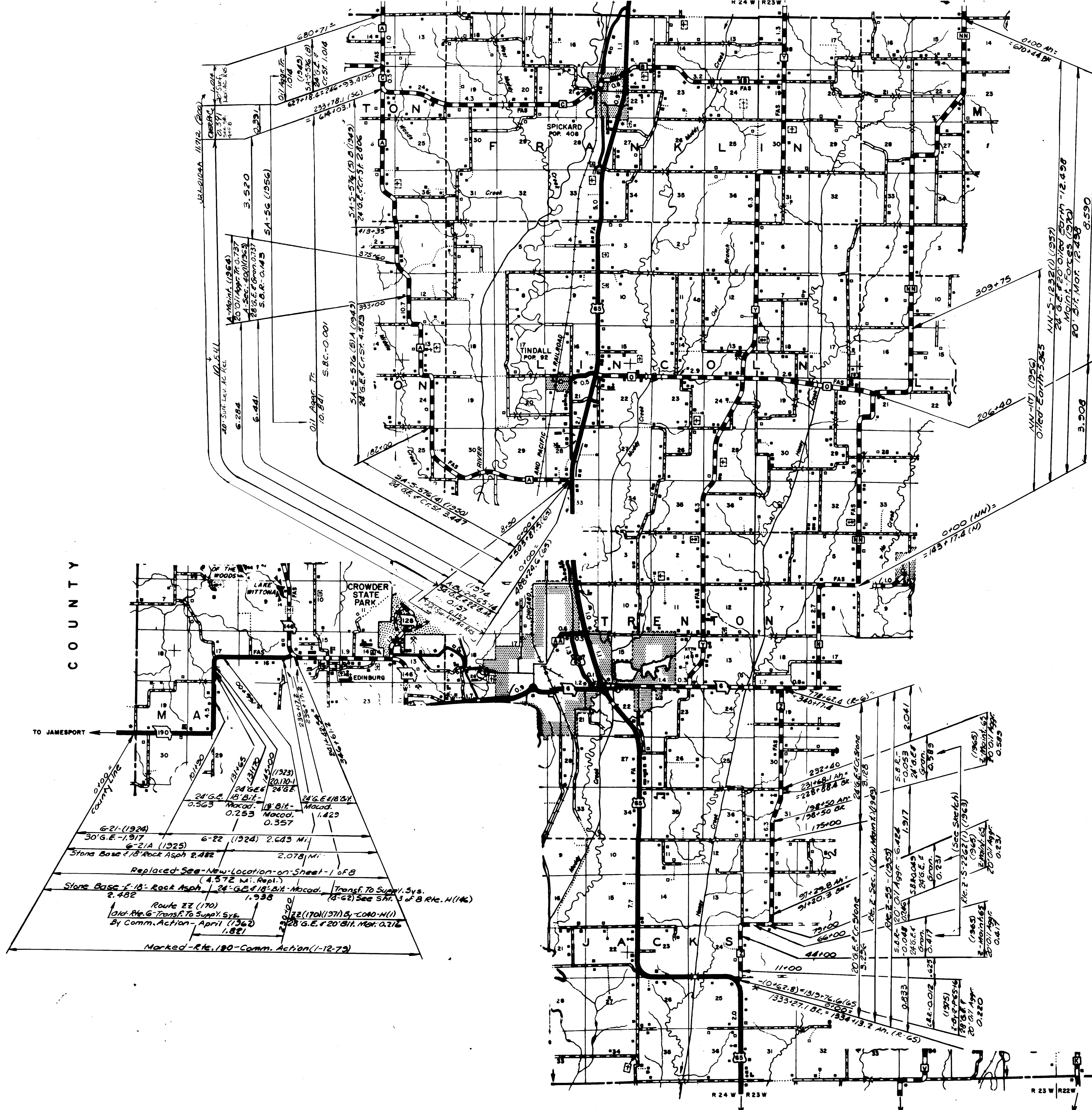

COUNTY

TO JAMESPORT

6-21 (1924)
30' G.E. - 1.917

6-22 (1924) 2.643 MI.
2.078 MI.

6-21A (1925)
Stone Base 7' Rock Asp. 2.482

Replaced See New Location on Sheet 1 of B
(4.572 MI. Repl.)

Stone Base 7' Rock Asp. 2.482
24' G.E. 18' Bit Macad. 1.429
18' Bit Macad. 0.357

Route ZZ (170)
Old Rte. G Transf. to Supp. Sys.
By Comm. Action - April (1962) 1.882

Route ZZ (170) (1971) by CORO-H(1)
28' G.E. & 20' Bit. Mat. 0.716

Marked - Rte. 190 - Comm. Action (1-12-79)

ROUTE :
190 (ZZ)
A
Z
NN

② 040 SHEET 5 OF 8
GRUNDY

117

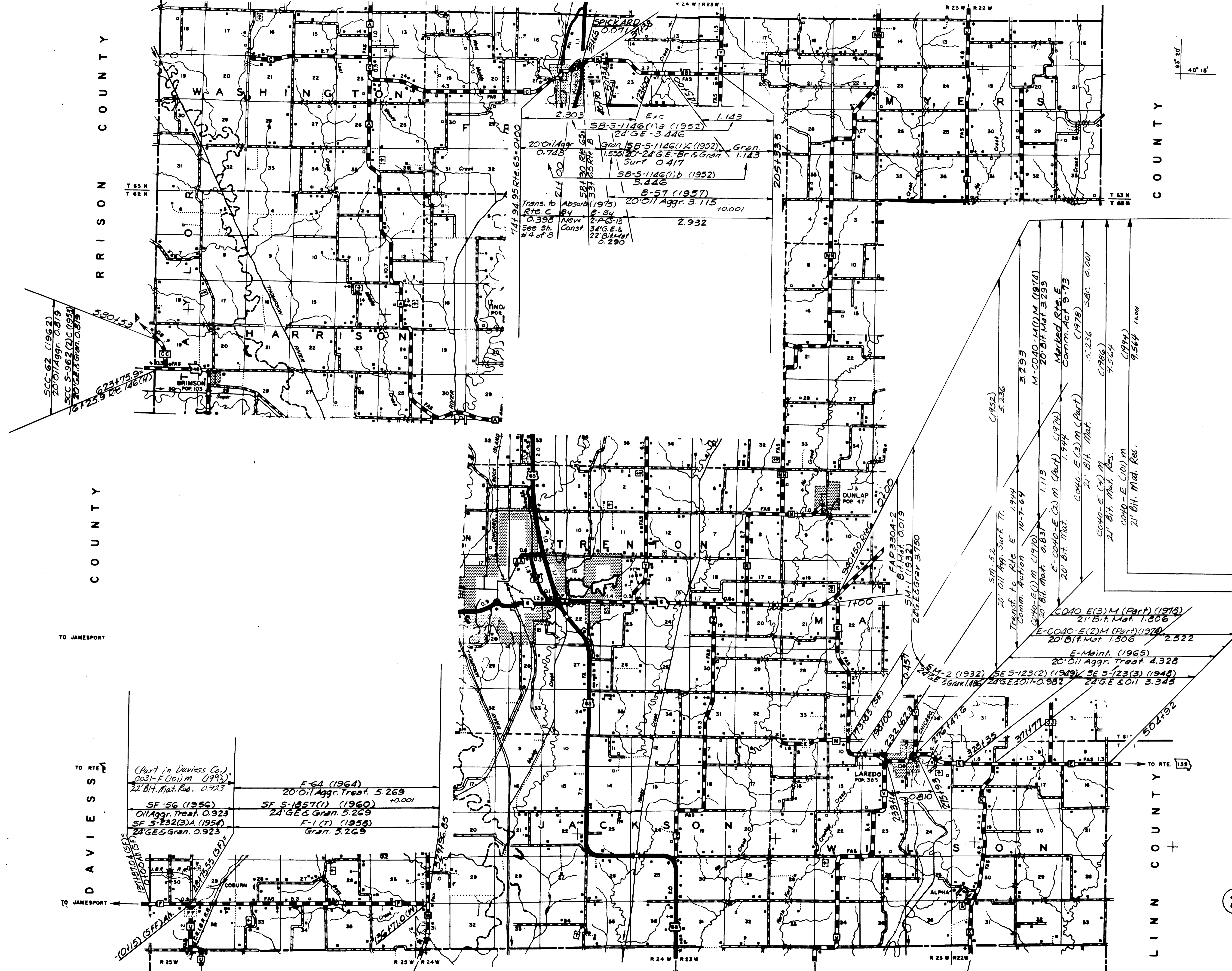

R R I S O N C O U N T Y
 W A S H I N G T O N
 H A R R I S O N
 C O U N T Y
 L I N N C O U N T Y
 D A V I E S S
 L I N N C O U N T Y

ROUTES
 B
 E
 F
 C
 C
 ② 040 SHEET 6 OF 8
 GRUNDY

SCC-62 (1962)
 20' Oil Aggr. Treat. 0.819
 SCC 5-962(2)C (1953)
 20' Oil Aggr. Treat. 0.819

(Part in Daviess Co.)
 2031-F(1)M (1913)
 22' Bit. Mat. Res. 0.923
 SF-56 (1956)
 Oil Aggr. Treat. 0.923
 SF 5-232(3)A (1954)
 24' G.E.S. Gran. 0.923

F-64 (1964)
 20' Oil Aggr. Treat. 5.269
 +0.001
 SF 5-1257(1) (1960)
 24' G.E.S. Gran. 5.269
 F-1 (T) (1958)
 Gran. 3.269

SPICKARD
 0.07
 2.303
 E.C.
 1.143
 SB-S-1146(1)a (1952)
 24' G.E.-3.446
 Gran SB-S-1146(1)c (1952)
 1555' 20'-24' G.E.-Br & Gran. 1.143
 Surf. 0.417
 SB-S-1146(1)b (1952)
 3.446
 B-57 (1957)
 20' Oil Aggr. 3.115
 +0.001
 2.932
 Trans. to Rte. C
 0.398
 See Sh. #4 of 8
 Absorb. (1975)
 B-By
 2-P.C.S-13
 34' G.E.E
 22' Bit. Mat.
 0.290

SM-52 (1952)
 20' Oil Aggr. Surf. Tr.
 Comm. Act. 10-7-64
 3.293
 M-CO40-M(1)M (1974)
 20' Bit. Mat. 3.293
 Marked Rte. E
 Comm. Act. 9-73
 (1978)
 5.236
 SEC 0.001
 (1986)
 9.564
 (1994)
 9.564
 44.009
 CO40-E(3)M (Part) (1974)
 21' Bit. Mat. 1.806
 E-CO40-E(2)M (Part) (1974)
 20' Bit. Mat. 1.806
 2.522
 E-Maint. (1965)
 20' Oil Aggr. Treat. 4.328
 SE 5-123(2) (1969) / SE 5-123(3) (1949)
 24' G.E. 2011-0.982 / 24' G.E. & Oil 3.345

TO JAMESPORT

TO RTE. 139

TO RTE. 139

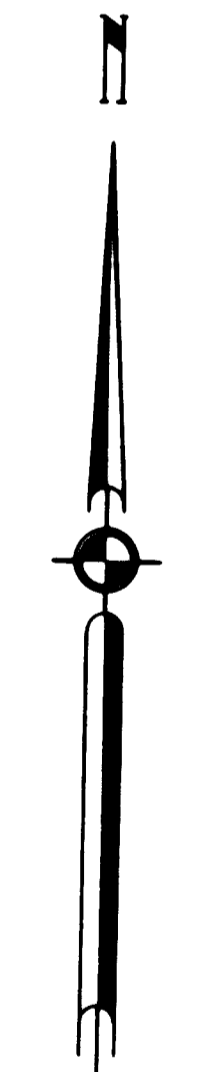

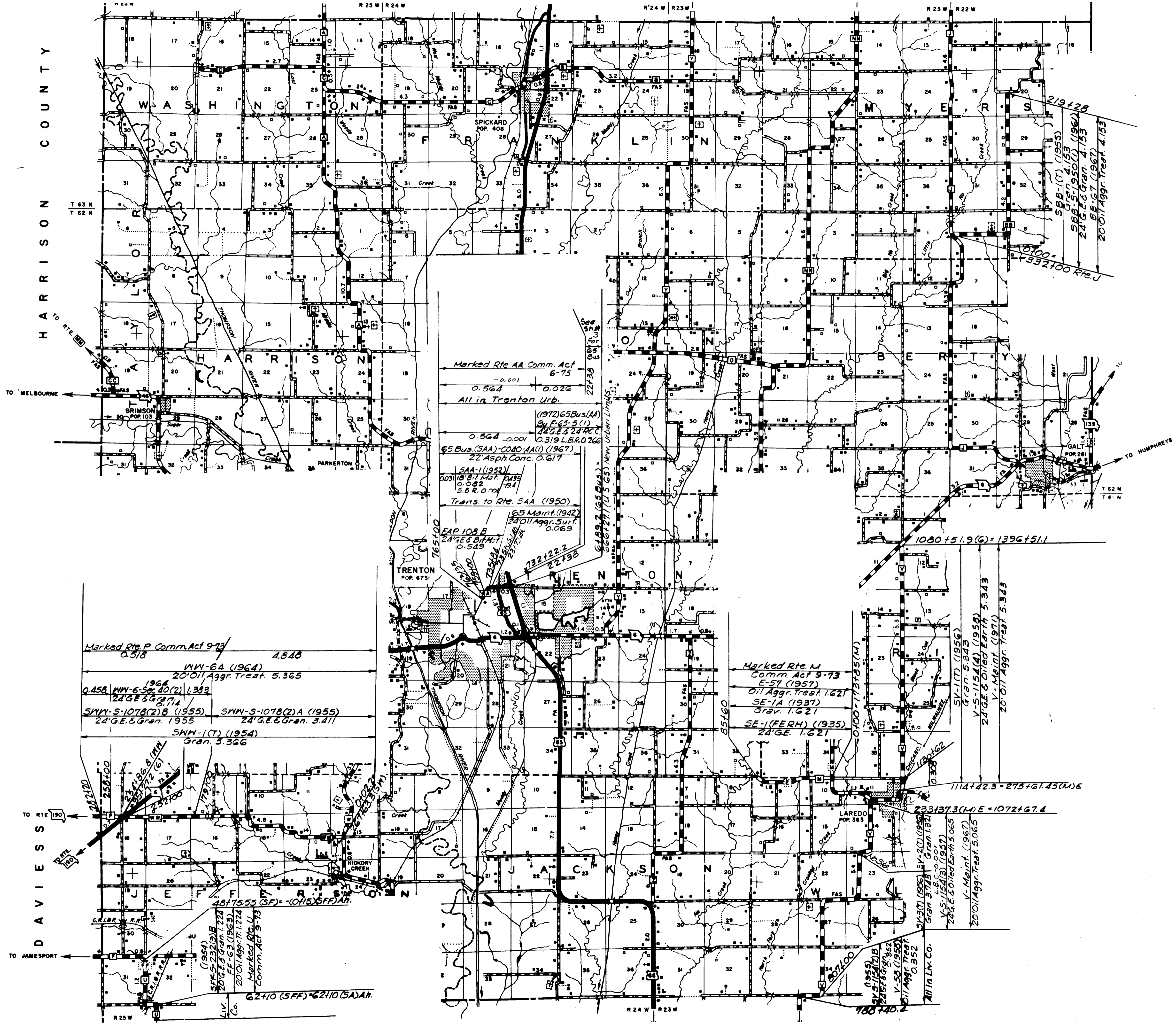

ROUTES
 M
 P
 U
 V
 AA
 BB
 WW

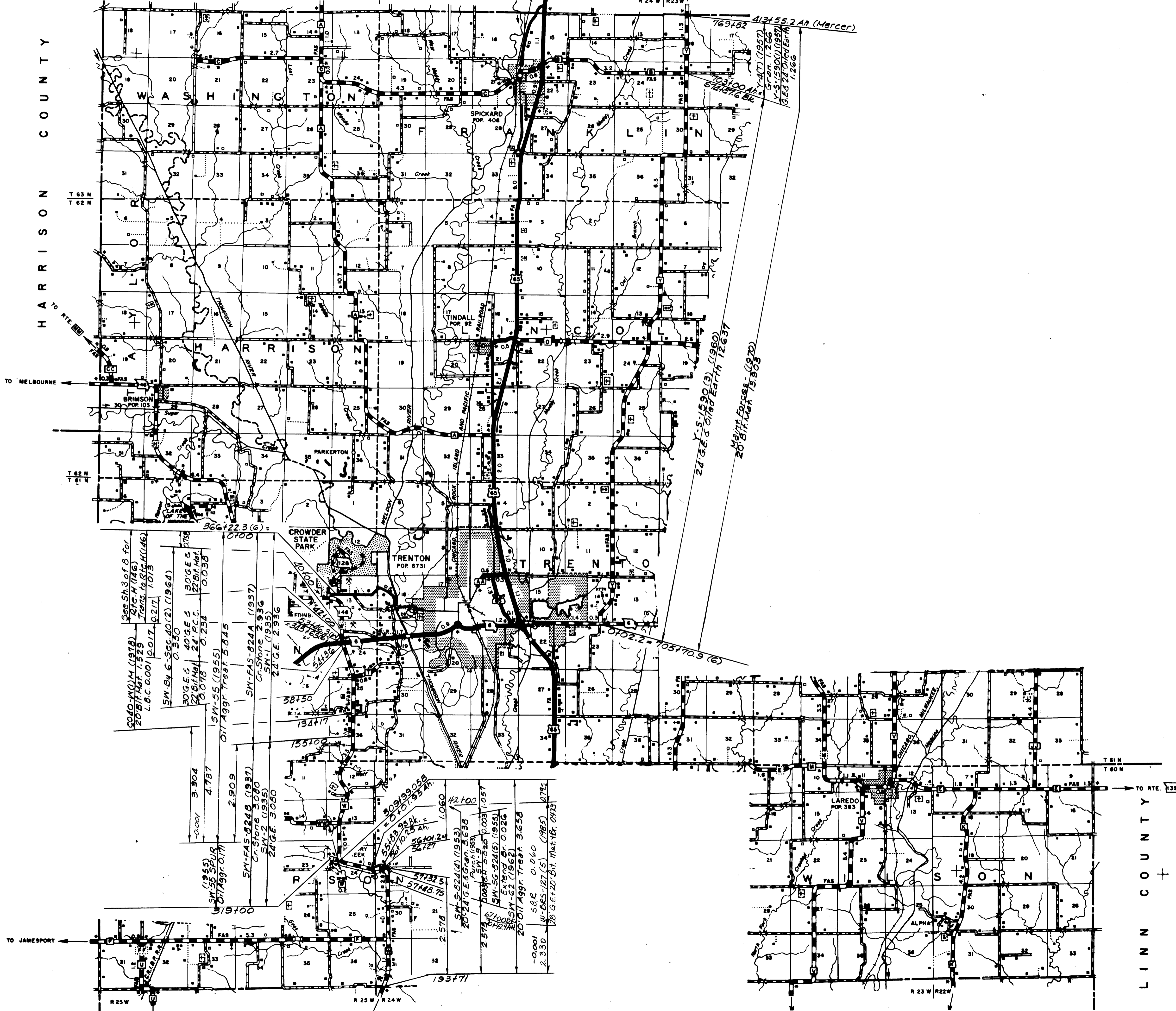

HARRISON COUNTY

TO MELBOURNE

TO JAMESPORT

TO RTE. 135
LINCOLN COUNTY



ROUTES
W
W SPUR
Y

② 040 SHEET 8 OF 8
GRUNDY