

ROUTE - 7

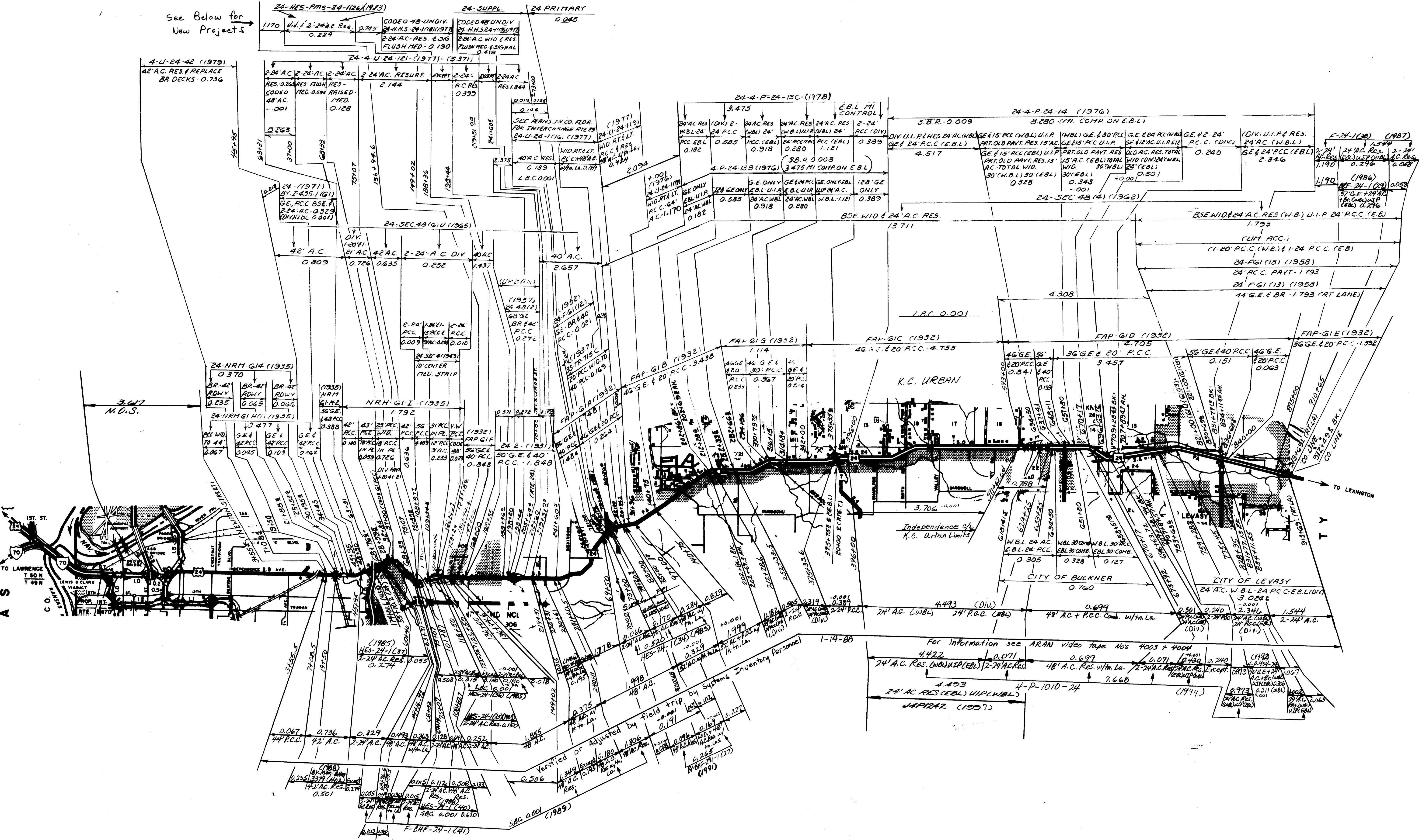

See Below for  
New Projects



ROUTES:  
24



**KANSAS CITY**  
 POP. 448,159  
 JACKSON CO. 371,901  
 PLATTE CO. 15,984  
 CLAY CO. 60,574

**LEE'S SUMMIT**  
 POP. 28,741  
 JACKSON CO. 28,681  
 CASS CO. 50

**ROUTES**  
 29  
 50 (PART)  
 350 (PART)  
 0  
 FF

④  
**048** SHEET 4 OF 21  
**JACKSON**

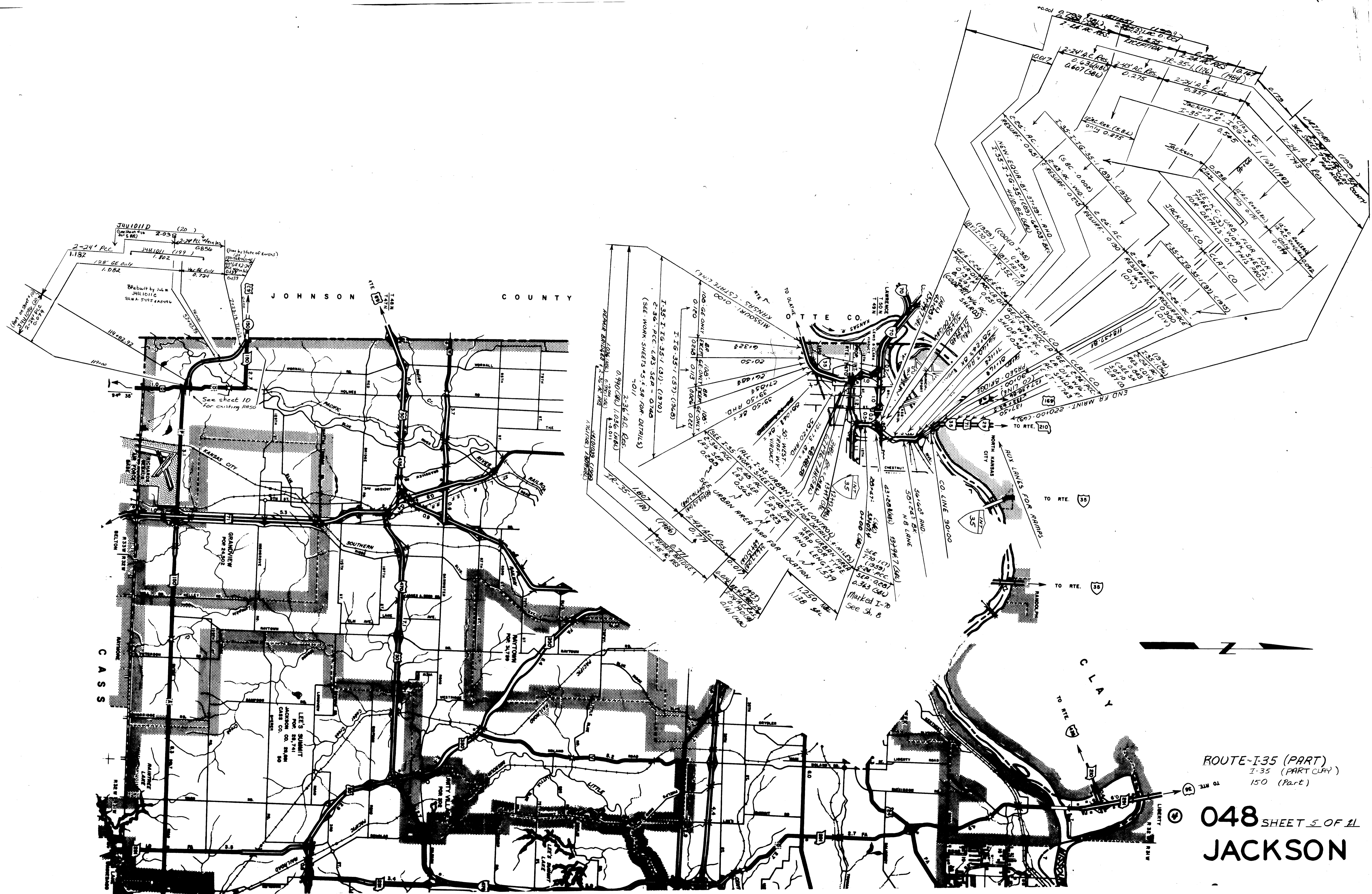

JOHNSON COUNTY

CASS

ROUTE-I-35 (PART)  
I-35 (PART CLAY)  
150 (PART)

048 SHEET 5 OF 21  
JACKSON

KANSAS

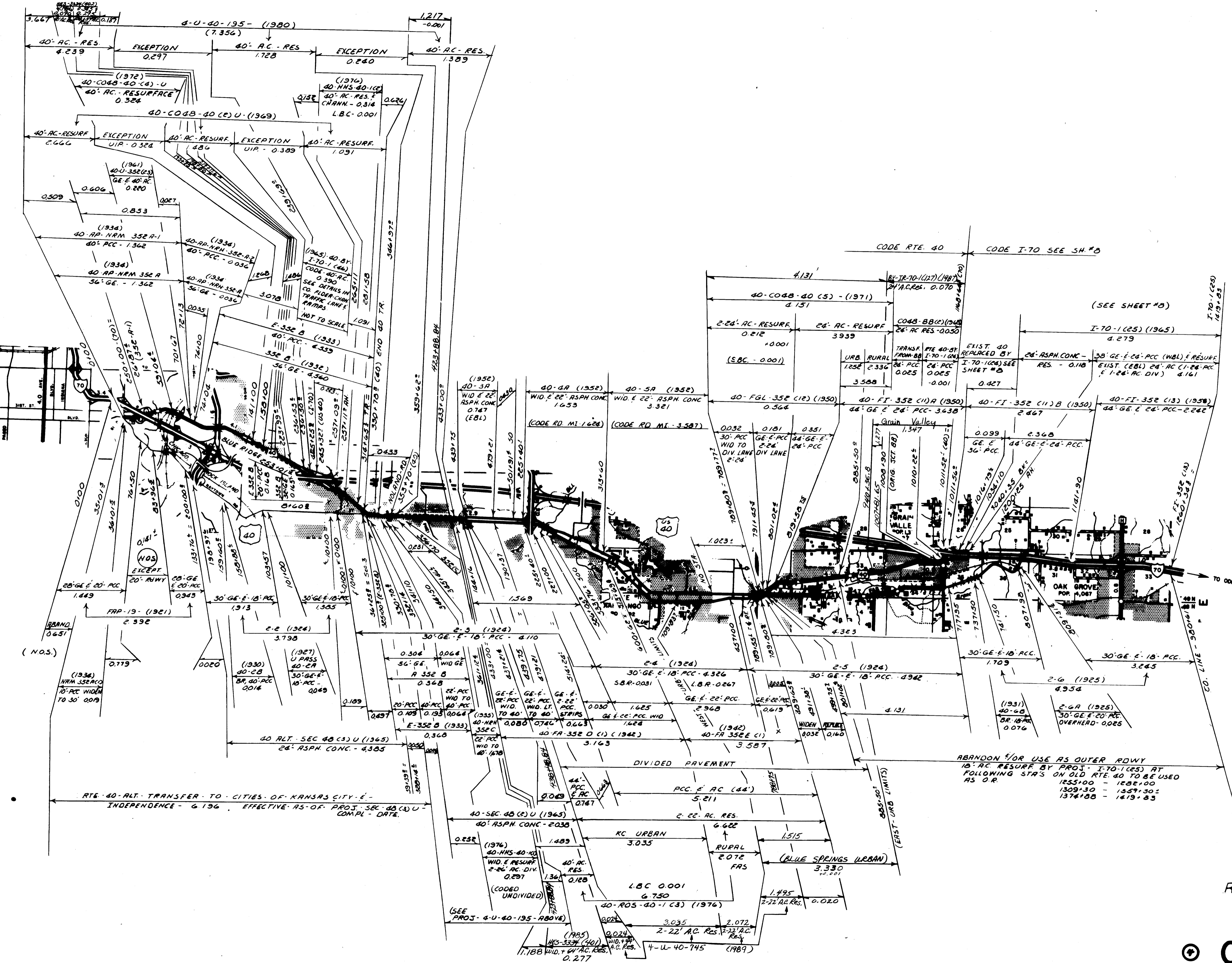
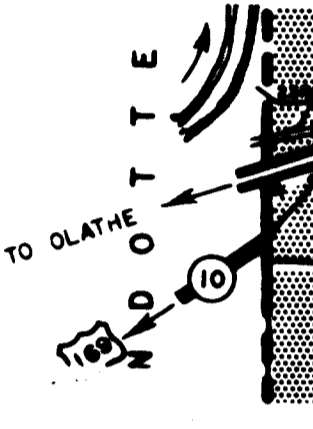

RTe 40-ALT. TRANSFER TO CITIES OF KANSAS CITY & INDEPENDENCE - 6/196. EFFECTIVE AS OF PROJ. SEC. 40 (C) U - COMPL. DATE.

ABANDON FOR USE AS OUTER ROW BY 18' AC RESURF BY PROJ. I-70-1(25) AT FOLLOWING STA'S ON OLD RTE. 40 TO BE USED AS O.R.  
1255+00 - 1282+00  
1309+30 - 1357+30  
1374+00 - 1419+85

ROUTE - 40 History

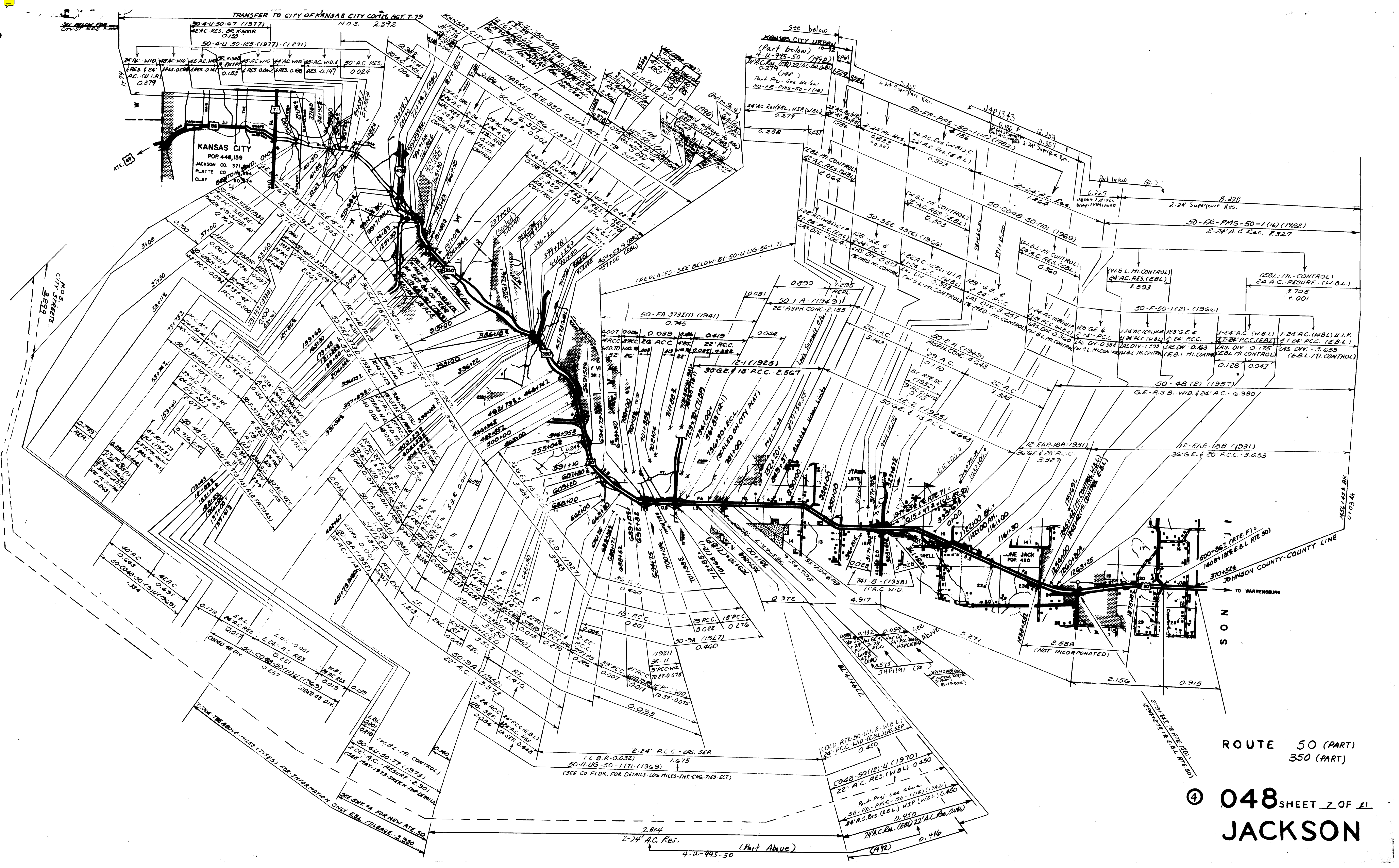

ROUTE 50 (PART)  
350 (PART)

④ 048 SHEET 7 OF 21  
JACKSON

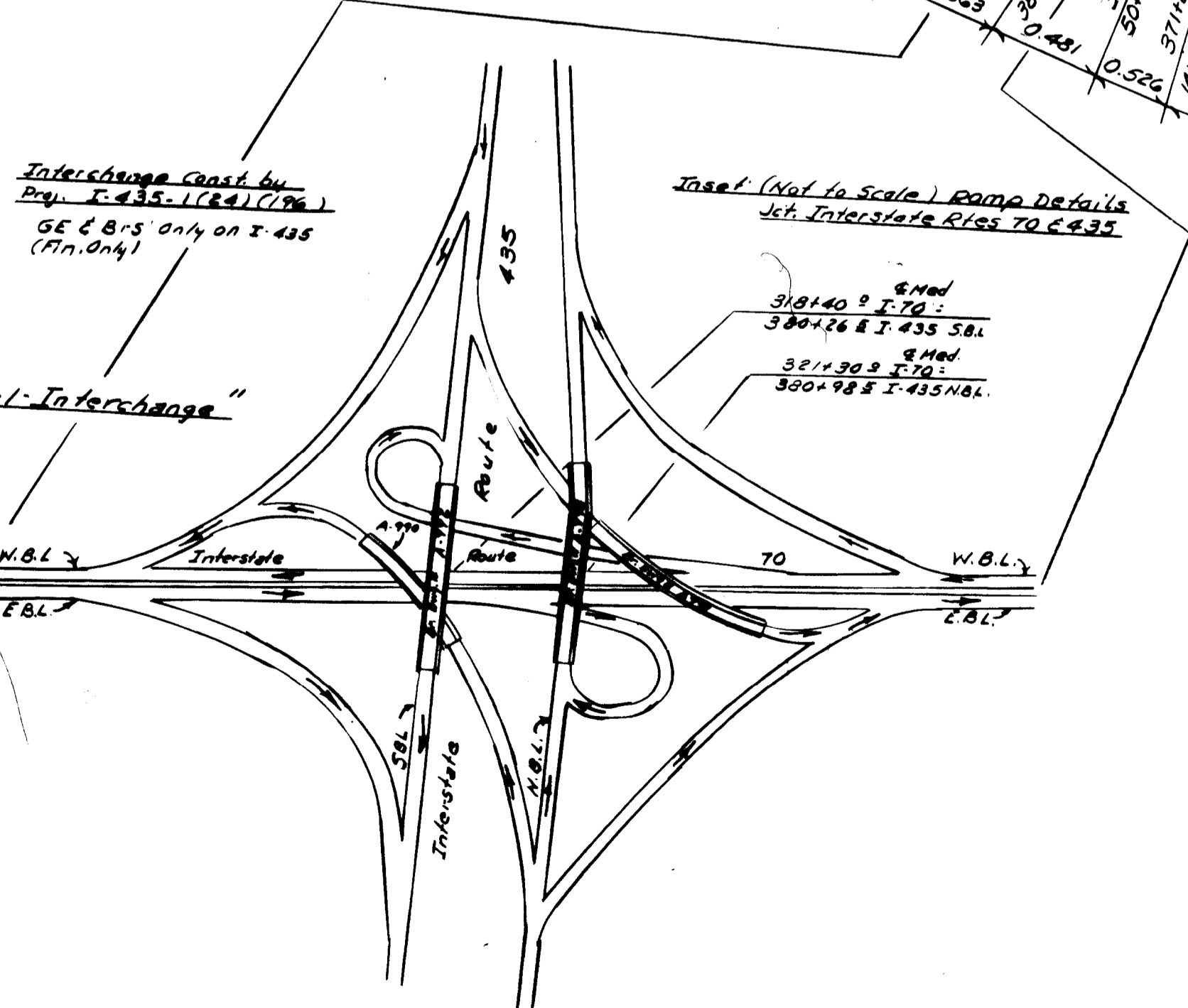
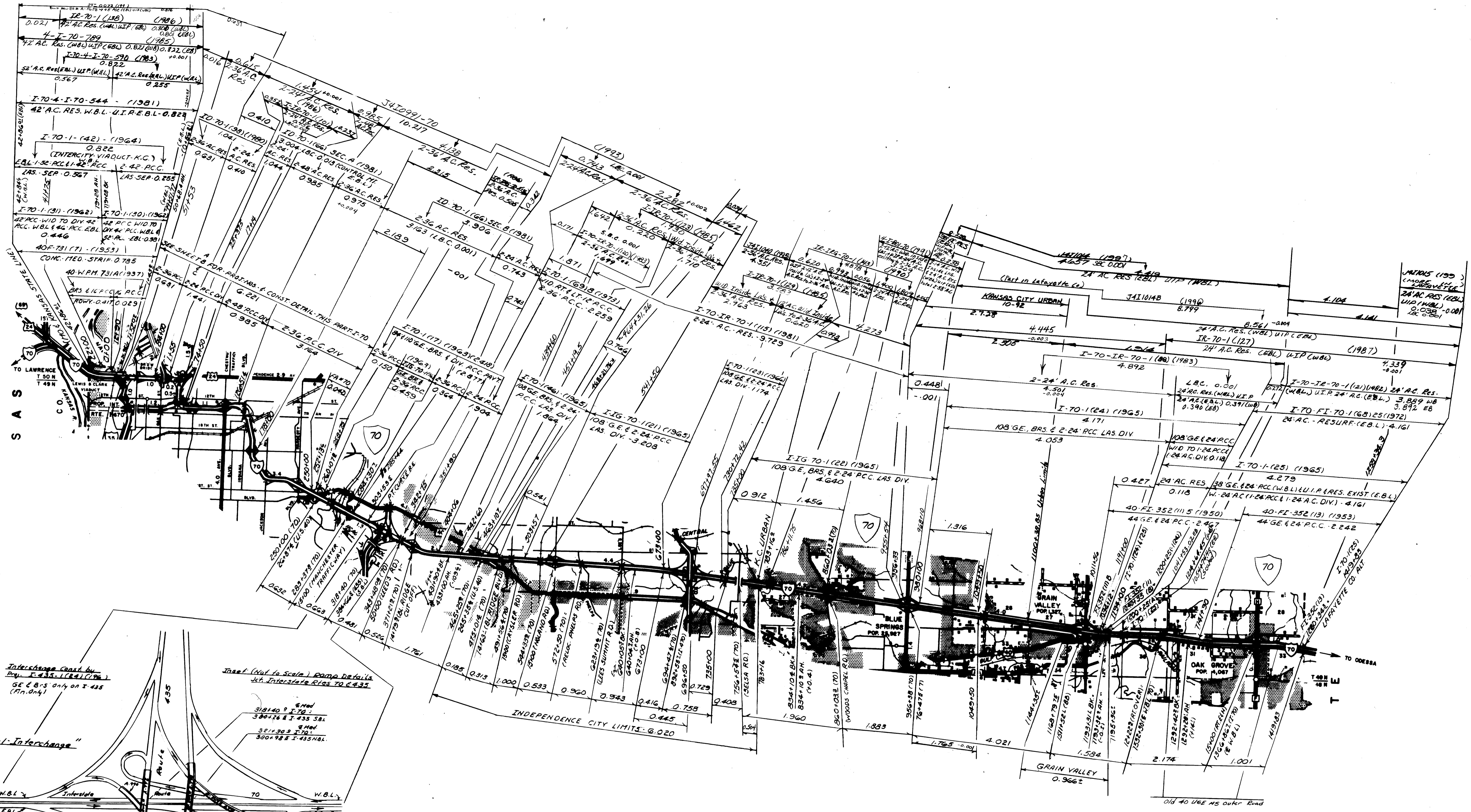

ROUTE 70

JACKSON CO. - 048

SHEET 8 OF 11

4



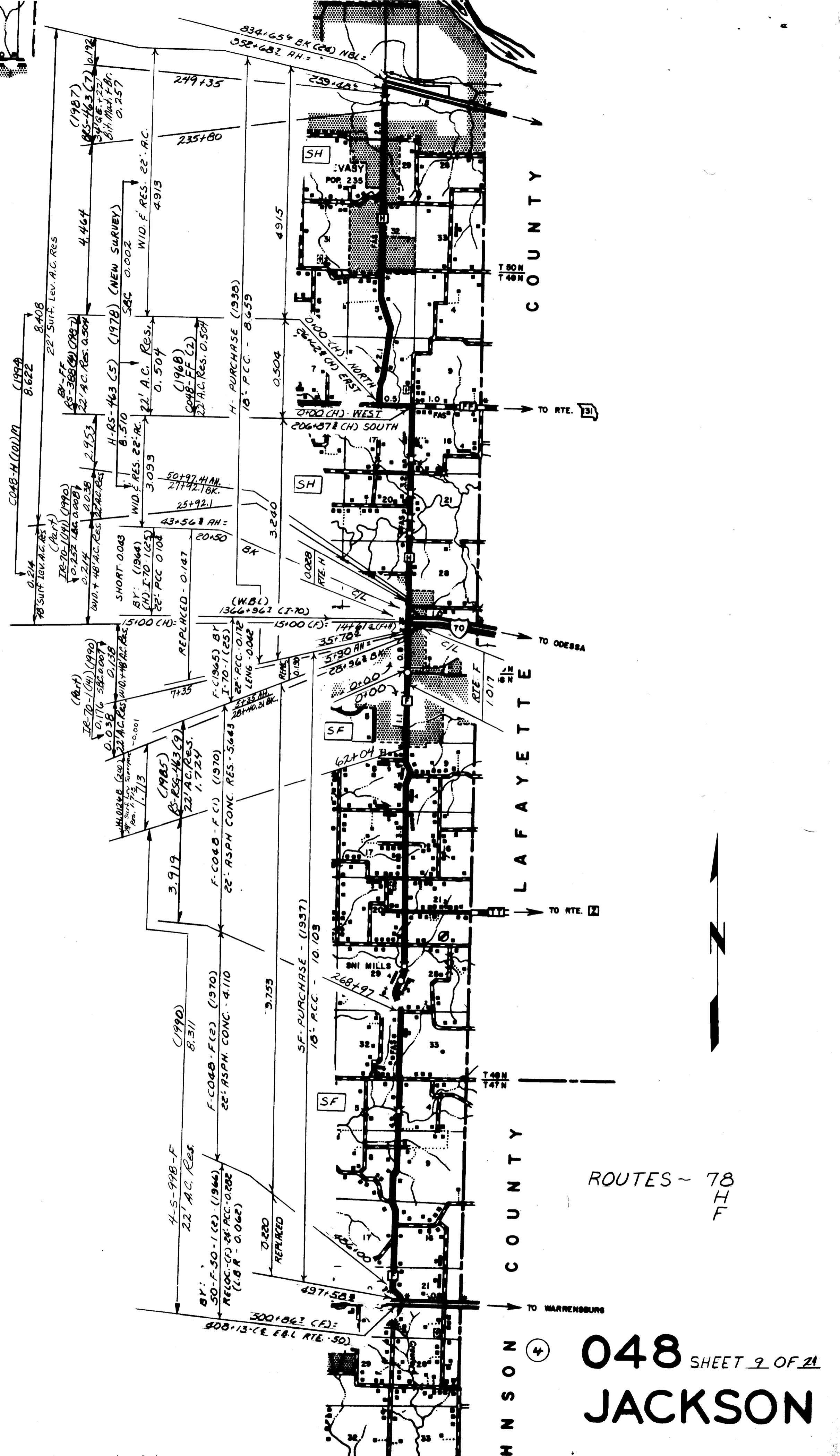
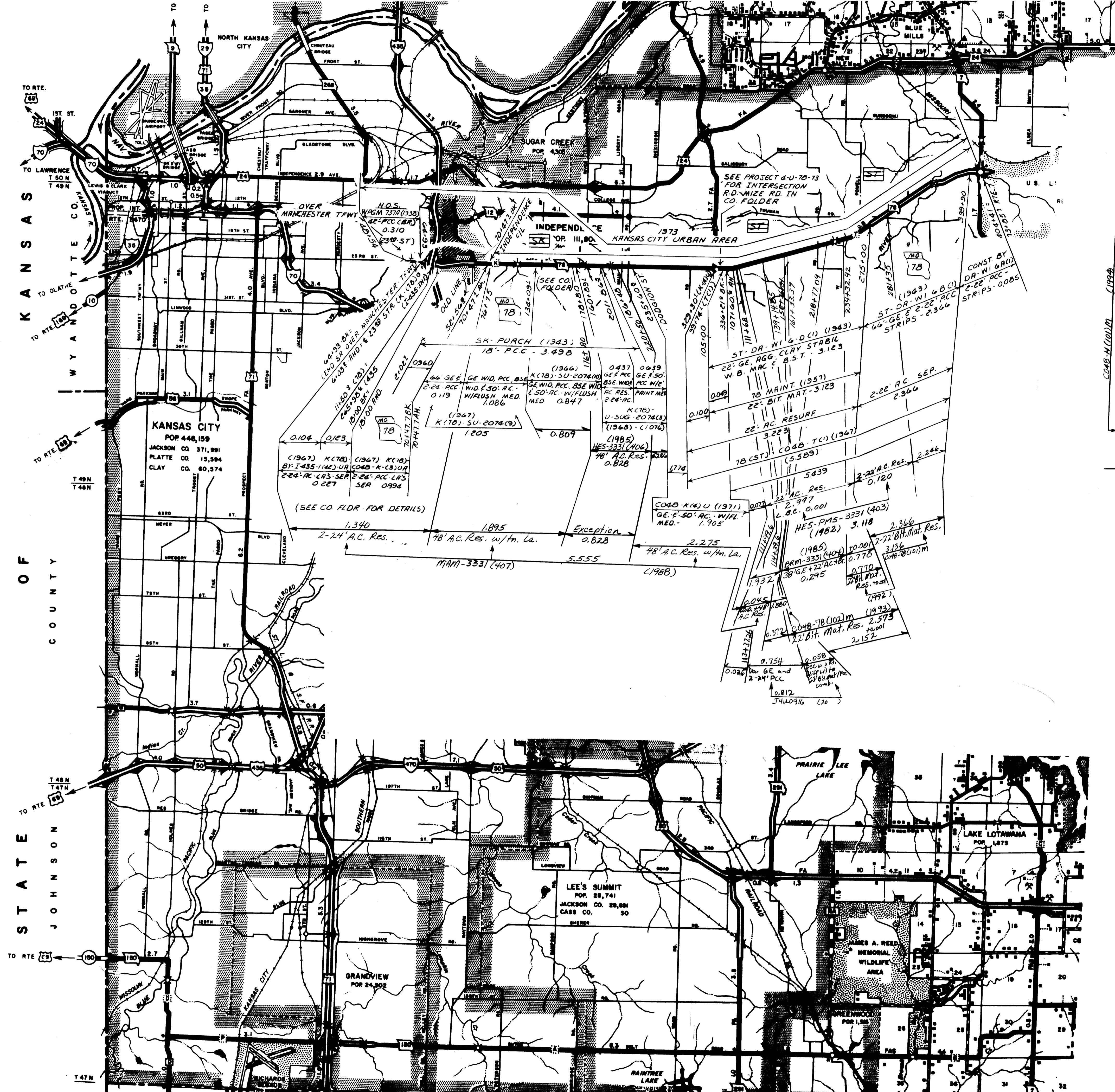

ROUTES - 78  
 H  
 F

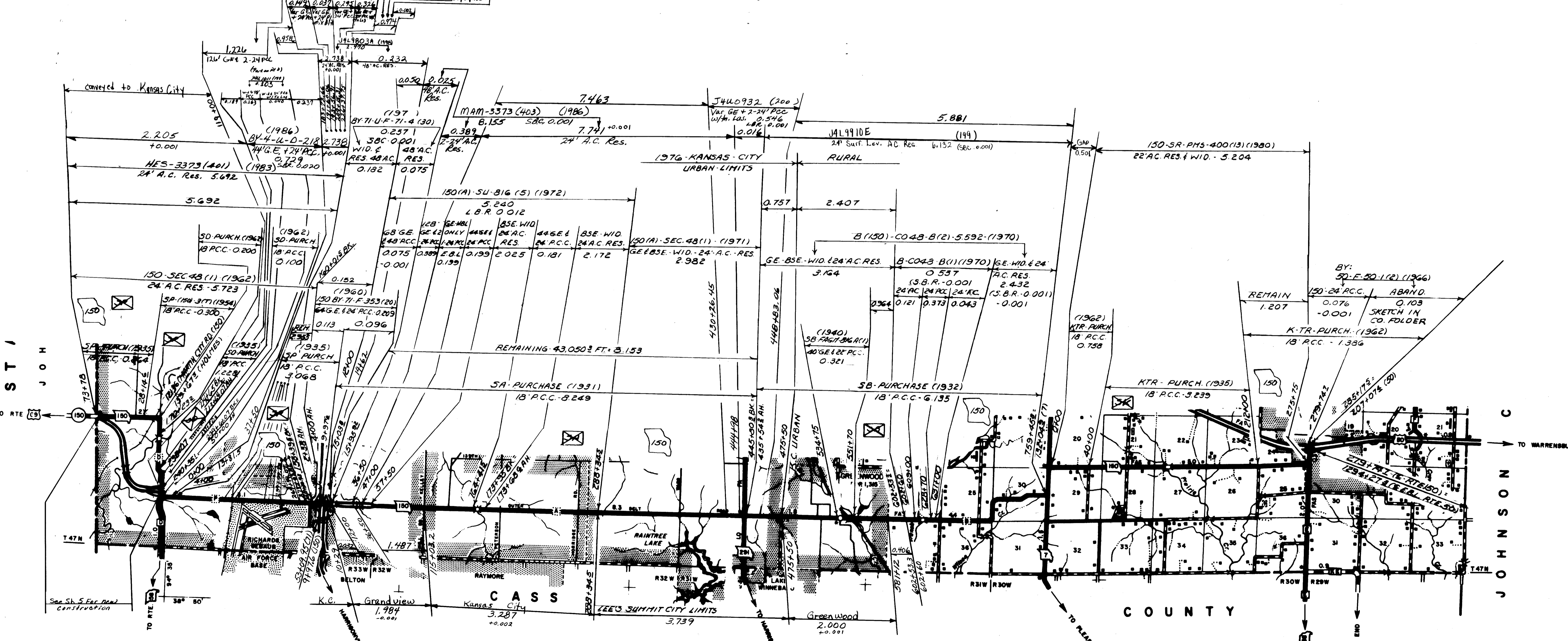
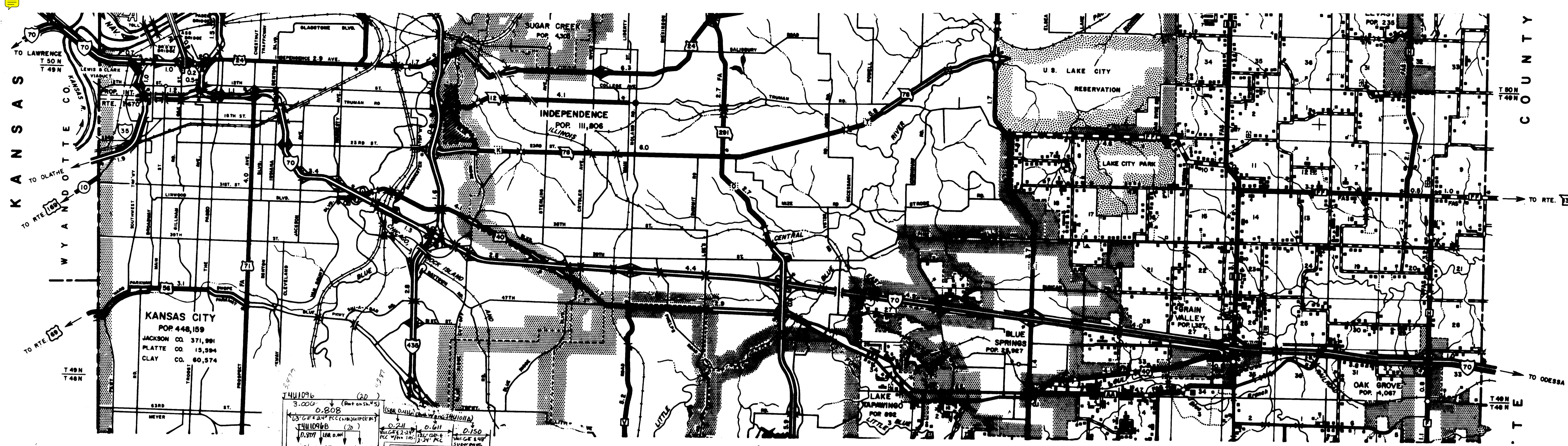

ROUTE  
150 (A-B-D-K-P)  
(Part)

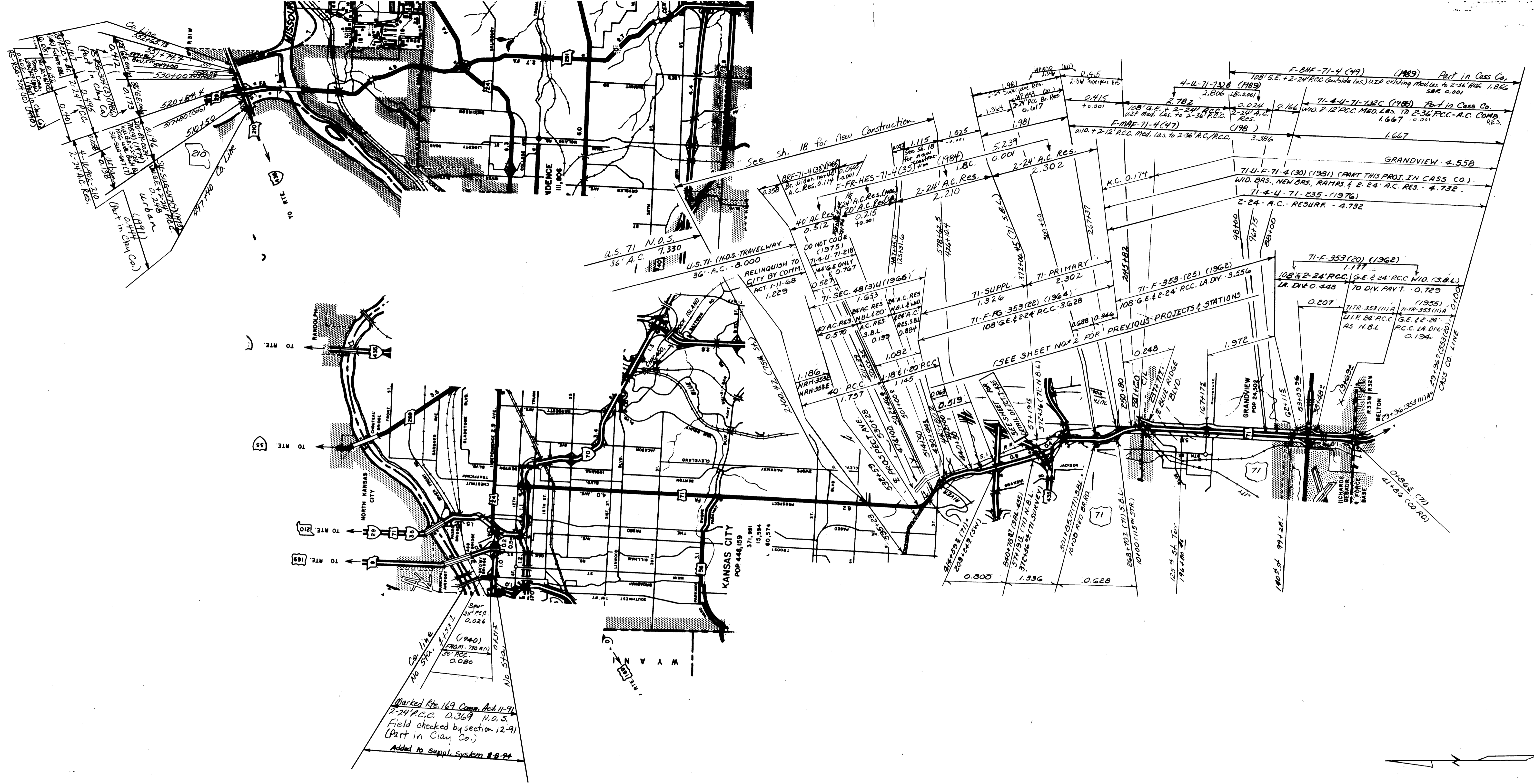

ROUTES - 210  
(PART) 71 (SEE SH. 2 FOR PREVIOUS  
PROJ.)  
169

④  
**048** SHEET 11 OF 11  
**JACKSON**

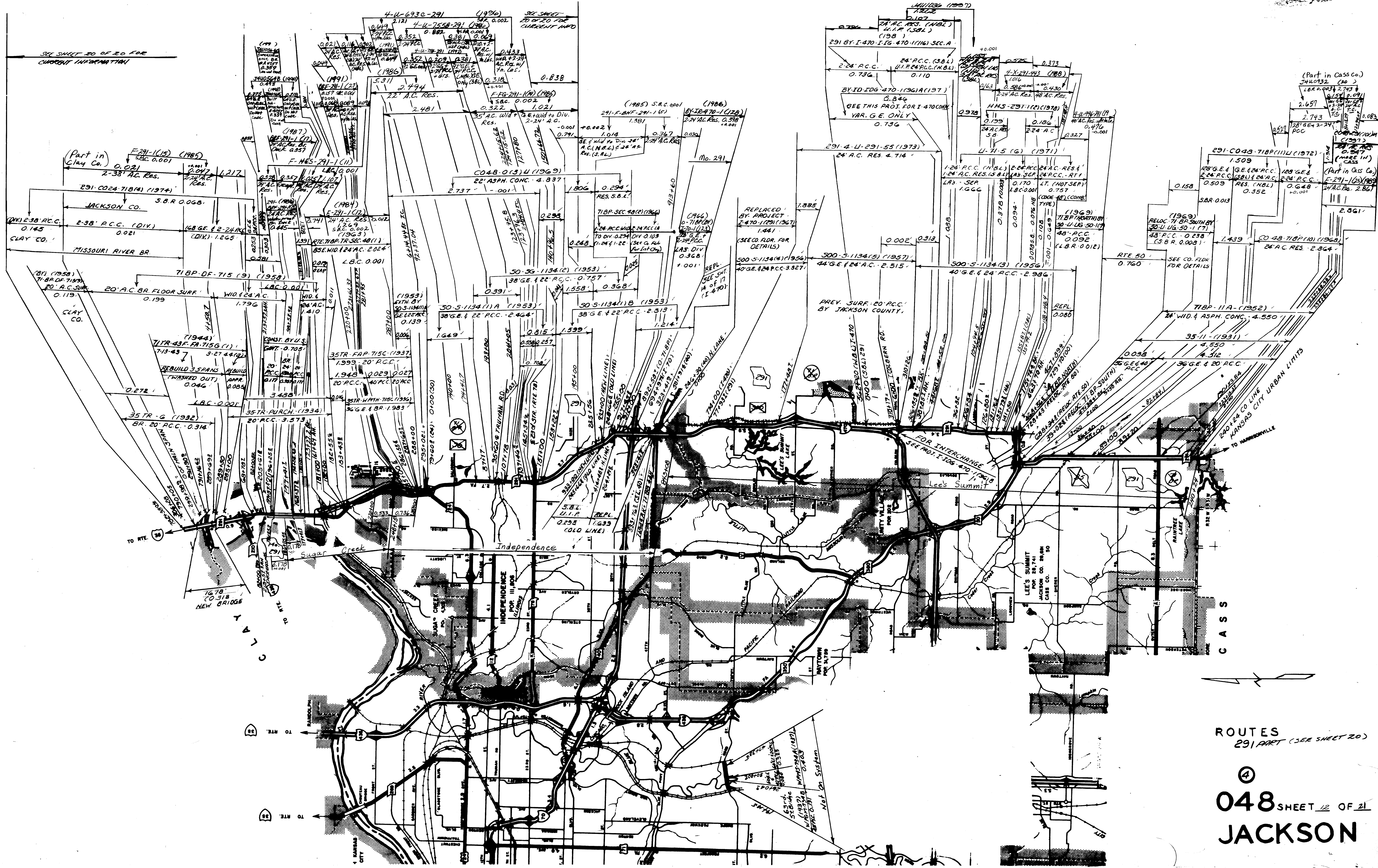

SEE SHEET 20 OF 20 FOR  
CURRENT INFORMATION

(Part in  
Clay Co.)  
E-291-1(15) (1985)  
S.B.C. 0.001  
2-38' AC. Res.

JACKSON CO.  
E-38' P.C.C. (DIV.)  
0.021  
MISSOURI RIVER BR

CLAY CO.  
71BP-DF-715 (9) (1958)  
20' AC. BR. FLOOR SURF.  
0.199

CLAY CO.  
71-8R-DF-715(9)  
20' AC. SURF.  
0.119

CLAY CO.  
71TR-43F-FA-715G (1)  
7-13-43  
3-27-44(12)

CLAY CO.  
35TR-G (1932)  
BR. 20' P.C.C. 0.314

CLAY CO.  
35TR-PURCH. (1934)  
20' P.C.C. 3.573

CLAY CO.  
35TR-WATH-715C (1936)  
36' GE & BR. 1.983

CLAY CO.  
35TR-FA-715C (1937)  
1.999 20' P.C.C.

CLAY CO.  
35TR-WATH-715C (1936)  
36' GE & BR. 1.983

CLAY CO.  
35TR-PURCH. (1934)  
20' P.C.C. 3.573

CLAY CO.  
35TR-WATH-715C (1936)  
36' GE & BR. 1.983

CLAY CO.  
35TR-FA-715C (1937)  
1.999 20' P.C.C.

CLAY CO.  
35TR-WATH-715C (1936)  
36' GE & BR. 1.983

CLAY CO.  
35TR-PURCH. (1934)  
20' P.C.C. 3.573

CLAY CO.  
35TR-WATH-715C (1936)  
36' GE & BR. 1.983

CLAY CO.  
35TR-FA-715C (1937)  
1.999 20' P.C.C.

CLAY CO.  
35TR-WATH-715C (1936)  
36' GE & BR. 1.983

CLAY CO.  
35TR-PURCH. (1934)  
20' P.C.C. 3.573

CLAY CO.  
35TR-WATH-715C (1936)  
36' GE & BR. 1.983

CLAY CO.  
35TR-FA-715C (1937)  
1.999 20' P.C.C.

CLAY CO.  
35TR-WATH-715C (1936)  
36' GE & BR. 1.983

CLAY CO.  
35TR-PURCH. (1934)  
20' P.C.C. 3.573

CLAY CO.  
35TR-WATH-715C (1936)  
36' GE & BR. 1.983

CLAY CO.  
35TR-FA-715C (1937)  
1.999 20' P.C.C.

CLAY CO.  
35TR-WATH-715C (1936)  
36' GE & BR. 1.983

CLAY CO.  
35TR-PURCH. (1934)  
20' P.C.C. 3.573

ROUTES  
291 PART (SEE SHEET 20)

④  
048 SHEET 12 OF 21  
JACKSON

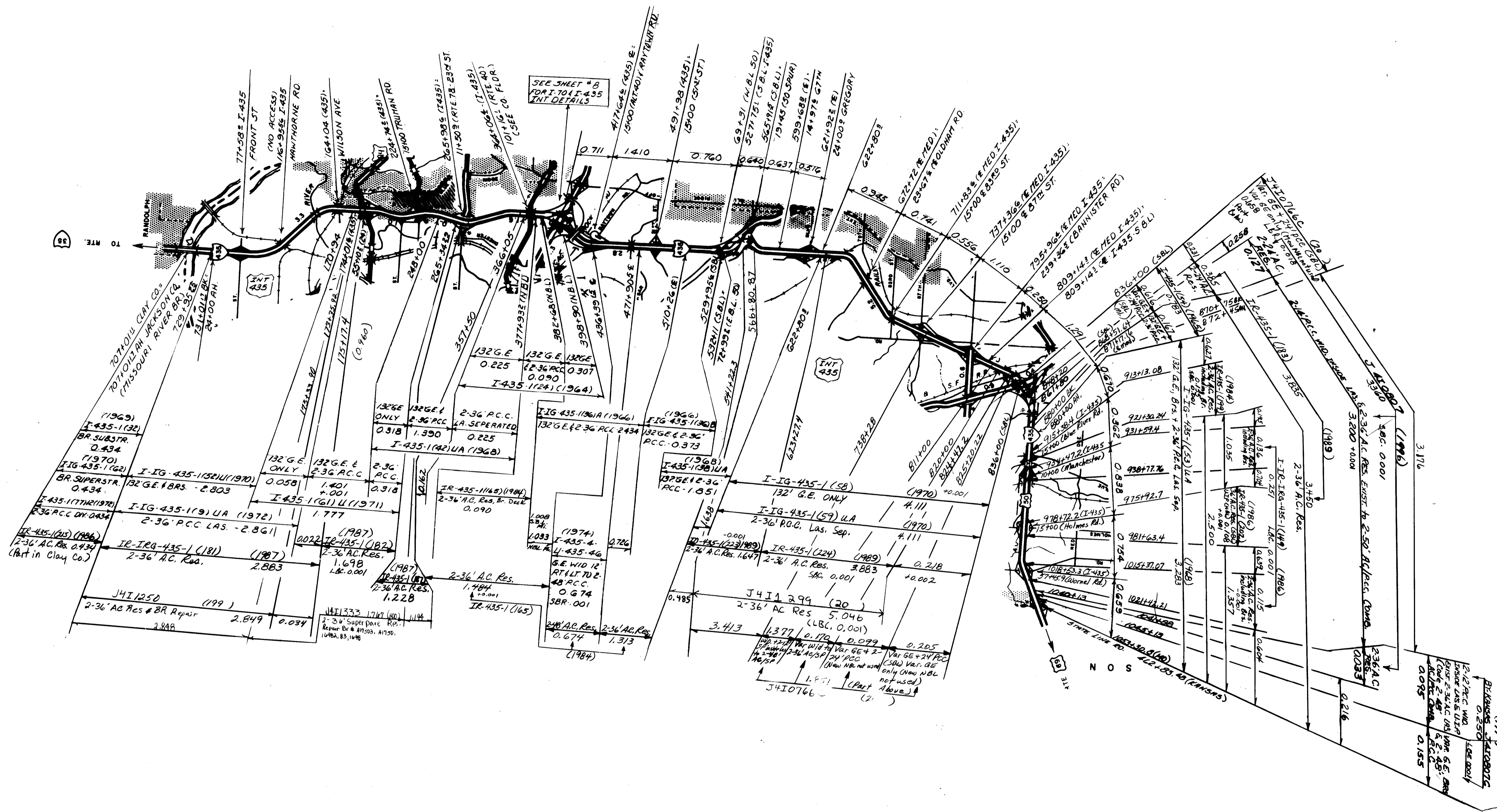

ROUTE:  
I-435

④ 048  
JACKSON COUNTY

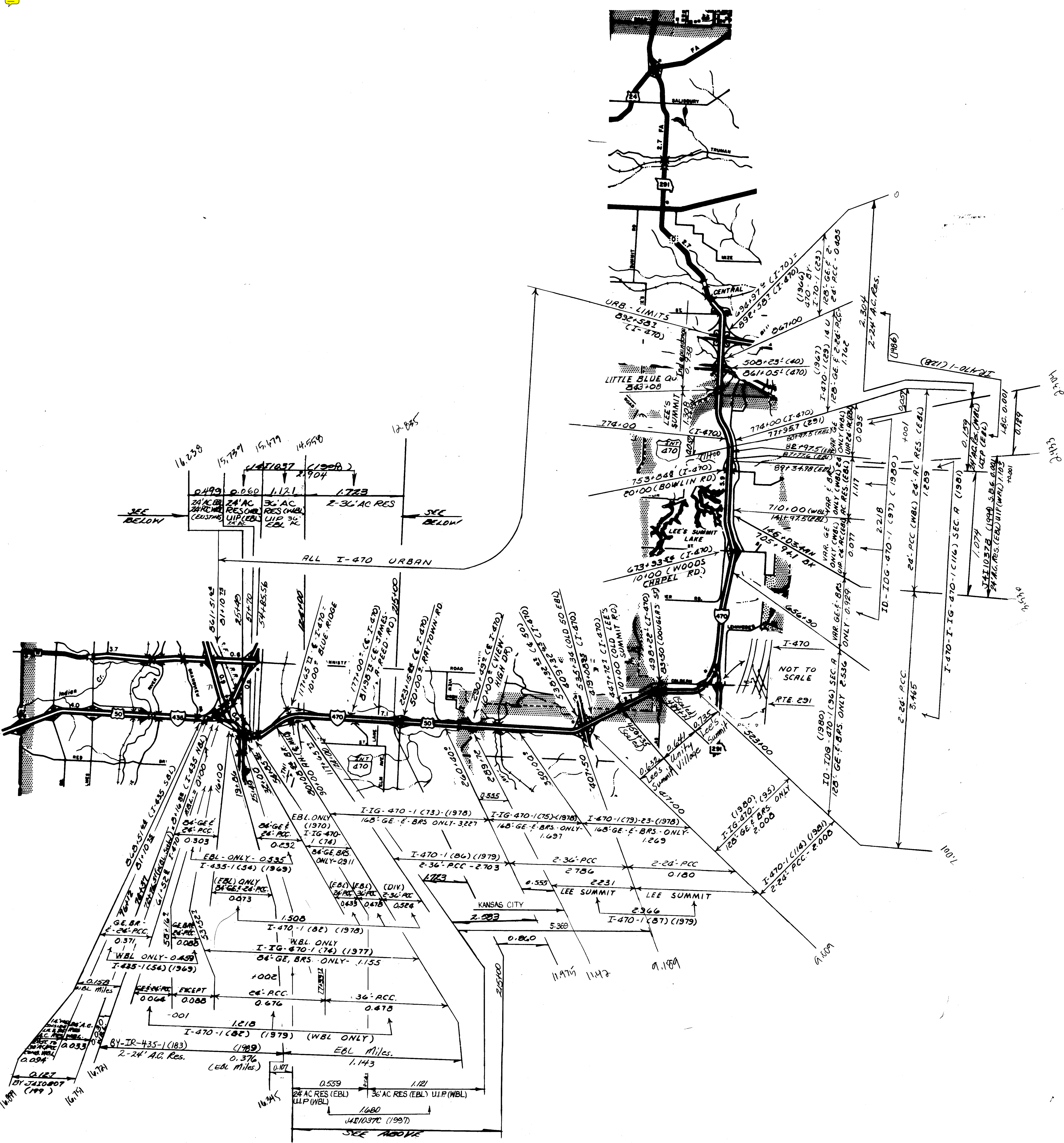

ROUTE - 470

048 SHEET 14 OF 21  
JACKSON

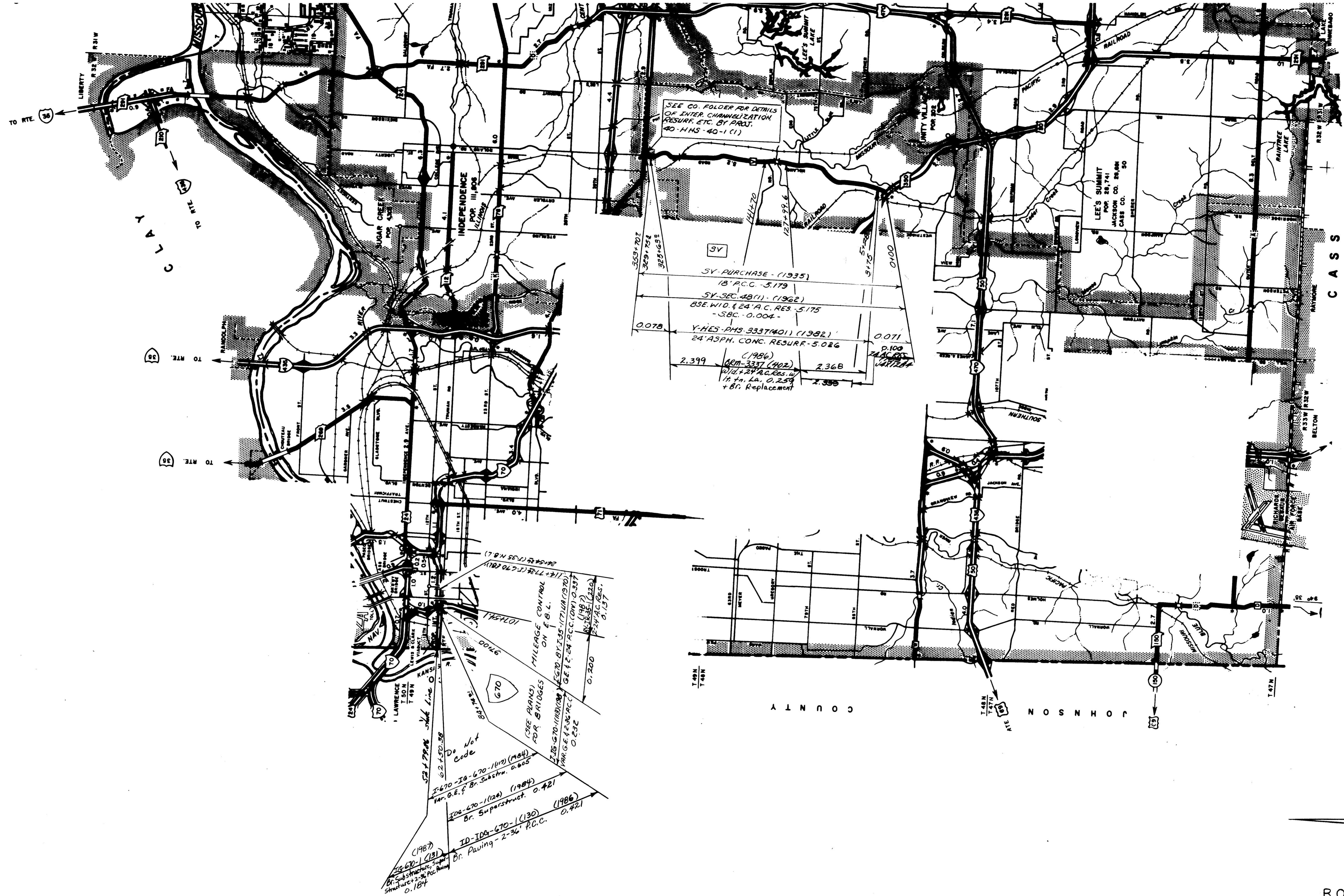

(178' N 11° 35' E 22.55' DIST) (114+77.78) (I-670 ELEV)  
 (114+77.78) (I-670 ELEV)  
 107+51.01  
 MILEAGE CONTROL ON F.B.L.  
 I-670-10-670-1(102) (1984) Par. G.E. Br. Substr. 0.605  
 I-670-1(102) (1984) Par. G.E. Br. Substr. 0.421  
 I-670-1(130) (1986) Br. Pawing-2-36' P.C.C. 0.421  
 I-670-1(131) (1986) Br. Substructure, Sup. Structure 2-36' P.C.C. 0.184  
 Do Not Code  
 I-670-10-670-1(102) (1984) Par. G.E. Br. Substr. 0.605  
 I-670-1(102) (1984) Par. G.E. Br. Substr. 0.421  
 I-670-1(130) (1986) Br. Pawing-2-36' P.C.C. 0.421  
 I-670-1(131) (1986) Br. Substructure, Sup. Structure 2-36' P.C.C. 0.184

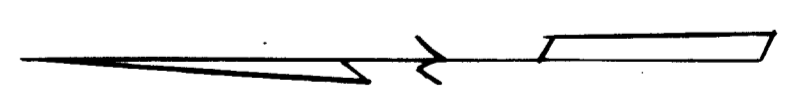

KANSAS

COUNTY

STATE

JOHNSON

COUNTY

ROUTES - AA  
 BB  
 RA  
 350 SPUR  
 35 PART SEE NOTE

© 048 SHEET 16 OF 21  
 JACKSON





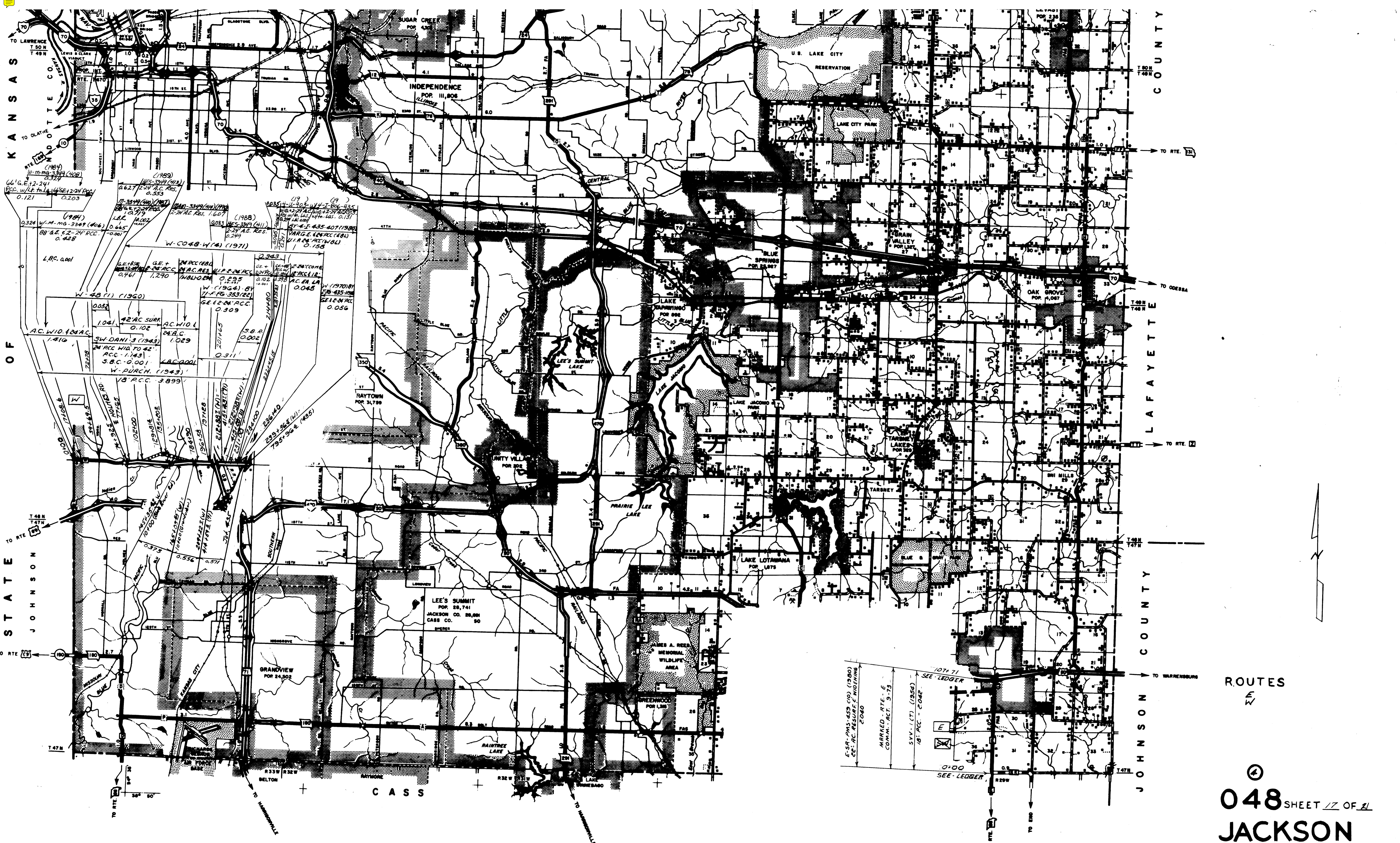

KANSAS

STATE OF JOHNSON COUNTY

LAFAYETTE COUNTY

JOHNSON COUNTY

ROUTES  
E  
W

048 SHEET 17 OF 21  
JACKSON

E-SR-915-423 (1980)  
SEC. PG. RESURF. & WIDENING  
2080

MARKED - RTE. E  
COMM. ACT. 9-75

SVV-1 (CT) (1954)  
18' PCC - 2082

107th ST  
SEE LEDGER

0+00  
SEE LEDGER

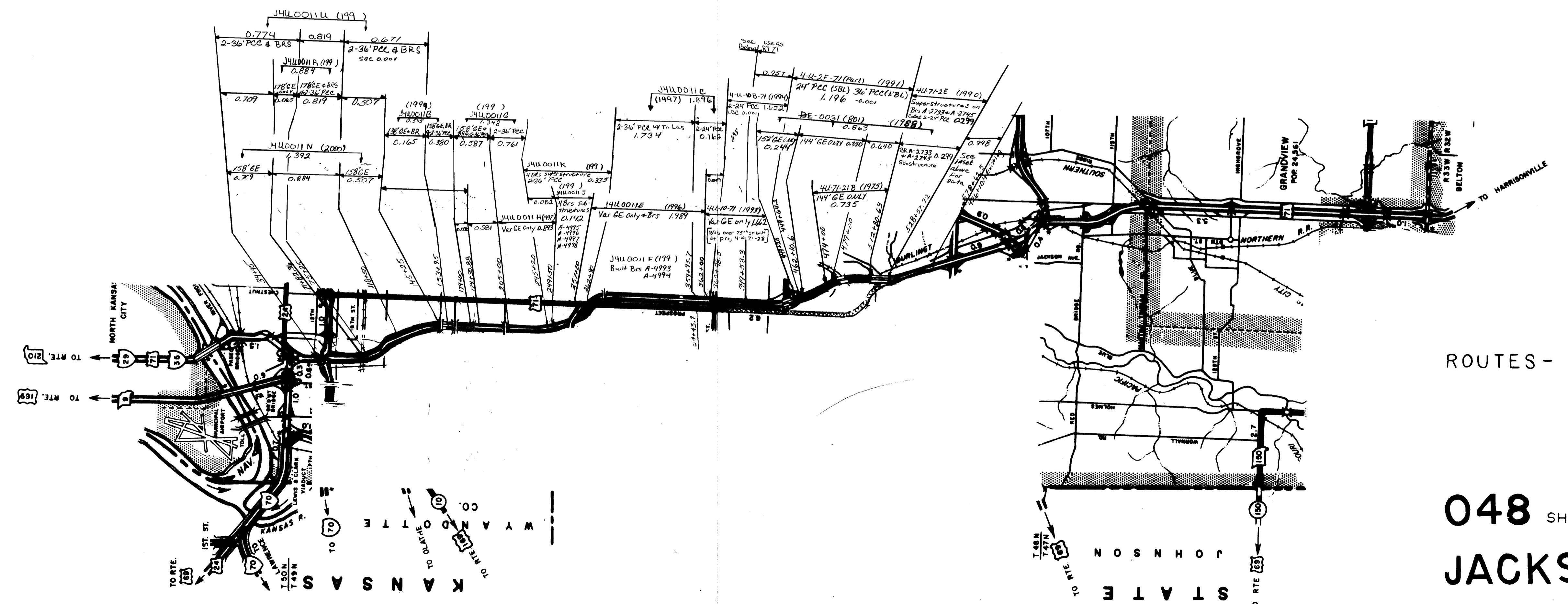
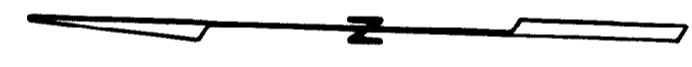
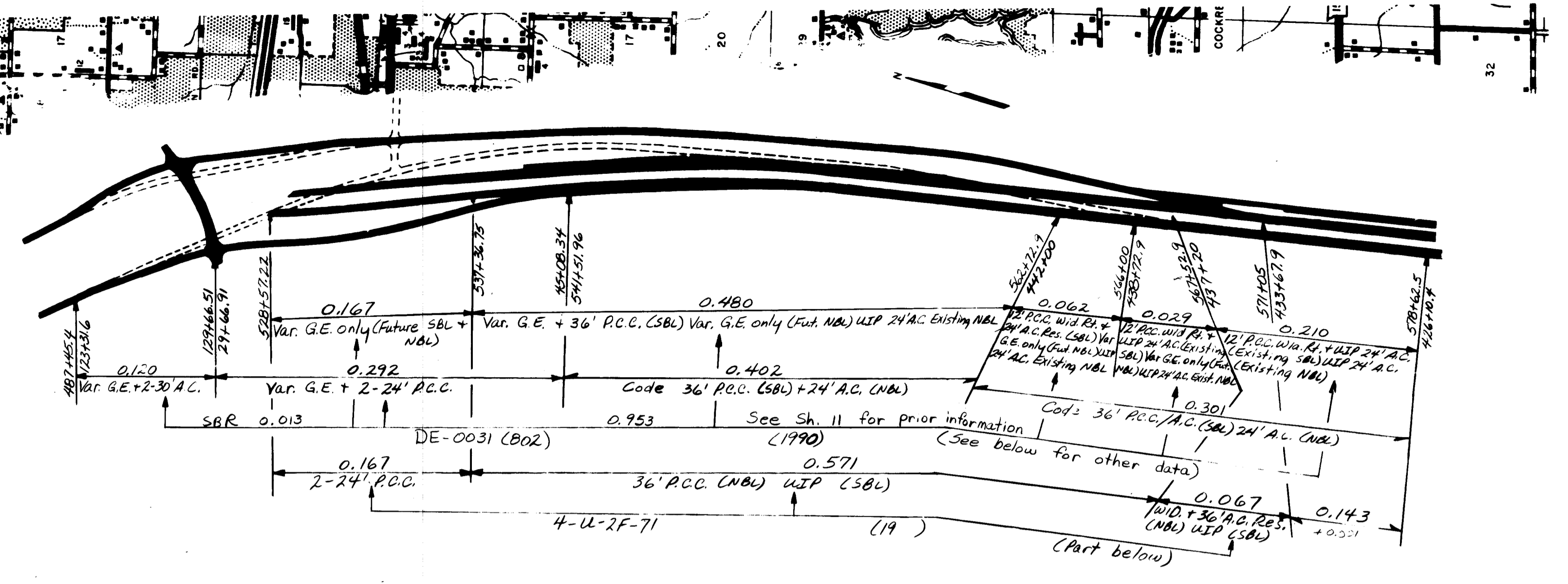
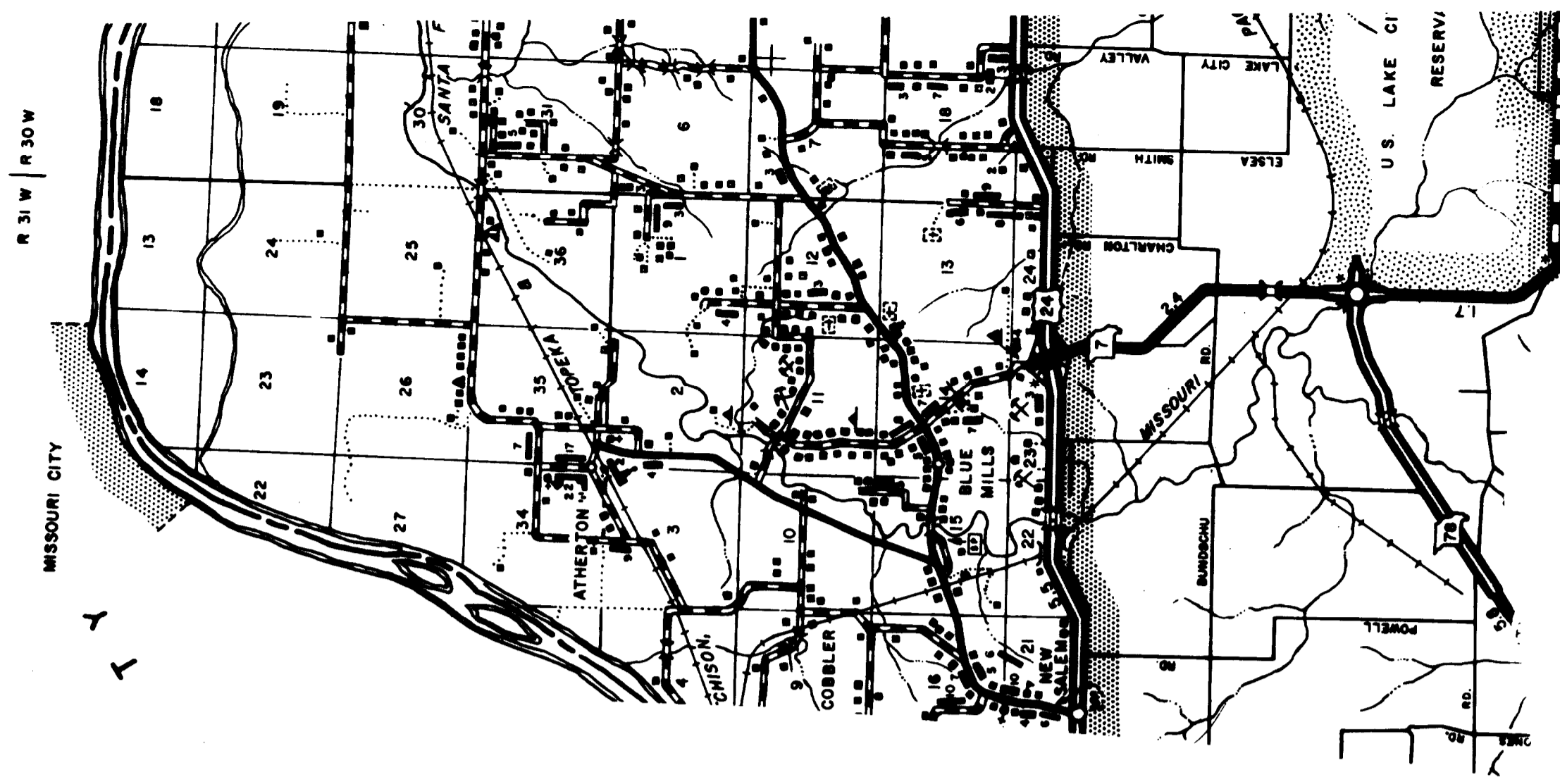

ROUTES - 71 (PART)

048 SHEET 18 OF 20  
JACKSON

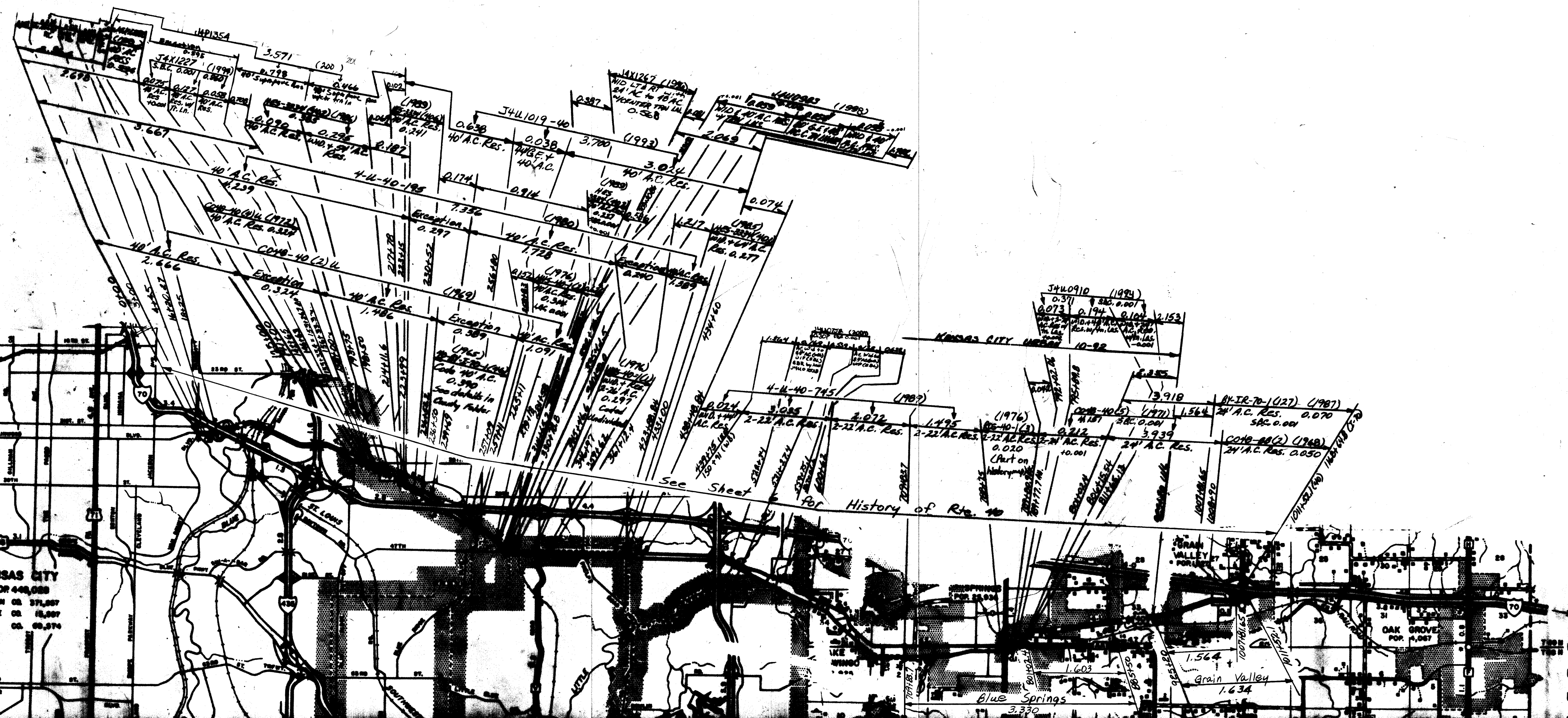

ROUTE 40

048 SHEET 19 OF 21  
 JACKSON

KANSAS CITY  
 POP 448,088  
 JACKSON CO 571,887  
 PLATTE CO 18,887  
 CLAY CO 68,974

6-1-91	STATE HIGHWAY	
12-27-88	COMPLETE NEW INV	
	DATE	
	DESCRIPTION	
	REVISIONS	

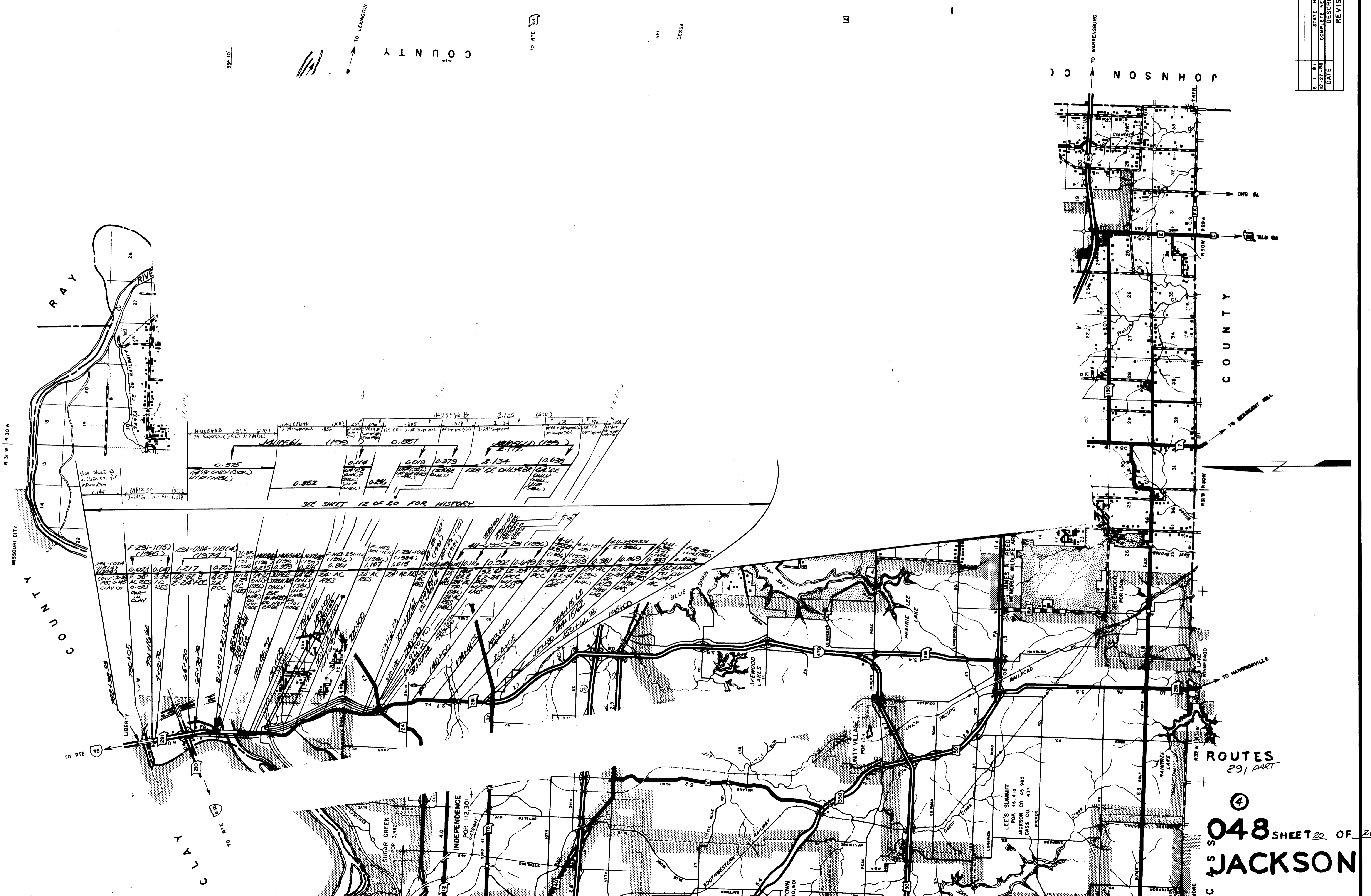

ROUTES  
 291 PART  
 ④  
**048** SHEET 20 OF 21  
**JACKSON**  
 COUNTY

38° 10'

COUNTY

TO RTE 30

56

DESSA

2

COUNTY

TO WARRENSBURG

COUNTY

TO WARRENSBURG

TO WARRENSBURG

TO WARRENSBURG

TO WARRENSBURG

TO WARRENSBURG



**KANSAS CITY**  
 POP 435,146

JACKSON CO	341,179
PLATTE CO	24,609
CLAY CO	69,316
CASS CO	42

OAK GROVE  
 POP 4,565  
 IN JACKSON CO. 4,561  
 IN CASS CO. 4

LAFAYETTE ROUTES  
 269

④  
**048** SHEET 21 OF 21  
 Jackson Co.  
**JACKSON**