

# JEFFERSON 050 ⑥

ROUTE  
I-55





# JEFFERSON O50 ©

ROUTES  
Rte. 110-BB  
EE-FF-30 Spur.



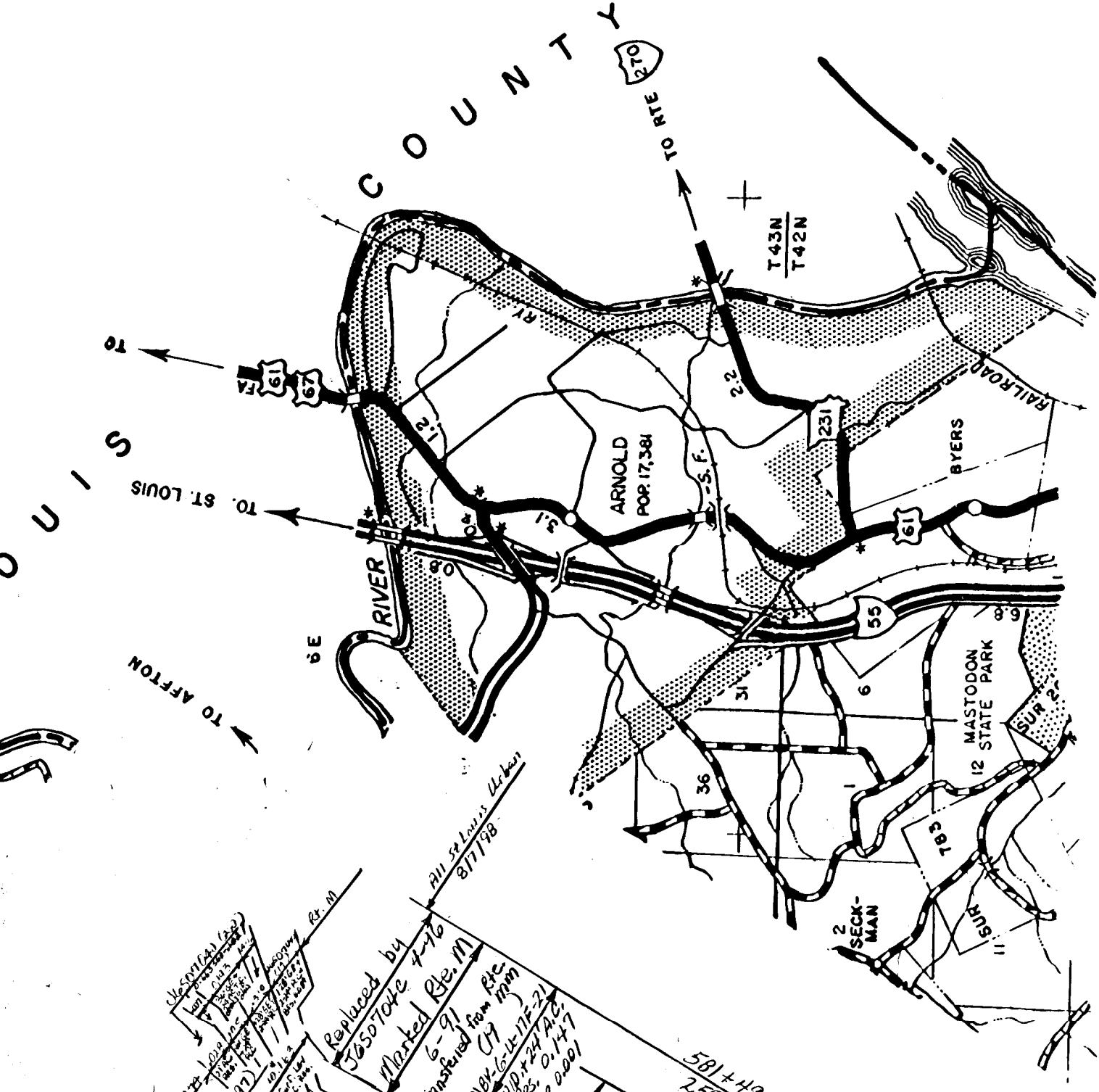
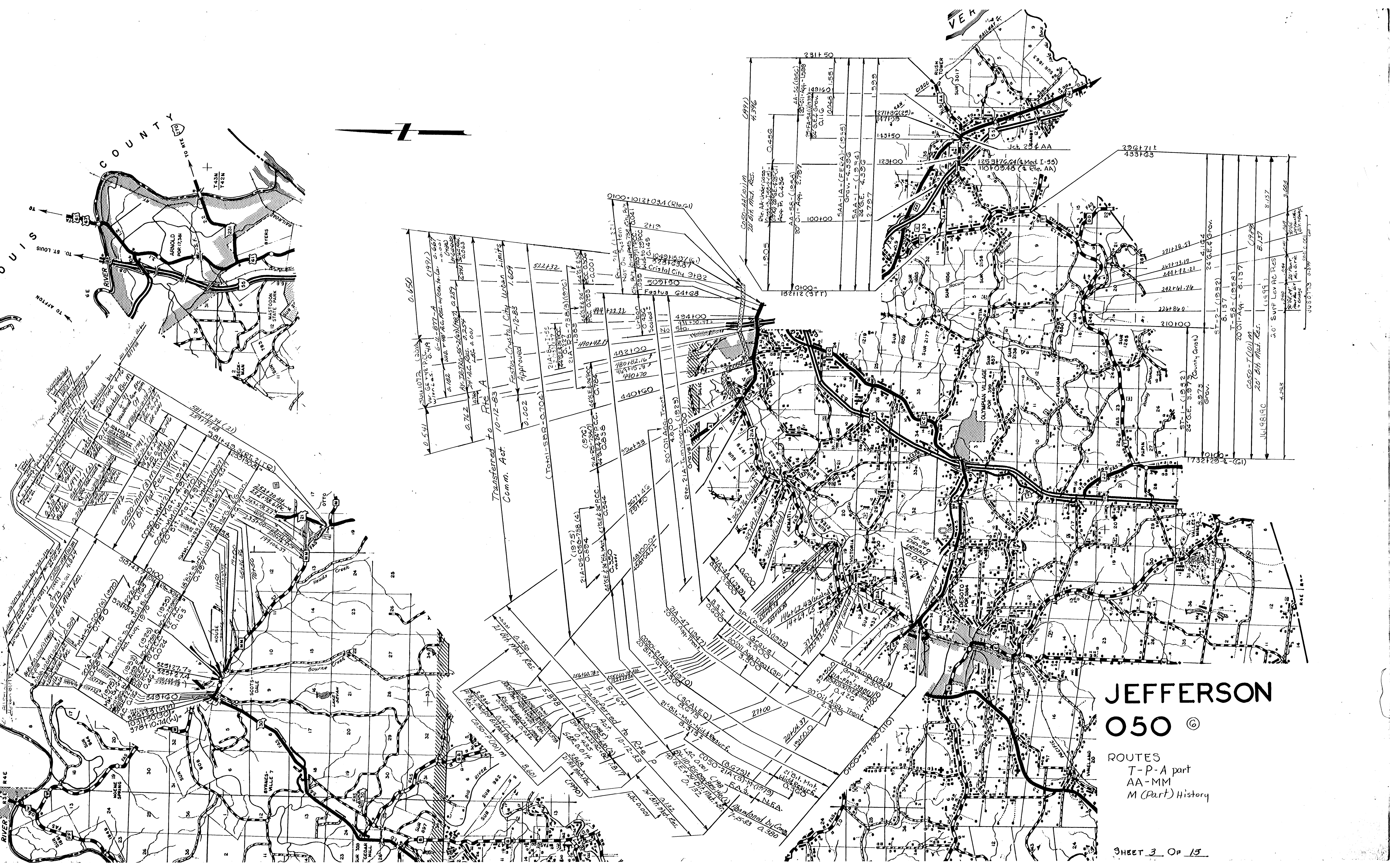

# JEFFERSON O50 ©

ROUTES  
T-P-A part  
AA-MM  
M (Part) History





# JEFFERSON 050

ROUTE  
21  
21F



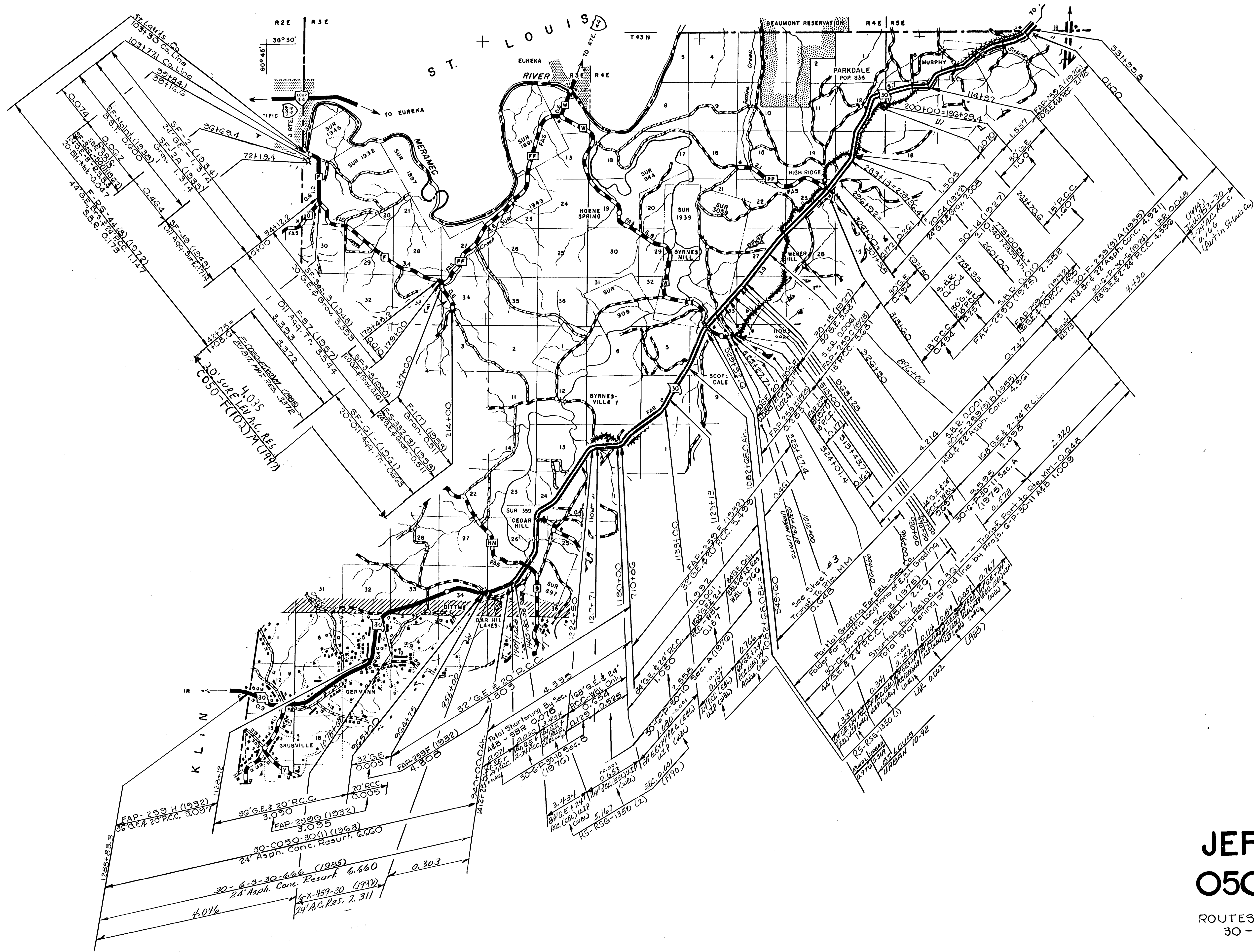

**JEFFERSON**  
**050** ©  
 ROUTES  
 30 - F



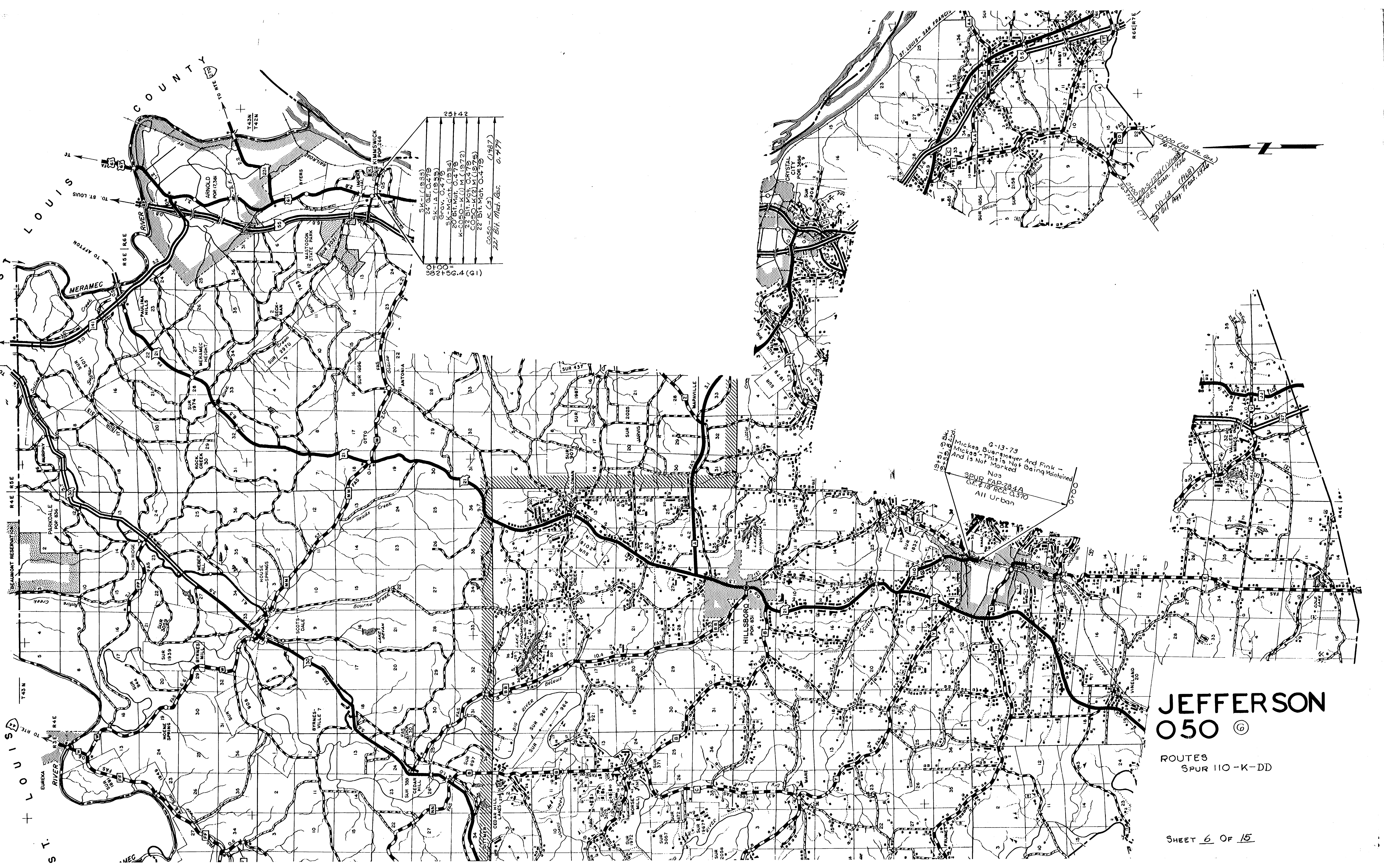

0100 =	24 GE. 0.475	SK-L (1953)
3821+56.4 (61)	SK-LA (1955)	Grav. 0.475
	27 MIT. (1954)	27 MIT. Mt. 0.475
	22 BIT. Mt. (1972)	K-COSO-M (1972)
	22 BIT. Mt. (1975)	COSO-K (2) (1975)
	22 BIT. Mt. 0.475	CO-50-K (3) (1987)
	22 BIT. Mt. Res. 0.475	

9-13-73  
 Mickes, Buergmeyer And Fink -  
 This is Not Being Maintained  
 And is Not Marked  
 Nos  
 SPUR FAP-28.4A  
 GE. 2 18 R.C.C. 0.370  
 All Urban

# JEFFERSON O50 ⑥

ROUTES  
 SPUR 110-K-DD



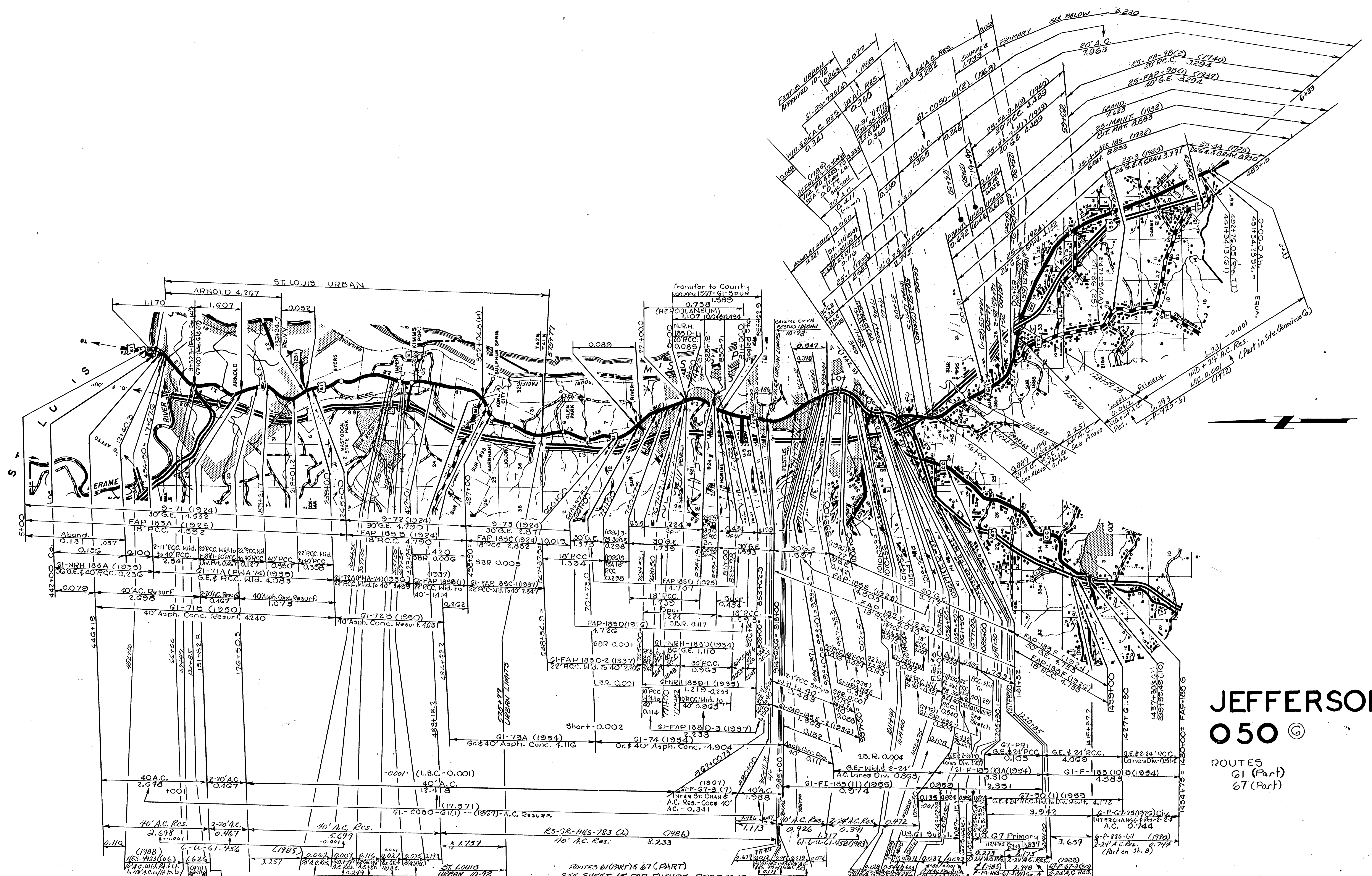

# JEFFERSON 050 ©

ROUTES  
G1 (Part)  
G7 (Part)



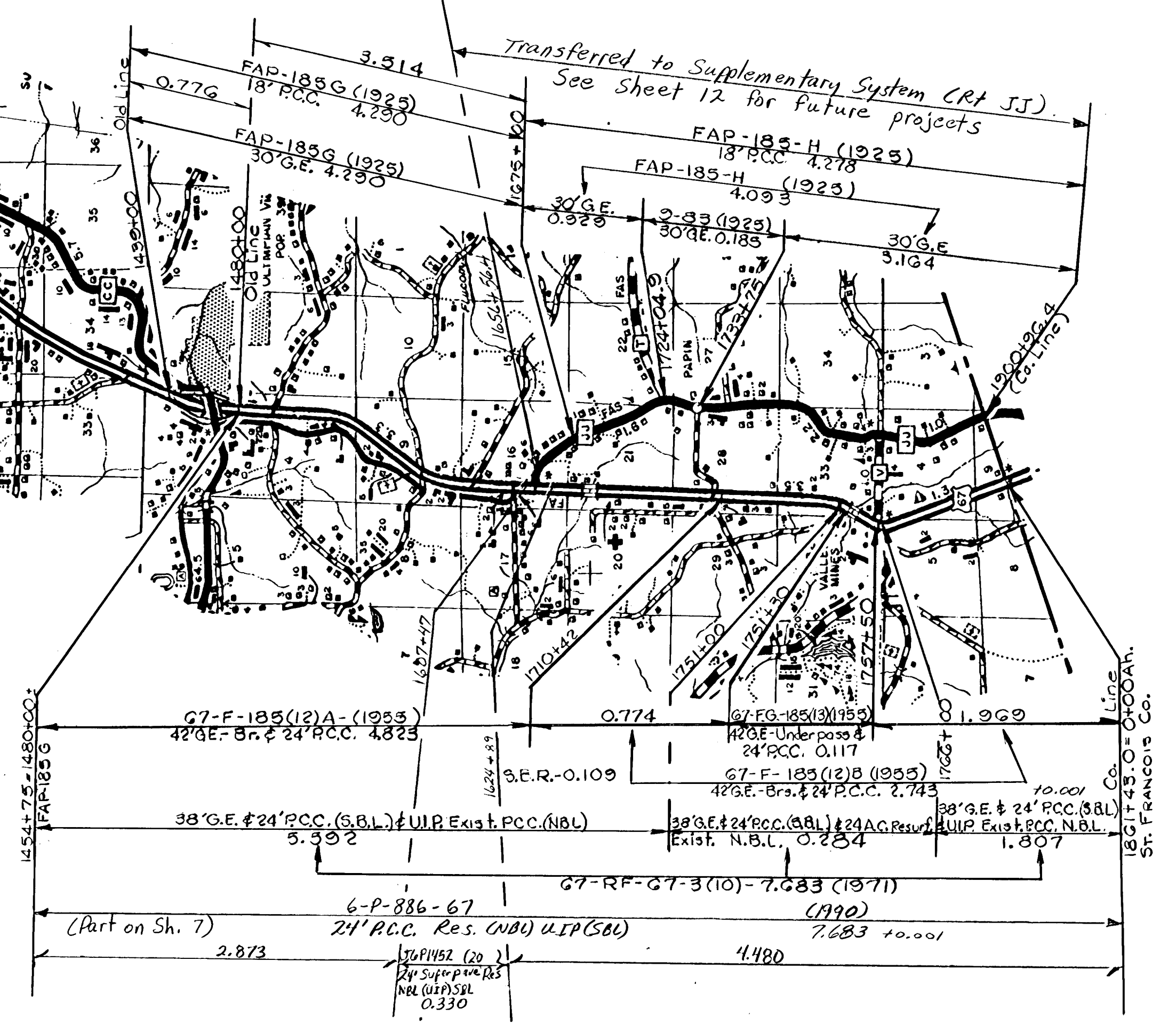
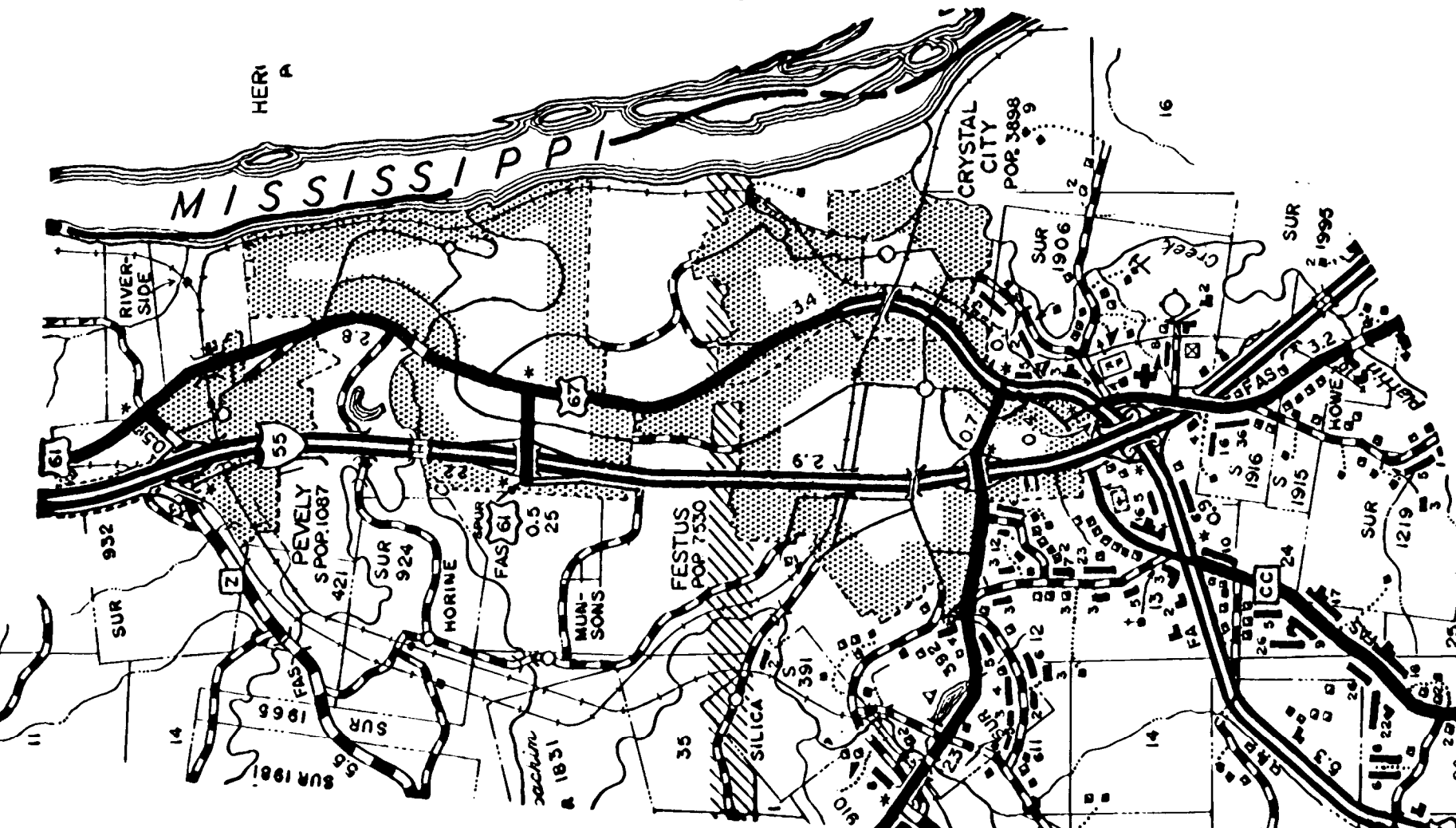
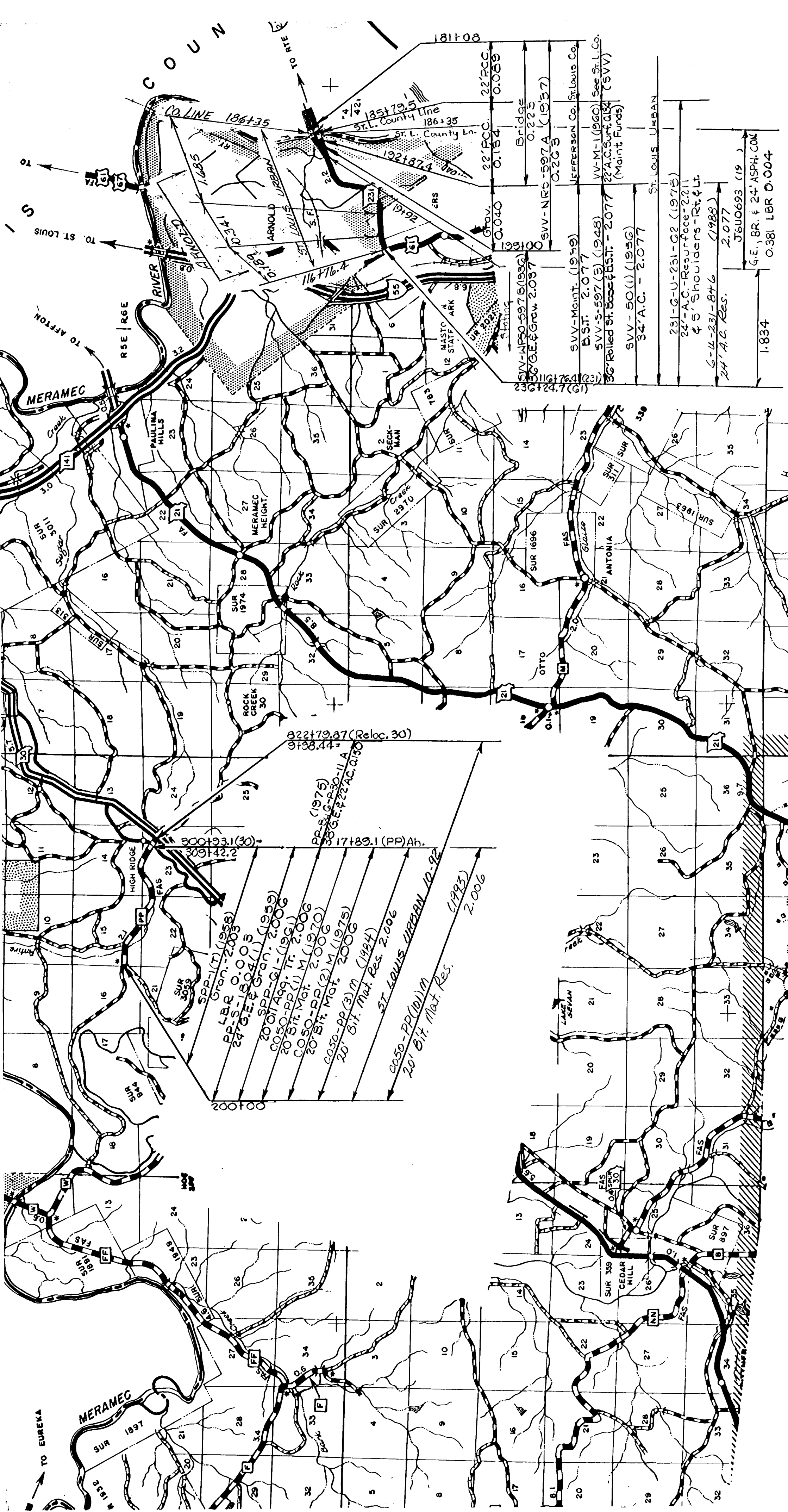

# JEFFERSON 050 ©

ROUTES  
G7 (PART)-231-PP  
JJ (History)







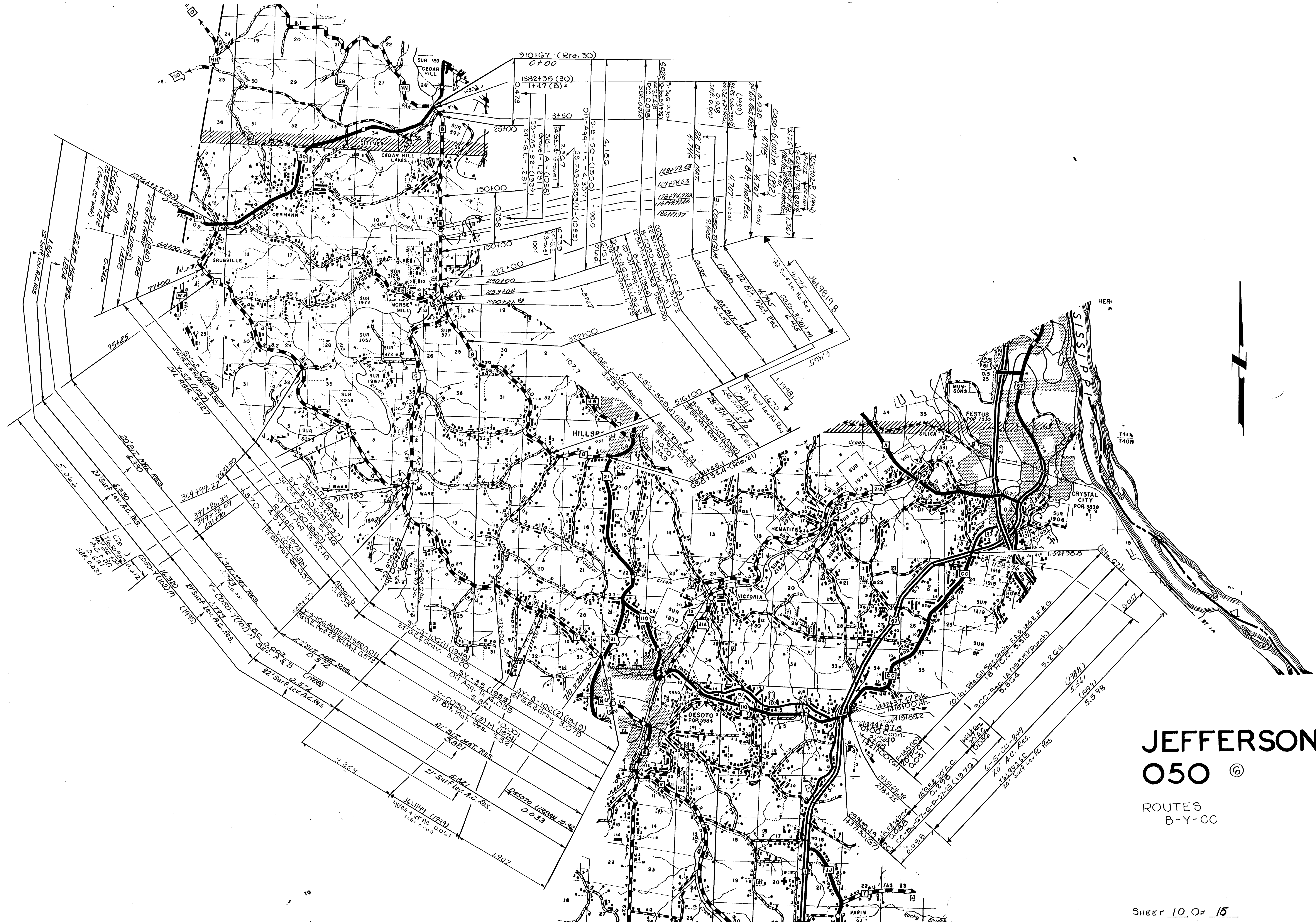

# JEFFERSON 050 ⑥

ROUTES  
B-Y-CC





JEFFERSON  
 O50 ©  
 ROUTES  
 M-W



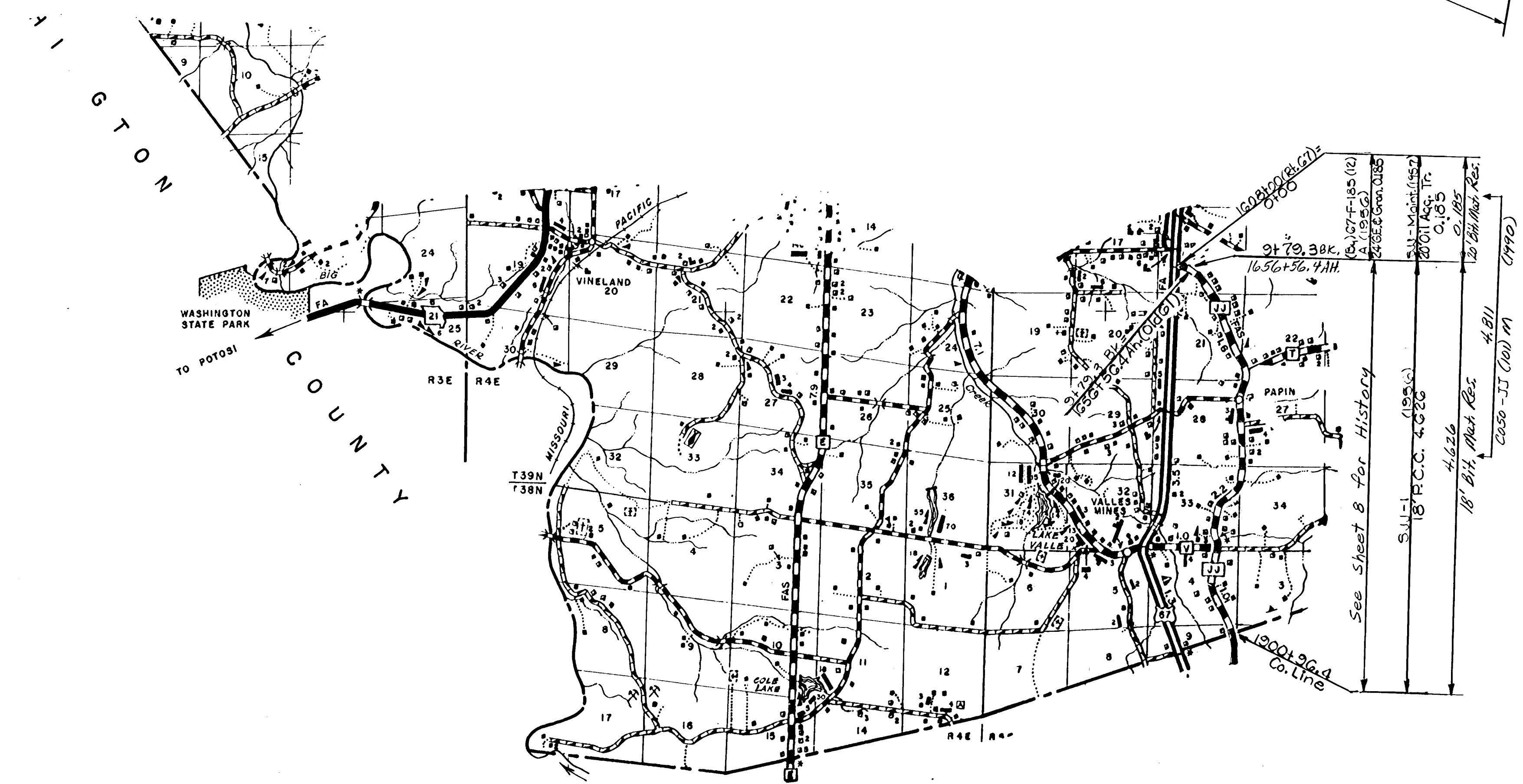
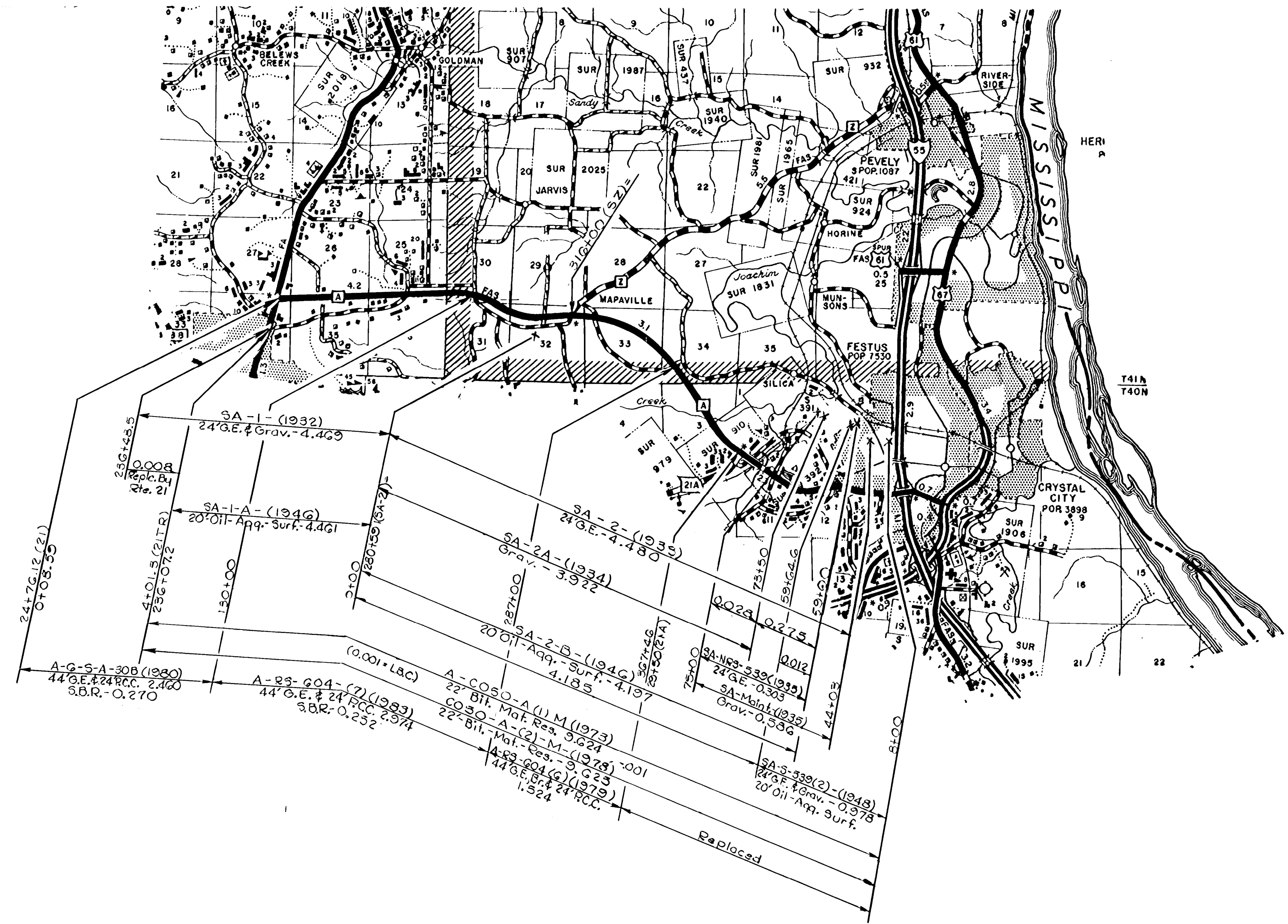
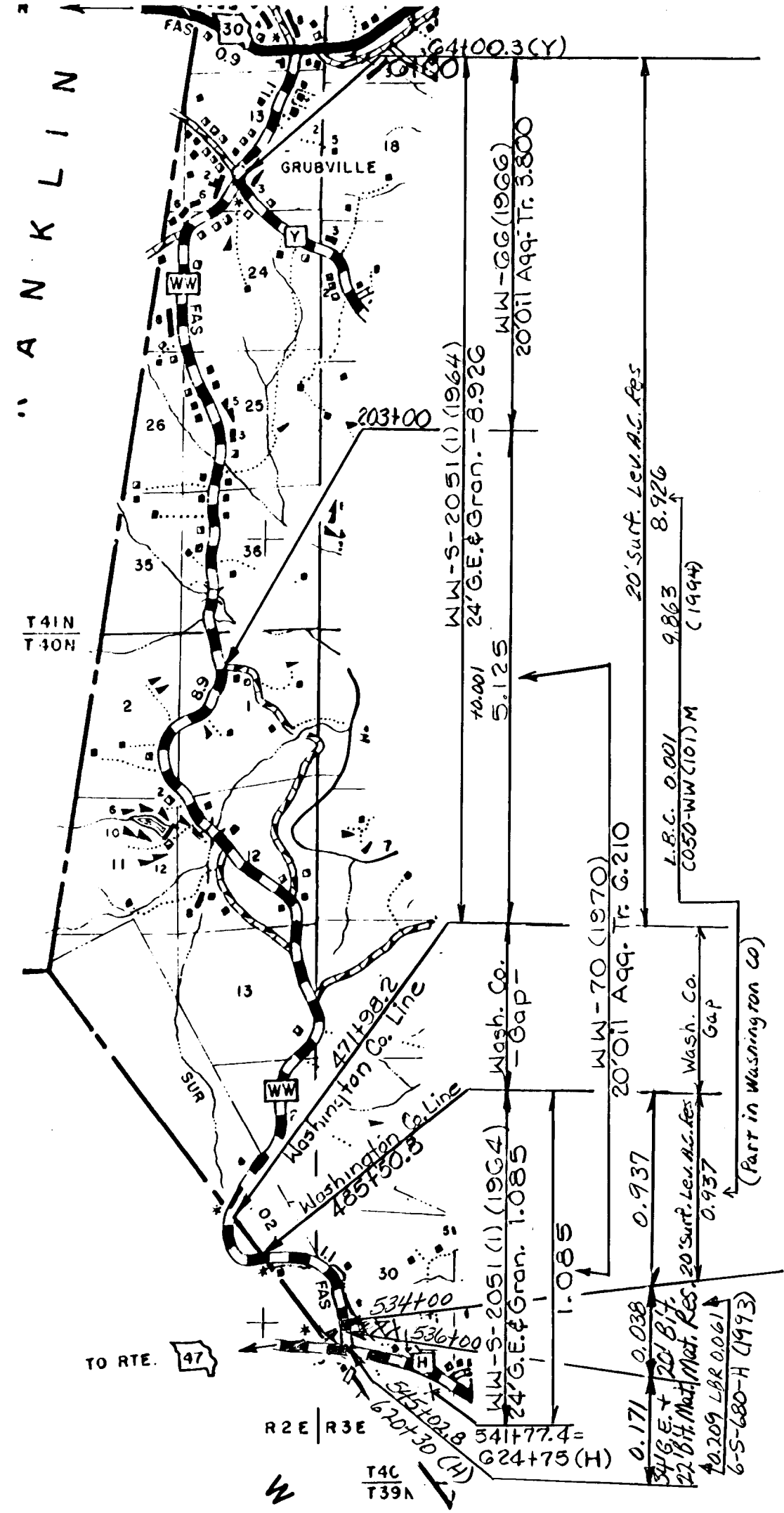

JEFFERSON  
 O50 ©  
 ROUTES  
 NW-JJ-A part



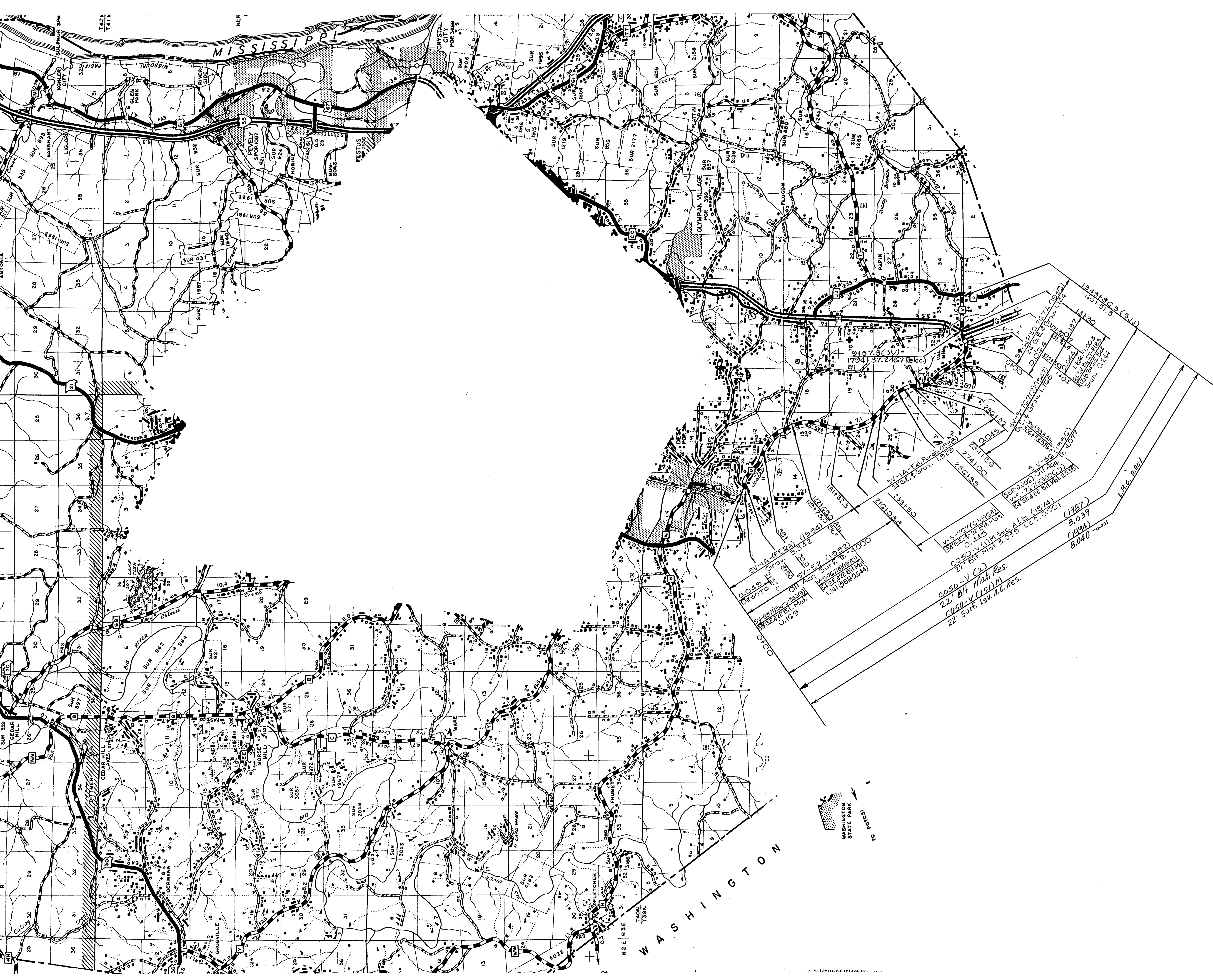

# JEFFERSON 050 ©

ROUTE  
V





# JEFFERSON O50

ROUTES  
C-E-H-N  
Z-TT



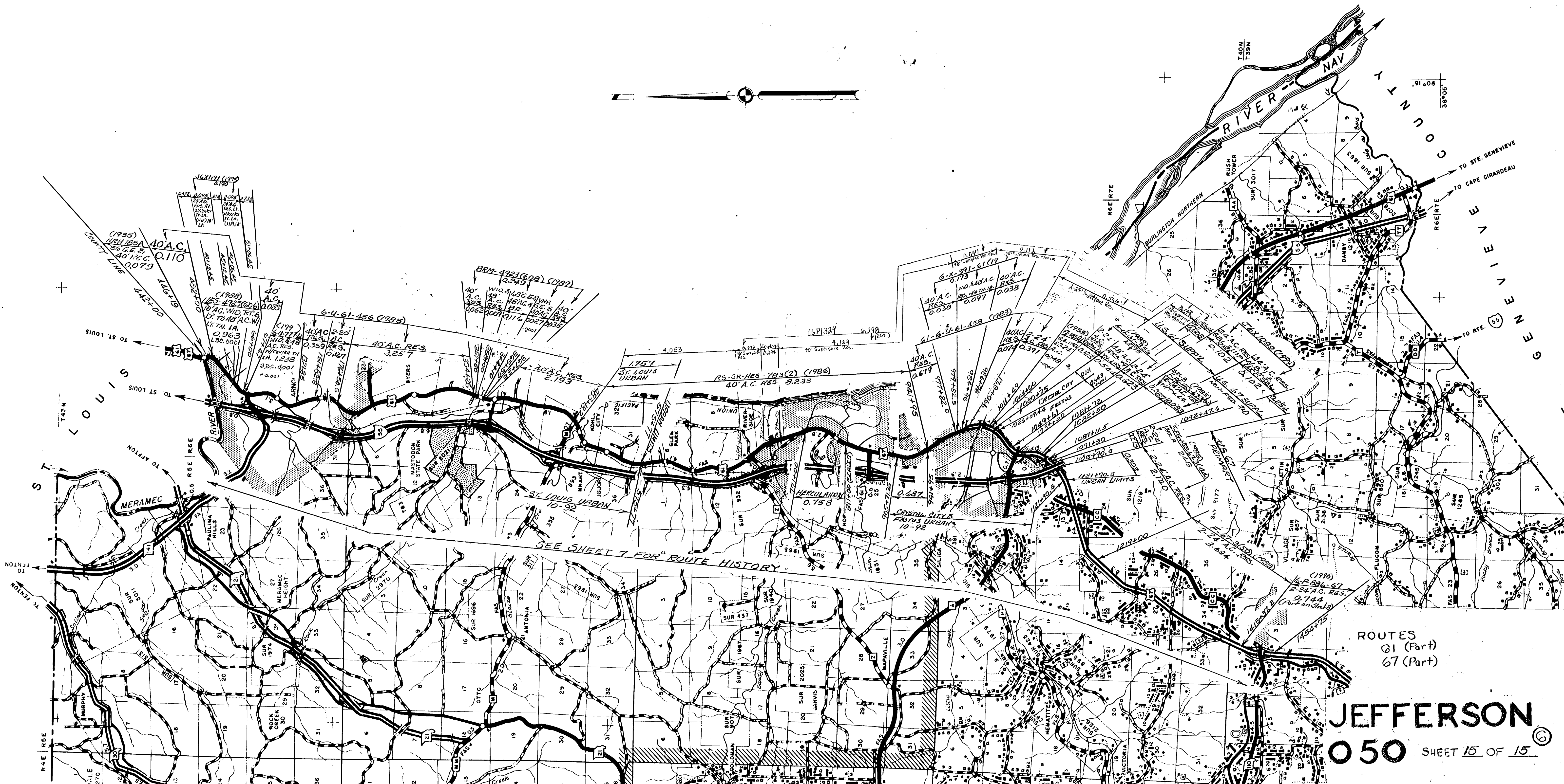

SEE SHEET 7 FOR ROUTE HISTORY

ROUTES  
61 (Part)  
67 (Part)

**JEFFERSON**  
**050** SHEET 15 OF 15