

COUNTY

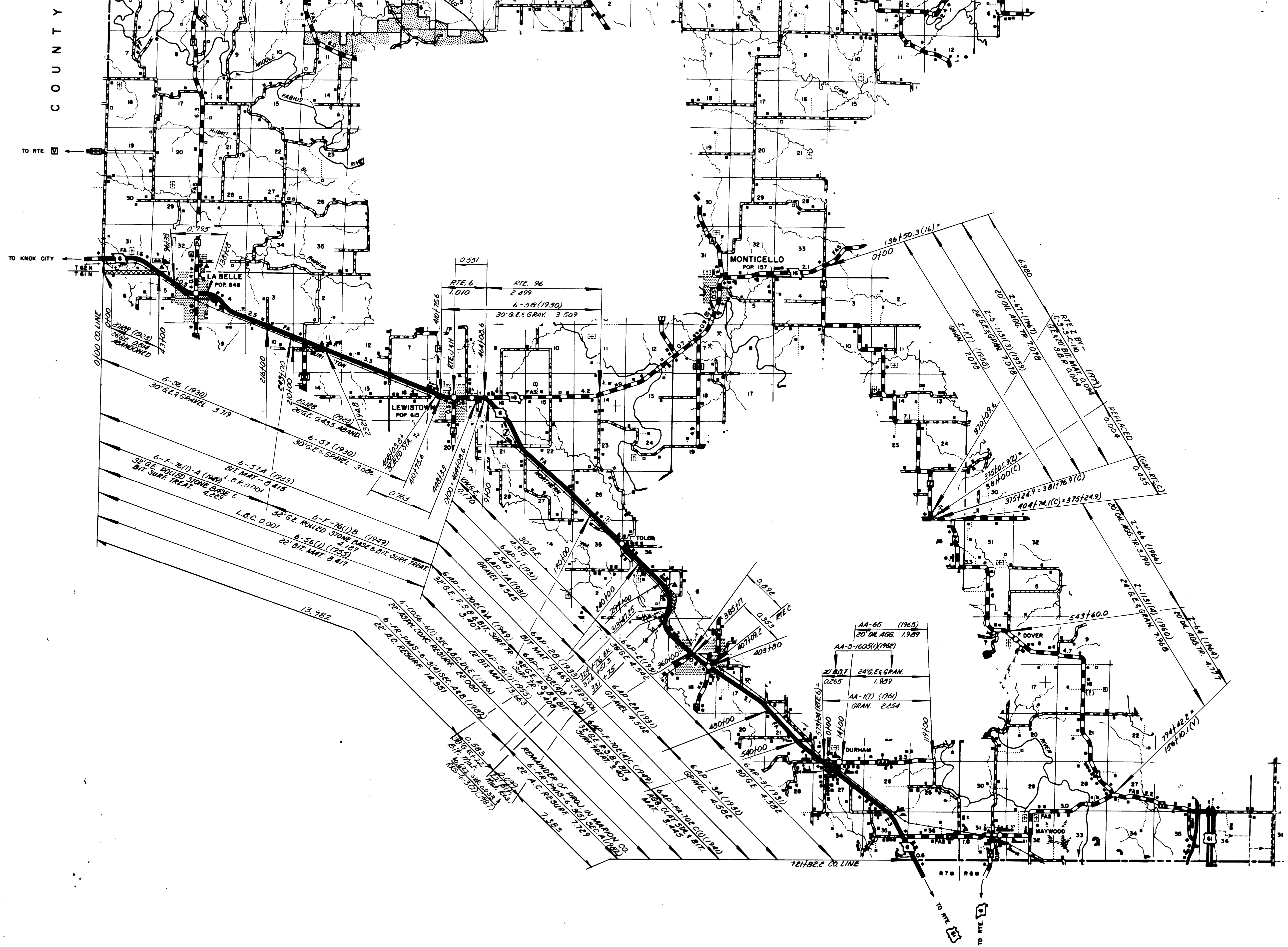

ROUTES 6
Z
AA

③

056

SHEET 1 OF 10

LEWIS

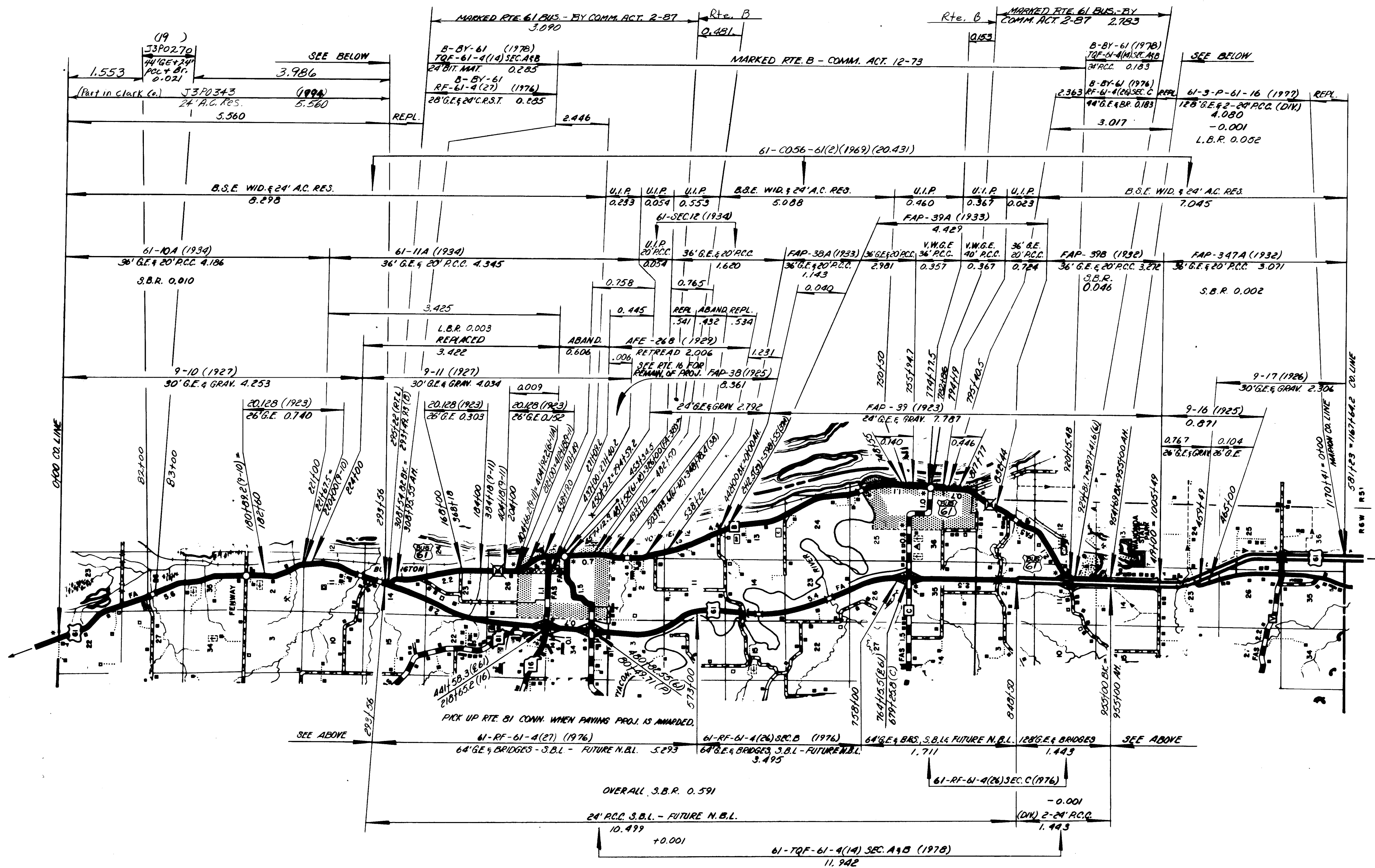

ROUTES 61
 B
 BUS. 61 (Part)

③

056

SHEET 3 OF 10

LEWIS

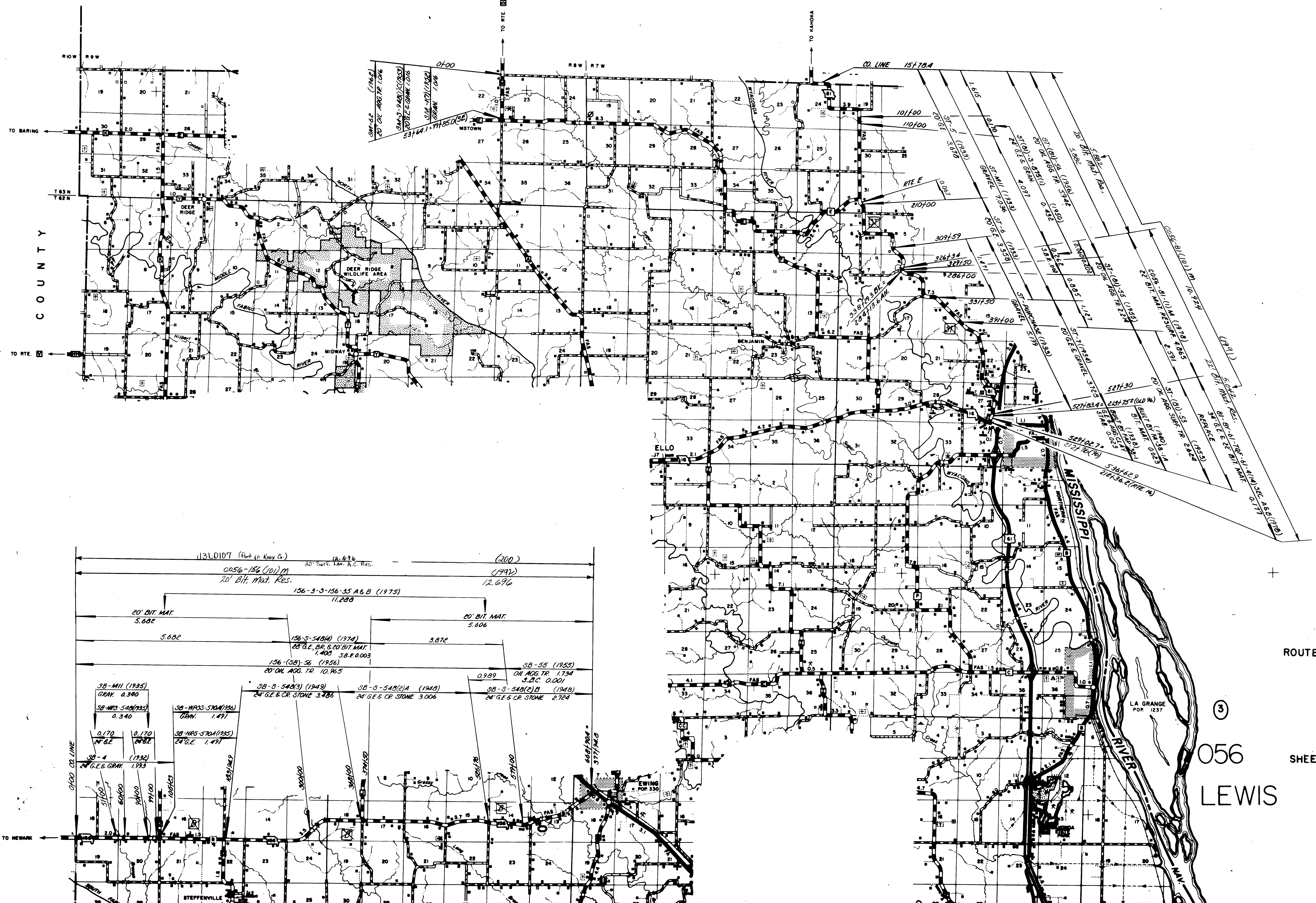

13.10107 (Part of Knox Co.) 12.696 (200)
 20' Surf. Lev. A.C. Res. (1992)
 0056-156 (101) M 12.696
 20' Bit. Mat. Res.

156-3-3-156-35 A&B (1975) 11.238

20' BIT. MAT. 5.682

156-S-548(A) (1974) 3.872
 28' G.E. BR. & 20' BIT. MAT. 1.400 S.B.R. 0.003

20' BIT. MAT. 5.606

156-(SB)-36 (1956) 20' ON AGG. TR. 10.965

SB-55 (1955) 0.989
 ON AGG. TR. 1.734
 S.B.C. 0.001

SB-8-548(3) (1949) 24' G.E. & CR. STONE 3.486

SB-8-548(2)A (1948) 24' G.E. & CR. STONE 3.006

SB-8-548(2)B (1948) 24' G.E. & CR. STONE 2.784

SB-M11 (1935) 0.340
 GRAN.

SB-MRS-548(1935) 0.340

SB-MRS-570A(1935) 1.491
 GRAN.

SB-MRS-570A(1935) 24' G.E. 1.491

SB-4 (1932) 0.170 0.170
 24' G.E. & GRAN. 1.993

STEFFENVILLE

EWING POP. 330

LA GRANGE POP. 1237

ROUTES 81
156
M

③
056
LEWIS

SHEET 4 OF 10

CLARK

HANCOCK COUNTY

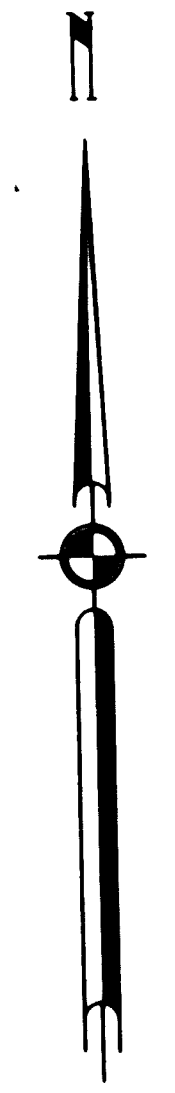
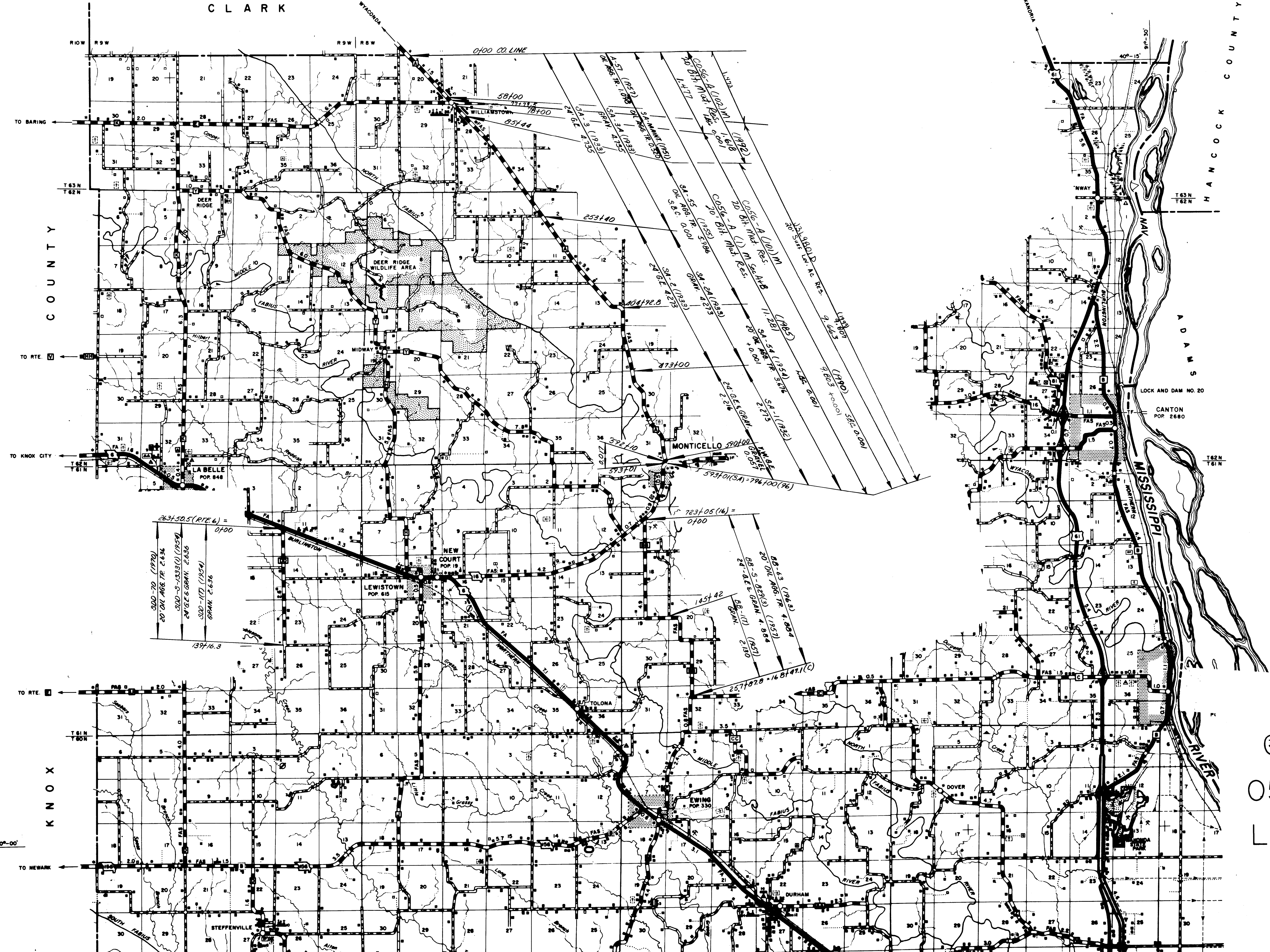

ROUTES A
BB
DD

③
056
LEWIS
SHEET 5 OF 10

+

+

+

+

+

+

TO BARING

TO RTE 6

TO KNOX CITY

TO RTE 6

TO NEWARK

LOCK AND DAM NO. 20

CANTON POP 2680

T 62 N T 61 N

85°-00'
40°-00'

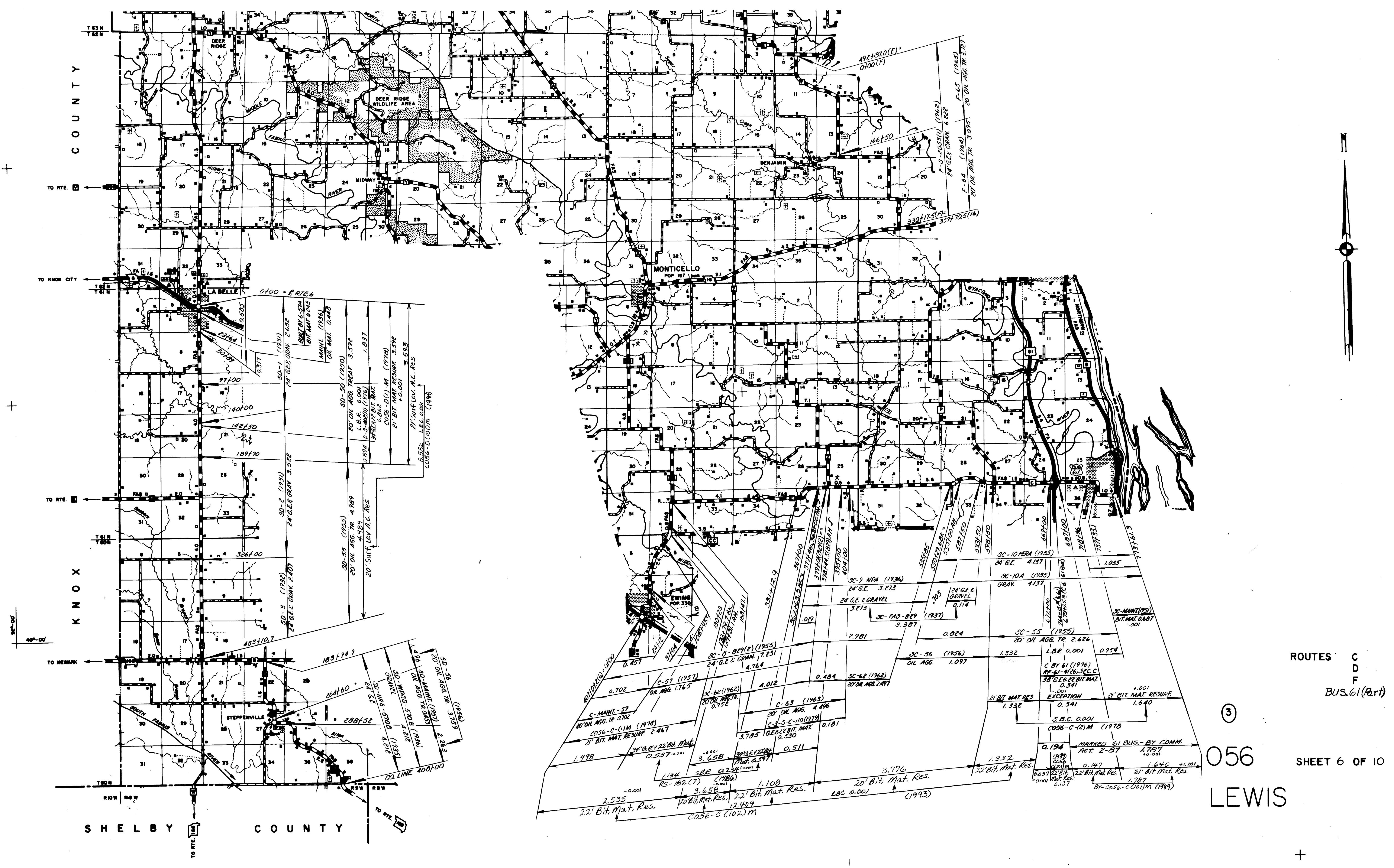

ROUTES C
D
F
BUS. 61 (Part)

③

056
LEWIS

SHEET 6 OF 10

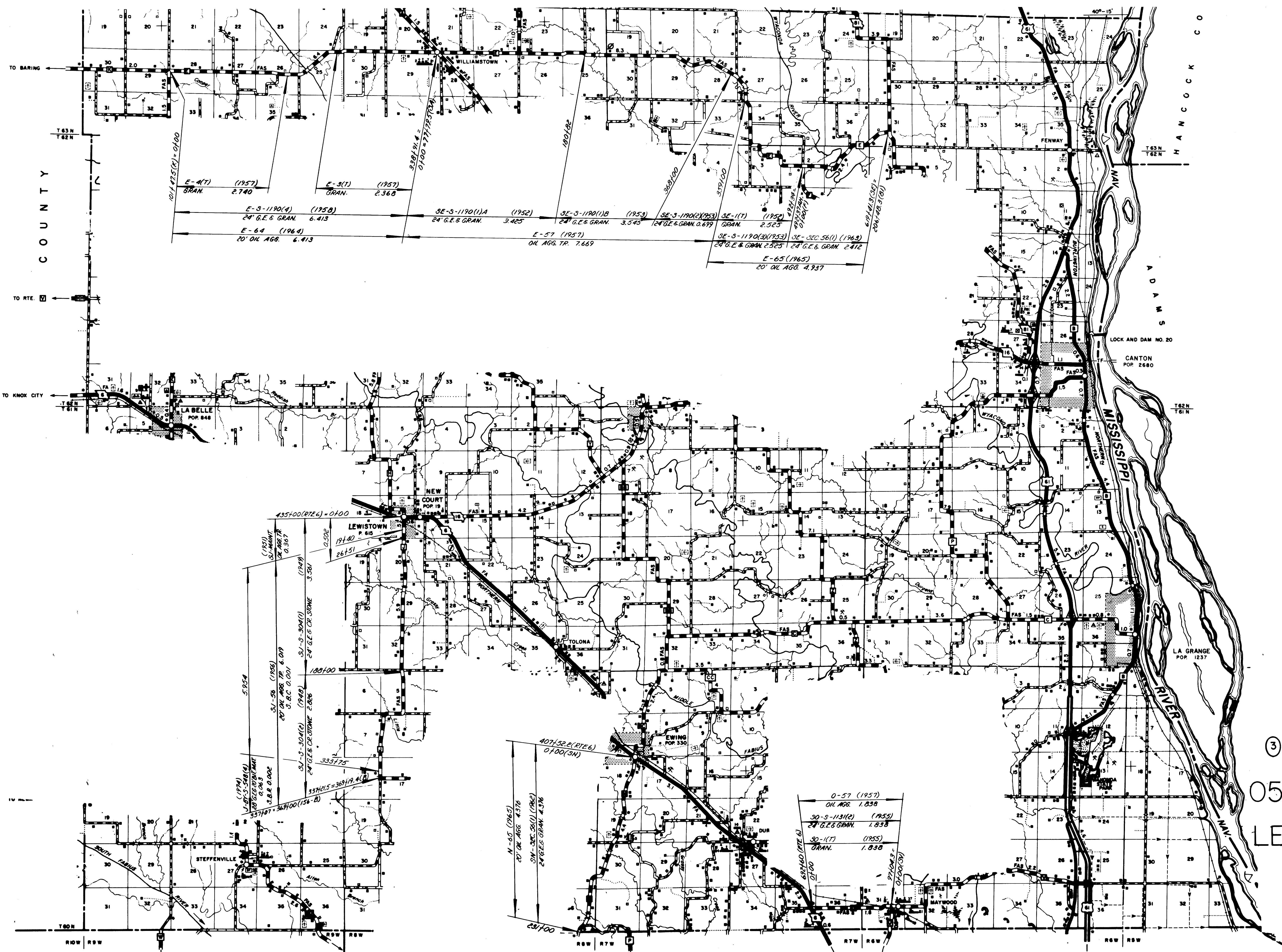

COUNTY

HANCOCK CO

SWADA

LOCK AND DAM NO. 20

CANTON
POP. 2680

T. 62 N.
T. 61 N.

LA GRANGE
POP. 1237

ROUTES
E
J
N
O

③

056

SHEET 7 OF 10

LEWIS

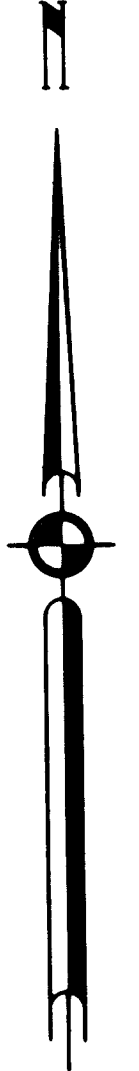

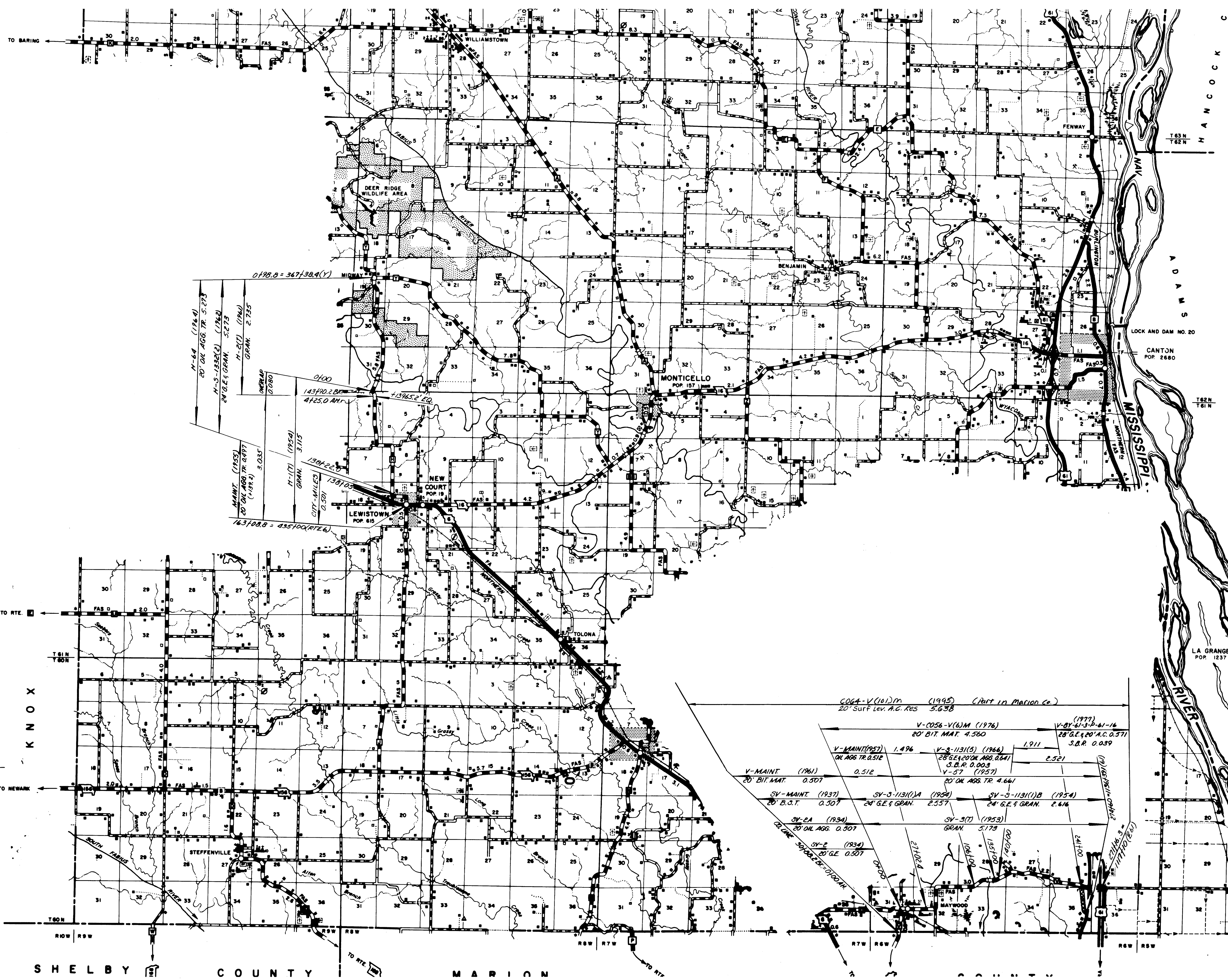

ROUTES H
V

056
LEWIS

SHEET 8 OF 10

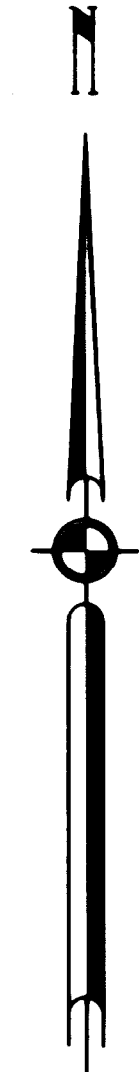

CLARK

COUNTY

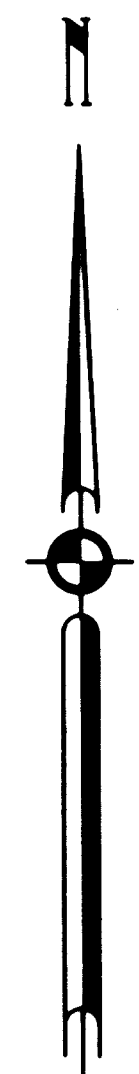
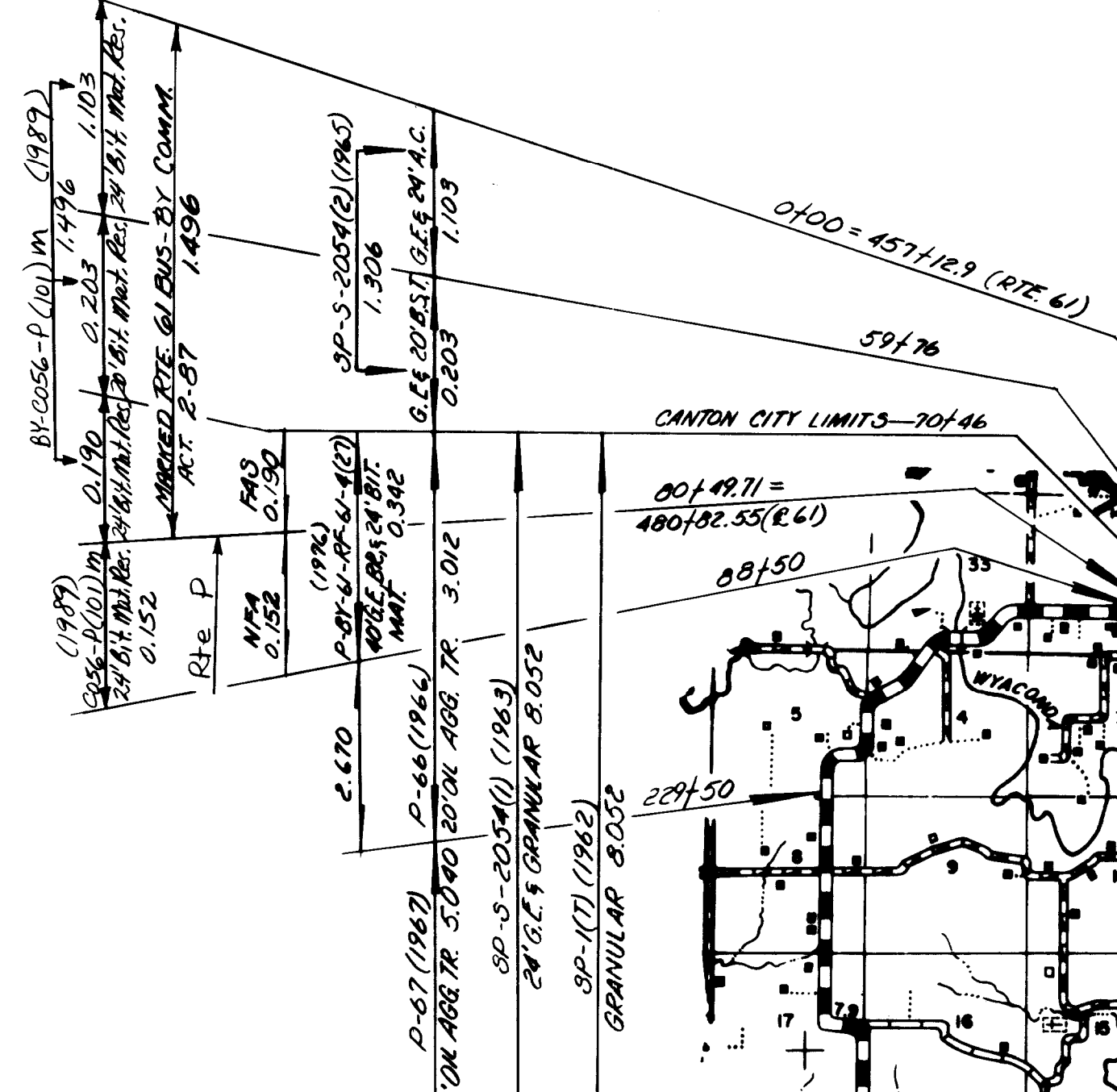
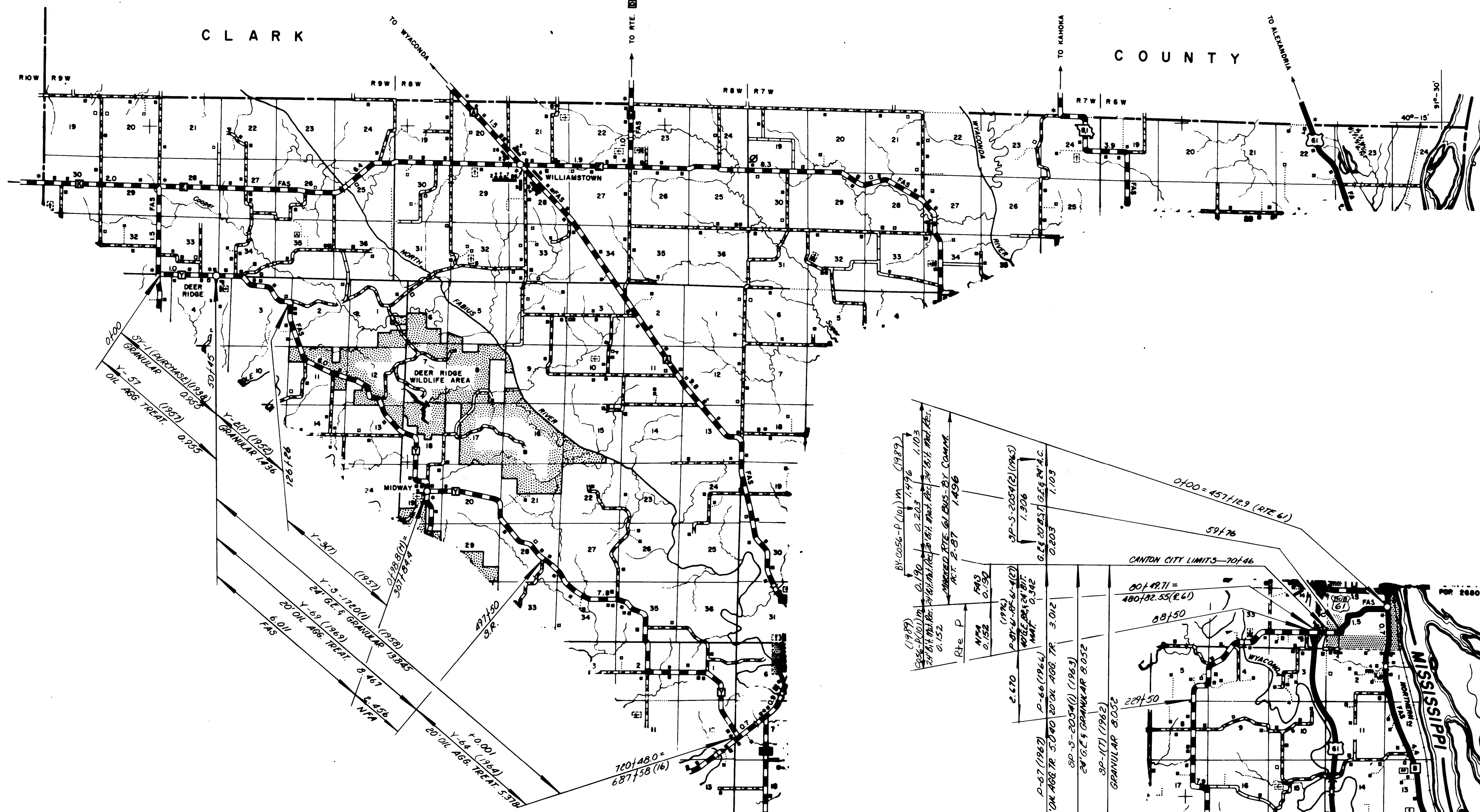

ROUTES P
Y
BUS. 61 (P+)

SHEET 10 OF 10

056
LEWIS

(3)

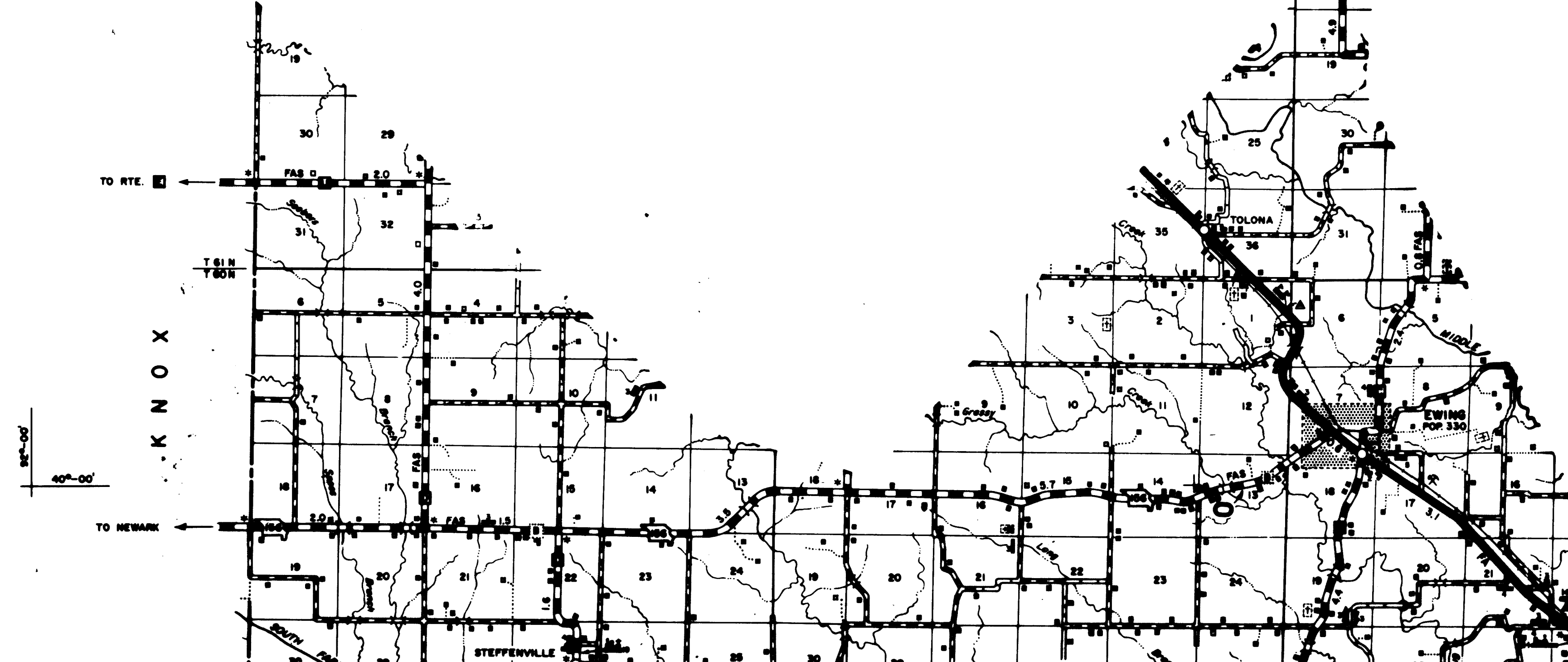

KNOX

TO RTE.

T. 18 N

TO NEWARK