

LEWIS COUNTY

STATE COUNTY

ROUTES 6  
C  
N History  
W

064  
MARION

SHEET 7 OF 19

Conveyed to city of Hannibal  
Commission Action 6-92  
3-11-319-N (19 )  
0.2578 0.841  
24 A.C. Res. 0.783  
20 A.C. Res. 0.003  
MARKED-RTE-N-COMM.-ACT-9-75  
SEE W-3-U-W-3(1975)  
1,482  
WID. E 20'A.C.  
0.783  
TRANSFER TO RTE-N BY COMM.  
ACT. FEB-1966  
3W-BY-E-61-40(1964)  
36 G.E. 224 P.C.C. 0.008  
56R 0.034 0.783  
3W-1-(1991)  
0.875  
0.002  
G.E. P.C.C. 0.033  
G.E. P.C.C.  
City Street  
20' P.C.C.  
0.606 ±  
N.O.S.  
62410  
HANNIBAL  
POP. 19,210  
2.6  
3.5  
SEE ABOVE  
1,482  
4991 W-3-U-W-3(1975)  
3.073  
3-5-321-W  
20' A.C. Res.  
1.796  
HANNIBAL URBAN  
10-92

3C-1(1) (1955)  
BRAY. 1.635  
3C-2-612(618)(1955)  
24 G.E. 609AN. 1.635  
C-26(300)  
20' OIL ADD. TR. 1.635  
3C-PW-FAS 612-E(1)  
24 G.E. 609AV. 4.258  
0.999  
C-27(1937)  
20' OIL AGG. 3.265  
3C-PM  
FAS 612-B(1)  
24 G.E. 609AV. 2.231  
3C-FAS 612-C(1941)  
24 G.E. 609AV. 3.026  
3C-FAS 612-D(1940)  
24 G.E. 609AV. 4.327  
3C-48(1948)  
20' OIL AGG. TR. 2.25  
3C-48(1948)  
20' OIL AGG. TR. 2.25  
3C-66(1956)  
56R 0.000-  
3.582(1964)  
24 G.E. 609AV. 1.080  
1.465  
0064-C(10)M  
20' Bit. Mat. Res.  
1197  
7.621  
C-0064-C(1)M-(1972)  
20' BIT-MAT. 6.051  
C-0064-C(2)M-(1976)  
20' BIT-MAT. 6.051  
(1992)  
9.579  
56R 0.001  
+0.001



LEWIS COUNTY

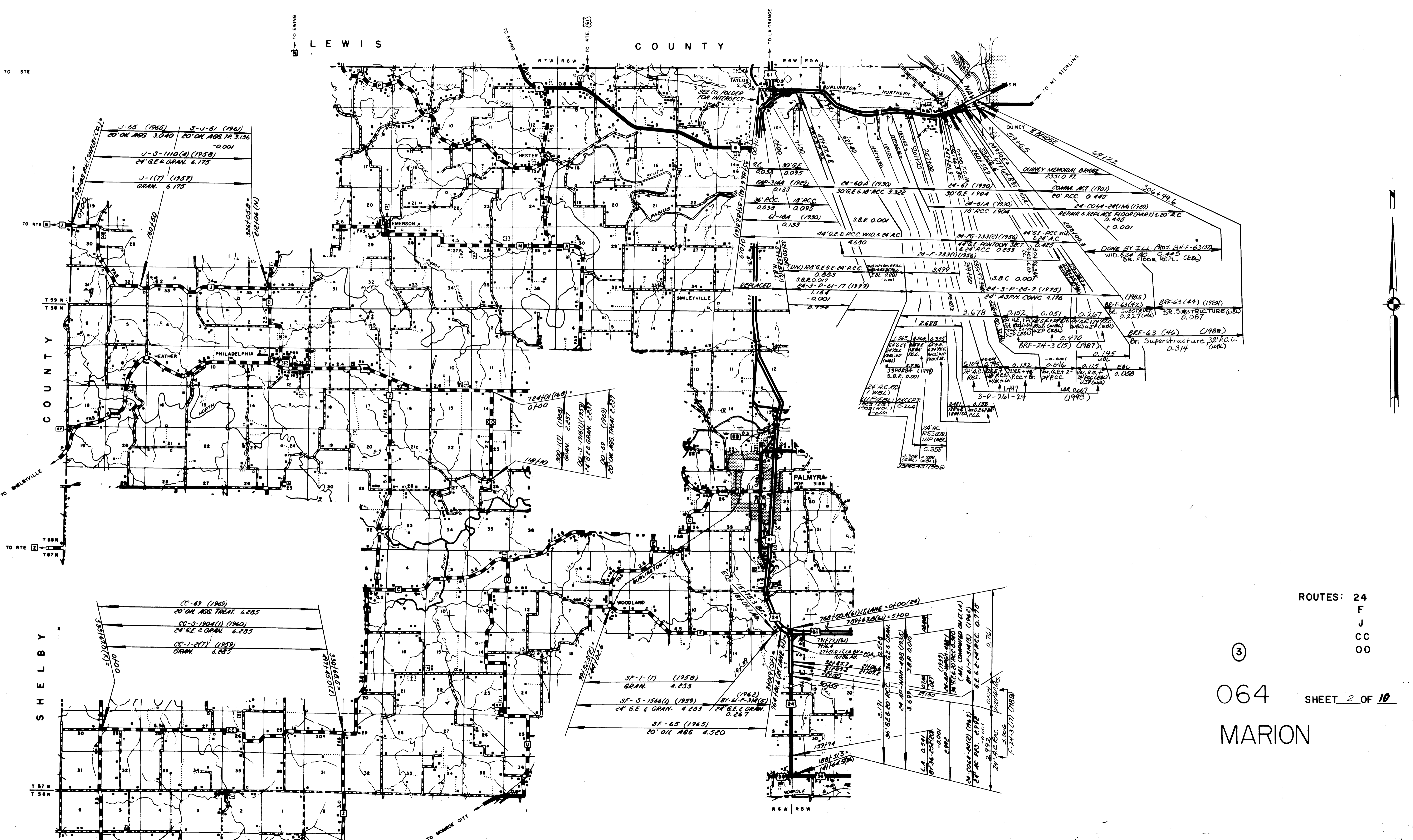

ROUTES: 24  
F  
J  
CC  
00

(3)

064 SHEET 2 OF 10

MARION



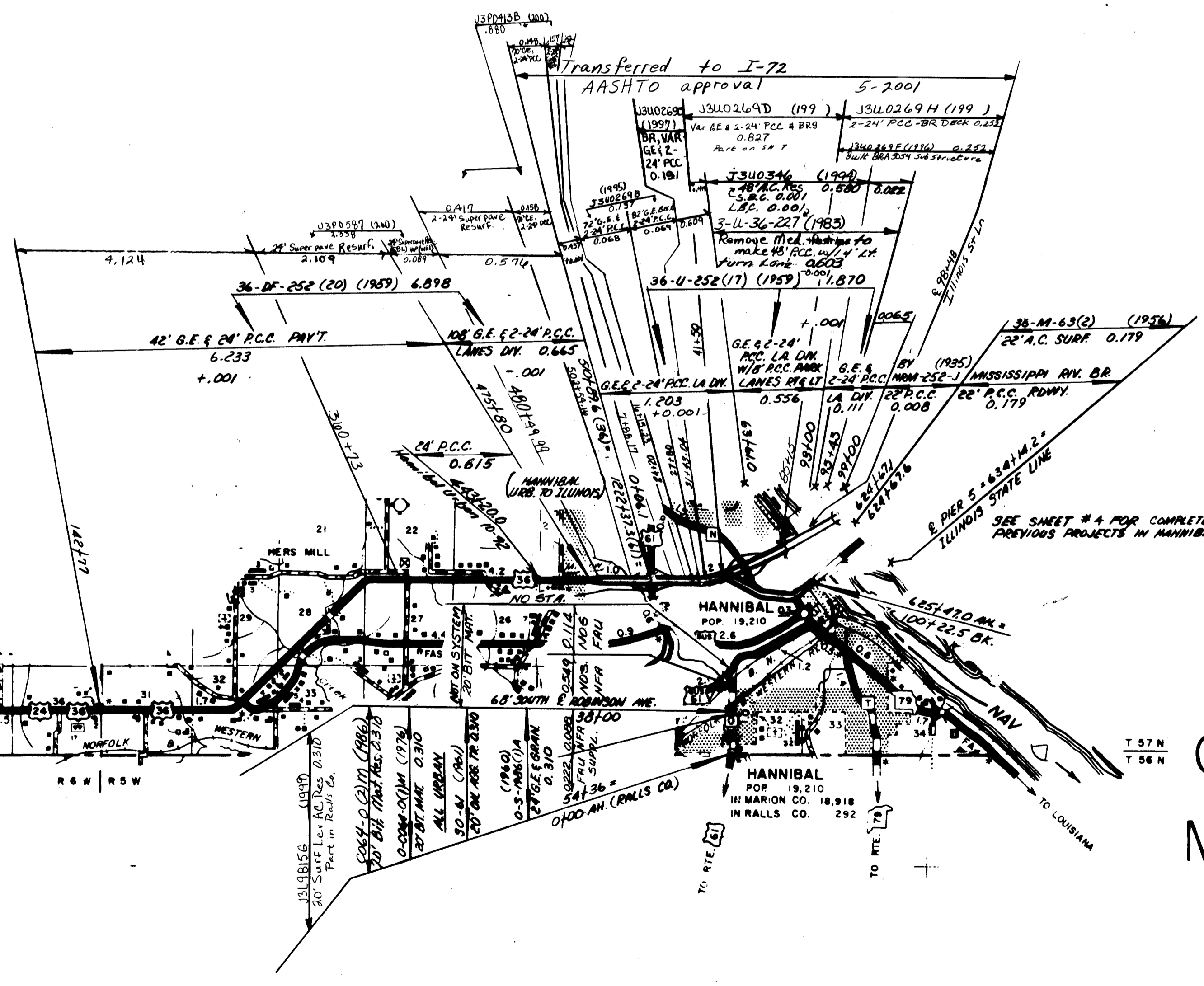
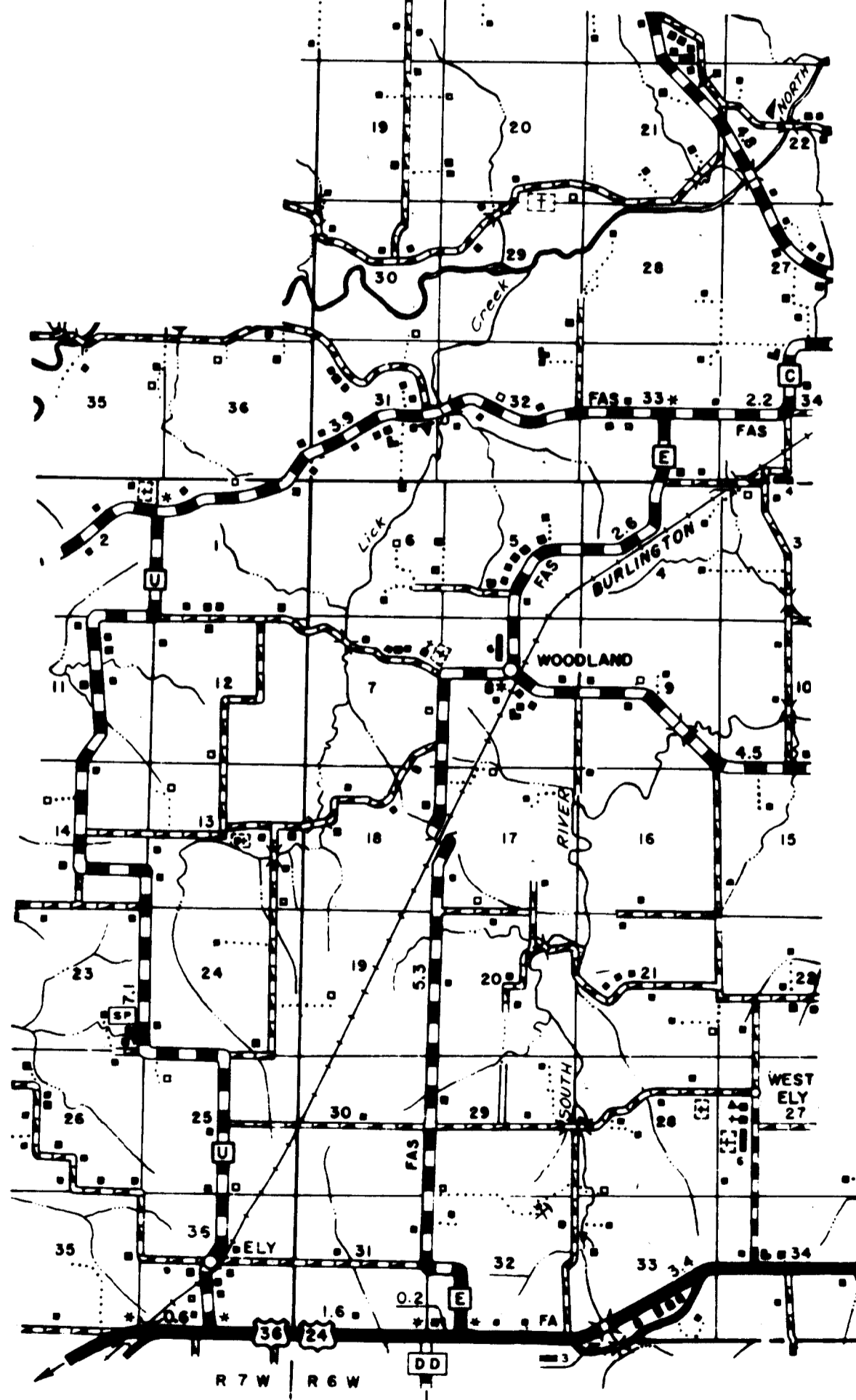
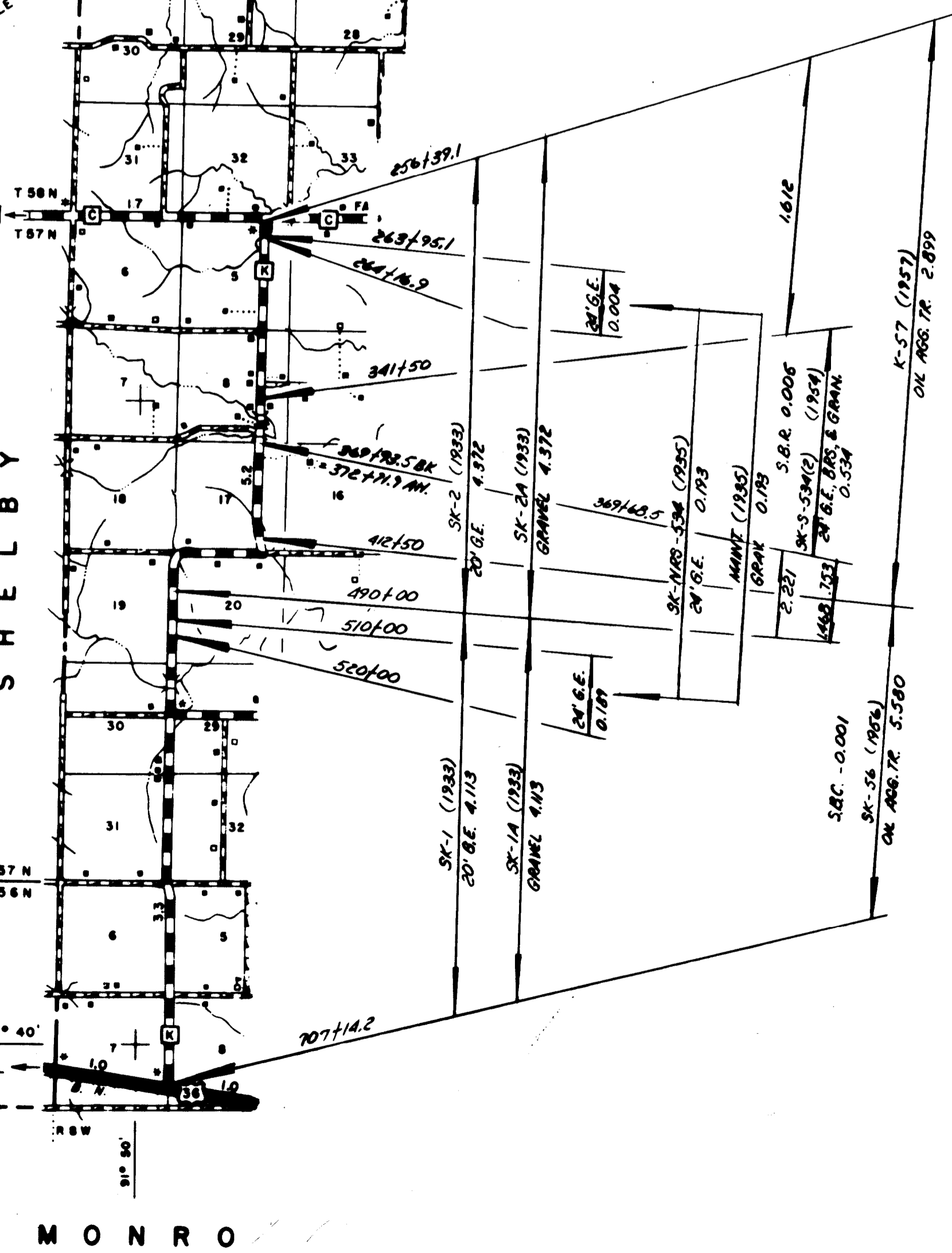
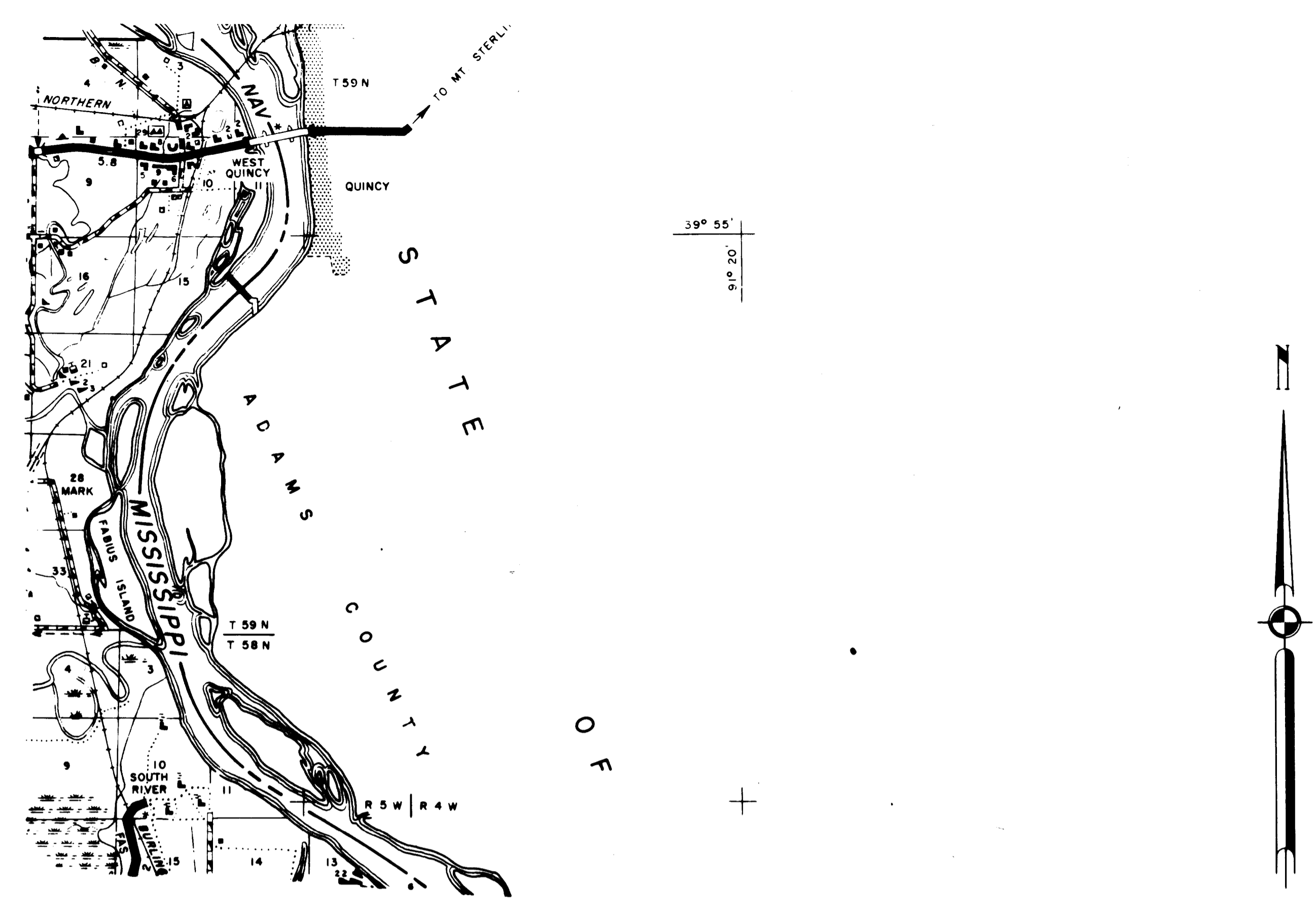
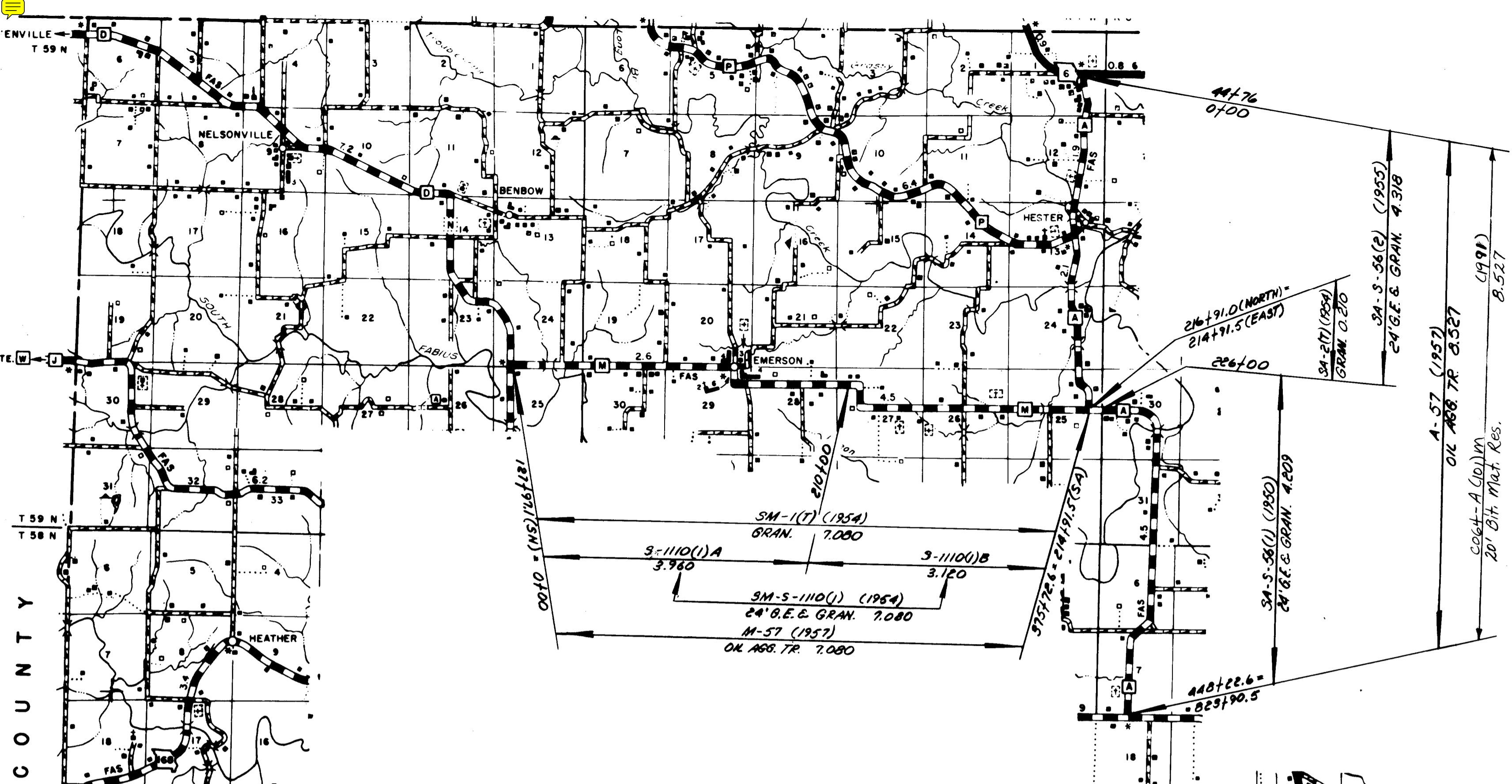

ROUTES  
 36 (PART)  
 A  
 K  
 M  
 O  
 I-72

064  
 MARION

SHEET 3 OF 10



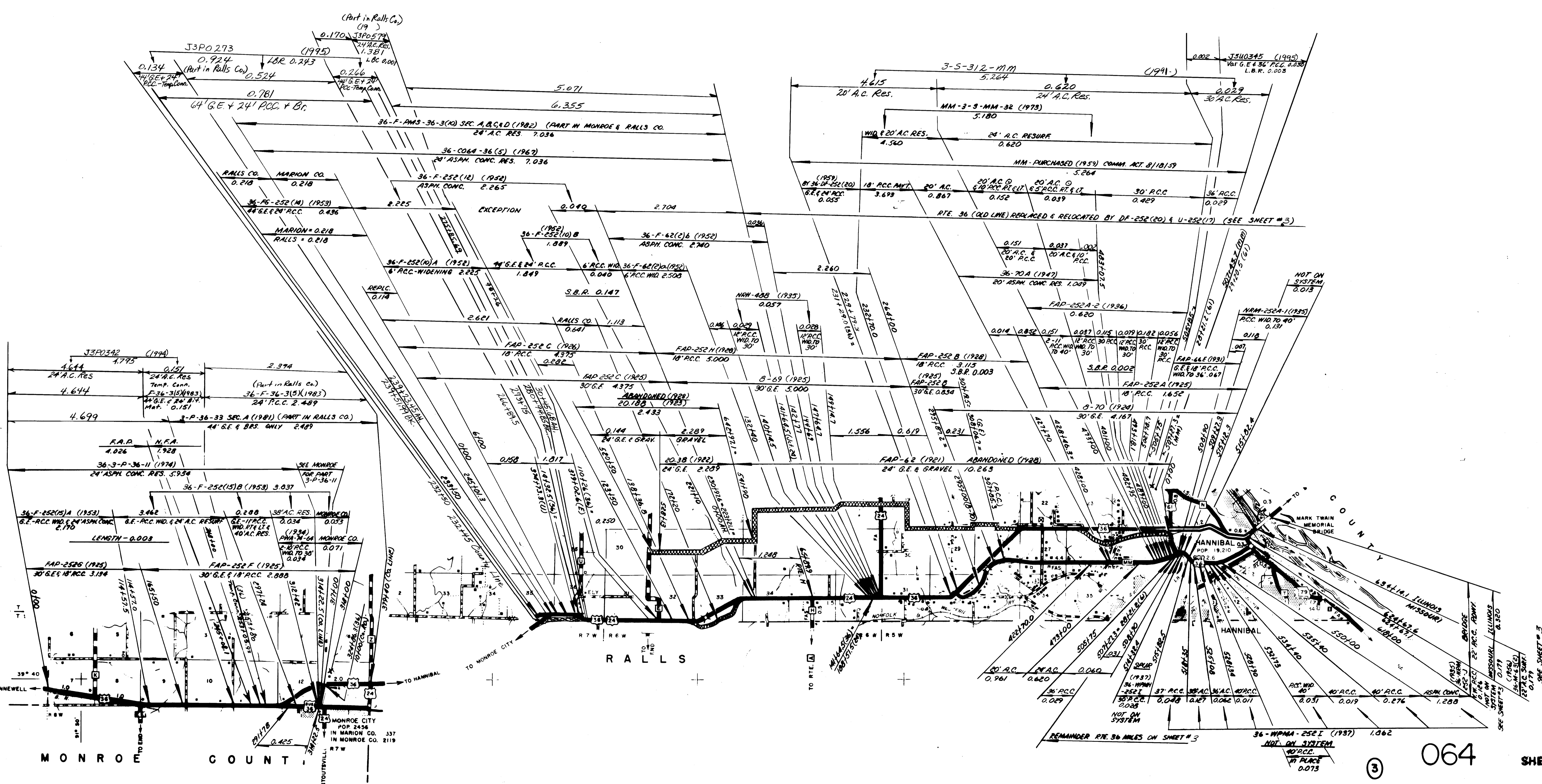

ROUTES:  
36(PART)  
MM

064  
MARION

SHEET 4 OF 10

3

MONROE COUNTY

MARION COUNTY

RALLS COUNTY

HANNIBAL

MARK TWAIN MEMORIAL BRIDGE

ILLINOIS MISSOURI BRIDGE



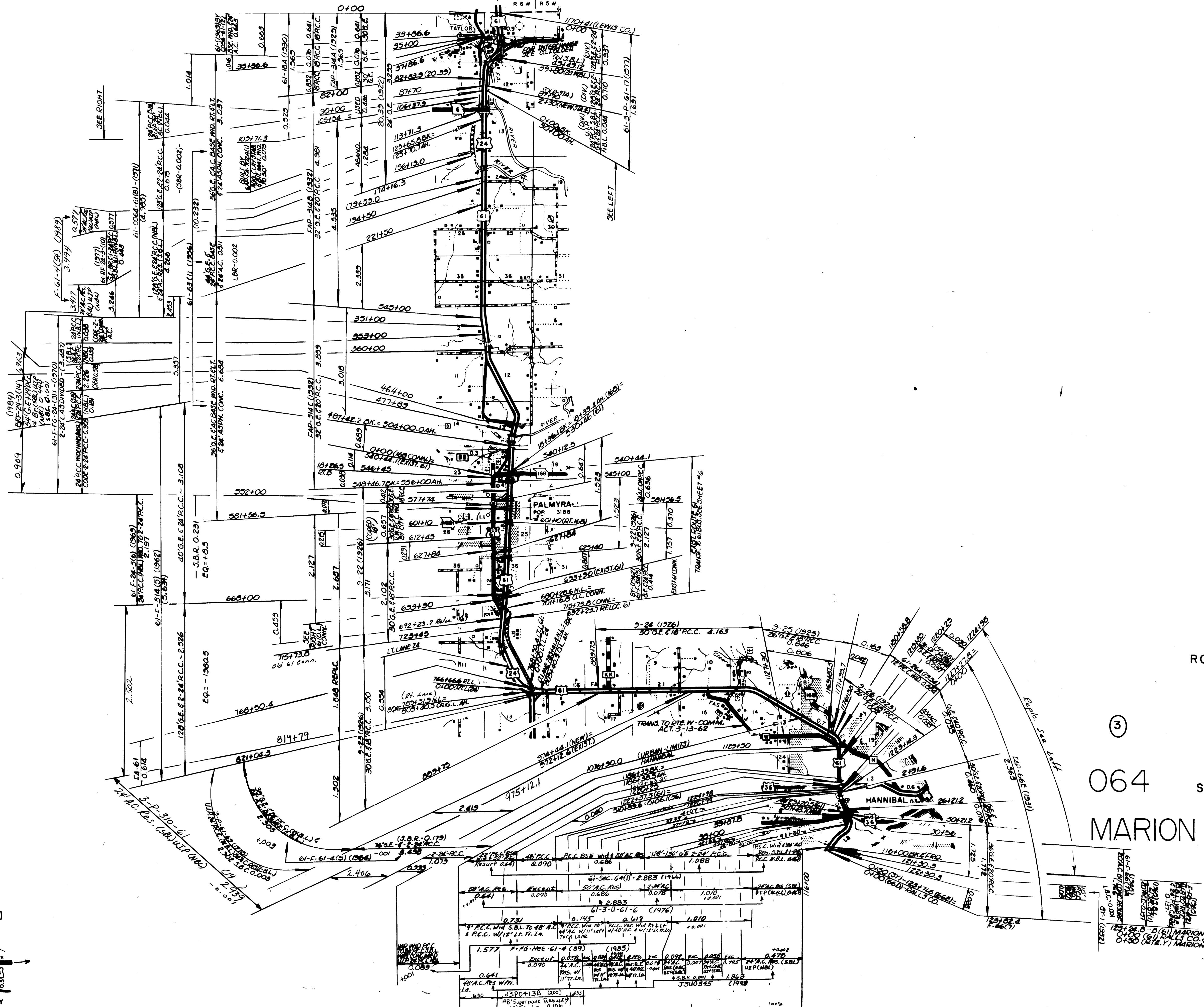

ROUTES 61

064  
MARION

SHEET 5 OF 10

125+24.6 - D(6) MARION CO. = 0+00 (6) RALLS CO. = 0+00 (6.5) MARION CO.

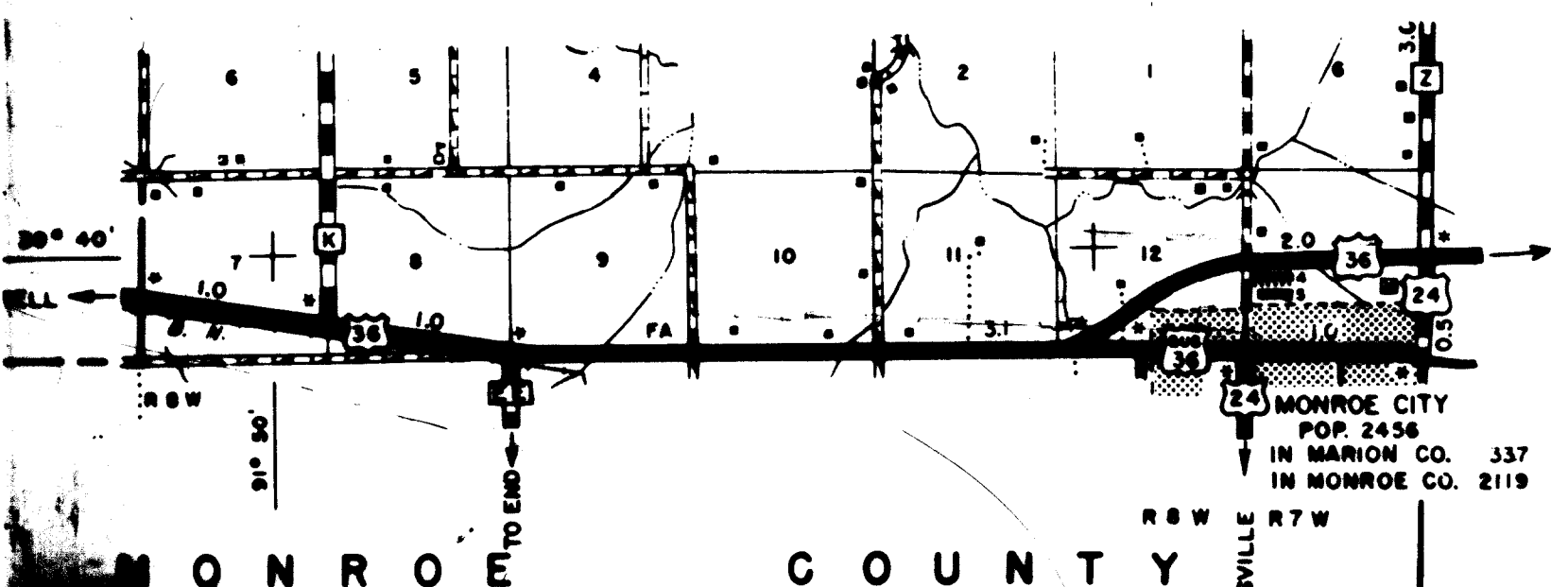

MONROE COUNTY



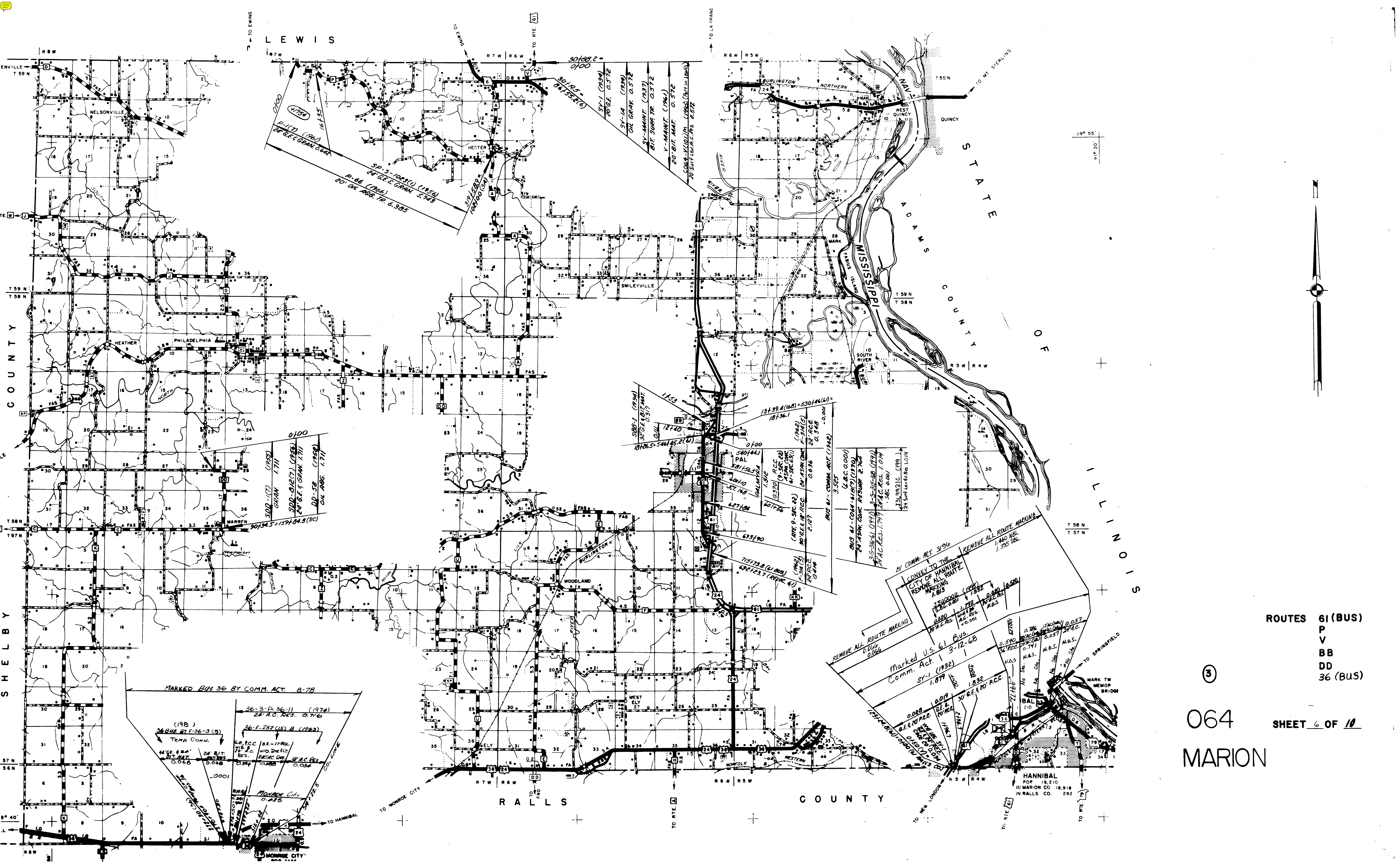

ROUTES 61 (BUS)  
 P  
 V  
 BB  
 DD  
 36 (BUS)

064  
 MARION

SHEET 6 OF 10



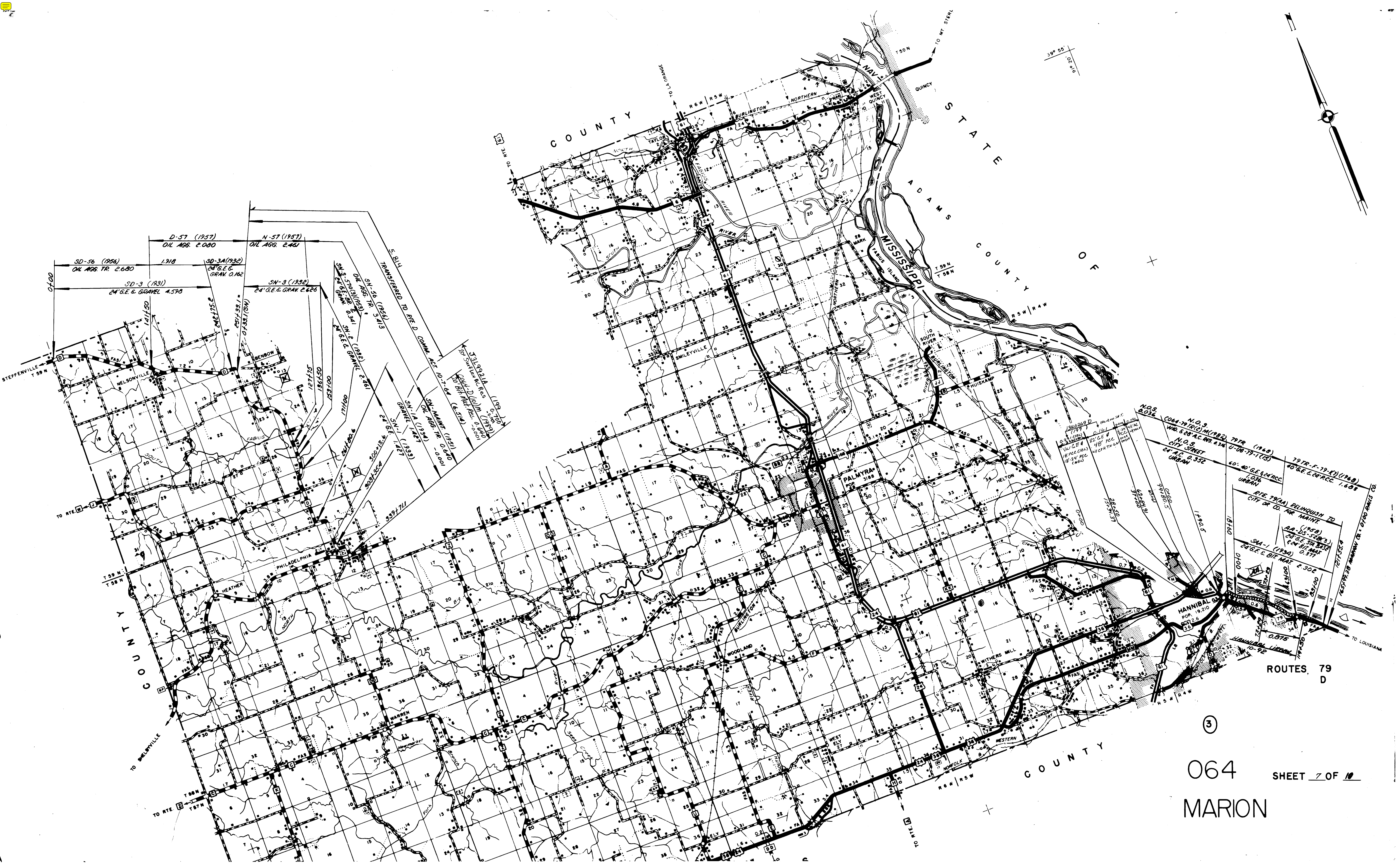

D-57 (1957)  
 OIL AGG. 2.000  
 N-57 (1957)  
 OIL AGG. 2.401  
 SD-56 (1956)  
 OIL AGG. TR. 2.680  
 SD-3 (1931)  
 24' G.E. & GRAVEL 4.598  
 SD-3A (1932)  
 24' G.E. & GRAVEL 0.162  
 SN-3 (1952)  
 24' G.E. & GRAVEL 2.626  
 SN-56 (1955)  
 24' G.E. & GRAVEL 2.461  
 SN-57 (1957)  
 24' G.E. & GRAVEL 2.413  
 SN-14 (1934)  
 24' G.E. & GRAVEL 1.421  
 SN-11 (1933)  
 24' G.E. & GRAVEL 2.461  
 SN-17 (1937)  
 24' G.E. & GRAVEL 0.601  
 SN-18 (1938)  
 24' G.E. & GRAVEL 0.601  
 SN-19 (1939)  
 24' G.E. & GRAVEL 0.601  
 SN-20 (1940)  
 24' G.E. & GRAVEL 0.601  
 SN-21 (1941)  
 24' G.E. & GRAVEL 0.601  
 SN-22 (1942)  
 24' G.E. & GRAVEL 0.601  
 SN-23 (1943)  
 24' G.E. & GRAVEL 0.601  
 SN-24 (1944)  
 24' G.E. & GRAVEL 0.601  
 SN-25 (1945)  
 24' G.E. & GRAVEL 0.601  
 SN-26 (1946)  
 24' G.E. & GRAVEL 0.601  
 SN-27 (1947)  
 24' G.E. & GRAVEL 0.601  
 SN-28 (1948)  
 24' G.E. & GRAVEL 0.601  
 SN-29 (1949)  
 24' G.E. & GRAVEL 0.601  
 SN-30 (1950)  
 24' G.E. & GRAVEL 0.601  
 SN-31 (1951)  
 24' G.E. & GRAVEL 0.601  
 SN-32 (1952)  
 24' G.E. & GRAVEL 0.601  
 SN-33 (1953)  
 24' G.E. & GRAVEL 0.601  
 SN-34 (1954)  
 24' G.E. & GRAVEL 0.601  
 SN-35 (1955)  
 24' G.E. & GRAVEL 0.601  
 SN-36 (1956)  
 24' G.E. & GRAVEL 0.601  
 SN-37 (1957)  
 24' G.E. & GRAVEL 0.601  
 SN-38 (1958)  
 24' G.E. & GRAVEL 0.601  
 SN-39 (1959)  
 24' G.E. & GRAVEL 0.601  
 SN-40 (1960)  
 24' G.E. & GRAVEL 0.601  
 SN-41 (1961)  
 24' G.E. & GRAVEL 0.601  
 SN-42 (1962)  
 24' G.E. & GRAVEL 0.601  
 SN-43 (1963)  
 24' G.E. & GRAVEL 0.601  
 SN-44 (1964)  
 24' G.E. & GRAVEL 0.601  
 SN-45 (1965)  
 24' G.E. & GRAVEL 0.601  
 SN-46 (1966)  
 24' G.E. & GRAVEL 0.601  
 SN-47 (1967)  
 24' G.E. & GRAVEL 0.601  
 SN-48 (1968)  
 24' G.E. & GRAVEL 0.601  
 SN-49 (1969)  
 24' G.E. & GRAVEL 0.601  
 SN-50 (1970)  
 24' G.E. & GRAVEL 0.601  
 SN-51 (1971)  
 24' G.E. & GRAVEL 0.601  
 SN-52 (1972)  
 24' G.E. & GRAVEL 0.601  
 SN-53 (1973)  
 24' G.E. & GRAVEL 0.601  
 SN-54 (1974)  
 24' G.E. & GRAVEL 0.601  
 SN-55 (1975)  
 24' G.E. & GRAVEL 0.601  
 SN-56 (1976)  
 24' G.E. & GRAVEL 0.601  
 SN-57 (1977)  
 24' G.E. & GRAVEL 0.601  
 SN-58 (1978)  
 24' G.E. & GRAVEL 0.601  
 SN-59 (1979)  
 24' G.E. & GRAVEL 0.601  
 SN-60 (1980)  
 24' G.E. & GRAVEL 0.601  
 SN-61 (1981)  
 24' G.E. & GRAVEL 0.601  
 SN-62 (1982)  
 24' G.E. & GRAVEL 0.601  
 SN-63 (1983)  
 24' G.E. & GRAVEL 0.601  
 SN-64 (1984)  
 24' G.E. & GRAVEL 0.601  
 SN-65 (1985)  
 24' G.E. & GRAVEL 0.601  
 SN-66 (1986)  
 24' G.E. & GRAVEL 0.601  
 SN-67 (1987)  
 24' G.E. & GRAVEL 0.601  
 SN-68 (1988)  
 24' G.E. & GRAVEL 0.601  
 SN-69 (1989)  
 24' G.E. & GRAVEL 0.601  
 SN-70 (1990)  
 24' G.E. & GRAVEL 0.601  
 SN-71 (1991)  
 24' G.E. & GRAVEL 0.601  
 SN-72 (1992)  
 24' G.E. & GRAVEL 0.601  
 SN-73 (1993)  
 24' G.E. & GRAVEL 0.601  
 SN-74 (1994)  
 24' G.E. & GRAVEL 0.601  
 SN-75 (1995)  
 24' G.E. & GRAVEL 0.601  
 SN-76 (1996)  
 24' G.E. & GRAVEL 0.601  
 SN-77 (1997)  
 24' G.E. & GRAVEL 0.601  
 SN-78 (1998)  
 24' G.E. & GRAVEL 0.601  
 SN-79 (1999)  
 24' G.E. & GRAVEL 0.601  
 SN-80 (2000)  
 24' G.E. & GRAVEL 0.601  
 SN-81 (2001)  
 24' G.E. & GRAVEL 0.601  
 SN-82 (2002)  
 24' G.E. & GRAVEL 0.601  
 SN-83 (2003)  
 24' G.E. & GRAVEL 0.601  
 SN-84 (2004)  
 24' G.E. & GRAVEL 0.601  
 SN-85 (2005)  
 24' G.E. & GRAVEL 0.601  
 SN-86 (2006)  
 24' G.E. & GRAVEL 0.601  
 SN-87 (2007)  
 24' G.E. & GRAVEL 0.601  
 SN-88 (2008)  
 24' G.E. & GRAVEL 0.601  
 SN-89 (2009)  
 24' G.E. & GRAVEL 0.601  
 SN-90 (2010)  
 24' G.E. & GRAVEL 0.601  
 SN-91 (2011)  
 24' G.E. & GRAVEL 0.601  
 SN-92 (2012)  
 24' G.E. & GRAVEL 0.601  
 SN-93 (2013)  
 24' G.E. & GRAVEL 0.601  
 SN-94 (2014)  
 24' G.E. & GRAVEL 0.601  
 SN-95 (2015)  
 24' G.E. & GRAVEL 0.601  
 SN-96 (2016)  
 24' G.E. & GRAVEL 0.601  
 SN-97 (2017)  
 24' G.E. & GRAVEL 0.601  
 SN-98 (2018)  
 24' G.E. & GRAVEL 0.601  
 SN-99 (2019)  
 24' G.E. & GRAVEL 0.601  
 SN-100 (2020)  
 24' G.E. & GRAVEL 0.601

N.O.S. 6036  
 CO. 4-7872 (1982) 7872  
 W.D. 8-28 AC. RD. 430 U-08-78-1 (1982)  
 N.O.S. 6037  
 CITY STREET  
 24' G.E. & GRAVEL 0.352  
 URBAN  
 7872-F-78-1 (1982)  
 40' G.E. & GRAVEL 1.681  
 URBAN  
 PLE. PRMA. REINQUISH TO  
 CITY OF CO. FOR MAINT.  
 (1958)  
 AD-05-5283  
 24' G.E. & GRAVEL  
 24' G.E. & GRAVEL 0.371  
 (1950)  
 SMA-1  
 24' G.E. & GRAVEL 2.302  
 URBAN  
 0.875  
 HANNIBAL LIBRY  
 0-92  
 TO LOUISIANA

③  
 064  
 MARION  
 SHEET 7 OF 10  
 ROUTES 79 D



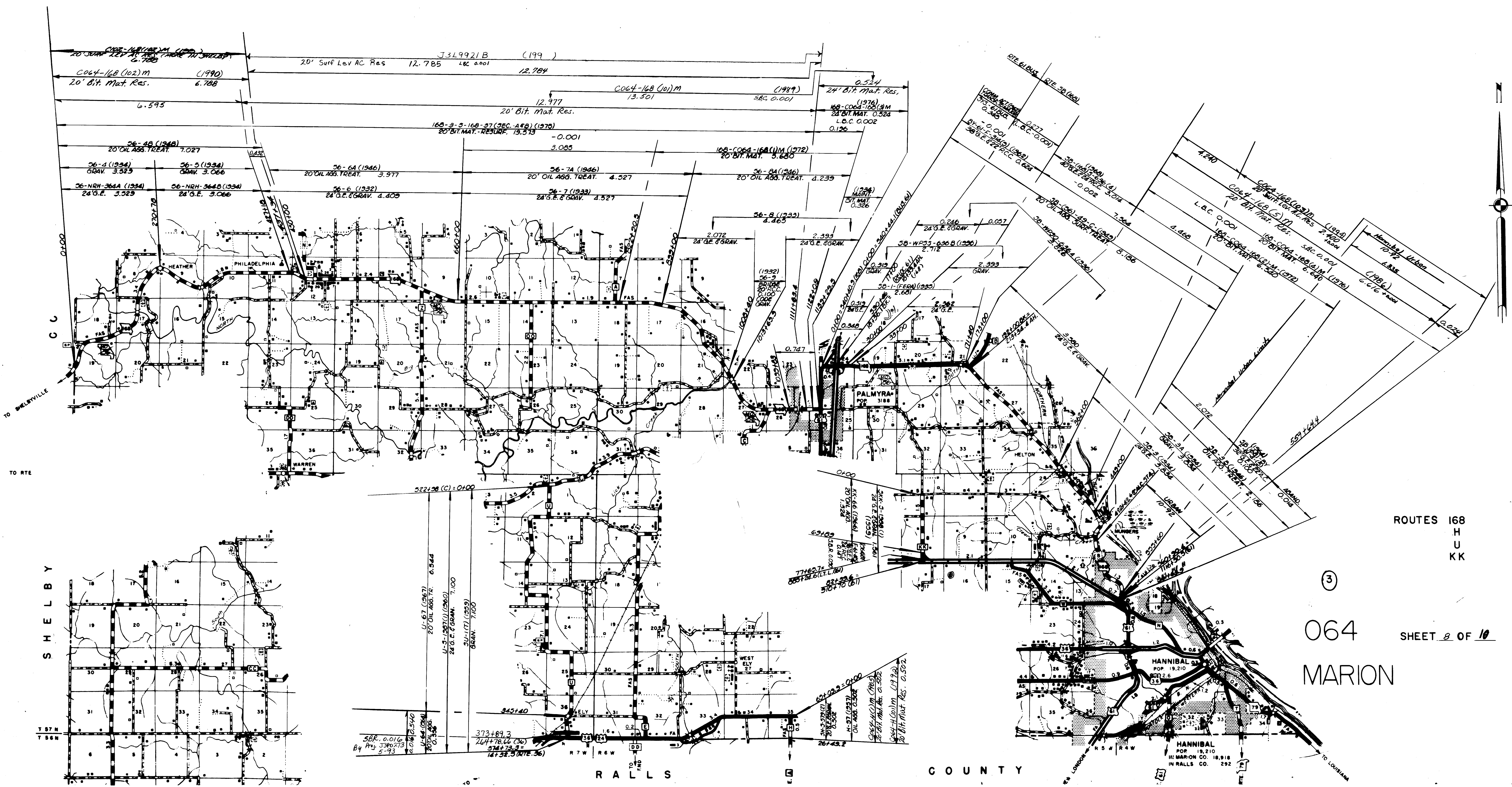

064  
MARION

SHEET 8 OF 10

HANNIBAL  
POP. 19,210  
IN MARION CO. 18,918  
IN RALLS CO. 292







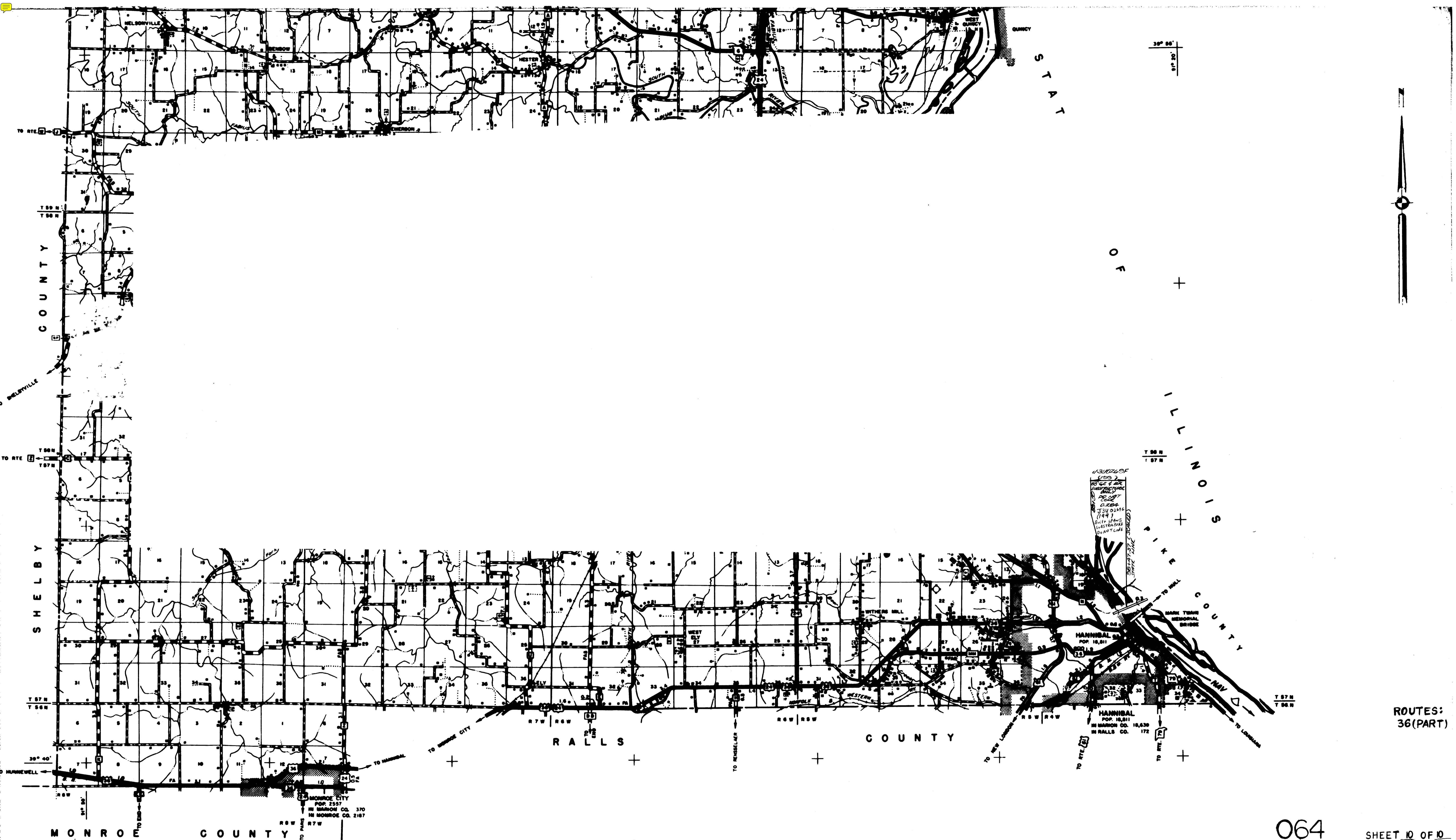

ROUTES:  
36(PART)

— L E G E N D —

064  
MARION

SHEET 10 OF 10