

COUNTY

COUNTY

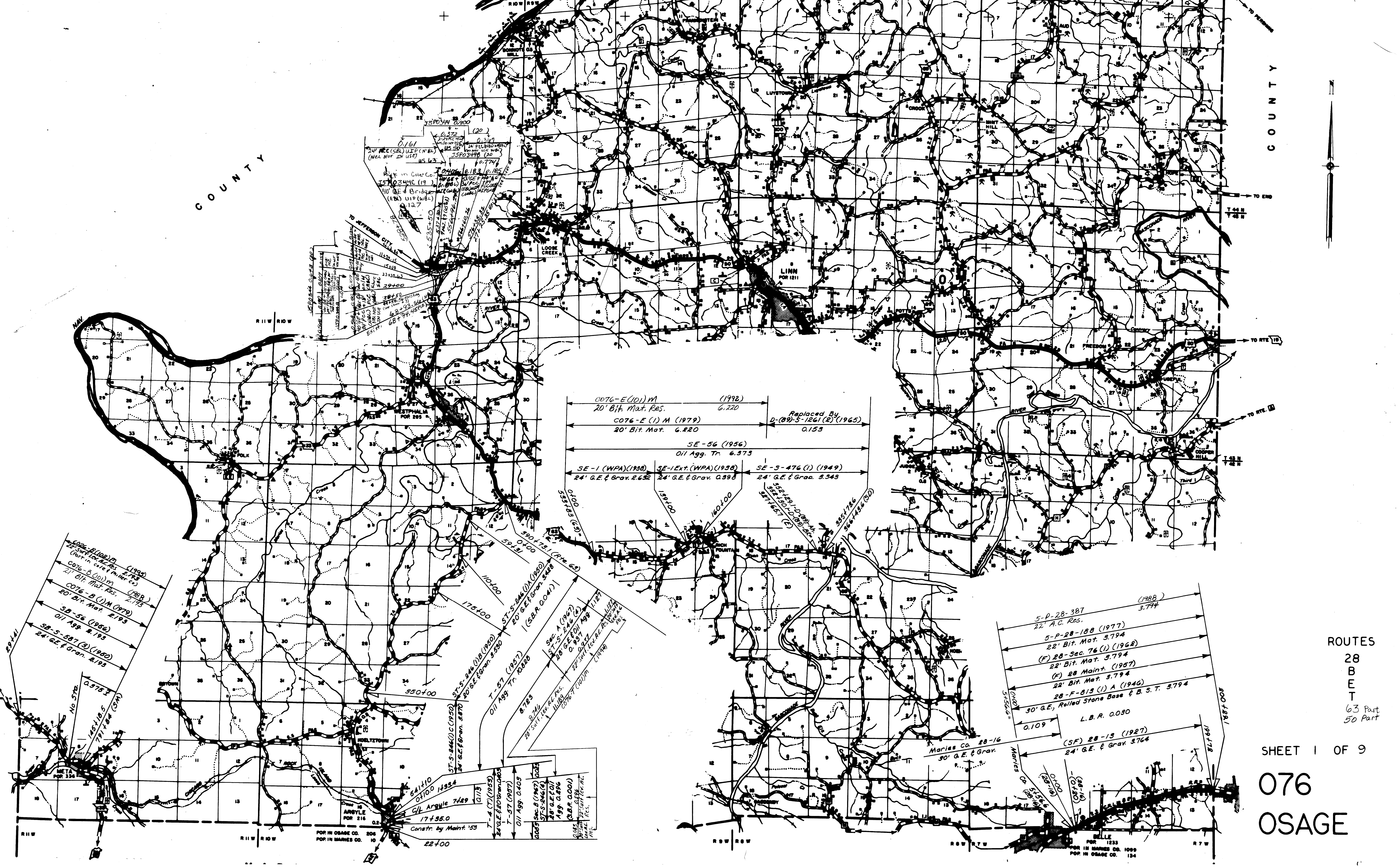

0076-E(101)M (1992)
20' Bit. Mat. Res. 6.220

0076-E(1)M (1979)
20' Bit. Mat. 6.220

SE-56 (1956)
Oil Agg. Tr. 6.373

SE-1 (WPA)(1938) 24' G.E. & Grav. 2.632

SE-1-Ext. (WPA)(1938) 24' G.E. & Grav. 0.998

SE-3-476(1) (1949)
24' G.E. & Grav. 3.348

Replaced By
D-(09)-5-1261(E) (1965)
0.153

0076-B(100)M (1992)
20' Surf. for Res. 2.794

0076-B(100)M (1988)
20' Bit. Mat. Res. 2.715

0076-B(1)M (1979)
20' Bit. Mat. 2.193

5B-56 (1956)
Oil Agg. 2.193

5B-5-587(2) (1982)
24' G.E. & Grav. 2.193

5-P-28-387 (1988)
22' A.C. Res. 3.794

5-P-28-188 (1977)
22' Bit. Mat. 3.794

(F) 28-Sec. 76(1) (1968)
22' Bit. Mat. 3.794

(F) 28 Maint. (1957)
22' Bit. Mat. 3.794

28-F-815(1) A (1946)
20' Bit. Mat. 3.794

30' G.E. Rolled Stone Base & B.S.T. 3.794

L.B.R. 0.030

(SF) 28-13 (1927)
24' G.E. & Grav. 3.764

ROUTES
28
B
E
T
63 Part
50 Part

SHEET 1 OF 9

076
OSAGE

FOR IN OSAGE CO. 206
FOR IN MARIES CO. 10

FOR IN MARIES CO. 1099
FOR IN OSAGE CO. 134

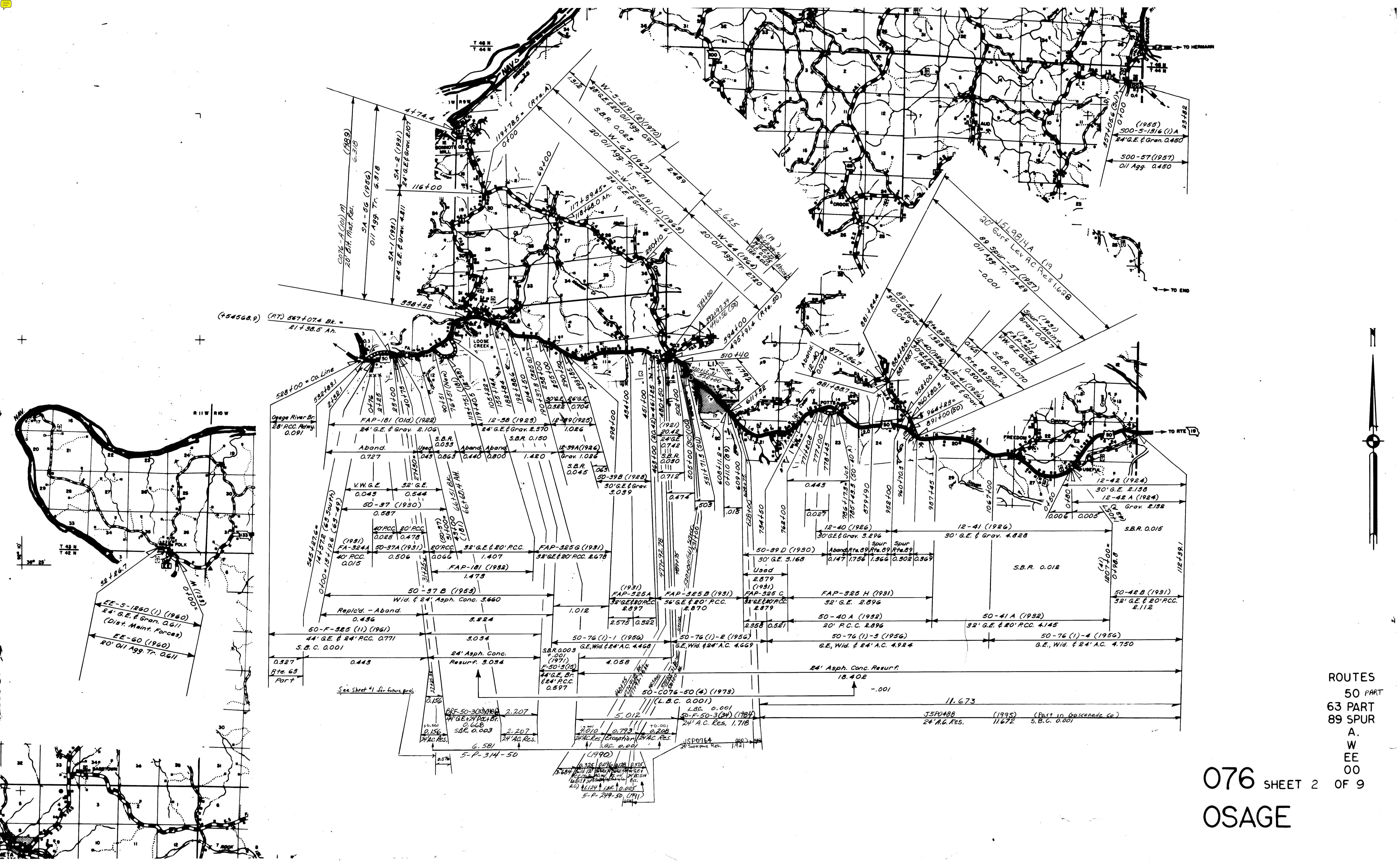

(+54568.9) (RT) 567+07.4 Bk. =
21+38.5 Ah.

ROUTES
50 PART
63 PART
89 SPUR
A.
W
EE
OO

076 SHEET 2 OF 9
OSAGE

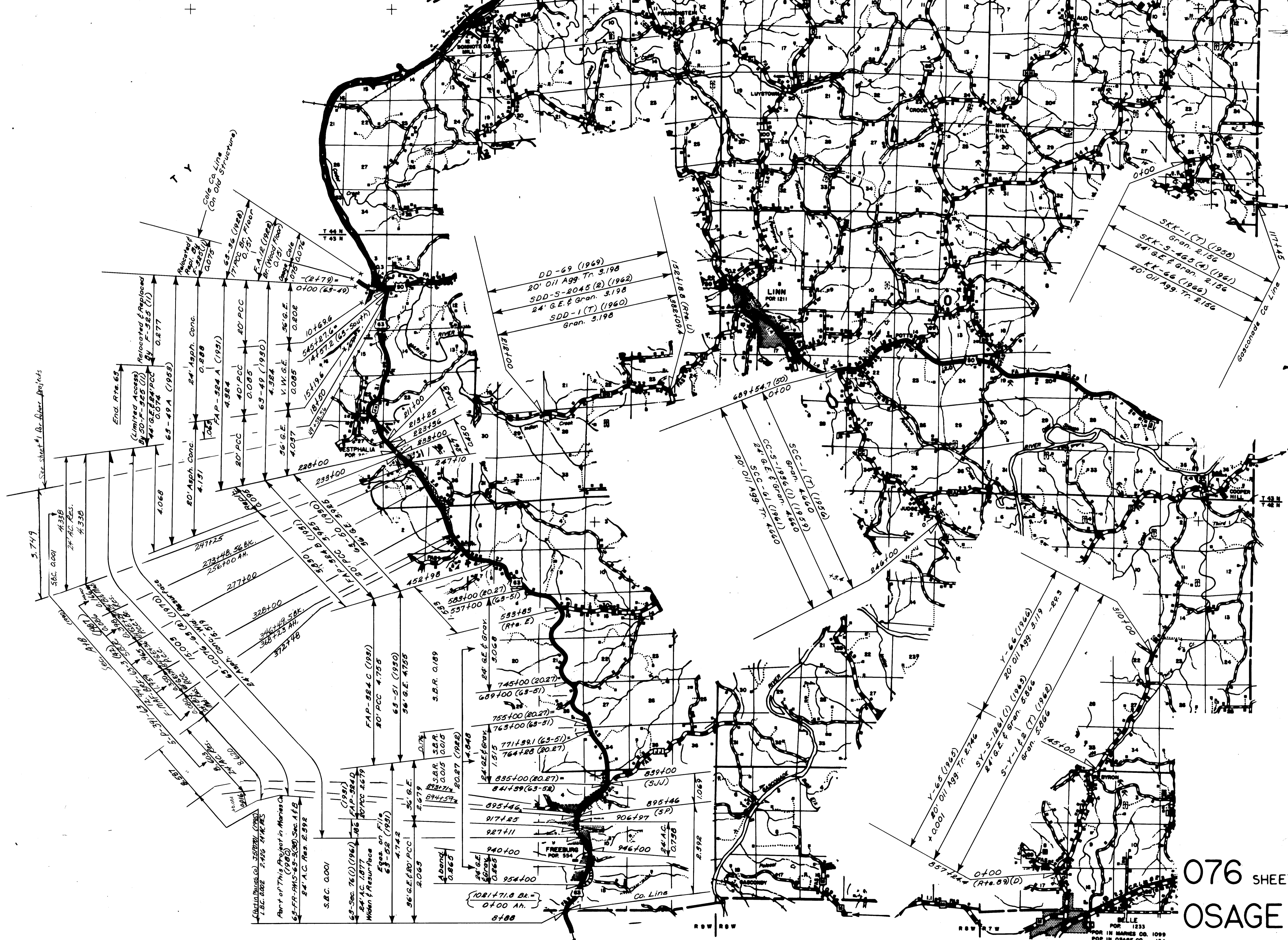

ROUTES
63 (PART)
Y
CC
DD
KK

076 SHEET 3 OF 9
OSAGE

BELLE
POP. 1233
POP. IN MARIES CO. 1099
POP. IN OSAGE CO. 134

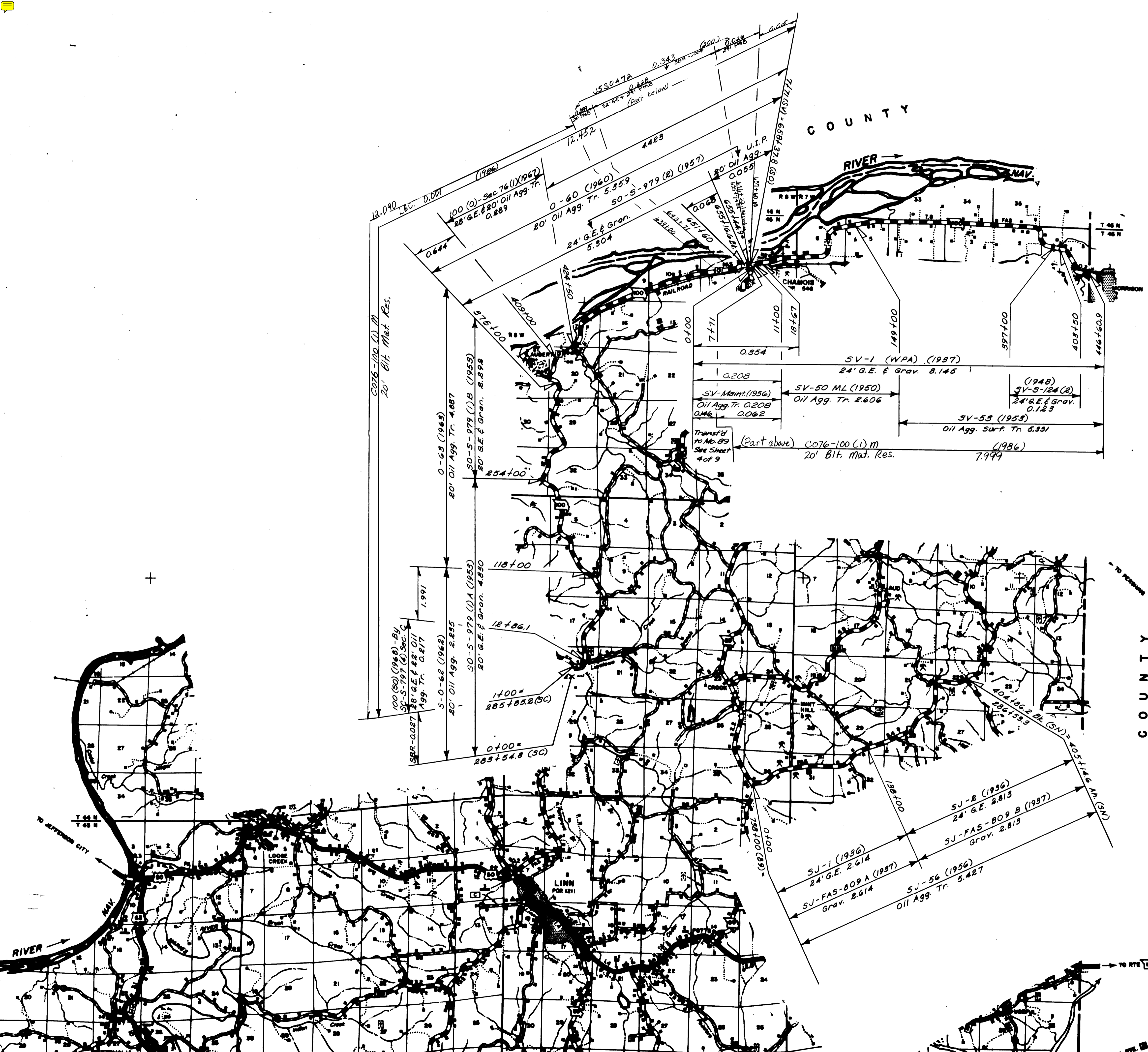

ROUTES
100 (O&V) PART
J PART

076 SHEET 5 OF 9
OSAGE

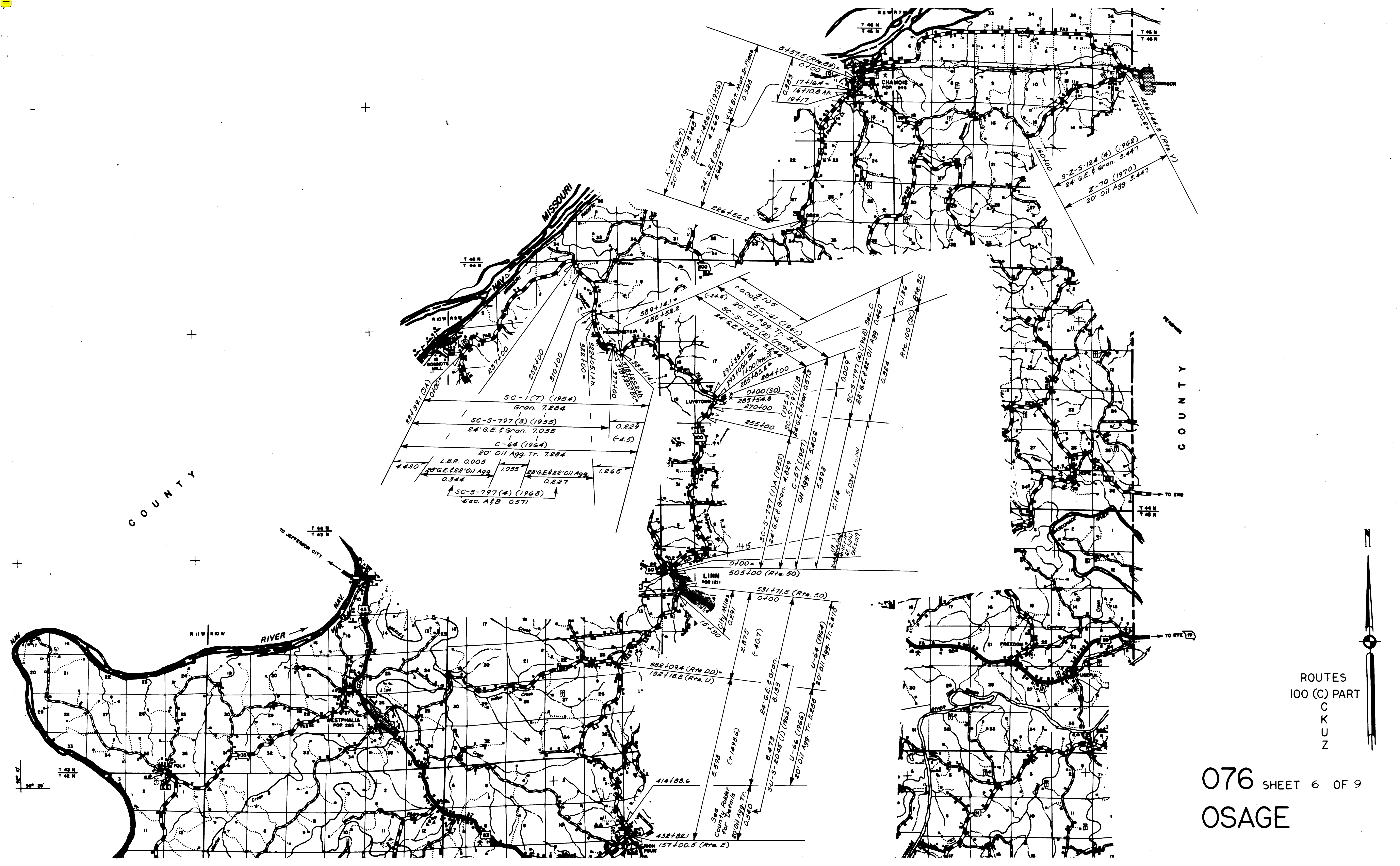

COUNTY

COUNTY

ROUTES
100 (C) PART
C
K
U
Z

076 SHEET 6 OF 9
OSAGE

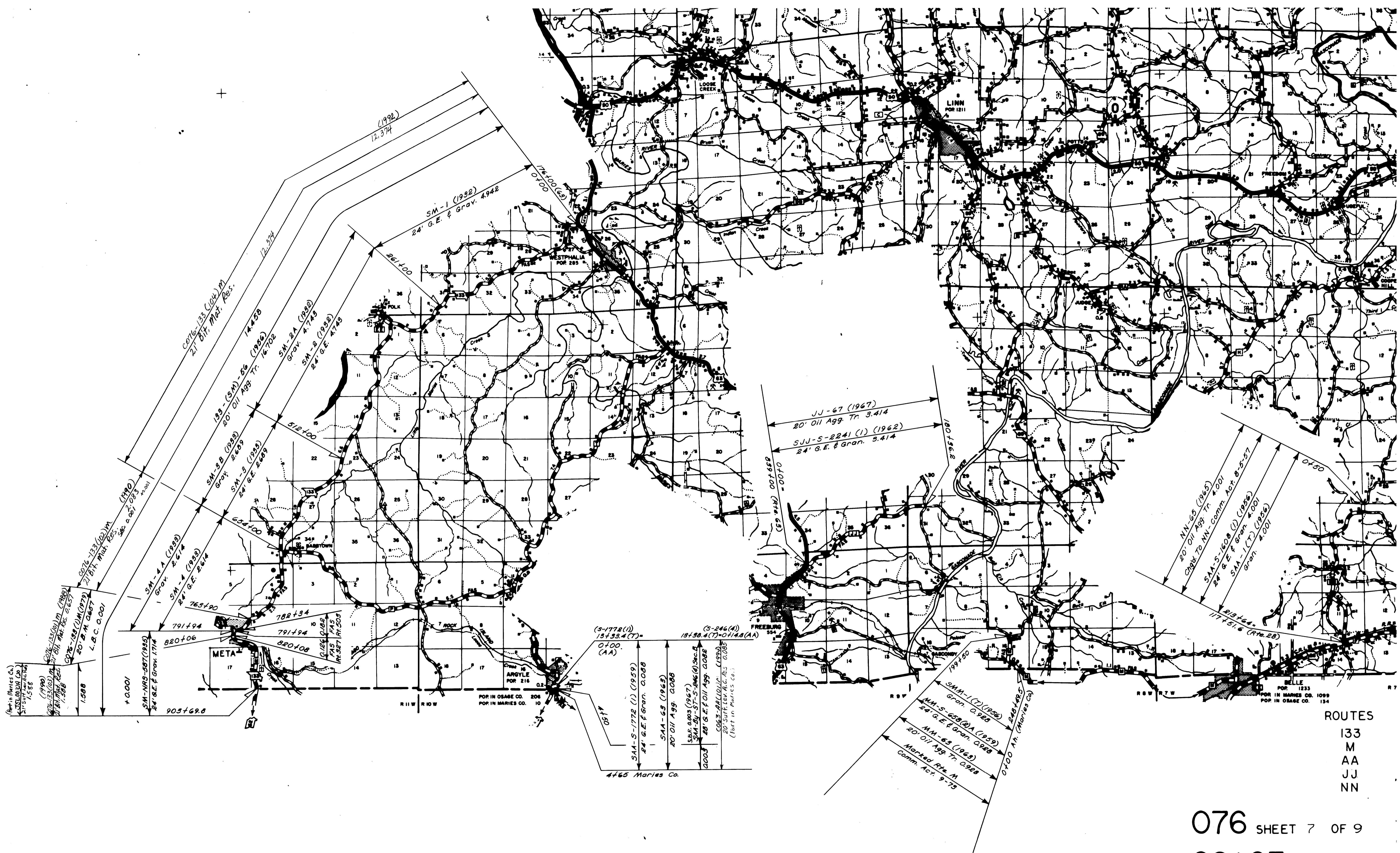

- ROUTES
 133
 M
 AA
 JJ
 NN

076 SHEET 7 OF 9
 OSAGE

(Part in Maries Co.)
 217 S.W. 1/4 Sec. 17, T. 27 N., R. 10 W.
 1.588
 (1990)
 2076-133(103) M
 217 S.W. 1/4 Mat. Res.
 1.588
 2076-133(103) M
 217 S.W. 1/4 Mat. Res.
 1.588
 (1990)
 2076-133(103) M
 217 S.W. 1/4 Mat. Res.
 1.588
 L.B.C. 0.001

+0.001
 SM-NRS-587(1955)
 24' G.E. f Grav. 1714
 903+69.8
 SM-4-A (1953)
 1 Grav. 2.614
 SM-4 (1953)
 24' G.E. 2.614
 763+90
 SM-3-B (1953)
 Grav. 2.609
 SM-3 (1953)
 24' G.E. 2.609
 604+100
 SM-2-A (1952)
 Grav. 4.743
 SM-2 (1952)
 24' G.E. 4.743
 512+100

791+94
 META
 17
 782+34
 791+94
 820+08
 G.L. 1261.082
 FAS FAS
 IN. 327 IN. 503

POP. IN OSAGE CO. 206
 POP. IN MARIES CO. 10
 ARGYLE
 POP. 216
 10
 17
 13
 14
 15
 16
 18
 19
 20
 21
 22
 23
 24
 25
 26
 27
 28
 29
 30
 31
 32
 33
 34
 35
 36

(S-1772(I))
 15+53.4(T)
 0+100
 (AA)
 4+65 Maries Co.
 SAA-5-1772(I) (1959)
 24' G.E. f Grav. 0.0088
 SAA-63 (1963)
 20' Oil Agg. 0.0088
 138.003 (1967)
 SAA-24-S7-S-AK(1) sec. 8
 28' G.E. f Oil Agg. 0.0082
 0003
 0063-241101A (1988)
 20' Surface Ag. 0.5 0.0085
 (Part in Maries Co.)

(S-246(A))
 13+50.4(T)-0+14.8(AA)
 0+100
 (AA)
 039+100 (Rte. 63)
 JJ-67 (1967)
 20' Oil Agg. Tr. 3.414
 SJJ-5-2241(I) (1962)
 24' G.E. f Grav. 3.414

199+50
 SAA-1(2) (1956)
 Grav. 0.125
 MM-5-258(A) (1953)
 24' G.E. f Grav. 0.928
 MM-63 (1963)
 20' Oil Agg. Tr. 0.928
 Marked Rte. A
 Comm. Act. 9-75
 0+100 Th. (Maries Co.)
 248+49.5

177+51.6 (Rte. 28)
 213+64
 NN-65 (1965)
 20' Oil Agg. Tr. 4.001
 SAA-5-1608(I) (1956)
 24' G.E. f Grav. 4.001
 SAA-(T) (1956)
 Grav. 4.001

POP. IN MARIES CO. 1233
 POP. IN OSAGE CO. 154
 BELLE
 17
 18
 19
 20
 21
 22
 23
 24
 25
 26
 27
 28
 29
 30
 31
 32
 33
 34
 35
 36

COUNTY

RIVER

GALLAWAY

MISSOURI

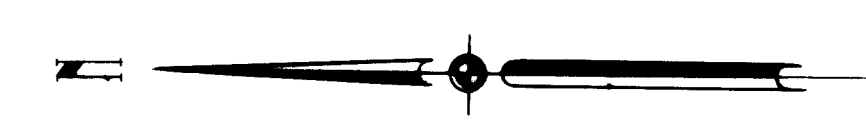
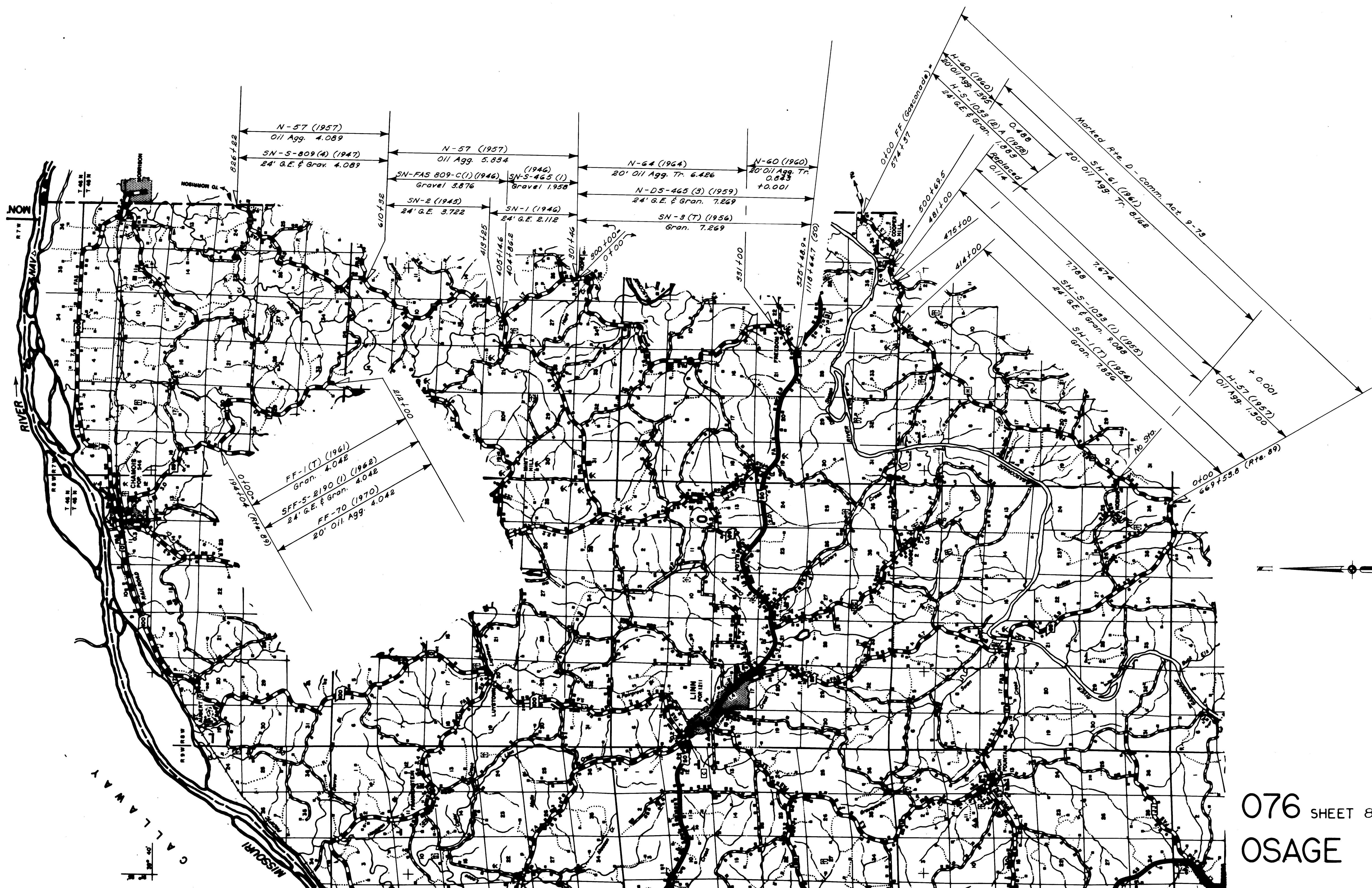

ROUTES
D
N
FF

076 SHEET 8 OF 9
OSAGE

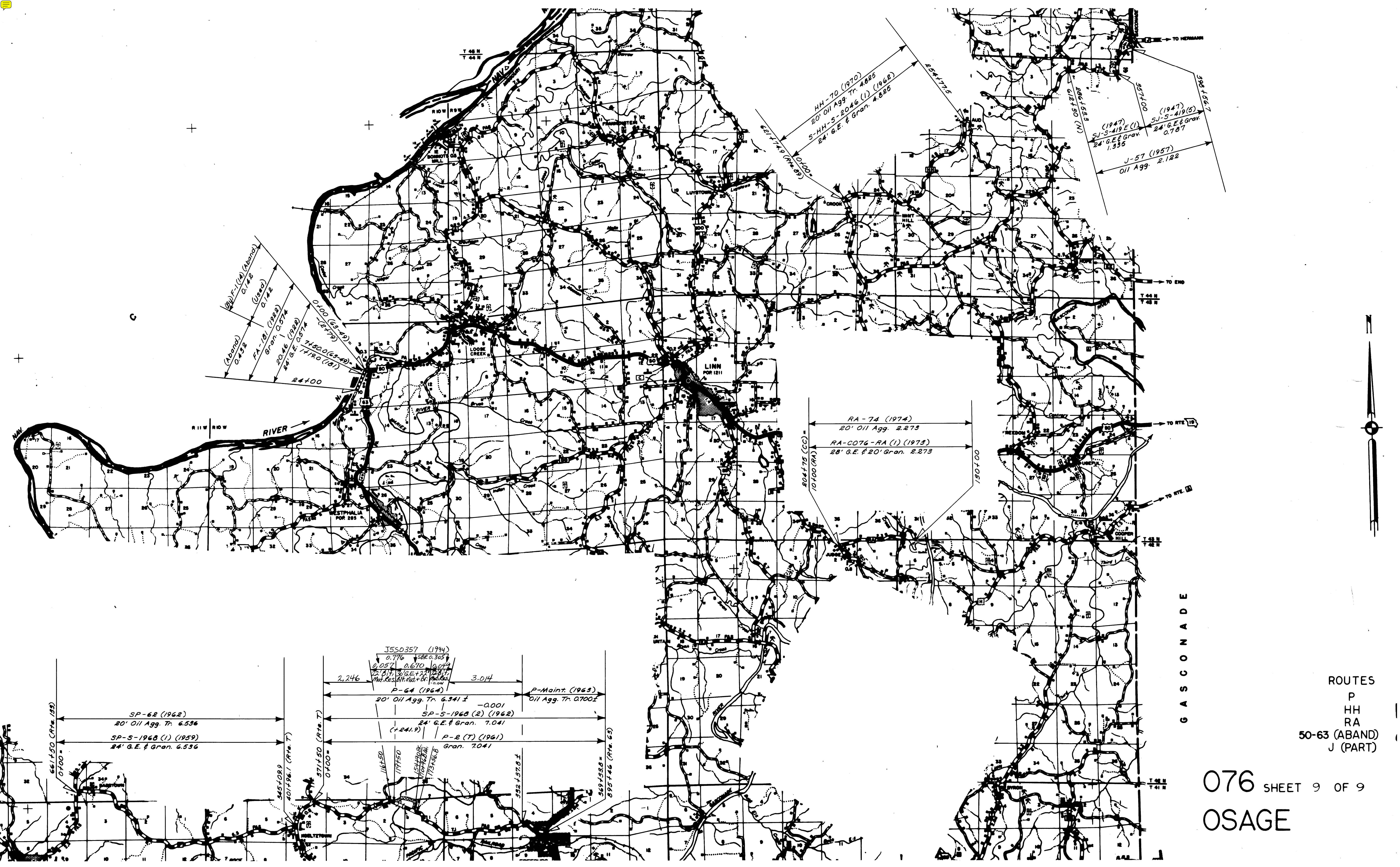

(Aband) 0.452
 (1947) 0.142
 (1947) 0.142
 FA-18 (1922) 0.700
 2046 (1922) 24' G.E. & Gran. 0.574
 14800 (6-49) 0.000
 14190 (3) 0.000
 24100

HH-70 (1970)
 20' Oil Agg. Tr. 4.825
 S-HH-S-2046 (1) (1962)
 24' G.E. & Gran. 4.825

(1947) 1.355
 SU-S-419 E (1) 24' G.E. & Gran.
 (1947) 0.787
 SJ-S-419 (5) 24' G.E. & Gran.
 J-57 (1957)
 Oil Agg. 2.122

RA-74 (1974)
 20' Oil Agg. 2.273
 RA-C076-RA (1) (1973)
 28' G.E. & 20' Gran. 2.273

661450 (Rte. 155) 0700
 3451099
 401496.7 (Rte. T)
 371450 (Rte. T) 0700
 116150
 177450
 154400K
 173450B
 382450.8
 369450.8
 395446 (Rte. 65)

2.246
 3.014
 P-64 (1964)
 20' Oil Agg. Tr. 6.341 ±
 P-Maint. (1963)
 Oil Agg. Tr. 0.700 ±
 SP-62 (1962)
 20' Oil Agg. Tr. 6.536
 SP-S-1968 (1) (1959)
 24' G.E. & Gran. 6.536
 SP-5-1968 (2) (1962)
 24' G.E. & Gran. 7.041
 P-2 (7) (1961)
 Gran. 7.041
 J550357 (1994)
 0.776 5820.305
 0.057 0.670 0.049
 22.617 30.6E+22 22.617
 Nat. Res. Bt. Mst. & Br. Poles

ROUTES
 P
 HH
 RA
 50-63 (ABAND)
 J (PART)

076 SHEET 9 OF 9
 OSAGE