

SHANNON

IOI ©

ROUTE

19 (PART)

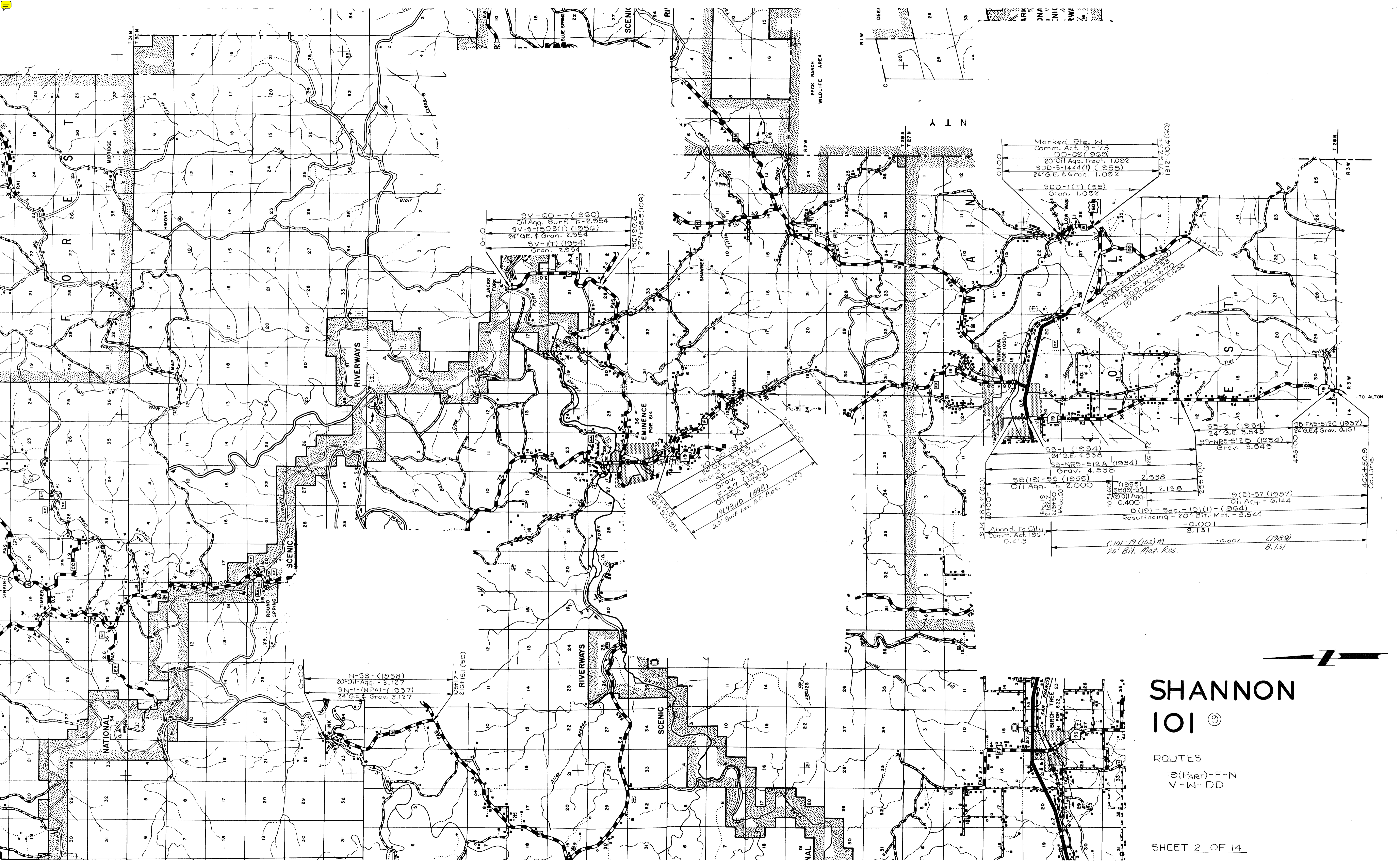

Marked Etc. W-1
 Comm. Act. 9-78
 DD-C2 (1969)
 20' Oil Aq. Treat. 1.092
 SDD-S-1444 (I) (1955)
 24' G.E. & Grav. 1.092

500-1(T) (55)
 Gran. 1.092

500-S-2116 (I) (1920)
 24' G.E. & Grav. 2.635
 SDD-70-1970
 20' Oil Aq. Tr. 2.635

5B-2 (1934)
 24' G.E. 3.845

5B-FAS-512C (1937)
 24' G.E. & Grav. 0.161

5B-NRS-512B (1934)
 Grav. 3.845

5B-1 (1934)
 24' G.E. 4.538

5B-NRS-512A (1934)
 Grav. 4.538

5B (19) - 55 (1955)
 Oil Aq. Tr. 2.000

5B (19) - 55 (1955)
 Oil Aq. Tr. 2.138

19(B)-57 (1937)
 Oil Aq. - 0.144

B (19) - Sec. - 101 (I) - (1964)
 Resurfacing - 20' Bit. - Mat. - 8.544

-0.001
 3.131

1934 4.832 (GO)
 Aband. To City
 Comm. Act. 1967
 0.413

C101-19 (102) M
 20' Bit. Mat. Res.

-0.001 (1959)
 8.131

N-58 - (1958)
 20' Oil Aq. - 3.127
 SN-1 - (WPA) - (1937)
 24' G.E. & Grav. 3.127

SV-60 -- (1960)
 Oil Aq. Surf. Tr. 2.954
 SV-S-1503 (I) (1956)
 24' G.E. & Grav. 2.954
 SV-1 (T) (1954)
 Gran. 2.954

5G+5G.5
 277+66.5 (10G)

20' AGO (1923)
 24' G.E. 3.153
 Aband. From Pop. Gr. 1-1
 SF (1933)
 Grav. 3.153
 F-57 (1957)
 Oil Aq. Tr. 3.153
 1919811D (1998)
 20' Surf. Lev. A.C. Res. 3.153

SHANNON IOI

ROUTES
 19 (PART) - F - N
 V - W - DD

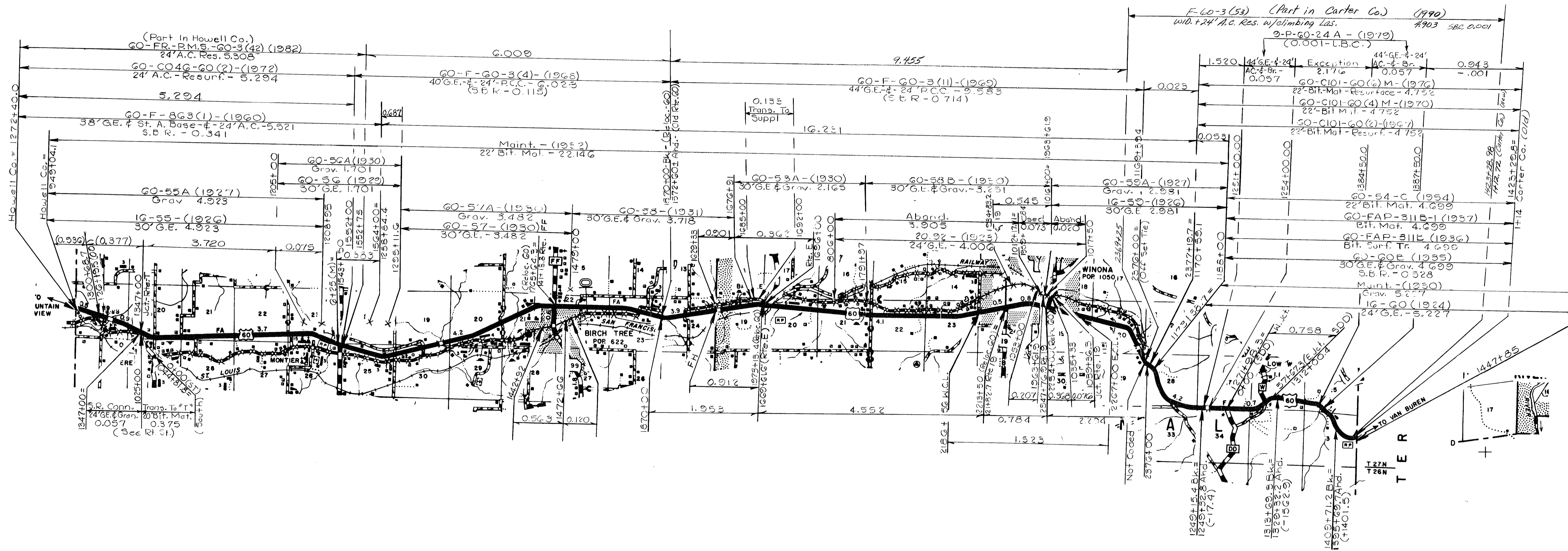

SHANNON

IOI

ROUTE

60

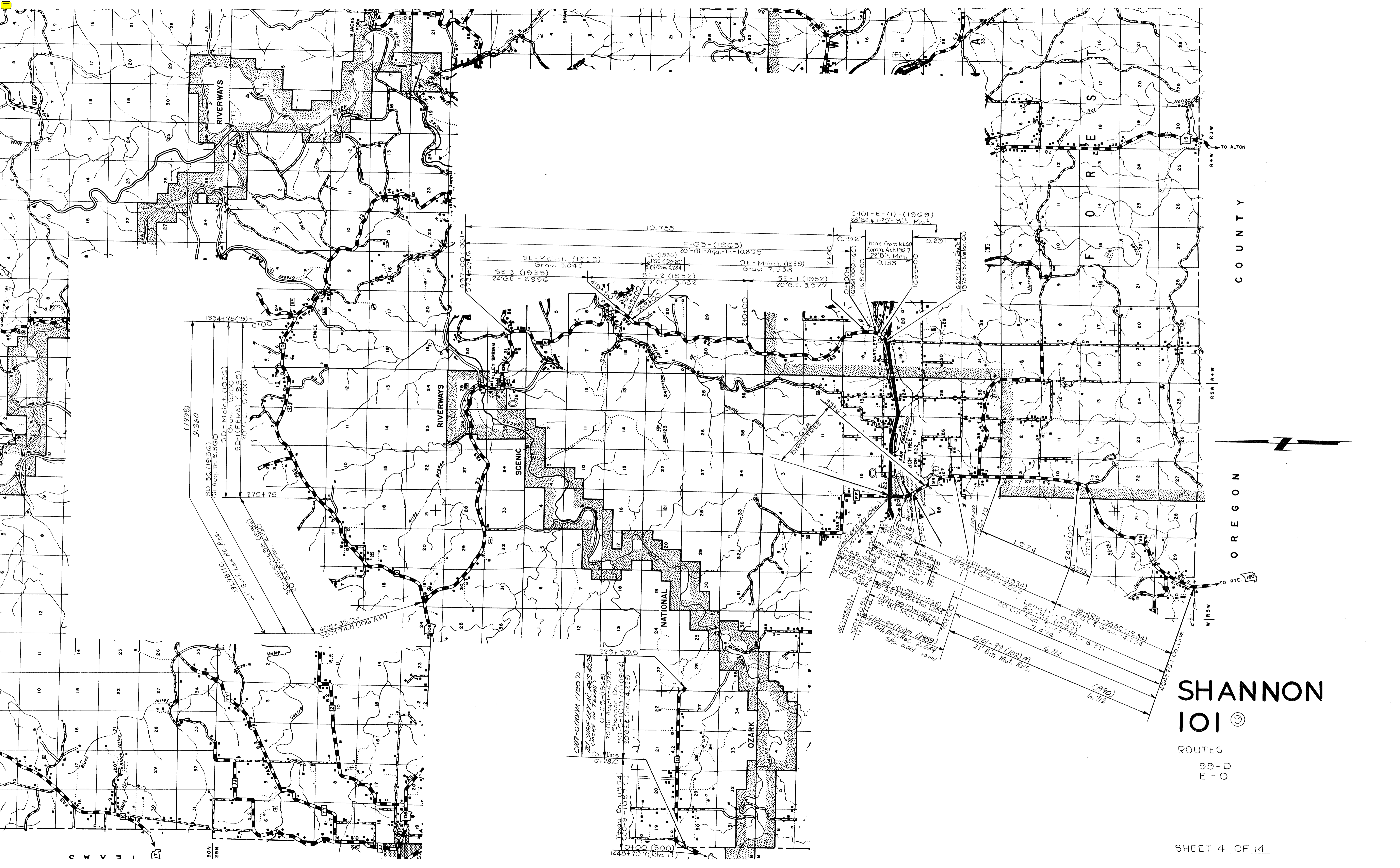

10.755
 E-GS-(1063)
 20'-Oil-Acq.-Tr.-10.855
 5L-Maint (1939)
 Grav. 3.045
 SE-3 (1935)
 24'Gr. 2.996
 5L-2 (1932)
 20'Gr. 3.832
 5L-Maint (1939)
 Grav. 7.538
 SE-1 (1932)
 20'Gr. 3.977
 C-101-E-(1)-(1969)
 28'Gr. 1-20'-Bit. Mat.
 Trans. from R.L. Co.
 Comm. Act. 1967
 22'Bit. Mat.
 0.135
 1934+75(19)
 0100
 SD-56 (1956)
 21' Acq. Tr. 9.560
 SD-(FFPA) (1955)
 20'Gr. 5.200
 SD-(FFPA) (1955)
 20'Gr. 5.200
 275+75
 1391911C (1955)
 21' Sur. Tr. 4.214 Res.
 495+30.3=330+74.8 (106 AP)
 10.755
 210+00
 210+00
 10.755
 1.974
 240+00
 270+25
 0.573
 12-NPH-355B-(1934)
 24'Gr. 4 Grav. -4.062
 Length - 0.001
 80'-52' Grav. -4.254
 19-NPH-355C (1934)
 24'Gr. 4 Grav. -4.254
 Length - 0.001
 20'-Oil Acq. Surf. Tr. - 3.311
 7.414
 C-101-99 (102)m
 21' Bit. Mat. Res.
 6.712
 1424' Ec. Co. Line
 6.712
 1934+75(19)
 0100
 SD-56 (1956)
 21' Acq. Tr. 9.560
 SD-(FFPA) (1955)
 20'Gr. 5.200
 SD-(FFPA) (1955)
 20'Gr. 5.200
 275+75
 1391911C (1955)
 21' Sur. Tr. 4.214 Res.
 495+30.3=330+74.8 (106 AP)



COUNTY OREGON COUNTY

SHANNON IOI

ROUTES
 99-D
 E-O

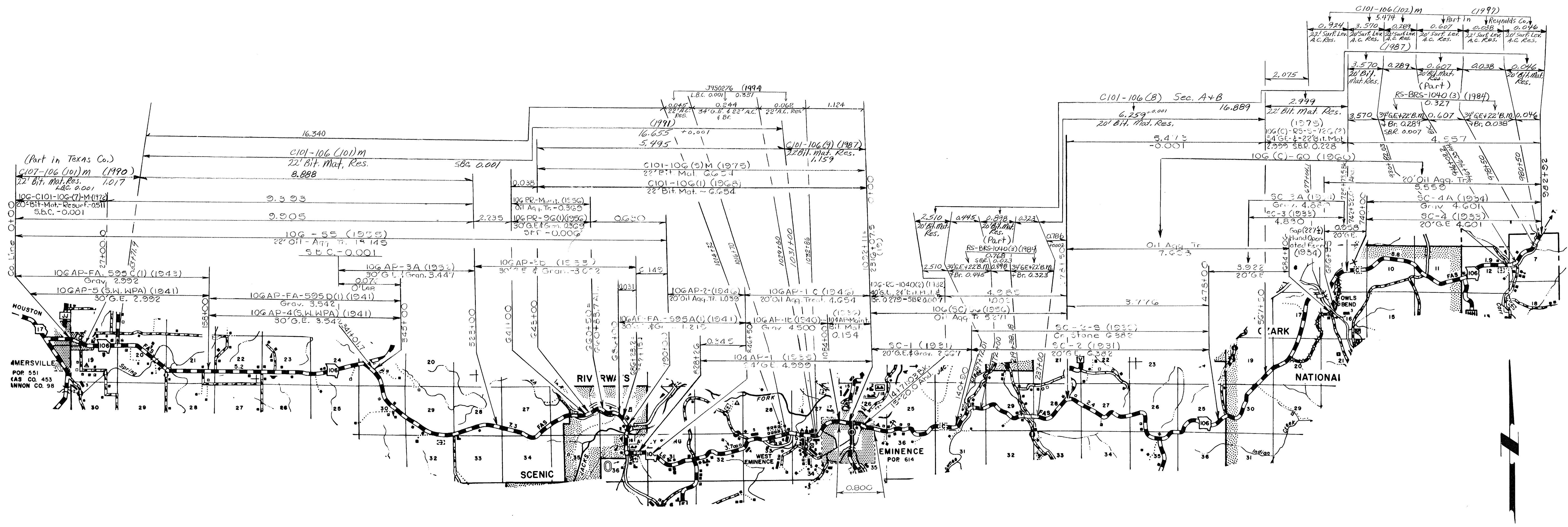

SHANNON
 IOI ⑨
 ROUTE
 IOG

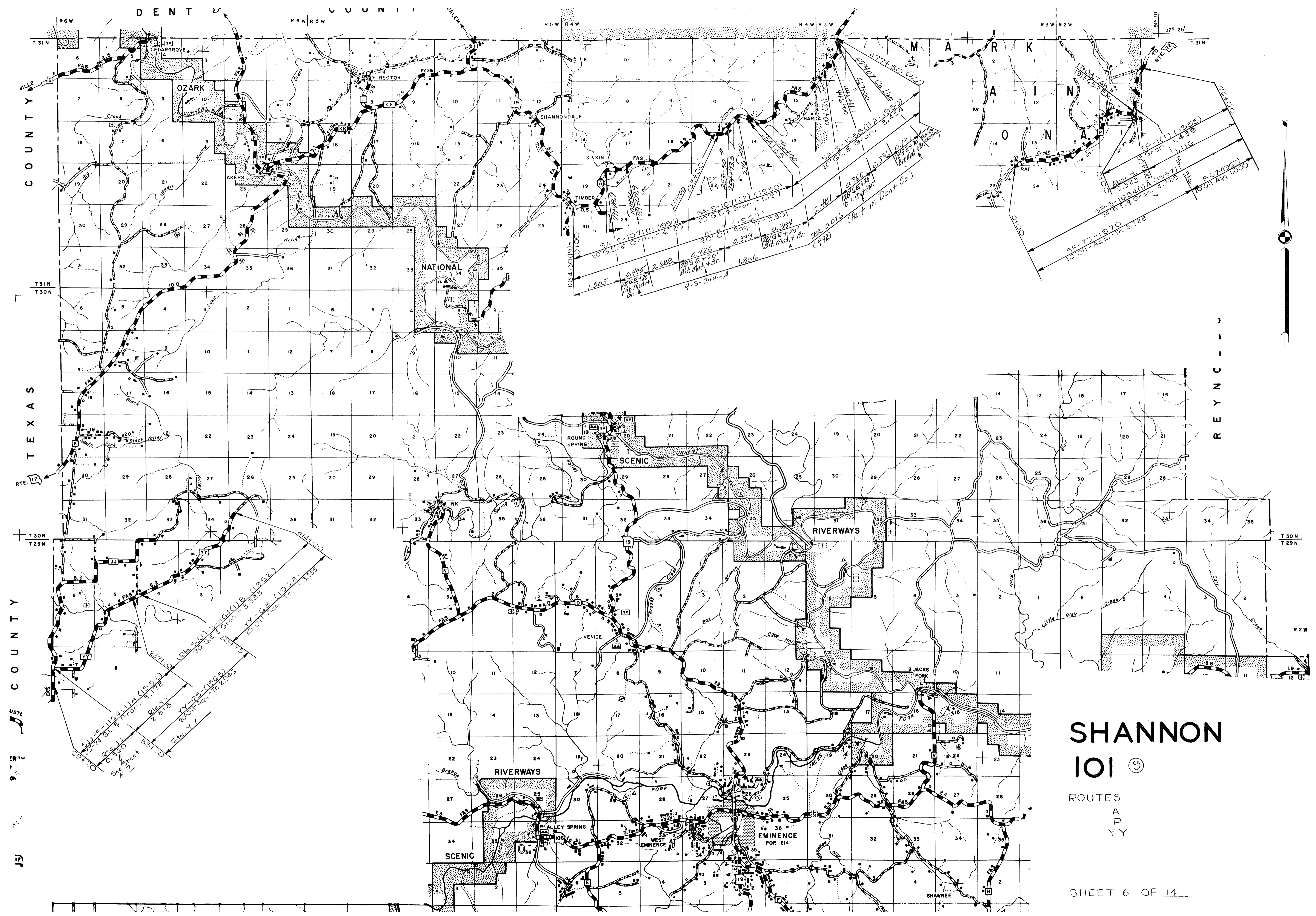

SHANNON IOI

ROUTES APPLY

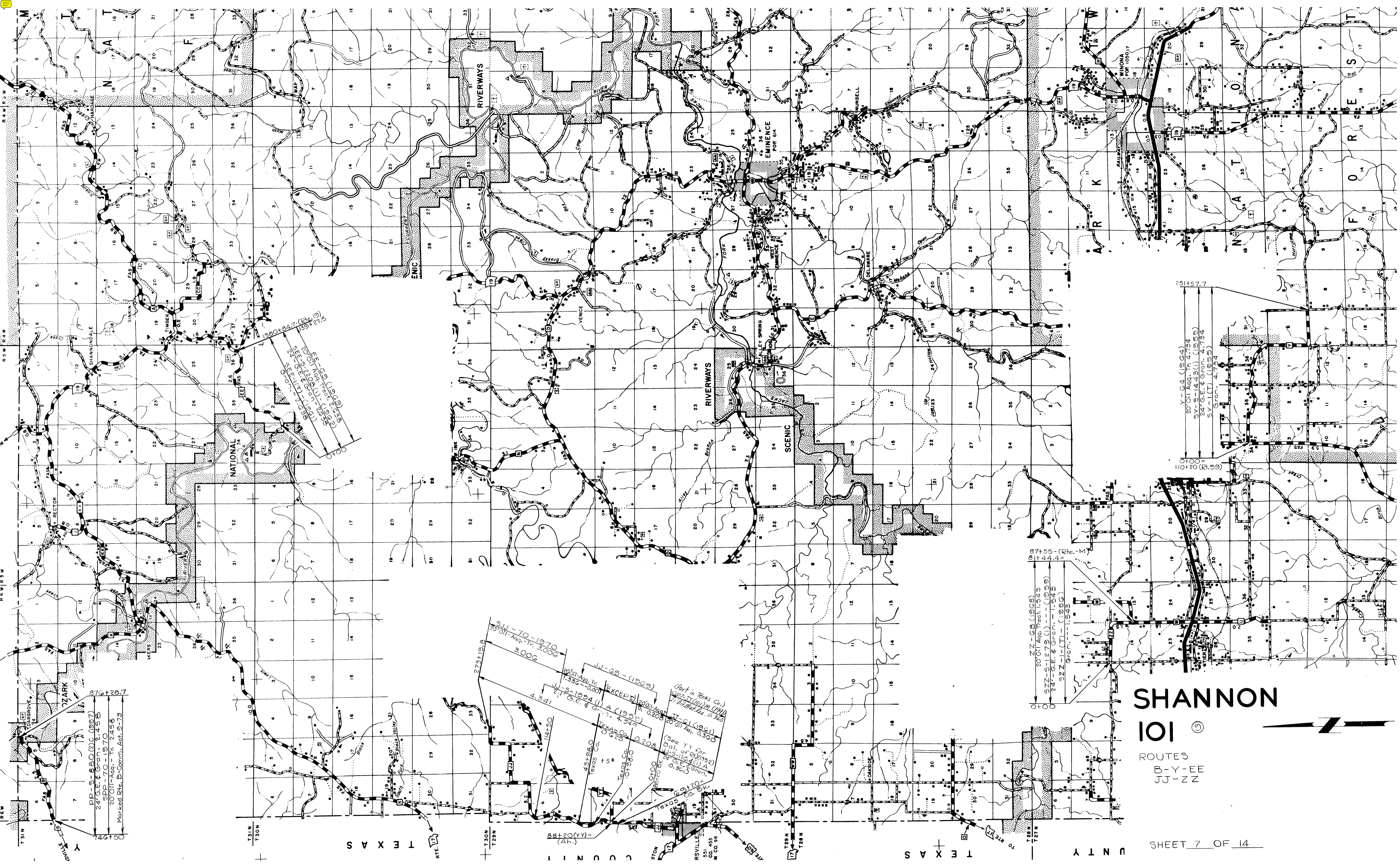

FE-69 (1969)
 20'01' Aq. Tr. 4.754
 SEE G.E. # 2476
 SEE LT. - (1955)
 27' G.E. & Grn. 4.754
 35' E.E. LT. - (1955) Grn. 4.754

DP-S-880 (20.0) (1957)
 27' G.E. & Grn. 4.754
 SU-70-1970 (1970)
 20'01' Aq. - Tr. 4.754
 Marked Rte. B-Comm. Act. 9-73

SU-70-1970
 20'01' Aq. - Tr. 3.006
 3.006
 4.341
 JU-65-(1965)
 20'01' Aq. Tr. 1.543
 1.543 - 0.208
 JU-9-1994 (U.A. (1955))
 27' G.E. & Grn. 4.543
 TEXAS CO. 0.625
 TEXAS CO. 0.208
 TEXAS CO. 0.208
 (Part in Texas Co.)
 20'01' Aq. Tr. 1.543
 1.543 - 0.208
 20'01' Aq. 0.300
 (See YY for
 Dist. of 1952)
 24' G.E. & Grn.
 24' G.E. & Grn.
 TEXAS CO. 0.208
 TEXAS CO. 0.208
 TEXAS CO. 0.208

ZZ-68 (1968)
 20'01' Aq. Tr. 1.543
 SZZ-6-1279 (I) - (1959)
 24' G.E. & Grn. 1.543
 SZZ-1-(T) - (1956)
 Grn. 1.543

Y-64 (1964)
 20'01' Aq. Tr. 4.754
 SY-8-1443(I) (1955)
 24' G.E. & Grn. 4.754
 SY-1-(T) (1955)
 Grn. 4.754

SHANNON

IOI ©
 ROUTES
 B-Y-EE
 JU-ZZ



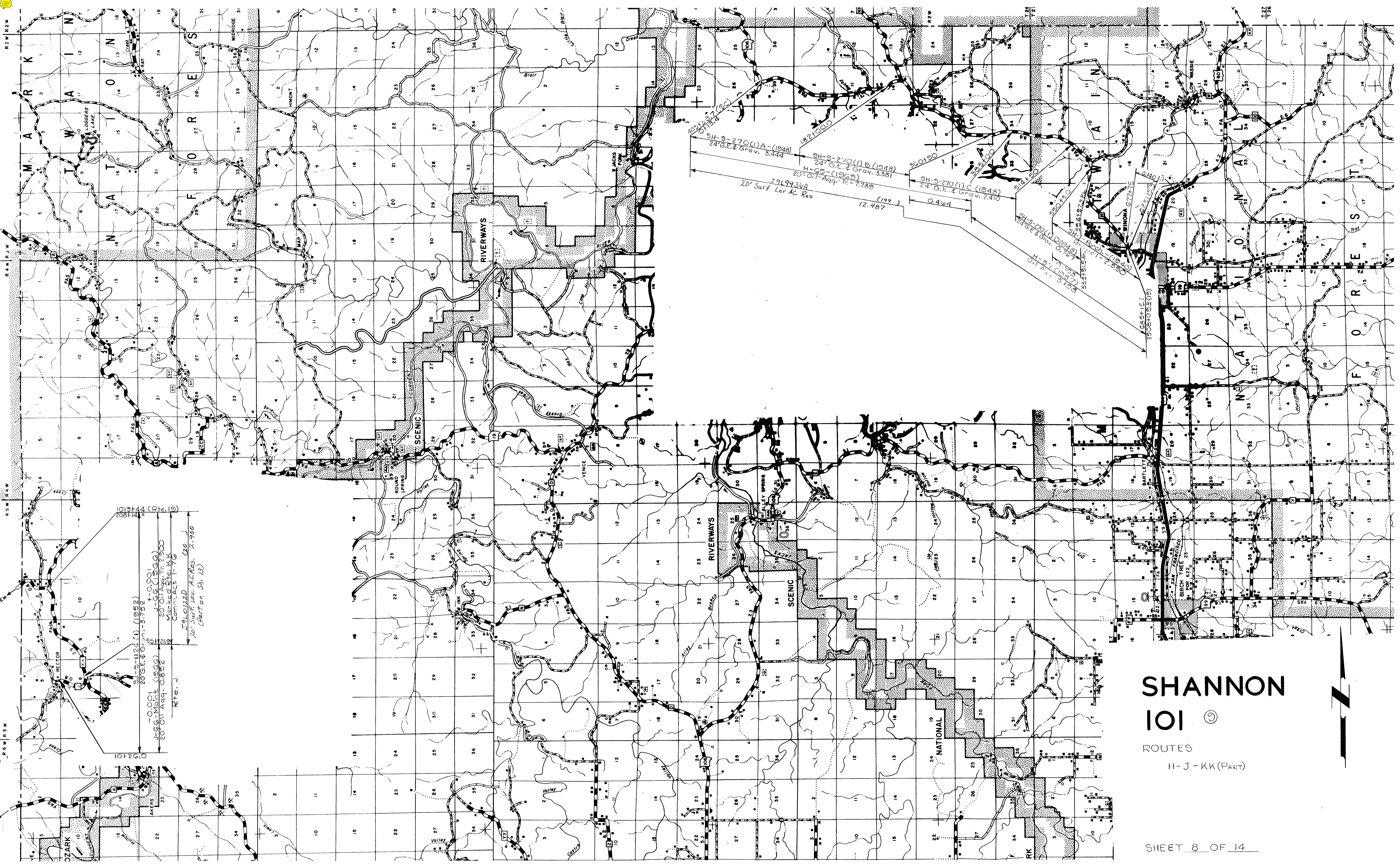

SHANNON IOI

ROUTES
H-J-KK (Part)

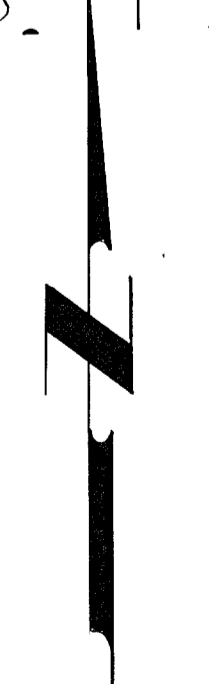

1013+44 (Rte. J)
208+14 =

SJ-S-1124(1) (1952)
20° G.E. & Grav. 3.752
+0.001

J-GG-Mount (1966)
20° On Pt. Tr. 2500
Marked Elev. 1.5
Comm. Act. 1-76

Rte. J

574.0122D (20)
20' Surf. Lev. AC Res. 2.900
(Part on Sh. 13)

203+37 (Rte. J)
107+34 =

SH-S-270(1)A (1948)
24° G.E. & Grav. 3.444

SH-S-270(1)B (1948)
24° G.E. & Grav. 3.381

H-C5-(1965)
20° On Pt. Tr. 2.289

J9L9936A (199)
20' Surf. Lev. AC Res 12.487

360150

SH-S-270(1)C (1948)
24° G.E. & Grav. 2.410

360150

SH-S-270(1)D (1948)
24° G.E. & Grav. 0.767

H-57 (1997)
On Pt. Tr. 5.195

555+55A
555+55B
555+55C

555+55D

555+55E

555+55F

555+55G

555+55H

555+55I

555+55J

555+55K

555+55L

555+55M

555+55N

555+55O

555+55P

555+55Q

555+55R

555+55S

555+55T

555+55U

555+55V

555+55W

555+55X

555+55Y

555+55Z

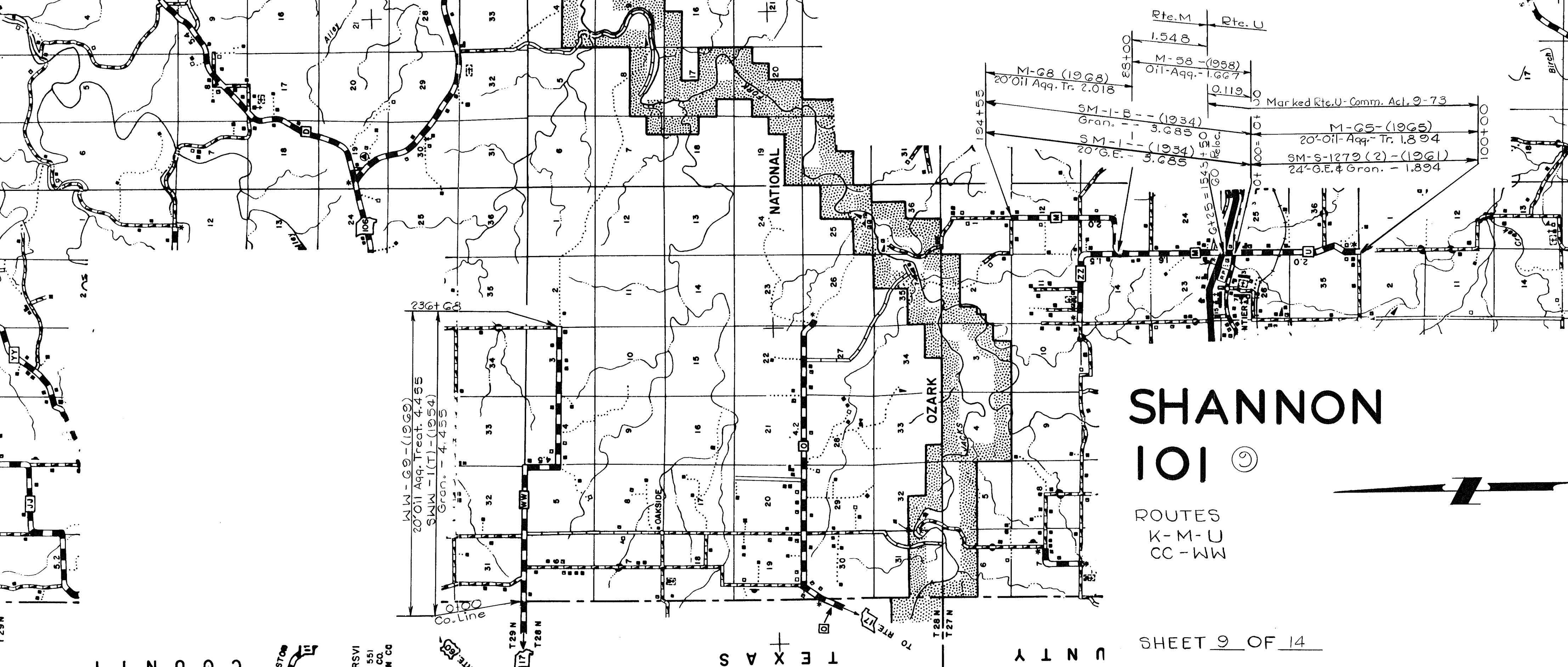
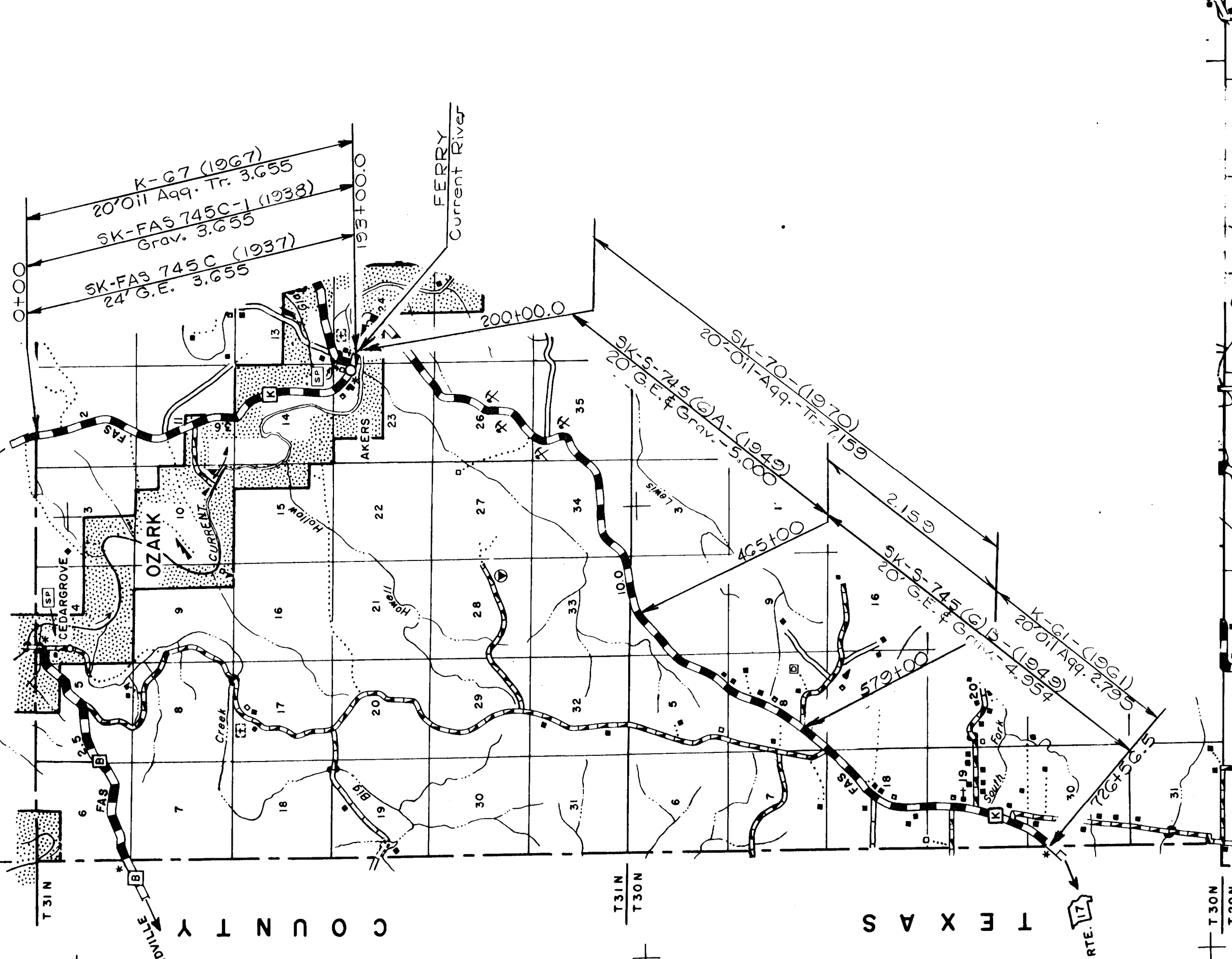
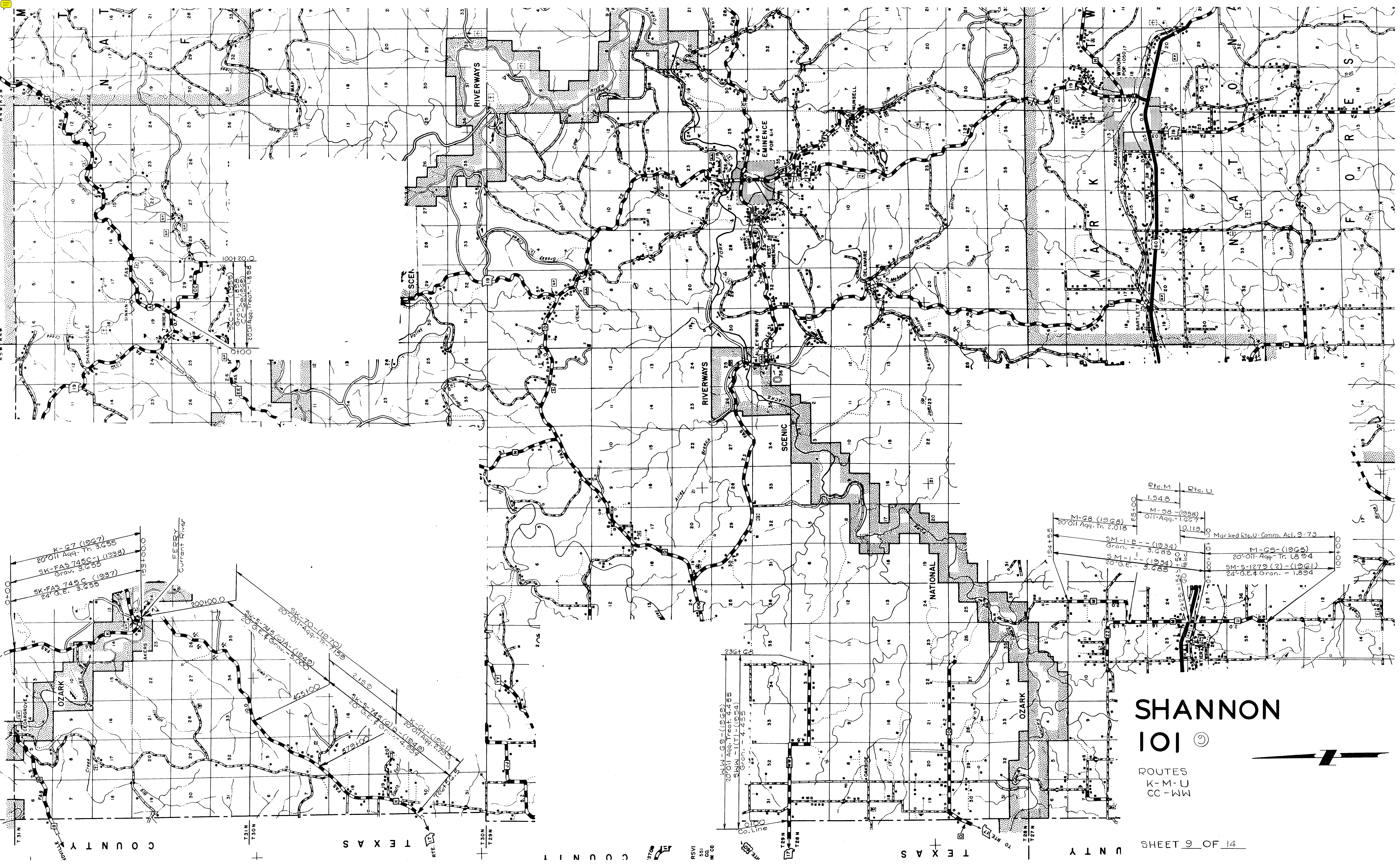

SHANNON

101

ROUTES
 K-M-U
 CC-WW



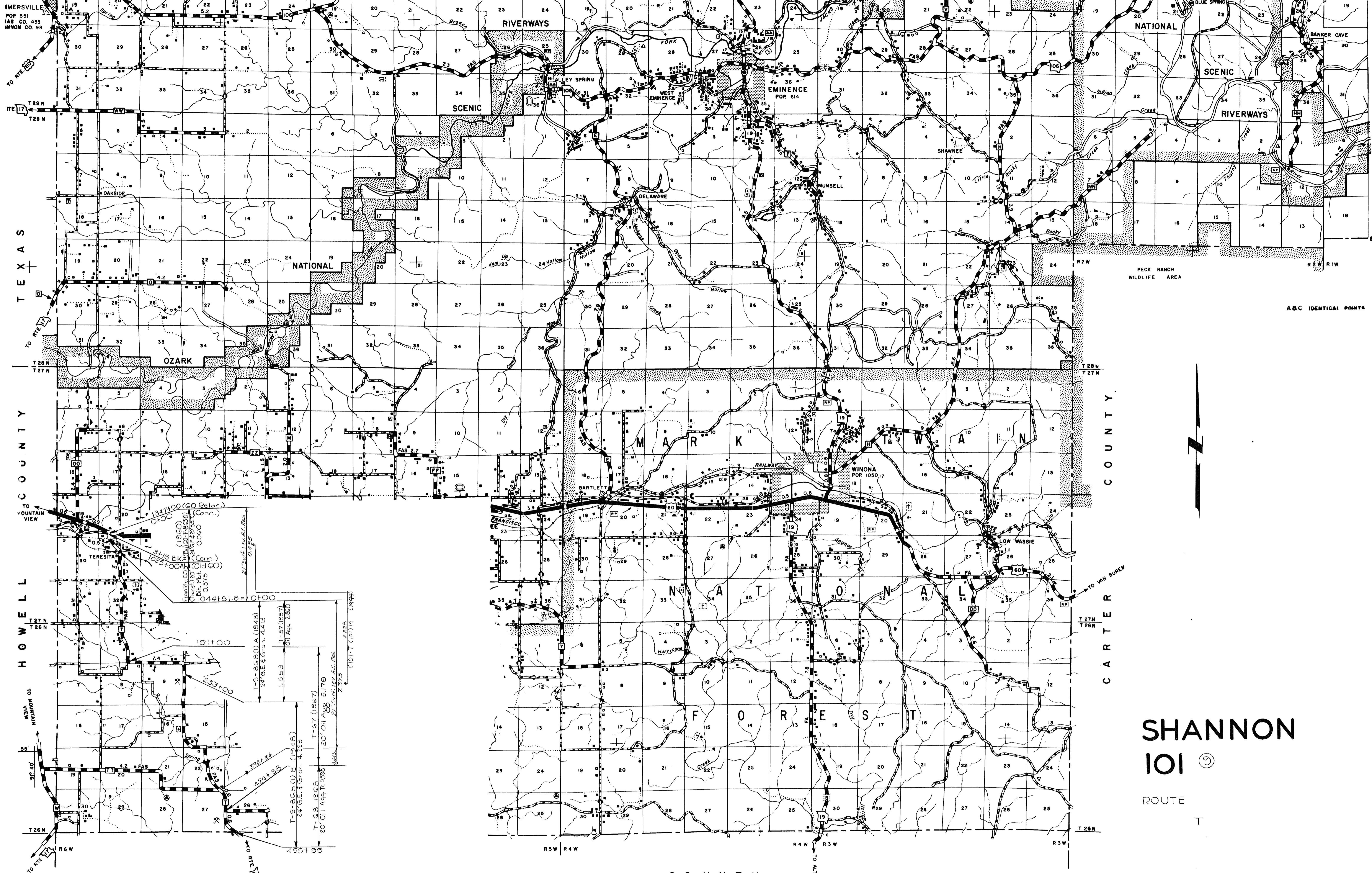

MEMPHISVILLE POP 551
IAS CO. 453
MNON CO. 98

TEXAS

HOWELL COUNTY

CARTER COUNTY

TO RTE 17

TO RTE 12

TO RTE 10

TO RTE 11

TO RTE 13

TO RTE 14

TO RTE 15

TO RTE 16

TO RTE 18

TO RTE 19

TO RTE 20

TO RTE 21

TO RTE 22

TO RTE 23

TO RTE 24

TO RTE 25

TO RTE 26

TO RTE 27

TO RTE 28

TO RTE 29

TO RTE 30

TO RTE 31

TO RTE 32

TO RTE 33

TO RTE 34

TO RTE 35

TO RTE 36

TO RTE 37

SHANNON IOI

ROUTE T

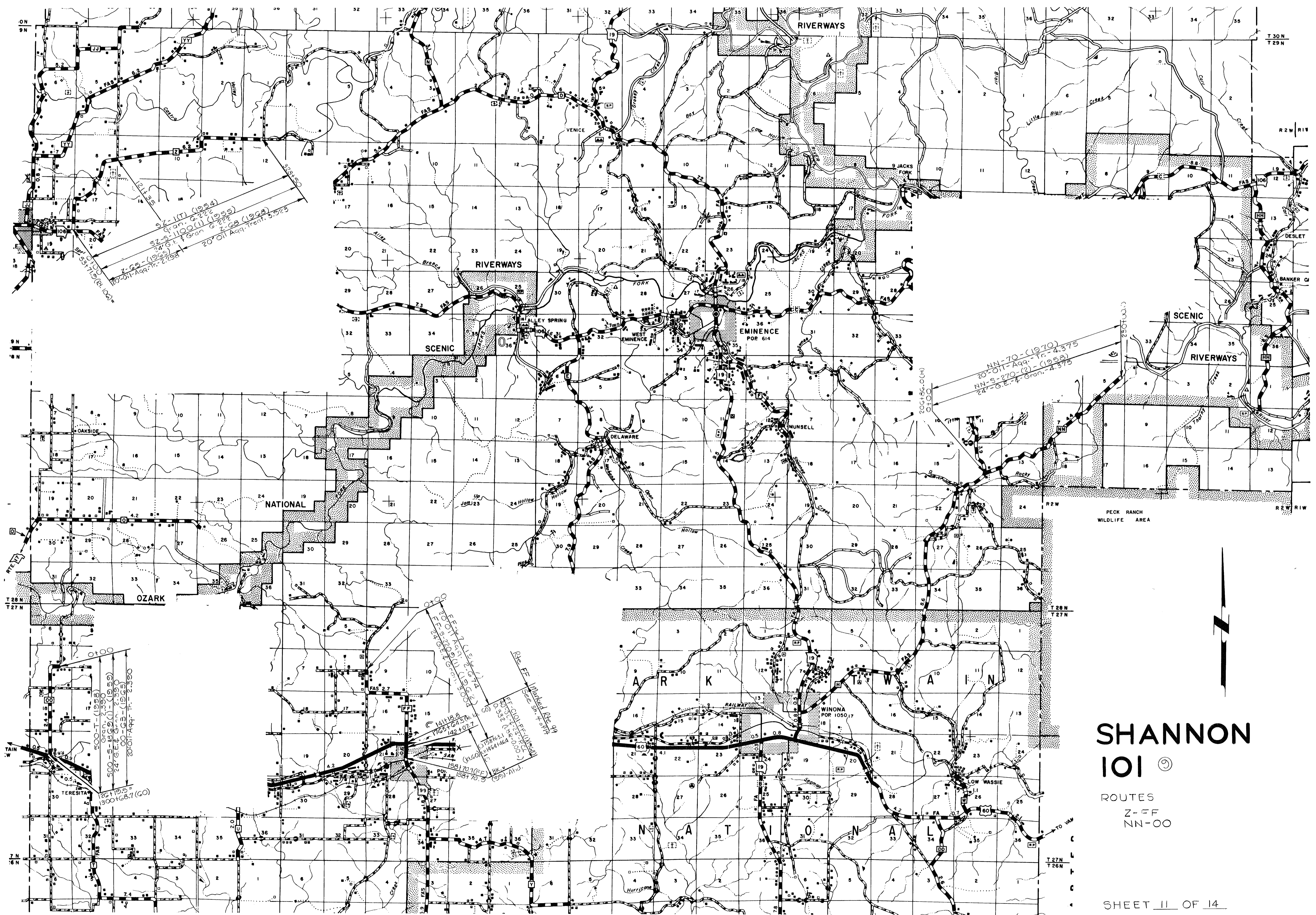

SHANNON IOI

ROUTES
Z-FF
NN-OO

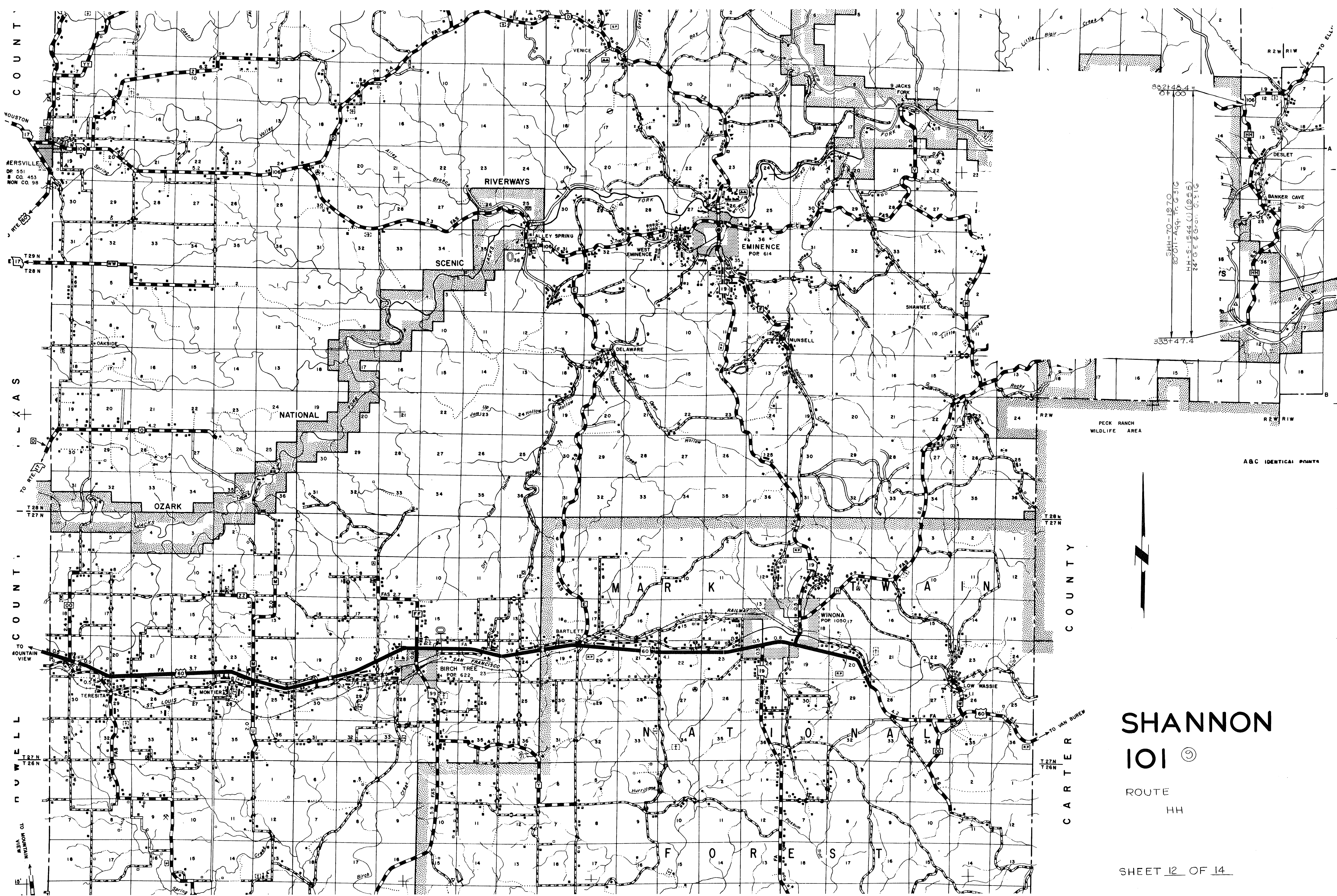

HOUSTON
MERSVILLE
DP 551
CO 453
NON CO 98

OAKSIDE

TO MOUNTAIN VIEW

TO MOUNTAIN VIEW

RIVERWAYS

SCENIC

NATIONAL

OZARK

MARRK

TWIN

NATL

FORREST

862146.4 =
8100

SHH-70-1970
20'01-Asq. Tr. G-31G
HH-S-1544 (J) (S56)
24' G.E. & Green. G-31G

333+47.4

PECK RANCH
WILDLIFE AREA

A & C IDENTICAL POINTS

SHANNON

101

ROUTE
HH

SHEET 12 OF 14

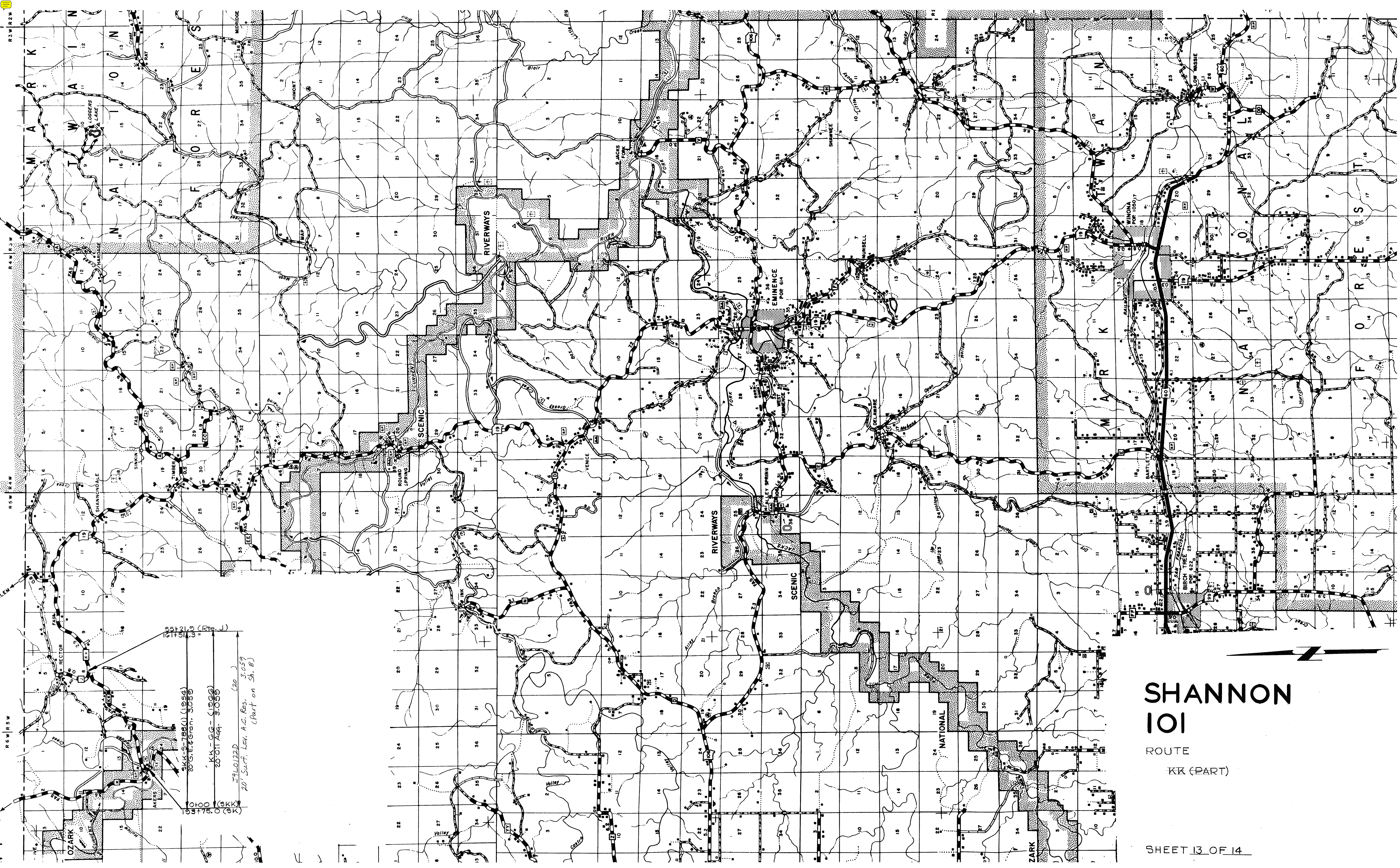

0+00 (SKK)
 195+79.0 (SK)
 55+21.9 (Rte. J)
 121+51.3 =
 K.K. - G.G. - (1954)
 S.K.K. - T.B.B. (1954)
 20' G. E. Tran. 3.055
 K.K. - G.G. - (1954)
 20' G. E. Tran. 3.055
 I-190122D (20)
 20' Surf. Lev. A.C. Res. 3.059
 (Part on Sh. B)

SHANNON IOI

ROUTE
K.K. (PART)

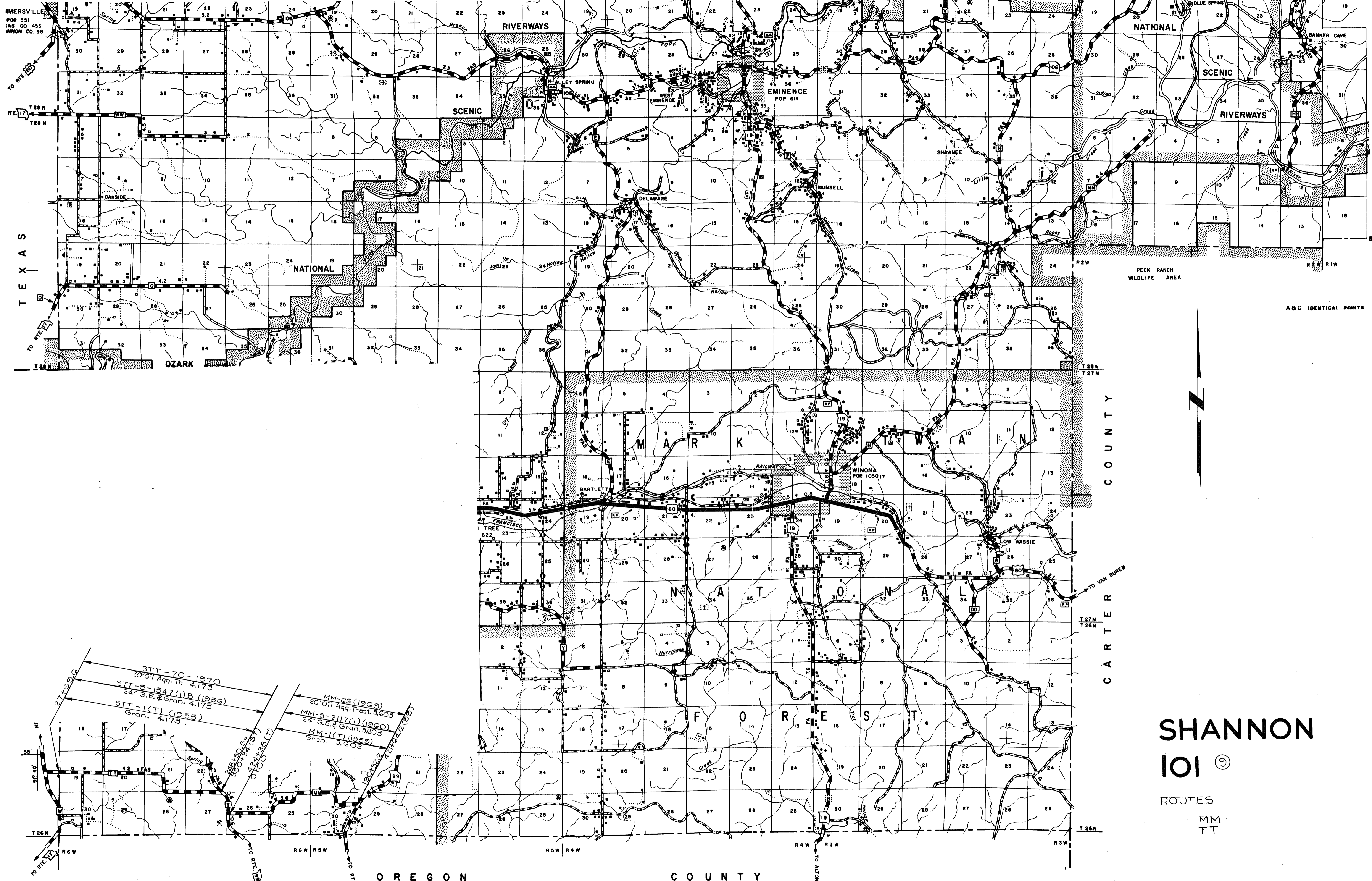

AMERSVILLE
 POP 551
 IAS CO. 453
 WNON CO. 98

T E X A S

T 29 N
 T 28 N
 T 27 N
 T 26 N

R 6 W
 R 5 W
 R 4 W
 R 3 W
 R 2 W

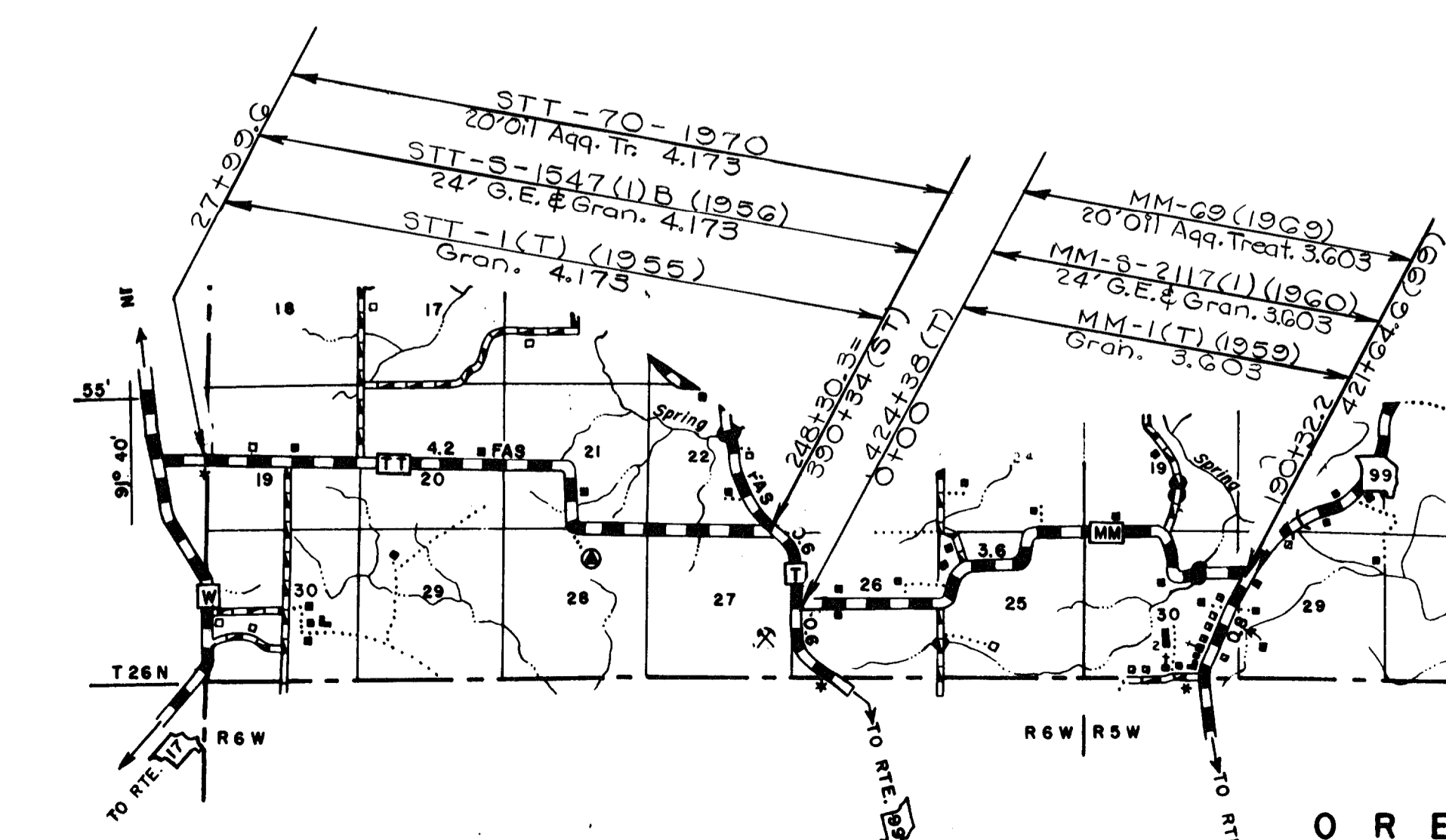

O R E G O N C O U N T Y

C A R T E R C O U N T Y

SHANNON IOI

ROUTES
 MM
 TT