

WRIGHT

114[®]

ROUTES

5

60 Bus. (Part)

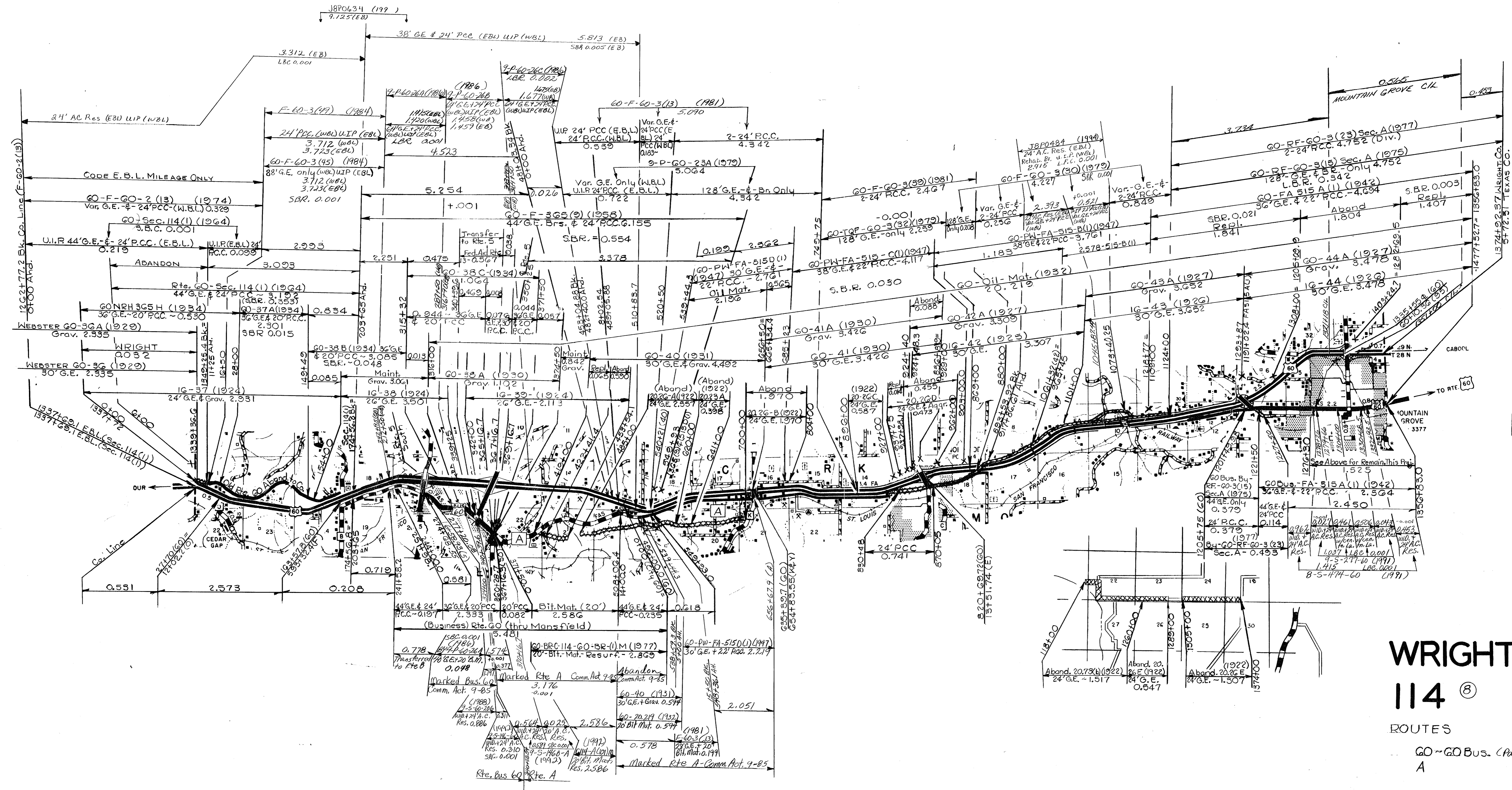

WRIGHT
114 ®
 ROUTES
 GO-GoBus. (Part)
 A

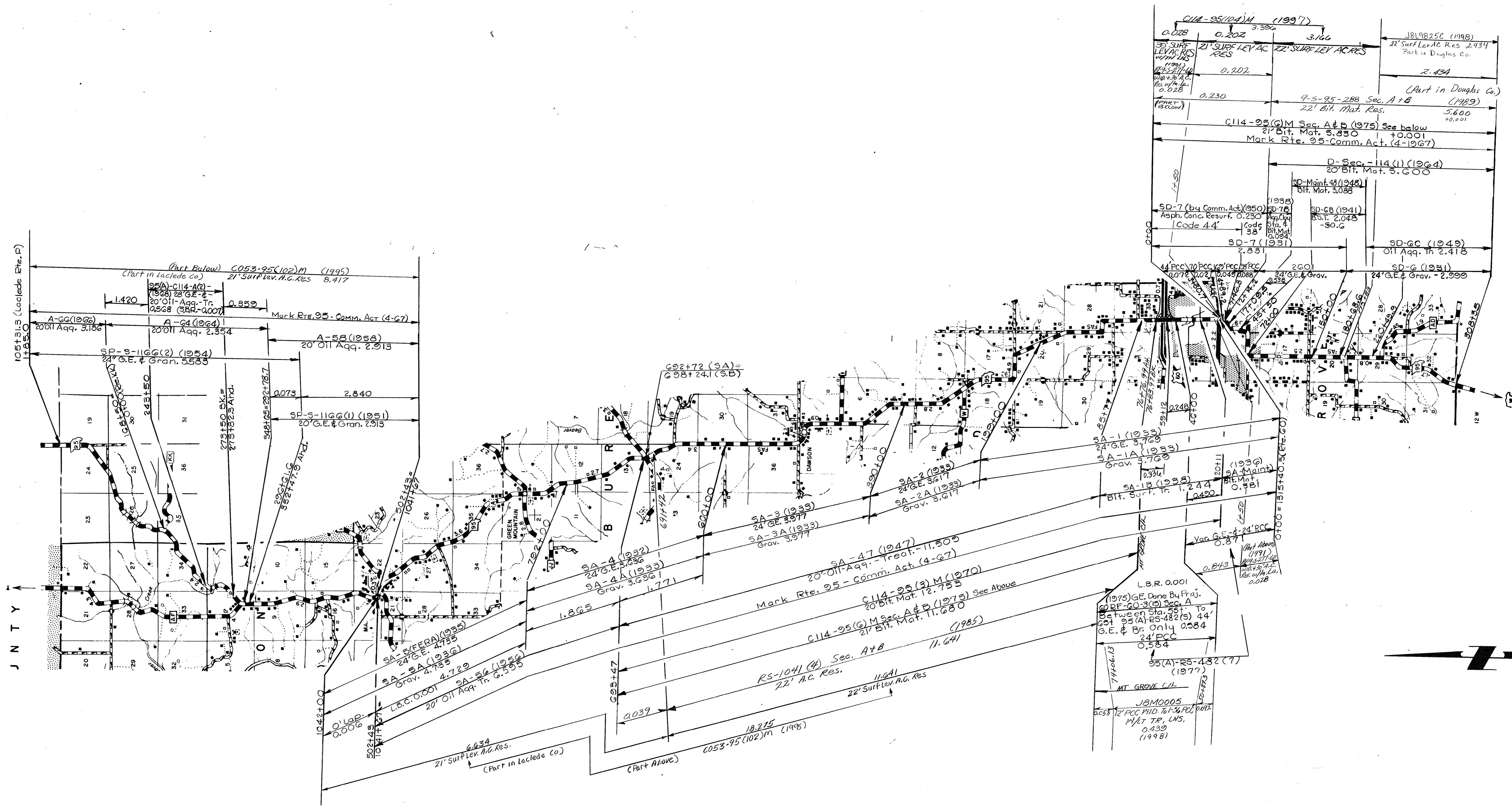

WRIGHT 114 ⑧

ROUTE
95

COUNTY

WEBSTER

COUNT

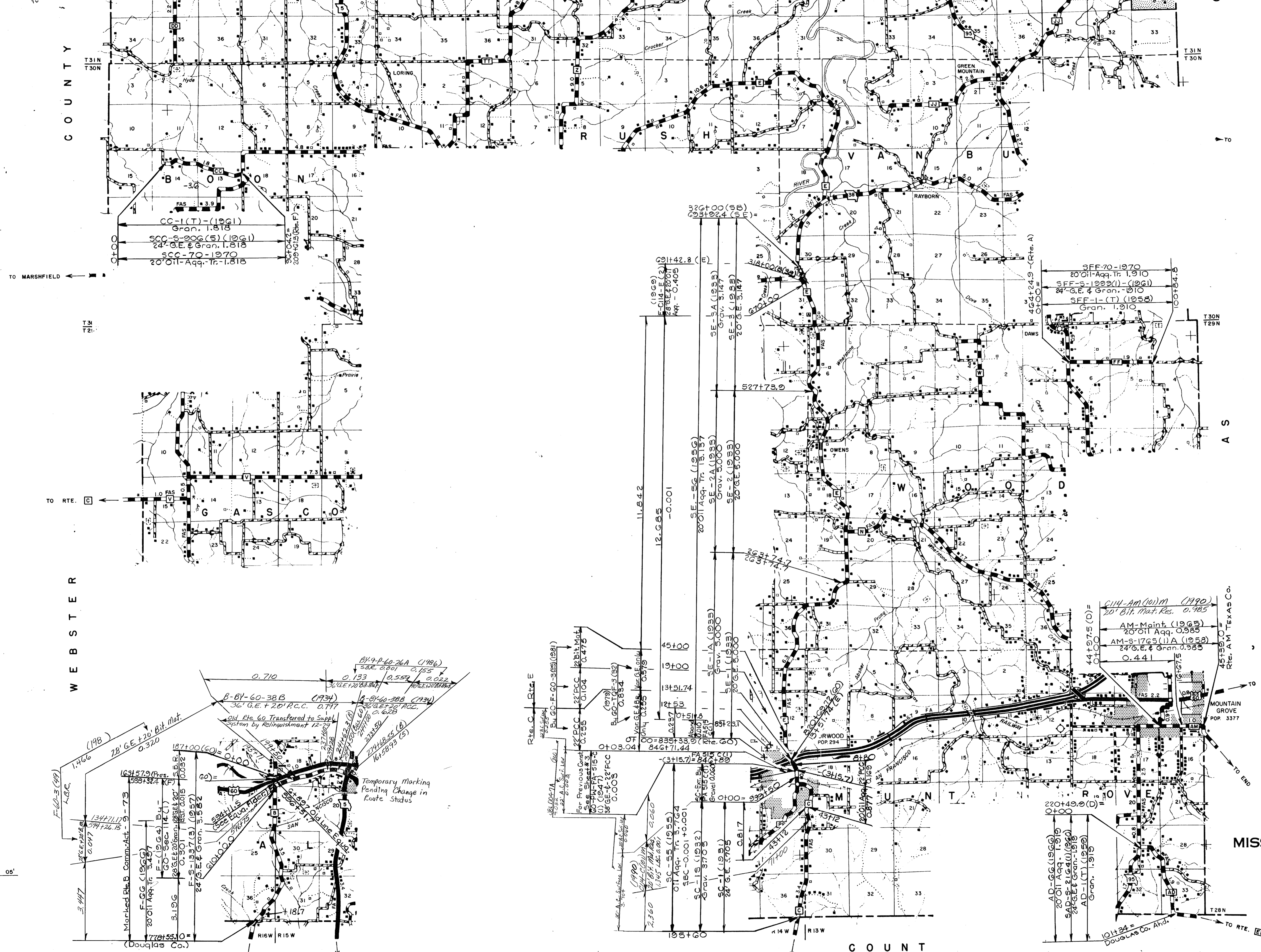

WRIGHT
114 (8)
 ROUTES
 B-C-E (PART)
 CC-FF
 AD-AM

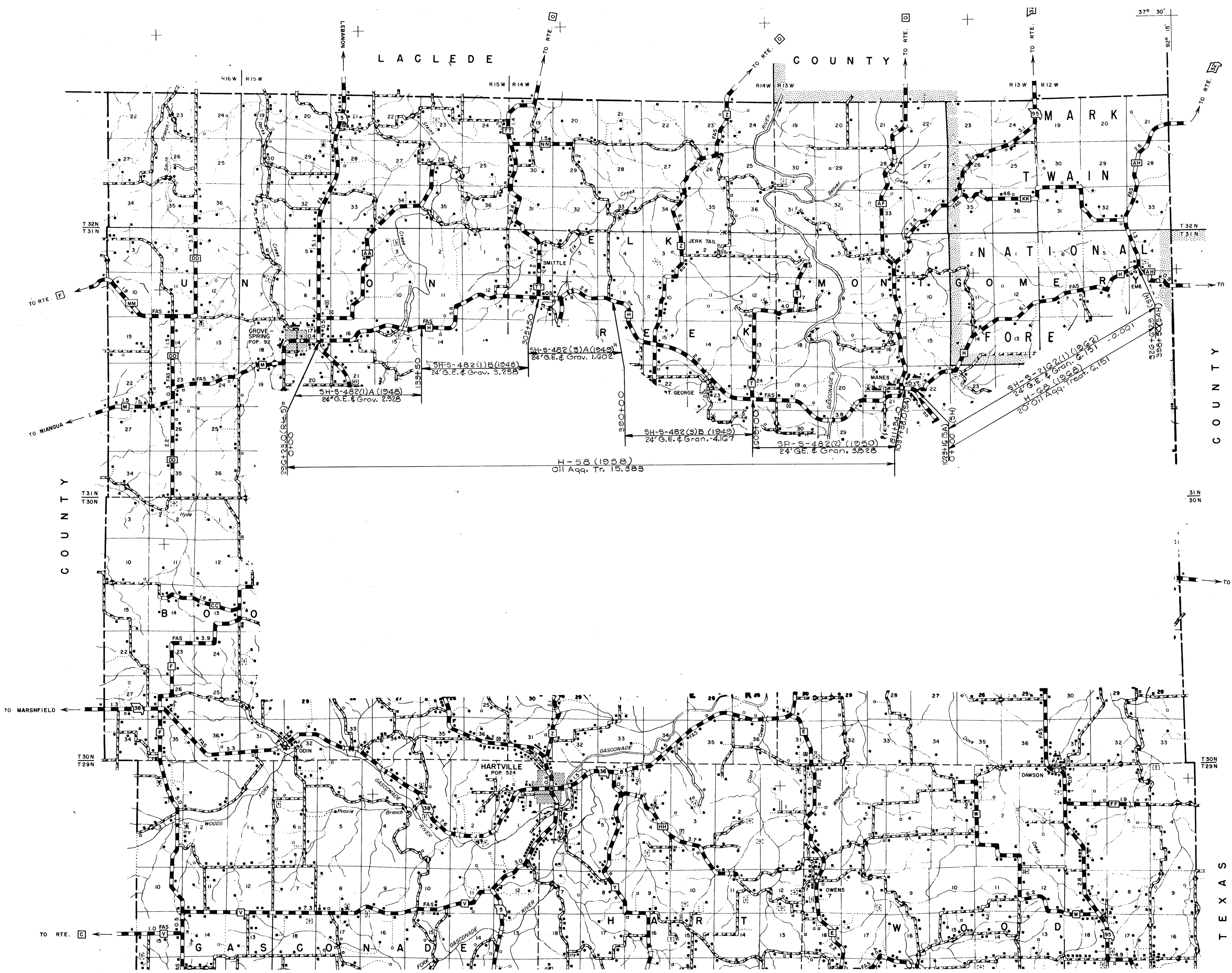

**WRIGHT
114** ⑧

ROUTE
H

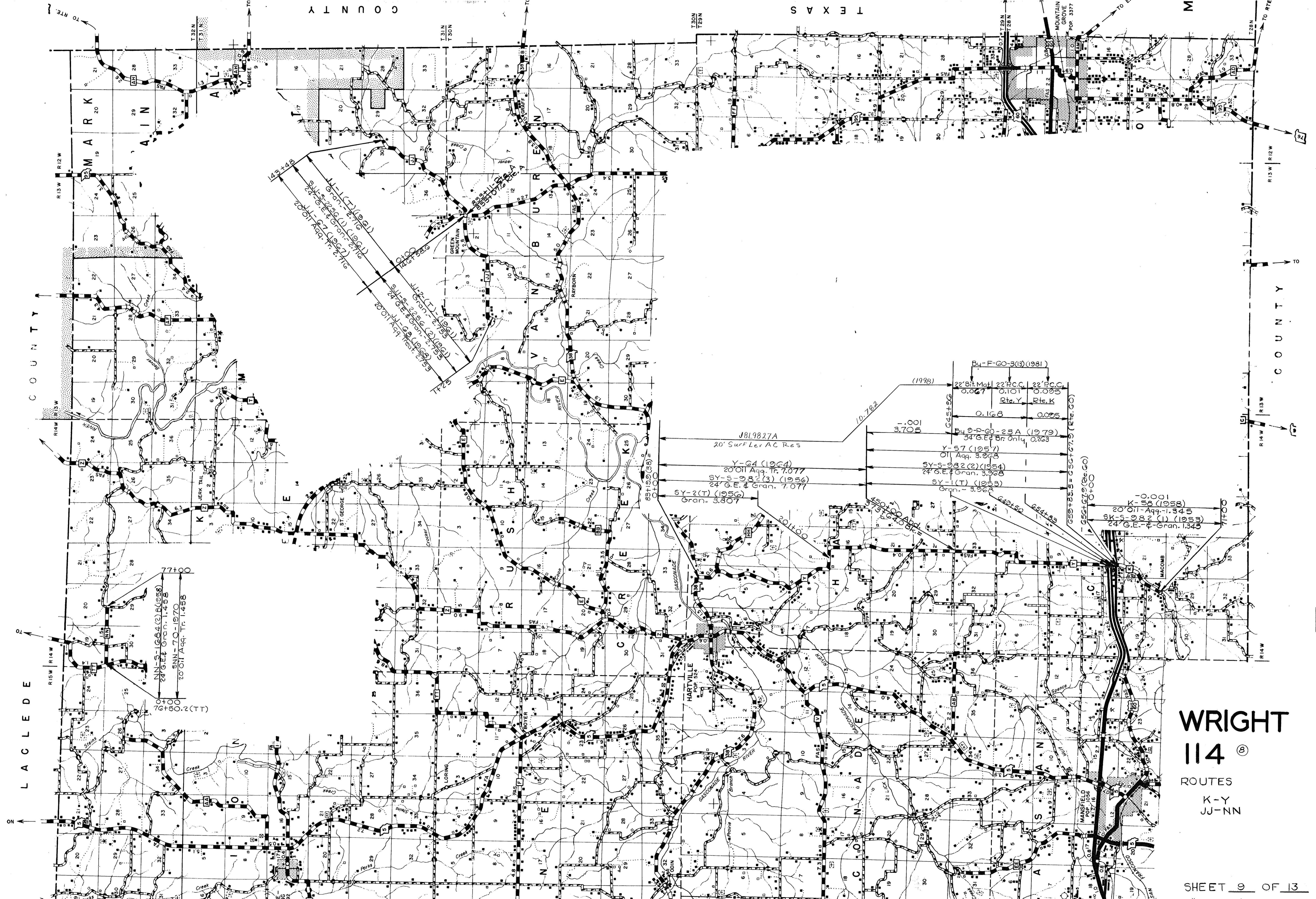

WRIGHT
114 ®
 ROUTES
 K-Y
 JJ-NN

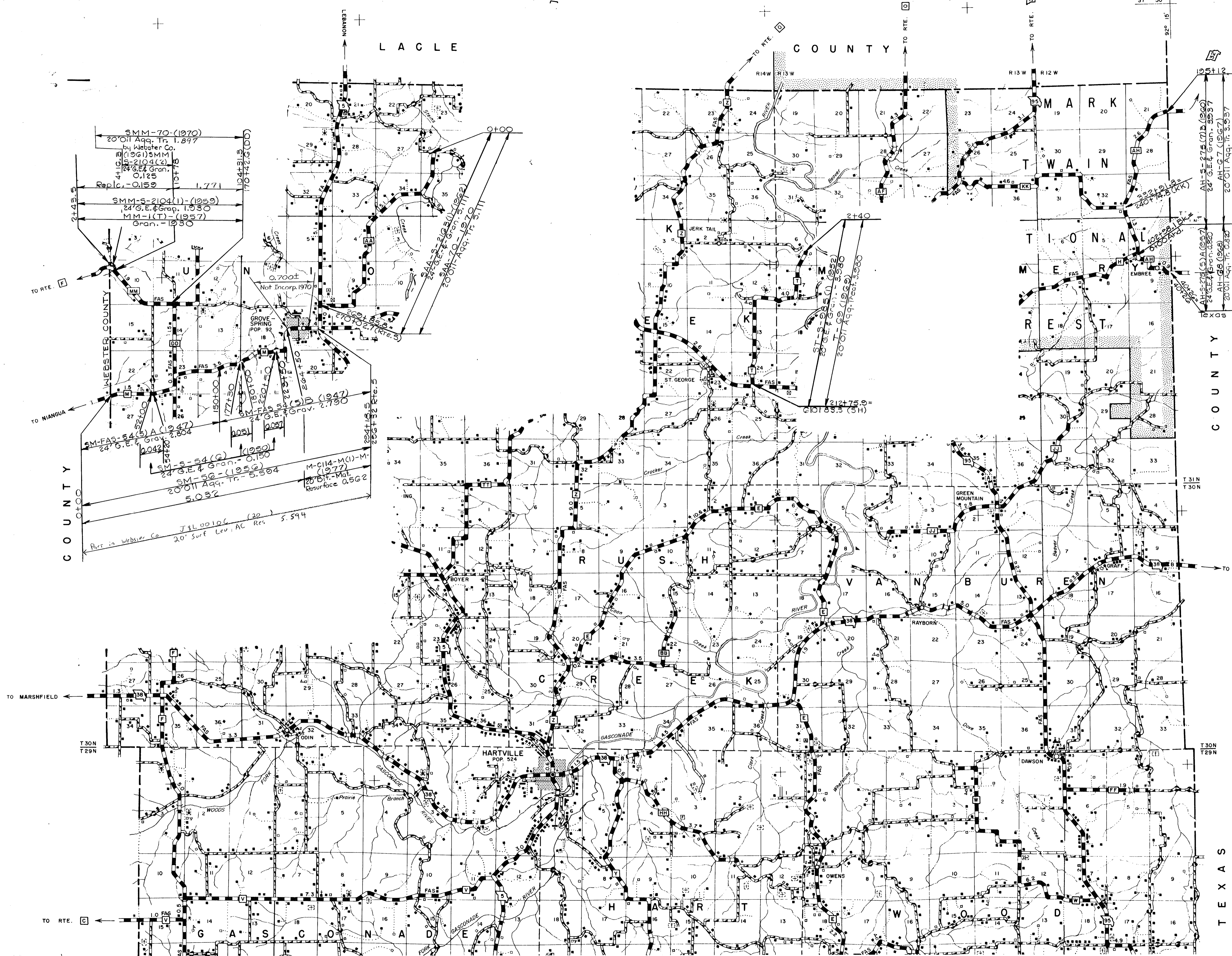

WRIGHT 114

ROUTES
M-T-AA
MM-AH

T E X A S

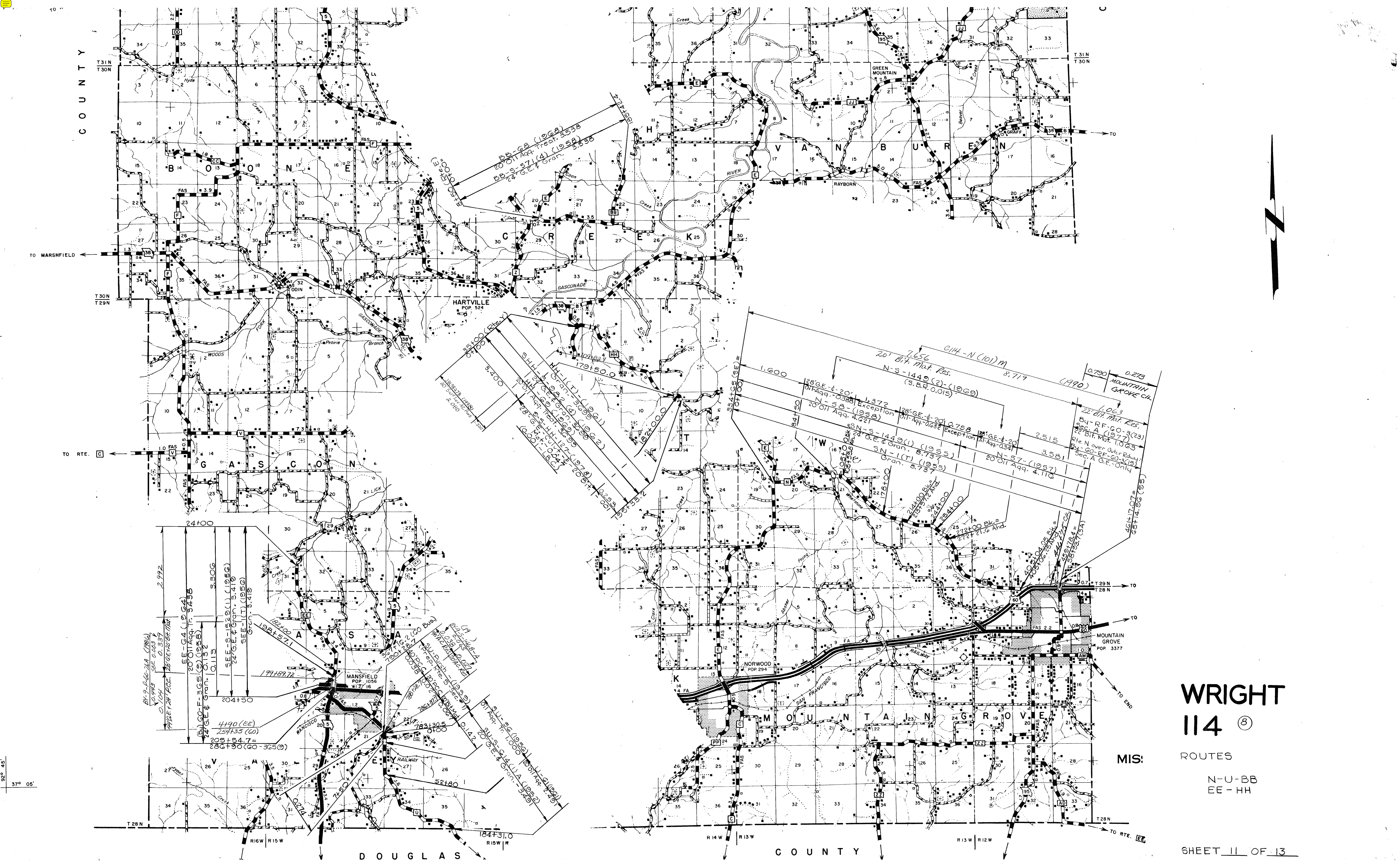

WRIGHT 114 (8)

MIS:

ROUTES

N-U-BB
EE-HH

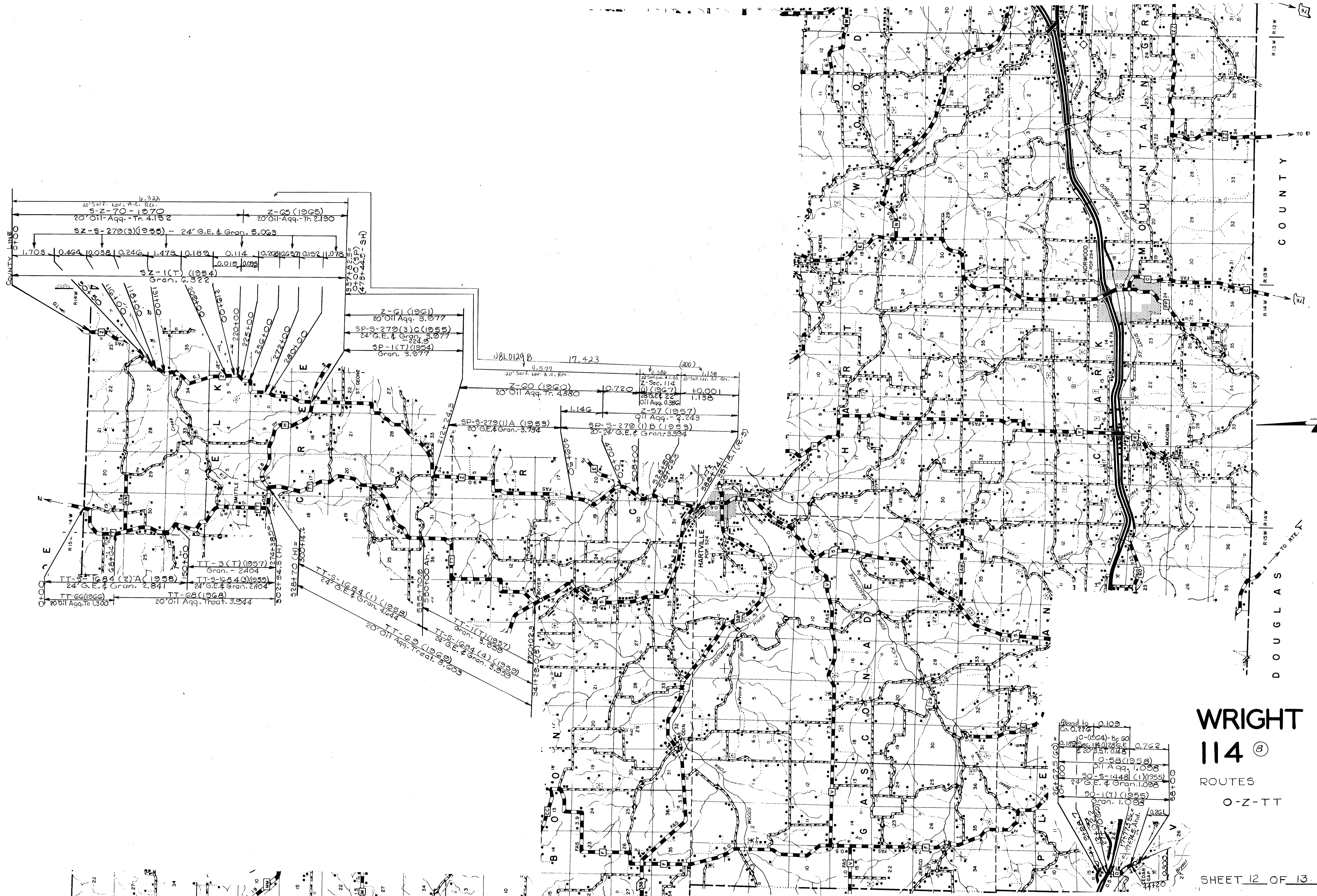

COUNTY

DOUGLAS COUNTY

WRIGHT 114 (B)

ROUTES
O-Z-TT

Aband to 0.109
0.0222
0-1564-B, 60
0.189 Sec. 114, 236 E 0.762
20 3.31, 0.143
0-58 (1958)
Oil Aqq. 1.038
30-5-1448 (1) (1955)
24 G.E. & Gran. 1.038
30-1 (T) (1955)
Gran. 1.038

6.322
20 Surf. Lev. W.C. Res.
S-Z-70-1970
20 Oil Aqq. Tr. 4.132
SZ-9-279(3) (1955) - 24' G.E. & Gran. 3.063
Z-65 (1965)
20 Oil Aqq. Tr. 2.190
1.703 0.464 0.038 0.246 1.473 0.189 0.114 0.208 0.057 0.152 1.075
Z-1 (T) (1954)
Gran. 6.522
0.019 0.093
337.925
0+00 (SP)
(473+442 SH)

Z-61 (1961)
20 Oil Aqq. 3.977
SP-3-279(3) C (1955)
24' G.E. & Gran. 3.977
SP-1 (T) (1954)
Gran. 3.977

J81.0129 B
9.577 17.423
20 Surf. Lev. A.C. Res.
Z-60 (1960)
20 Oil Aqq. Tr. 4.830
0.720
Z-57 (1957)
Oil Aqq. 2.223
SP-3-279 (1) A (1953)
20 G.E. & Gran. 3.754
SP-3-279 (1) B (1953)
20-24' G.E. & Gran. 3.394
1.146
0.280 1.130
22 Surf. Lev. A.C. Res.
Z-56 (1957)
28 G.E. & 22
Oil Aqq. 0.386
+0.001
1.135

TT-3 (T) (1957)
Gran. 2.404
TT-9-1684 (2) A (1958)
24' G.E. & Gran. 2.841
TT-9-1684 (3) (1959)
24' G.E. & Gran. 2.404
TT-66 (1966)
20 Oil Aqq. Tr. 1.300
TT-68 (1968)
20 Oil Aqq. Treat. 3.944
302+94.3 (H)
328+70 (H)
300+14.2
TT-9-1684 (1) (1958)
24' G.E. & Gran. 4.644
TT-1 (T) (1957)
Gran. 3.939
TT-9-1684 (4) (1959)
24' G.E. & Gran. 3.939
TT-69 (1969)
20 Oil Aqq. Treat. 8.603
34+102.5
555+70.9
550+00 AN.
341+02.5

C O U N T Y

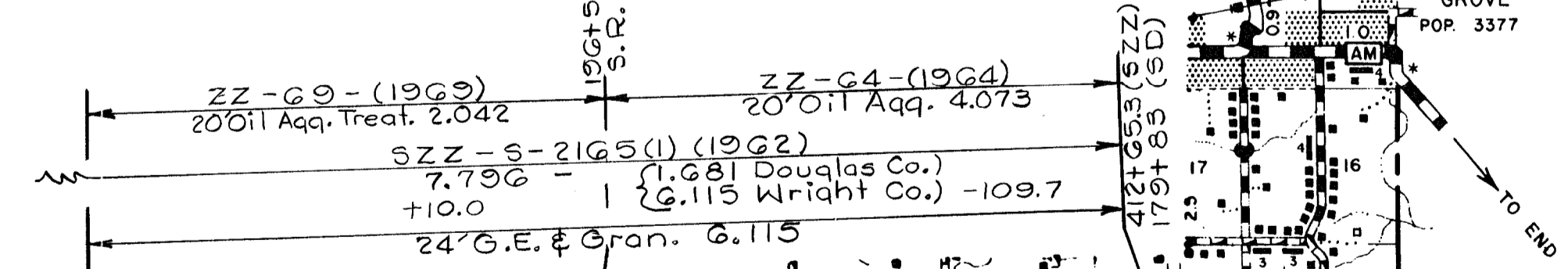
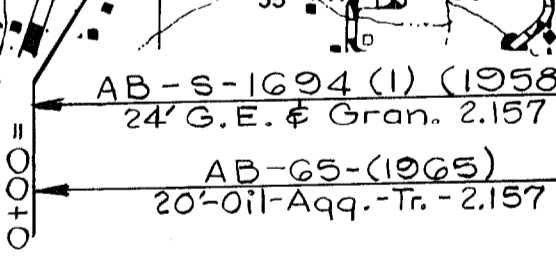
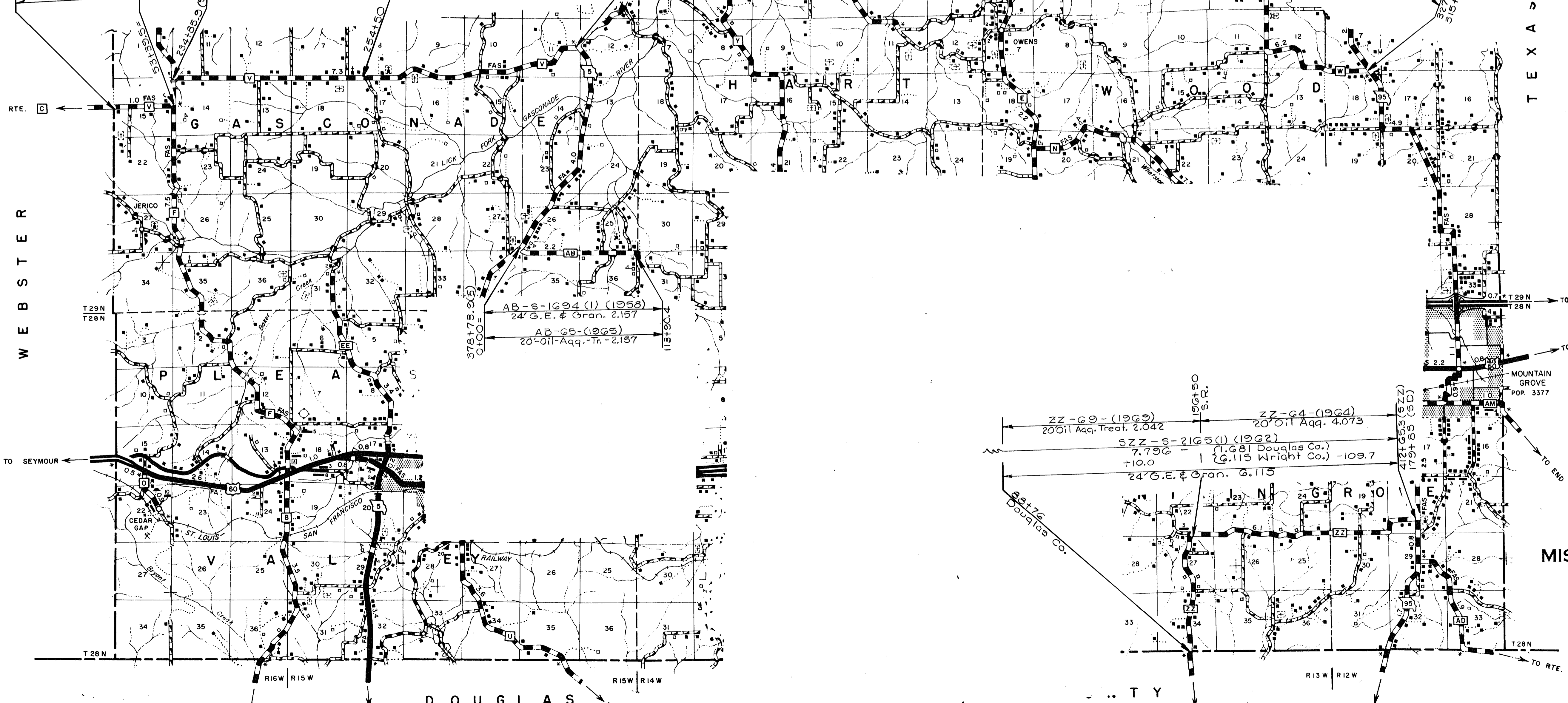
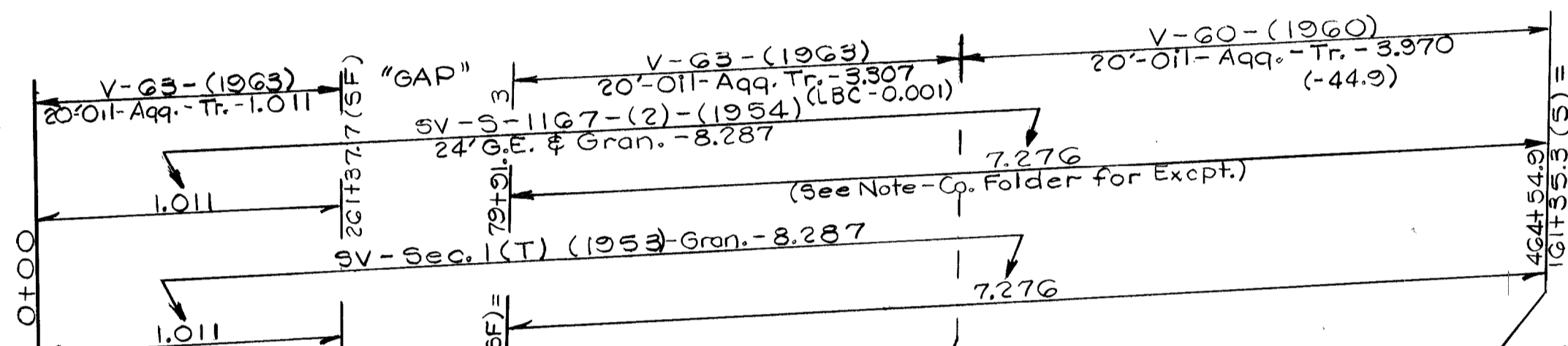
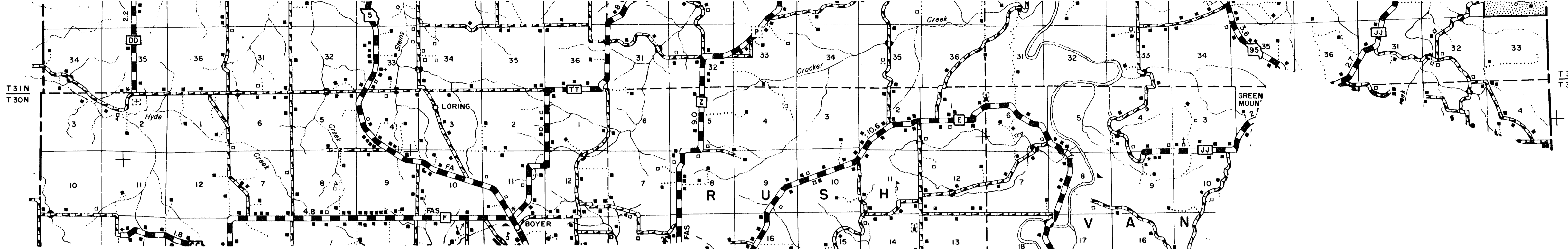

WRIGHT
114 ⑧
MIS: ROUTES
V-W-ZZ-AB